

**TREE CANOPY COMPLIANCE**  
**GROSS PROJECT SITE AREA:**  
 <LESS FLOODPLAIN>  
 = NET PROJECT SITE AREA:  
 X 38% = **TREE CANOPY REQUIRED**  
**TREE CANOPY PROVIDED**

|   |                           |
|---|---------------------------|
| <b>1. 100% CREDIT EXISTING PROTECTED TREES</b>  | <b>984,807 SF</b>         |
| <b>(275) LIVE OAK @ 875 SF x 100%:</b>  | <b>149,651 SF</b>         |
| (TAG #'s 6043, 6064, 6073, 6074, 6085, 6086, 6092, 6098 thru 6101, 6103, 6112, 6115, 6116, 6144, 6145, 6155, 6157 thru 6160, 6162 thru 6179, 6181 thru 6183 6216, 6271, 6300, 6303 thru 6306, 6308 thru 6320, 6322, 6324, 6331, 6332, 6334, 6364 thru 6366, 6369, 6370, 6371, 6381, 6382 thru 6387, 6392 thru 6400, 6402, 6408 thru 6410, 6496 thru 6499, 6504 thru 6507, 6509, 6510, 6534, 6536, 6555, 6556, 6567, 6631, 6640, 6647, 6649 thru 6663, 6666, 6667, 6670 thru 6673, 6675 thru 6681, 6683 thru 6685, 6687 thru 6689, 6693 thru 6701, 6703 thru 6707, 6709, 6711, 6715 thru 6719, 6722, 6723, 6725 thru 6739, 6740 thru 6774, 6771 thru 6774, 6776 thru 6784, 6789, 6791 thru 6797, 6806, 6815 thru 6829, 6831, 6836 thru 6847, 6849 thru 6872, 6903) | <b>240,625 SF</b>         |
| <b>(53) ELM @ 875 SF x 100%:</b>  | <b>46,375 SF</b>          |
| (TAG #'s 6017, 6020, 6039, 6042, 6063, 6066 thru 6068, 6070, 6075 thru 6081, 6091, 6093 thru 6097, 6102, 6113, 6136 thru 6138, 6147, 6156, 6217, 6388, 6511, 6512, 6557 thru 6562, 6564 thru 6566, 6702, 6708, 6710, 6712 thru 6714, 6720, 6721, 6724, 6902, 6909)  | <b>7425 SF</b>            |
| <b>(27) CEDAR @ 275 SF x 100%:</b>  | <b>2625 SF</b>            |
| (TAG #'s 6082 thru 6084, 6140, 6323, 6368, 6389, 6390, 6460, 6501, 6533, 6641 thru 6646, 6648, 6664, 6665, 6668, 6669, 6674, 6682, 6686, 6690, 6775)  | <b>550 SF</b>             |
| <b>(3) HACKBERRY @ 875 SF x 100%:</b>   | <b>875 SF</b>             |
| (TAG #'s 6114, 6367, 6623)  | <b>550 SF</b>             |
| <b>(2) PERSIMMON @ 275 SF x 100%:</b>   | <b>41,800 SF</b>          |
| (TAG #'s 6161, 6563)  | <b>9625 SF</b>            |
| <b>(1) WALNUT @ 875 SF x 100%:</b>  | <b>7875 SF</b>            |
| (TAG # 6830)  | <b>1750 SF</b>            |
| <b>(1) RED OAK @ 550 SF x 100%:</b>   | <b>1100 SF</b>            |
| (TAG # 8321)  |                           |
| <b>2. 100% CREDIT EXISTING UNDERSIZED TREES</b>   | <b>79,380 SF</b>          |
| <b>(152) CEDAR @ 275 SF x 100%:</b>   | <b>38,588 SF</b>          |
| (TAG #'s 001 thru 004, 009 thru 013, 017 thru 019, 021 thru 023, 025 thru 027, 029 thru 031, 035, 039 thru 040, 048, 053 thru 068, 070 thru 091, 096 thru 113, 115, 117 thru 137, 155 thru 167, 169 thru 200)   |                           |
| <b>(35) PERSIMMON @ 275 SF x 100%:</b>  | <b>479,143 SF (57.4%)</b> |
| (TAG #'s 005, 008, 028, 033, 034, 036 thru 038, 046, 047, 049 thru 052, 069, 092 thru 095, 138 thru 150, 152 thru 154)  |                           |
| <b>(9) LIVE OAK @ 875 SF x 100%:</b>  |                           |
| (TAG #'s 014 thru 016, 020, 024, 032, 151, 168, 188)  |                           |
| <b>(2) ELM @ 875 SF x 100%:</b>   |                           |
| (TAG #'s 006, 007)  |                           |
| <b>(2) RED OAK @ 550 SF x 100%:</b>   |                           |
| (TAG #'s 114, 118)  |                           |
| <b>3. NEW TREES - (2) PER LOT, 49 LOTS TOTAL</b>  |                           |
| (1) SHUMARD OAKS, BUR OAKS OR MEXICAN SYCAMORES PER LOT @ 1200 SF X 90% X 150% (ENERGY CONSERVATION CREDIT USED)  |                           |
| B. (1) LIVE OAK OR CEDAR ELM PER LOT @ 875 SF X 90%   |                           |

**TREE MITIGATION SUMMARY**

|  |                           |
|--|---------------------------|
| <b>MITIGATION REQUIRED PER TREE INVENTORY:</b> | <b>1546.8 Cal. Inches</b> |
| MITIGATION PROVIDED:                           |                           |
| 1. UNDERSIZED TREES TO BE PRESERVED            | 2048 Cal. Inches          |
| REF. UNDERSIZED TREE INVENTORY                 |                           |
| 2. PARTIAL-CREDIT PROPOSED TREES               |                           |
| (2) 3" TREES PER LOT X 49 LOTS (LESS 1.5" EA)  | 147 Cal. Inches           |
| <b>TOTAL MITIGATION PROVIDED:</b>              | <b>2195.0 Cal. Inches</b> |

**EXISTING TREE PRESERVATION AND REMOVAL NOTES:**

- UNLESS OTHERWISE SPECIFICALLY INDICATED, THIS DOCUMENT SHOWS ONLY EXISTING PROTECTED-SIZE TREES AS DEFINED BY THE CITY OF SAN ANTONIO UNIFIED DEVELOPMENT CODE (THE "UDC") IN EFFECT ON THE DATE HEREOF.
- CONTRACTOR IS SOLELY RESPONSIBLE FOR INSPECTING THE PROJECT SITE AND DETERMINING FOR HIMSELF IF OTHER EXISTING TREES, SHRUBS, OR VEGETATION ARE PRESENT WHICH MUST BE REMOVED IN ORDER TO CONSTRUCT THE IMPROVEMENTS PROPOSED HEREBY.
- BY ACT OF SUBMITTING A BID TO REMOVE THE EXISTING TREES SHOWN ON THIS PLAN, CONTRACTOR WARRANTS THAT HE (A) HAS PERSONALLY VISITED THE PROJECT SITE, (B) HAS INVESTIGATED THE EXISTING CONDITIONS SUFFICIENTLY TO DETERMINE WHAT, IF ANY, ADDITIONAL EXISTING TREES, SHRUBS, AND VEGETATION MUST BE REMOVED IN ORDER TO CONSTRUCT THE IMPROVEMENTS PROPOSED HEREBY, AND (C) HAS A CLEAR UNDERSTANDING OF THE TERMS "PROTECTED TREE," "SIGNIFICANT TREE," "HERITAGE TREE," AND "FLOOD PLAIN," AND OF ANY OTHER CITY GUIDELINES, STANDARDS, AND REQUIREMENTS WHICH MAY IMPACT REMOVAL OF THE EXISTING TREES DEPICTED ON THIS PLAN.
- IN THE EVENT CONTRACTOR ENCOUNTERS ADDITIONAL EXISTING TREES, SHRUBS, AND VEGETATION NOT SHOWN ON THIS PLAN, BUT WHICH MUST REASONABLY BE REMOVED IN ORDER TO CONSTRUCT THE IMPROVEMENTS PROPOSED HEREBY, CONTRACTOR SHALL REMOVE THE ADDITIONAL EXISTING TREES, SHRUBS, AND VEGETATION AT NO ADDITIONAL COST TO THE OWNER, SUBJECT TO ANY APPLICABLE REQUIREMENTS, GUIDELINES, STIPULATIONS, OR APPROVALS ENFORCED BY THE CITY OF SAN ANTONIO.
- ALL NEW TREES SHALL BE PLANTED IN SOIL THAT IS SUITABLE FOR ESTABLISHING AND SUSTAINING THE PLANTINGS. IN ADDITION TO CONTAINING SUITABLE PARTICLE SIZE AND DEPTH OF SOIL ZONE, THE SOIL MUST CONTAIN SUFFICIENT ORGANIC MATTER AND NUTRIENTS. TESTING AND CONFIRMATION BY A LANDSCAPE ARCHITECT OR A TEXAS LICENSED SOIL TESTING LAB SHALL BE COMPLETED TO ENSURE THE SUITS ARE SUITABLE. IN LIEU OF CONFIRMATION BY A LANDSCAPE ARCHITECT OR A TEXAS LICENSED SOIL TESTING LAB, AMEND SOIL WITH COMPOST BY ADDING 3" OF COMPOST BLENDED INTO EVERY ONE (1) FOOT OF SOIL DEPTH. FOR COMPLETE SOIL REPLACEMENT, ADD COMPOST TO SOIL AT A RATIO OF 25% COMPOST TO 75% NATIVE SOIL.

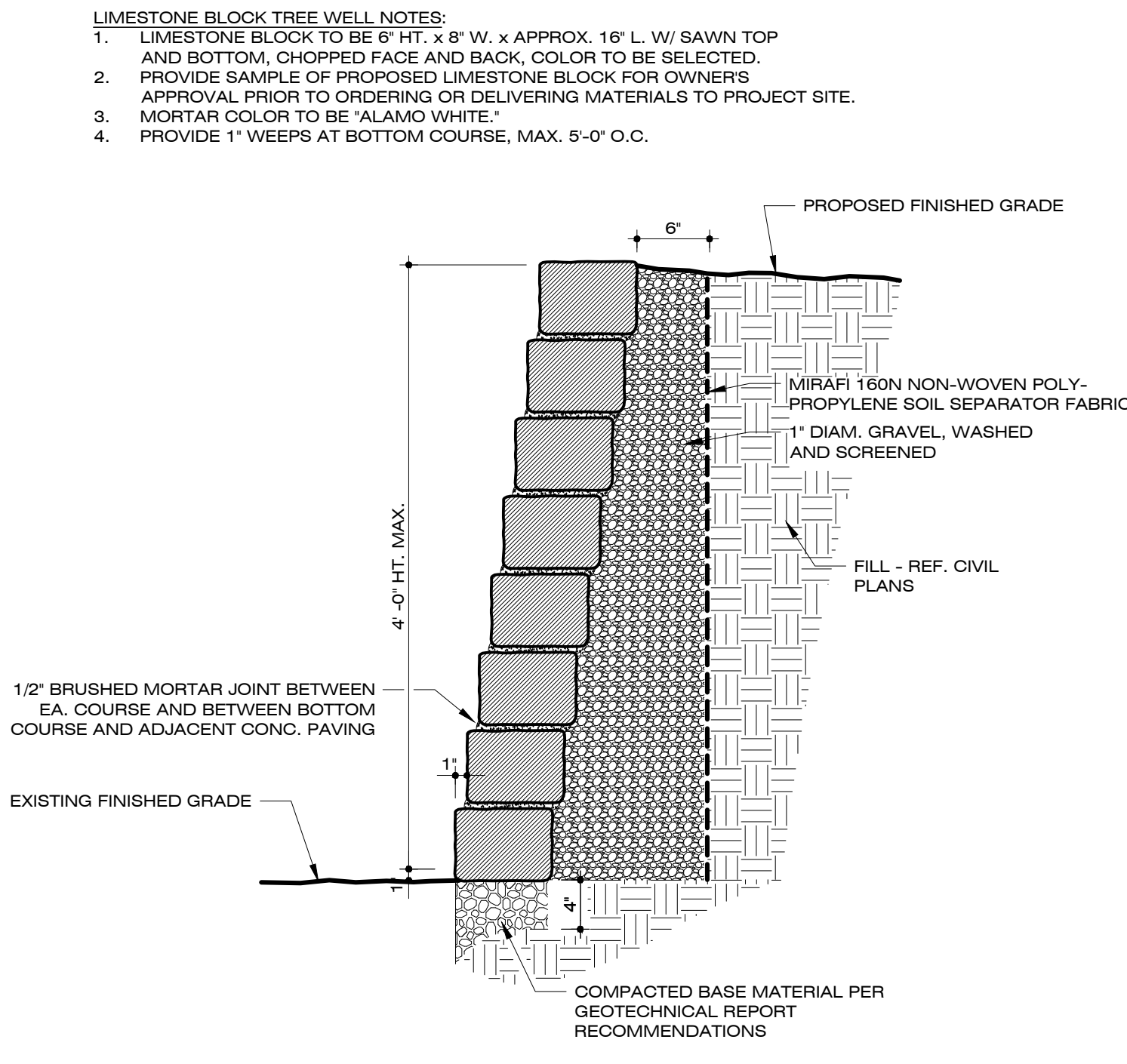

**MORTARED LIMESTONE BLOCK TREE WELL**  
 SCALE: 1" = 1'-0"

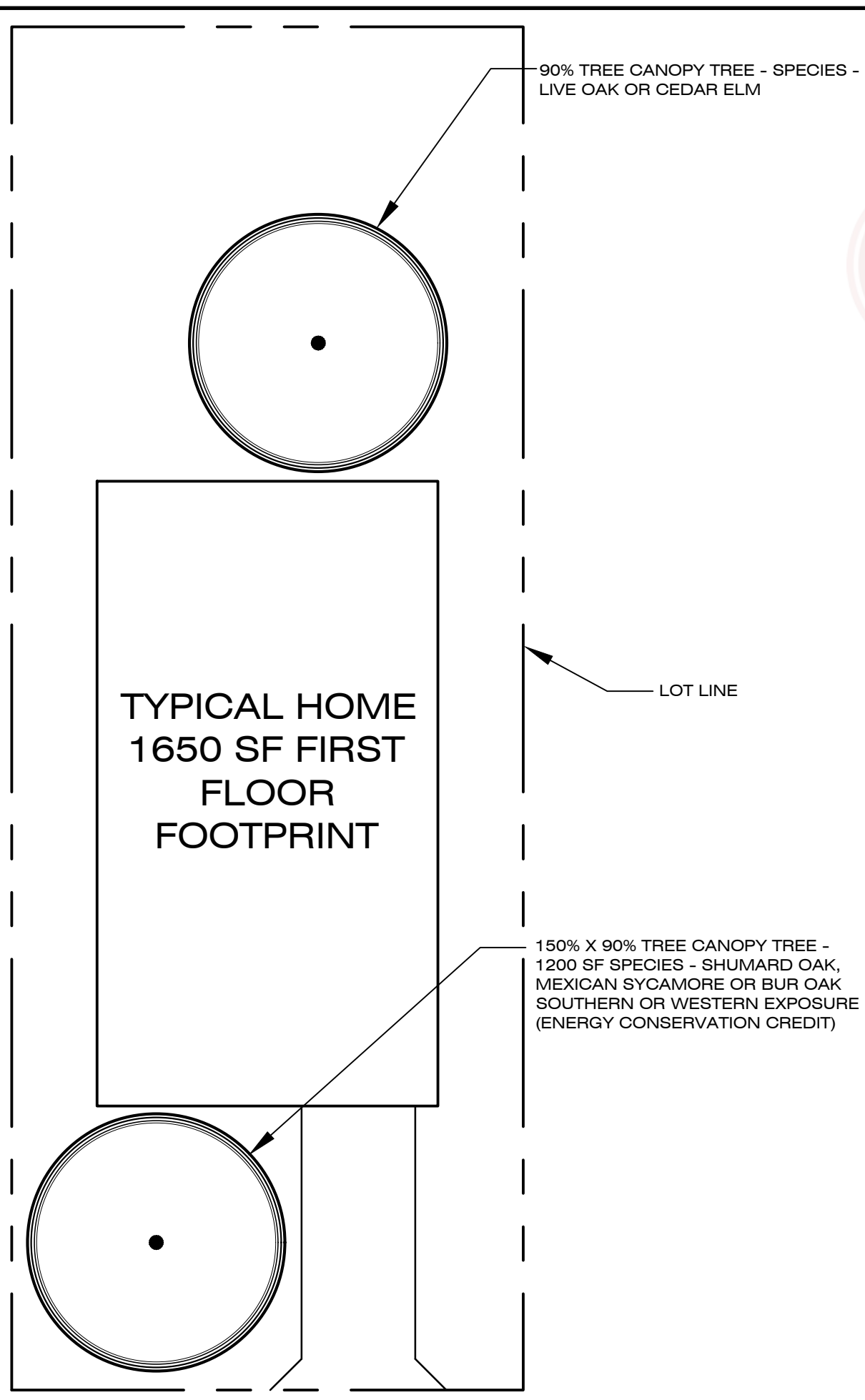
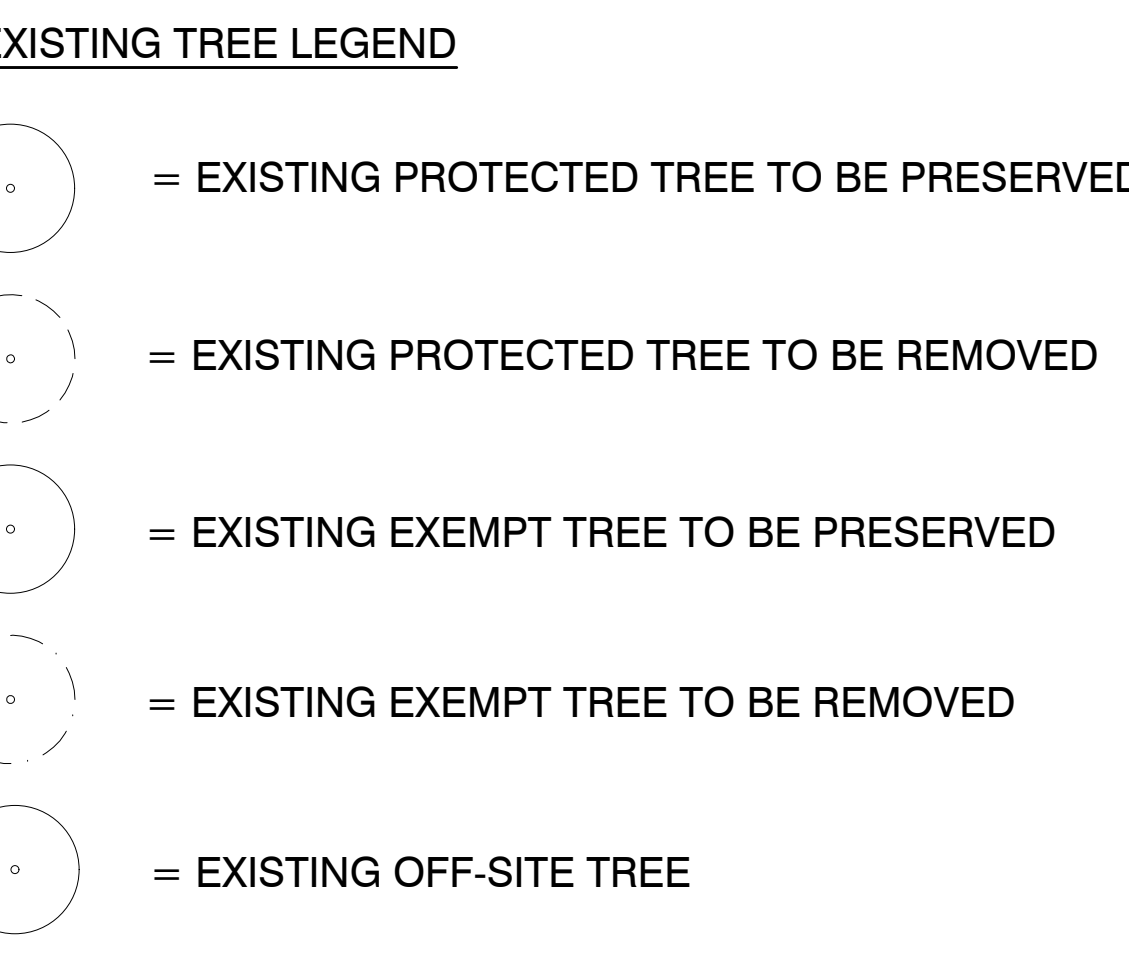
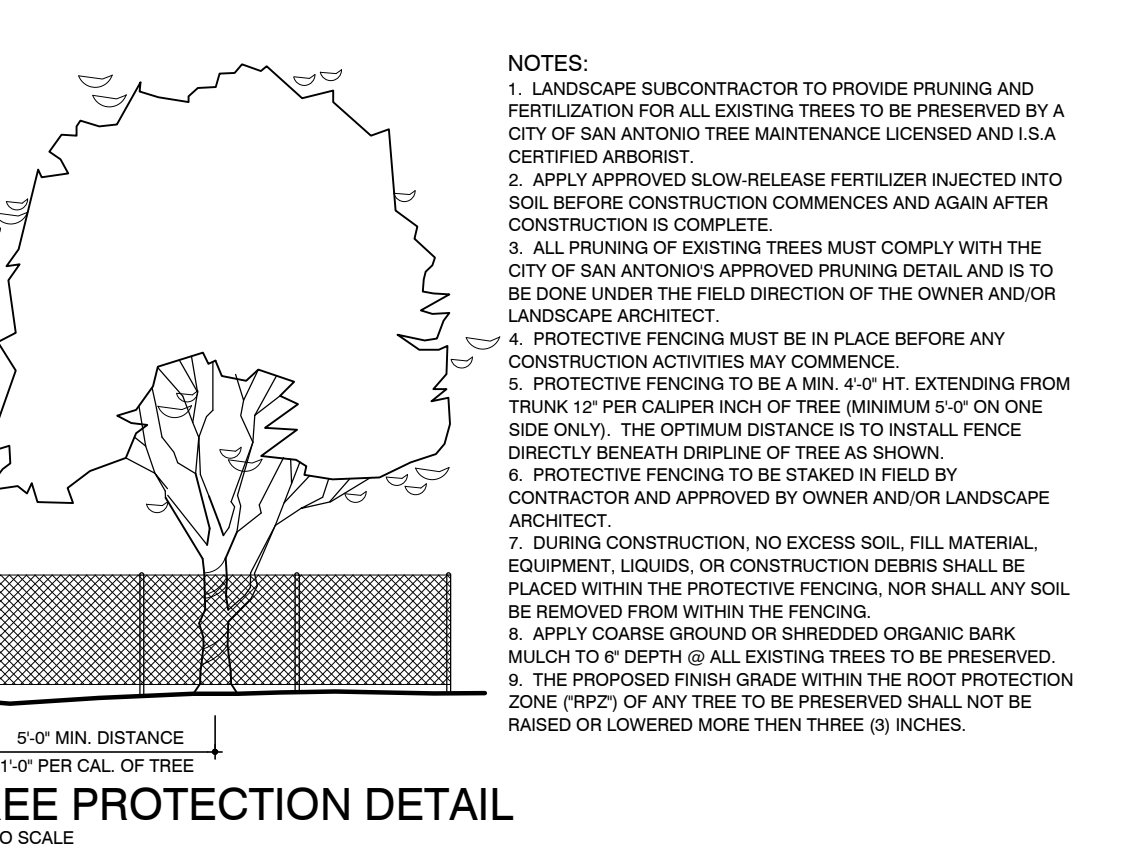
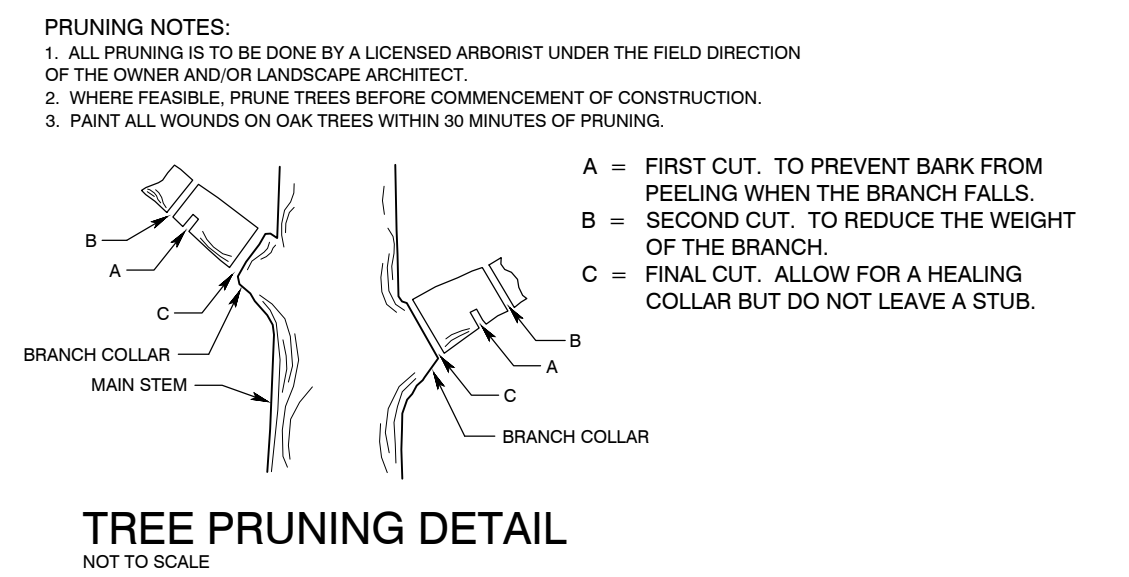

**TREE PLANTING DETAIL FOR TYPICAL LOT - 2 Trees**  
 Scale: 1/8" = 1'-0"

"SCOPE OF WORK: PLATTING AND TREE REMOVAL FOR RESIDENTIAL DEVELOPMENT WITHIN ET-7"

STATUS APPROVED 4/16/26 (2025 TREE SURVEY METHOD)

NOTE: APPLICATION IS FOR PLATTING AND TREE REMOVAL PURPOSES. TREE REMOVAL APPROVAL IS FOR TREE REMOVAL WITHIN PLAT 24-1180005 ONLY. ANY SITE WORK OR TREE REMOVAL OUTSIDE OF PLAT 24-1180005 SHALL REQUIRE A SEPARATE TREE APPLICATION BE SUBMITTED AND APPROVED PRIOR TO START OF WORK.

PLEASE SEE COMMENTS/CONDITIONS BELOW.

-0-3" CALIPER NATIVE MEDIUM AND LARGE SHADE TREES REQUIRED PER LOT AT BUILDING STAGE FOR MITIGATION AND TREE CANOPY COVER REQUIREMENTS. 1 OUT OF THE 2 TREES SHALL BE PLANTED ON THE SOUTH OR WEST SIDE OF BUILDING FOR ENERGY CONSERVATION.

NO STREET-TREE OR TREE CANOPY BOND REQUIRED.

THIS SUBDIVISION IS SUBJECT TO A MASTER TREE PLAN (THE APP-APPD-2008030) WHICH REQUIRES COMPLIANCE BY THE OWNERS OF ALL PROPERTY WITHIN THE PLAT BOUNDARY, AND THEIR EMPLOYEES AND CONTRACTORS, AND SHALL BE BINDING ON ALL SUCCESSORS IN TITLE EXCEPT FOR OWNERS OF SINGLE-FAMILY RESIDENTIAL LOTS SUBDIVIDED HEREINAFTER FOR WHICH CONSTRUCTION OF A RESIDENTIAL STRUCTURE HAS BEEN COMPLETED. THE MASTER TREE PLAN IS ON FILE AT THE CITY OF SAN ANTONIO ARBORISTS OFFICE. NO TREES OR UNDERSTORY SHALL BE REMOVED WITHOUT PRIOR APPROVAL OF THE CITY ARBORISTS OFFICE (SEE 4757).

CONSTRUCTION ON INDIVIDUAL RESIDENTIAL LOTS OUTSIDE OF CITY LIMITS ARE REQUIRED TO SUBMIT A TREE PERMIT APPLICATION REFERENCING APPROVED TREE PRESERVATION PLAN TO VERIFY COMPLIANCE AT BUILDING STAGE. FAILURE TO DO SO COULD INCUR CEASATION OF ON-SITE CONSTRUCTION, ADDITIONAL MITIGATION, AND/OR WORK WITHOUT PERMIT PENALTIES.

PRIOR TO COMMENCEMENT OF ANY ACTIVITIES REQUIRING A TREE PERMIT, THE APPLICANT SHALL SCHEDULE A PRE-CONSTRUCTION MEETING WITH THE CITY ARBORIST TO REVIEW PROCEDURES FOR PROTECTION AND MANAGEMENT OF ALL SIGNIFICANT, HERITAGE OR MITIGATION TREES (CAN BE SCHEDULED WITH TREE FENCING INSPECTION). INSPECTIONS CAN BE SCHEDULED ONLINE THROUGH:

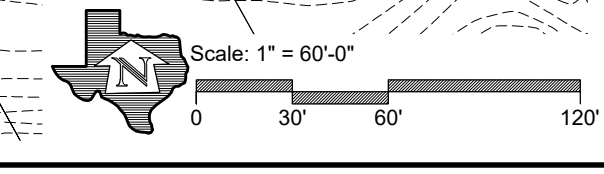
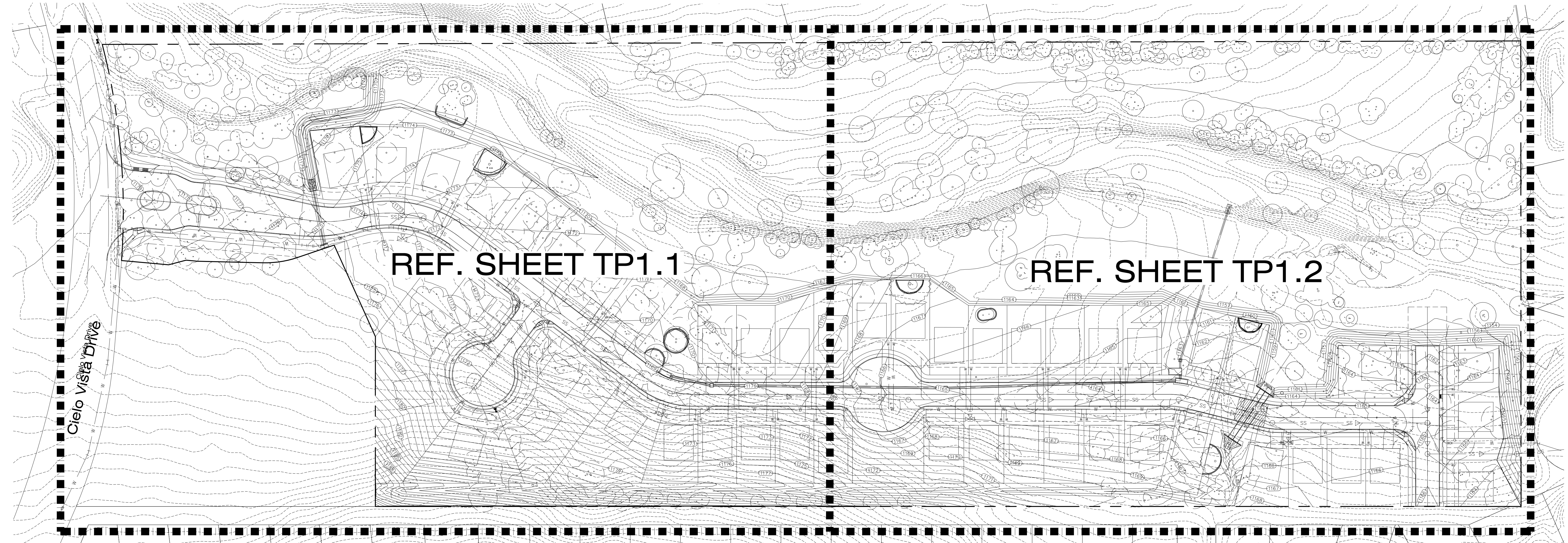

**HORIZON DESIGN AND DEVELOPMENT**  
 PLANNING LANDSCAPE ARCHITECTURE  
 DEVELOPMENT CONSULTING  
 14607 San Pedro Ave., Suite 200  
 San Antonio, Texas 78232  
 210.831.8564 | jrobison@horizondesignna.com

4/15/26

The user of this file agrees to assume all responsibility for any modifications to or use of this drawing file that is inconsistent with the requirements of the Rules and Regulations of the Texas Board of Architectural Examiners. No person may make any modifications to this electronic drawing file without the Landscape Architect's express written permission.

**City of San Antonio Plan Reviewed**

Development Services Dept

Failure to schedule a fencing inspection prior to start of work may result in a stop work order or a penalty of \$1,000.00 or both UDC §55-523 (h)(2)

It shall be the responsibility of the permit holder to maintain a copy of the approved tree plans, approved tree permit and the conditions of approval readily available at all times.

DEVELOPMENT SERVICES Tree Pre-Construction Meeting Required prior to Site Work

DEVELOPMENT SERVICES TREE PROTECTION SECTION REVIEWED FOR COMPLIANCE

**OWNER**

**TTM DEVELOPMENT LLC**  
 2025 Guadalupe Street Suite 260  
 Austin, TX 78705

**PROJECT TITLE**

**Hideaway Village Tree Preservation Plan Revisions**  
 Cielo Vista Drive  
 San Antonio, TX 78255

**PROJECT NUMBER**

2026-036

**DRAWN BY** jh **CHECKED BY** jr

**REVISIONS**

| NUMBER | DATE    | DESCRIPTION   |
|--------|---------|---------------|
| 1      | 4/15/26 | City Comments |

**SHEET TITLE**

**OVERALL TREE PRESERVATION PLAN**





**DATE**

April 7, 2026

**SHEET NUMBER**

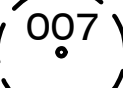
**TP1.0**

EXISTING TREE LEGEND

-  = EXISTING PROTECTED TREE TO BE PRESERVED
-  = EXISTING PROTECTED TREE TO BE REMOVED
-  = EXISTING EXEMPT TREE TO BE PRESERVED
-  = EXISTING EXEMPT TREE TO BE REMOVED
-  = EXISTING OFF-SITE TREE
-  = EXISTING SAVED TREE

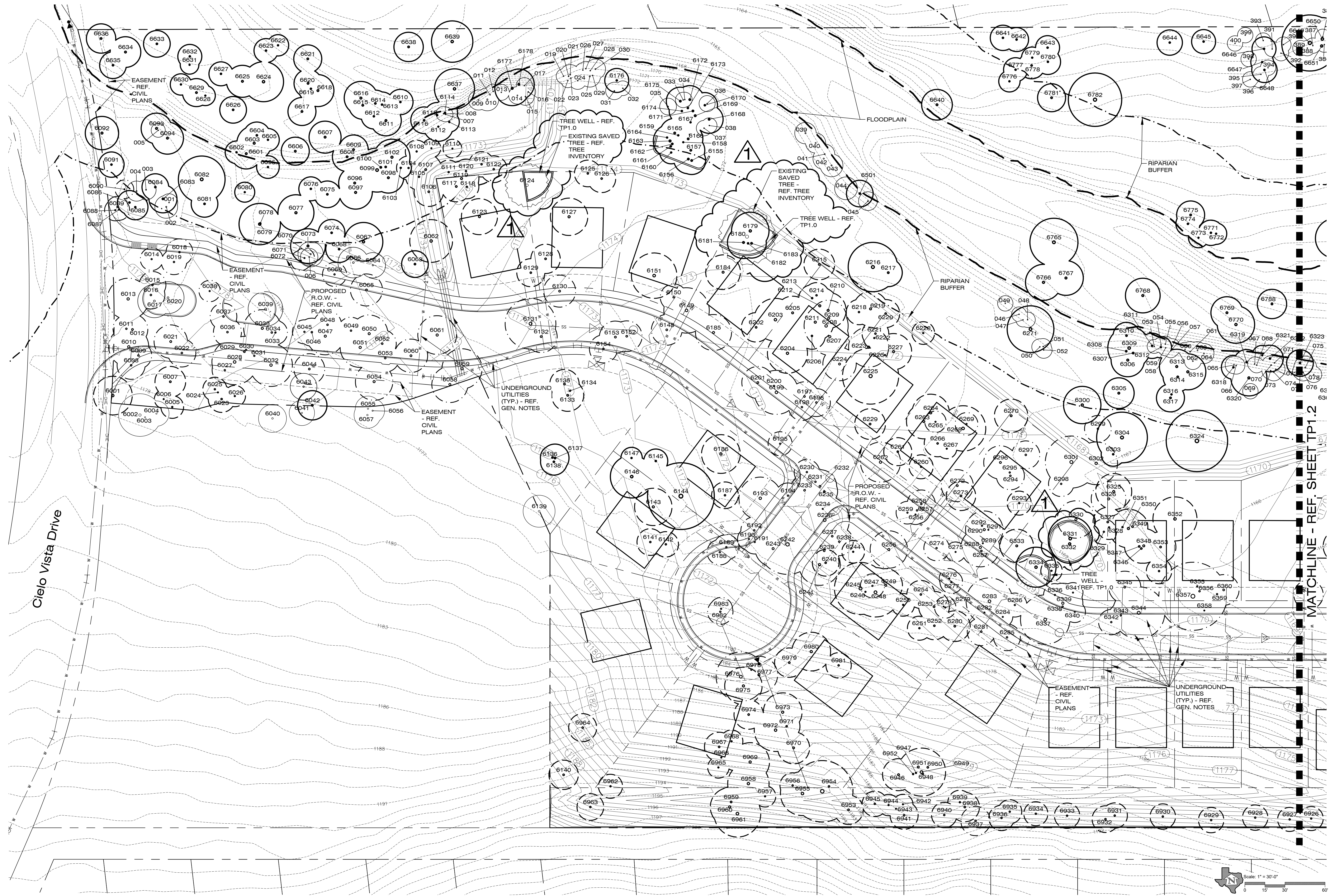

**HORIZON**  
DESIGN AND DEVELOPMENT  
PLANNING LANDSCAPE ARCHITECTURE  
DEVELOPMENT CONSULTING  
14607 San Pedro Ave., Suite 200  
San Antonio, Texas 78232  
210.831.8564 | jrobison@horizondesign.com



41526  
The user of this file agrees to assume all responsibility for any modifications to or use of this drawing file that is inconsistent with the requirements of the Rules and Regulations of the Texas Board of Architectural Examiners. No person may make any modifications to this electronic drawing file without the Landscape Architect's express written permission.



City of San Antonio  
Development Services Dept

Failure to schedule a fencing inspection prior to start of work may result in a stop work order or a penalty of \$1,000.00 or both. UDC §35-523 (k)(2)

It shall be the responsibility of the permit holder to maintain a copy of the approved tree plans, approved tree permit and the conditions of approval readily available at all times.

DEVELOPMENT SERVICES  
Tree Pre-Construction Meeting  
Required prior to Site Work

DEVELOPMENT SERVICES  
TREE PROTECTION SECTION  
REVIEWED FOR COMPLIANCE

OWNER  
**TTM DEVELOPMENT LLC**  
2025 Guadalupe Street Suite 260  
Austin, TX 78705

PROJECT TITLE  
**Hideaway Village Tree Preservation Plan Revisions**  
Cielo Vista Drive  
San Antonio, TX 78355

PROJECT NUMBER  
2026-036

DRAWN BY: jh  
CHECKED BY: jr

| REVISIONS | NUMBER | DATE   | DESCRIPTION   |
|-----------|--------|--------|---------------|
| L         | 1      | 4/5/26 | City Comments |





SHEET TITLE  
**ENLARGED TREE PRESERVATION PLAN**

DATE  
April 7, 2026

SHEET NUMBER

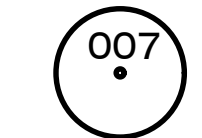
**TP1.1**

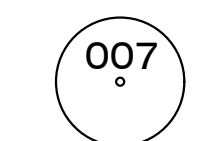
EXISTING TREE LEGEND

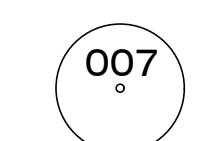
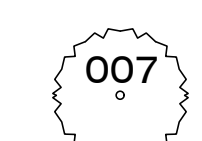
-  = EXISTING PROTECTED TREE TO BE PRESERVED
-  = EXISTING PROTECTED TREE TO BE REMOVED
-  = EXISTING EXEMPT TREE TO BE PRESERVED
-  = EXISTING EXEMPT TREE TO BE REMOVED
-  = EXISTING OFF-SITE TREE
-  = EXISTING SAVED TREE

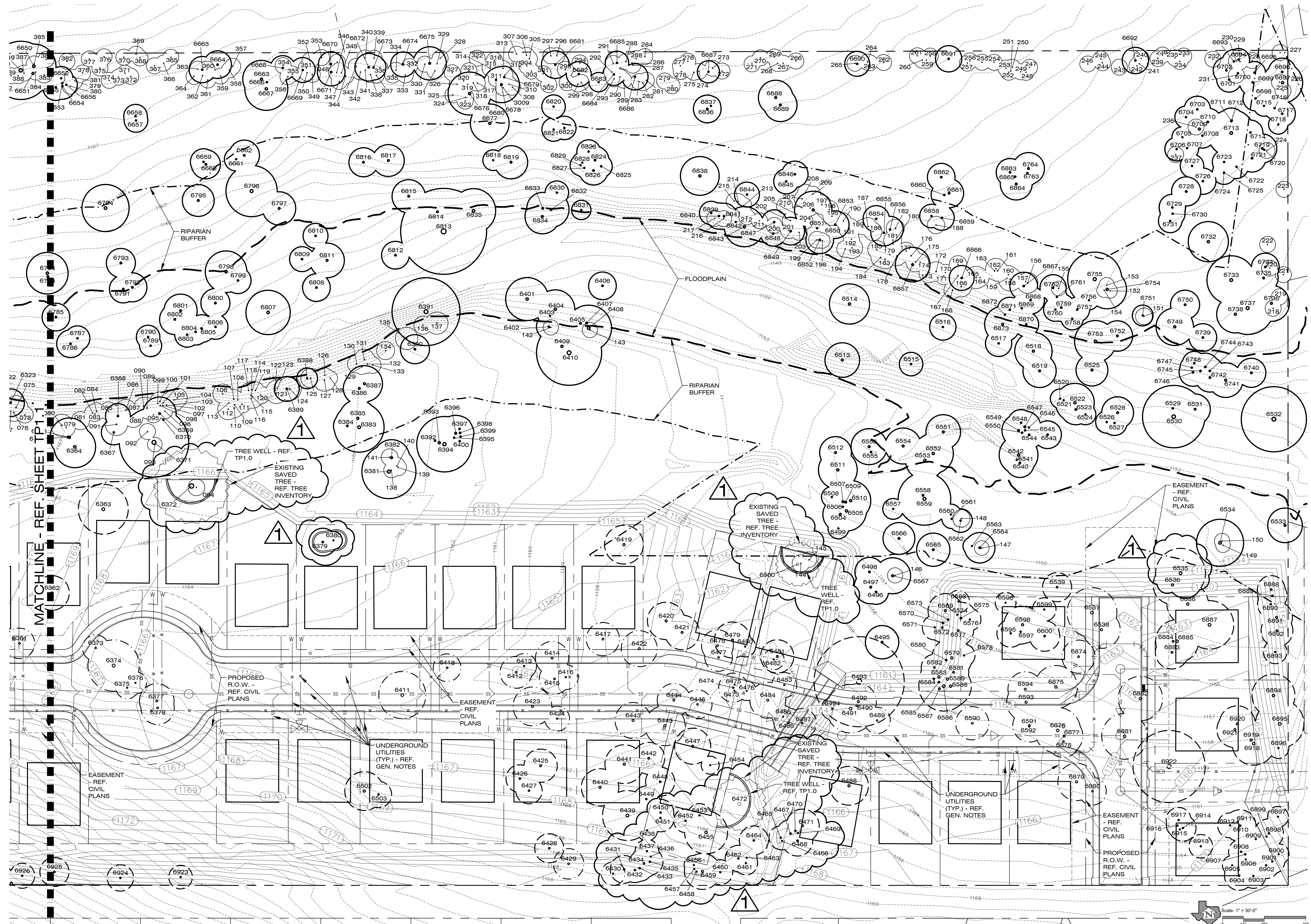



**HORIZON**  
DESIGN AND DEVELOPMENT  
PLANNING LANDSCAPE ARCHITECTURE  
DEVELOPMENT CONSULTING  
14607 San Pedro Ave., Suite 200  
San Antonio, Texas 78232  
210.831.8564 | info@horizondesign.com

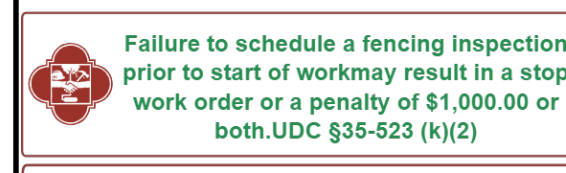
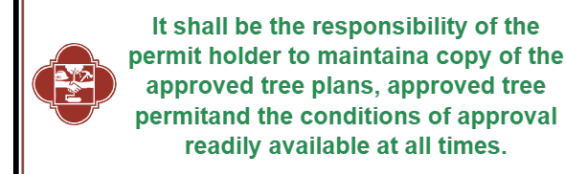

41526  
The user of this file agrees to assume all responsibility for any modifications to or use of this drawing file that is inconsistent with the requirements of the Rules and Regulations of the Texas Board of Architectural Examiners. No person may make any modifications to this electronic drawing file without the Landscape Architect's express written permission.

City of San Antonio  
Plan Reviewed  
Development Services Dept

- 
- 
- 
- 

OWNER  
**TTM DEVELOPMENT LLC**  
2025 Guadalupe Street Suite 260  
Austin, TX 78705

PROJECT TITLE  
**Hideaway Village Tree Preservation Plan Revisions**  
Cielo Vista Drive  
San Antonio, TX 78255

PROJECT NUMBER  
2026-036  
DRAWN BY: jh  
CHECKED BY: jr

| REVISIONS | NUMBER | DATE          | DESCRIPTION |
|-----------|--------|---------------|-------------|
| 1         | 4/7/26 | City Comments |             |

SHEET TITLE  
**ENLARGED TREE PRESERVATION PLAN**

DATE  
April 7, 2026  
SHEET NUMBER

**TP1.2**

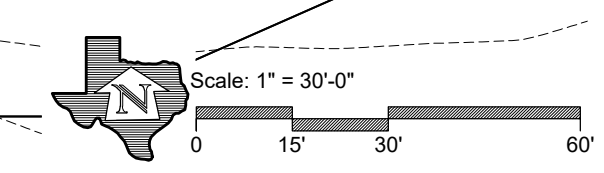





| TAG# | SPECIES   | SIZE | LARGE SPECIES         |                     |                    | SMALL SPECIES         |                     |                    | PROTECTED CAL. INCHES EXEMPT | COMMENTS |
|------|-----------|------|-----------------------|---------------------|--------------------|-----------------------|---------------------|--------------------|------------------------------|----------|
|      |           |      | SIGNIFICANT PRESERVED | SIGNIFICANT REMOVED | HERITAGE PRESERVED | SIGNIFICANT PRESERVED | SIGNIFICANT REMOVED | HERITAGE PRESERVED |                              |          |
| 6702 | ELM       | 11   | 11                    |                     |                    |                       |                     |                    |                              |          |
| 6703 | LIVE OAK  | 11   | 11                    |                     |                    |                       |                     |                    |                              |          |
| 6704 | LIVE OAK  | 8    | 8                     |                     |                    |                       |                     |                    |                              |          |
| 6705 | LIVE OAK  | 7    | 7                     |                     |                    |                       |                     |                    |                              |          |
| 6706 | LIVE OAK  | 9    | 9                     |                     |                    |                       |                     |                    |                              |          |
| 6707 | LIVE OAK  | 9    | 9                     |                     |                    |                       |                     |                    |                              |          |
| 6708 | ELM       | 10   | 10                    |                     |                    |                       |                     |                    |                              |          |
| 6709 | LIVE OAK  | 13   | 13                    |                     |                    |                       |                     |                    |                              |          |
| 6710 | ELM       | 12   | 12                    |                     |                    |                       |                     |                    |                              |          |
| 6711 | LIVE OAK  | 11   | 11                    |                     |                    |                       |                     |                    |                              |          |
| 6712 | ELM       | 7    | 7                     |                     |                    |                       |                     |                    |                              |          |
| 6713 | ELM       | 26   |                       |                     | 26                 |                       |                     |                    |                              |          |
| 6714 | ELM       | 10   | 10                    |                     |                    |                       |                     |                    |                              |          |
| 6715 | LIVE OAK  | 7    | 7                     |                     |                    |                       |                     |                    |                              |          |
| 6716 | LIVE OAK  | 8    | 8                     |                     |                    |                       |                     |                    |                              |          |
| 6717 | LIVE OAK  | 11   | 11                    |                     |                    |                       |                     |                    |                              |          |
| 6718 | LIVE OAK  | 6    | 6                     |                     |                    |                       |                     |                    |                              |          |
| 6719 | LIVE OAK  | 13   | 13                    |                     |                    |                       |                     |                    |                              |          |
| 6720 | ELM       | 7    | 7                     |                     |                    |                       |                     |                    |                              |          |
| 6721 | ELM       | 12   | 12                    |                     |                    |                       |                     |                    |                              |          |
| 6722 | LIVE OAK  | 9    | 9                     |                     |                    |                       |                     |                    |                              |          |
| 6723 | LIVE OAK  | 9    | 9                     |                     |                    |                       |                     |                    |                              |          |
| 6724 | ELM       | 6    | 6                     |                     |                    |                       |                     |                    |                              |          |
| 6725 | LIVE OAK  | 9    | 9                     |                     |                    |                       |                     |                    |                              |          |
| 6726 | LIVE OAK  | 11   | 11                    |                     |                    |                       |                     |                    |                              |          |
| 6727 | LIVE OAK  | 9    | 9                     |                     |                    |                       |                     |                    |                              |          |
| 6728 | LIVE OAK  | 13   | 13                    |                     |                    |                       |                     |                    |                              |          |
| 6729 | LIVE OAK  | 11   | 11                    |                     |                    |                       |                     |                    |                              |          |
| 6730 | LIVE OAK  | 10   | 10                    |                     |                    |                       |                     |                    |                              |          |
| 6731 | LIVE OAK  | 9    | 9                     |                     |                    |                       |                     |                    |                              |          |
| 6732 | LIVE OAK  | 21   | 21                    |                     |                    |                       |                     |                    |                              |          |
| 6733 | LIVE OAK  | 27   |                       |                     | 27                 |                       |                     |                    |                              |          |
| 6734 | LIVE OAK  | 12   | 12                    |                     |                    |                       |                     |                    |                              |          |
| 6735 | LIVE OAK  | 13   | 13                    |                     |                    |                       |                     |                    |                              |          |
| 6736 | LIVE OAK  | 18   | 18                    |                     |                    |                       |                     |                    |                              |          |
| 6737 | LIVE OAK  | 30   |                       |                     | 30                 |                       |                     |                    |                              |          |
| 6738 | LIVE OAK  | 19   | 19                    |                     |                    |                       |                     |                    |                              |          |
| 6739 | LIVE OAK  | 12   | 12                    |                     |                    |                       |                     |                    |                              |          |
| 6740 | LIVE OAK  | 19   | 19                    |                     |                    |                       |                     |                    |                              |          |
| 6741 | LIVE OAK  | 13   | 13                    |                     |                    |                       |                     |                    |                              |          |
| 6742 | LIVE OAK  | 7    | 7                     |                     |                    |                       |                     |                    |                              |          |
| 6743 | LIVE OAK  | 14   | 14                    |                     |                    |                       |                     |                    |                              |          |
| 6744 | LIVE OAK  | 22   | 22                    |                     |                    |                       |                     |                    |                              |          |
| 6745 | LIVE OAK  | 22   | 22                    |                     |                    |                       |                     |                    |                              |          |
| 6746 | LIVE OAK  | 30   | 20                    |                     |                    |                       |                     |                    |                              |          |
| 6747 | LIVE OAK  | 30   |                       |                     | 30                 |                       |                     |                    |                              |          |
| 6748 | LIVE OAK  | 6    | 6                     |                     |                    |                       |                     |                    |                              |          |
| 6749 | LIVE OAK  | 10   | 10                    |                     |                    |                       |                     |                    |                              |          |
| 6750 | LIVE OAK  | 12   | 12                    |                     |                    |                       |                     |                    |                              |          |
| 6751 | LIVE OAK  | 8    | 8                     |                     |                    |                       |                     |                    |                              |          |
| 6752 | LIVE OAK  | 14   | 14                    |                     |                    |                       |                     |                    |                              |          |
| 6753 | LIVE OAK  | 22   | 22                    |                     |                    |                       |                     |                    |                              |          |
| 6754 | LIVE OAK  | 22   | 22                    |                     |                    |                       |                     |                    |                              |          |
| 6755 | LIVE OAK  | 30   | 20                    |                     |                    |                       |                     |                    |                              |          |
| 6756 | LIVE OAK  | 30   |                       |                     | 30                 |                       |                     |                    |                              |          |
| 6757 | LIVE OAK  | 6    | 6                     |                     |                    |                       |                     |                    |                              |          |
| 6758 | LIVE OAK  | 10   | 10                    |                     |                    |                       |                     |                    |                              |          |
| 6759 | LIVE OAK  | 12   | 12                    |                     |                    |                       |                     |                    |                              |          |
| 6760 | LIVE OAK  | 8    | 8                     |                     |                    |                       |                     |                    |                              |          |
| 6761 | LIVE OAK  | 12   | 12                    |                     |                    |                       |                     |                    |                              |          |
| 6762 | LIVE OAK  | 9    | 9                     |                     |                    |                       |                     |                    |                              |          |
| 6763 | LIVE OAK  | 7    | 7                     |                     |                    |                       |                     |                    |                              |          |
| 6764 | LIVE OAK  | 11   | 11                    |                     |                    |                       |                     |                    |                              |          |
| 6765 | LIVE OAK  | 11   | 11                    |                     |                    |                       |                     |                    |                              |          |
| 6766 | LIVE OAK  | 8    | 8                     |                     |                    |                       |                     |                    |                              |          |
| 6767 | LIVE OAK  | 7    | 7                     |                     |                    |                       |                     |                    |                              |          |
| 6768 | LIVE OAK  | 10   | 10                    |                     |                    |                       |                     |                    |                              |          |
| 6769 | CEEDAR    | 14   | 14                    |                     |                    |                       |                     |                    |                              |          |
| 6770 | LIVE OAK  | 8    | 8                     |                     |                    |                       |                     |                    |                              |          |
| 6771 | LIVE OAK  | 10   | 10                    |                     |                    |                       |                     |                    |                              |          |
| 6772 | LIVE OAK  | 12   | 12                    |                     |                    |                       |                     |                    |                              |          |
| 6773 | LIVE OAK  | 8    | 8                     |                     |                    |                       |                     |                    |                              |          |
| 6774 | LIVE OAK  | 7    | 7                     |                     |                    |                       |                     |                    |                              |          |
| 6775 | LIVE OAK  | 14   | 14                    |                     |                    |                       |                     |                    |                              |          |
| 6776 | LIVE OAK  | 10   | 10                    |                     |                    |                       |                     |                    |                              |          |
| 6777 | LIVE OAK  | 12   | 12                    |                     |                    |                       |                     |                    |                              |          |
| 6778 | LIVE OAK  | 8    | 8                     |                     |                    |                       |                     |                    |                              |          |
| 6779 | LIVE OAK  | 11   | 11                    |                     |                    |                       |                     |                    |                              |          |
| 6780 | LIVE OAK  | 11   | 11                    |                     |                    |                       |                     |                    |                              |          |
| 6781 | LIVE OAK  | 13   | 13                    |                     |                    |                       |                     |                    |                              |          |
| 6782 | LIVE OAK  | 32   |                       |                     | 32                 |                       |                     |                    |                              |          |
| 6783 | LIVE OAK  | 13   | 13                    |                     |                    |                       |                     |                    |                              |          |
| 6784 | LIVE OAK  | 22   | 22                    |                     |                    |                       |                     |                    |                              |          |
| 6785 | LIVE OAK  | 8    | 8                     |                     |                    |                       |                     |                    |                              |          |
| 6786 | LIVE OAK  | 12   | 12                    |                     |                    |                       |                     |                    |                              |          |
| 6787 | LIVE OAK  | 13   | 13                    |                     |                    |                       |                     |                    |                              |          |
| 6788 | LIVE OAK  | 13   | 13                    |                     |                    |                       |                     |                    |                              |          |
| 6789 | LIVE OAK  | 26   |                       |                     | 26                 |                       |                     |                    |                              |          |
| 6790 | LIVE OAK  | 15   | 15                    |                     |                    |                       |                     |                    |                              |          |
| 6791 | LIVE OAK  | 29   |                       |                     | 29                 |                       |                     |                    |                              |          |
| 6792 | LIVE OAK  | 16   | 16                    |                     |                    |                       |                     |                    |                              |          |
| 6793 | LIVE OAK  | 10   | 10                    |                     |                    |                       |                     |                    |                              |          |
| 6794 | LIVE OAK  | 16   | 16                    |                     |                    |                       |                     |                    |                              |          |
| 6795 | LIVE OAK  | 9    | 9                     |                     |                    |                       |                     |                    |                              |          |
| 6796 | LIVE OAK  | 9    | 9                     |                     |                    |                       |                     |                    |                              |          |
| 6797 | LIVE OAK  | 9    | 9                     |                     |                    |                       |                     |                    |                              |          |
| 6798 | LIVE OAK  | 9    | 9                     |                     |                    |                       |                     |                    |                              |          |
| 6799 | LIVE OAK  | 12   | 12                    |                     |                    |                       |                     |                    |                              |          |
| 6800 | LIVE OAK  | 6    | 6                     |                     |                    |                       |                     |                    |                              |          |
| 6801 | LIVE OAK  | 6    | 6                     |                     |                    |                       |                     |                    |                              |          |
| 6802 | LIVE OAK  | 20   | 20                    |                     |                    |                       |                     |                    |                              |          |
| 6803 | LIVE OAK  | 9    | 9                     |                     |                    |                       |                     |                    |                              |          |
| 6804 | LIVE OAK  | 11   | 11                    |                     |                    |                       |                     |                    |                              |          |
| 6805 | LIVE OAK  | 11   | 11                    |                     |                    |                       |                     |                    |                              |          |
| 6806 | LIVE OAK  | 9    | 9                     |                     |                    |                       |                     |                    |                              |          |
| 6807 | LIVE OAK  | 11   | 11                    |                     |                    |                       |                     |                    |                              |          |
| 6808 | LIVE OAK  | 21   | 21                    |                     |                    |                       |                     |                    |                              |          |
| 6809 | LIVE OAK  | 10   | 10                    |                     |                    |                       |                     |                    |                              |          |
| 6810 | LIVE OAK  | 10   | 10                    |                     |                    |                       |                     |                    |                              |          |
| 6811 | LIVE OAK  | 11   | 11                    |                     |                    |                       |                     |                    |                              |          |
| 6812 | LIVE OAK  | 9    | 9                     |                     |                    |                       |                     |                    |                              |          |
| 6813 | LIVE OAK  | 17   | 17                    |                     |                    |                       |                     |                    |                              |          |
| 6814 | LIVE OAK  | 9    | 9                     |                     |                    |                       |                     |                    |                              |          |
| 6815 | LIVE OAK  | 10   | 10                    |                     |                    |                       |                     |                    |                              |          |
| 6816 | LIVE OAK  | 11   | 11                    |                     |                    |                       |                     |                    |                              |          |
| 6817 | LIVE OAK  | 11   | 11                    |                     |                    |                       |                     |                    |                              |          |
| 6818 | LIVE OAK  | 10   | 10                    |                     |                    |                       |                     |                    |                              |          |
| 6819 | LIVE OAK  | 11   | 11                    |                     |                    |                       |                     |                    |                              |          |
| 6820 | LIVE OAK  | 10   | 10                    |                     |                    |                       |                     |                    |                              |          |
| 6821 | LIVE OAK  | 10   | 10                    |                     |                    |                       |                     |                    |                              |          |
| 6822 | LIVE OAK  | 7    | 7                     |                     |                    |                       |                     |                    |                              |          |
| 6823 | LIVE OAK  | 12   | 12                    |                     |                    |                       |                     |                    |                              |          |
| 6824 | LIVE OAK  | 8    | 8                     |                     |                    |                       |                     |                    |                              |          |
| 6825 | LIVE OAK  | 8    | 8                     |                     |                    |                       |                     |                    |                              |          |
| 6826 | LIVE OAK  | 13   | 13                    |                     |                    |                       |                     |                    |                              |          |
| 6827 | LIVE OAK  | 6    | 6                     |                     |                    |                       |                     |                    |                              |          |
| 6828 | LIVE OAK  | 7    | 7                     |                     |                    |                       |                     |                    |                              |          |
| 6829 | LIVE OAK  | 7    | 7                     |                     |                    |                       |                     |                    |                              |          |
| 6830 | WALNUT    | 9    | 9                     |                     |                    |                       |                     |                    |                              |          |
| 6831 | LIVE OAK  | 6    | 6                     |                     |                    |                       |                     |                    |                              |          |
| 6832 | LIVE OAK  | 12   | 12                    |                     |                    |                       |                     |                    |                              |          |
| 6833 | LIVE OAK  | 6    | 6                     |                     |                    |                       |                     |                    |                              |          |
| 6834 | LIVE OAK  | 20   | 20                    |                     |                    |                       |                     |                    |                              |          |
| 6835 | LIVE OAK  | 9    | 9                     |                     |                    |                       |                     |                    |                              |          |
| 6836 | LIVE OAK  | 11   | 11                    |                     |                    |                       |                     |                    |                              |          |
| 6837 | LIVE OAK  | 11   | 11                    |                     |                    |                       |                     |                    |                              |          |
| 6838 | LIVE OAK  | 21   | 21                    |                     |                    |                       |                     |                    |                              |          |
| 6839 | LIVE OAK  | 10   | 10                    |                     |                    |                       |                     |                    |                              |          |
| 6840 | LIVE OAK  | 10   | 10                    |                     |                    |                       |                     |                    |                              |          |
| 6841 | LIVE OAK  | 10   | 10                    |                     |                    |                       |                     |                    |                              |          |
| 6842 | LIVE OAK  | 11   | 11                    |                     |                    |                       |                     |                    |                              |          |
| 6843 | LIVE OAK  | 11   | 11                    |                     |                    |                       |                     |                    |                              |          |
| 6844 | LIVE OAK  | 10   | 10                    |                     |                    |                       |                     |                    |                              |          |
| 6845 | LIVE OAK  | 10   | 10                    |                     |                    |                       |                     |                    |                              |          |
| 6846 | LIVE OAK  | 11   | 11                    |                     |                    |                       |                     |                    |                              |          |
| 6847 | LIVE OAK  | 10   | 10                    |                     |                    |                       |                     |                    |                              |          |
| 6848 | CEEDAR    | 10   |                       |                     | 10                 |                       |                     |                    |                              |          |
| 6849 | LIVE OAK  | 12   | 12                    |                     |                    |                       |                     |                    |                              |          |
| 6850 | LIVE OAK  | 19   | 19                    |                     |                    |                       |                     |                    |                              |          |
| 6851 | LIVE OAK  | 9    | 9                     |                     |                    |                       |                     |                    |                              |          |
| 6852 | LIVE OAK  | 12   | 12                    |                     |                    |                       |                     |                    |                              |          |
| 6853 | LIVE OAK  | 12   | 12                    |                     |                    |                       |                     |                    |                              |          |
| 6854 | LIVE OAK  | 11   | 11                    |                     |                    |                       |                     |                    |                              |          |
| 6855 | LIVE OAK  | 11   | 11                    |                     |                    |                       |                     |                    |                              |          |
| 6856 | LIVE OAK  | 11   | 11                    |                     |                    |                       |                     |                    |                              |          |
| 6857 | LIVE OAK  | 17   | 17                    |                     |                    |                       |                     |                    |                              |          |
| 6858 | LIVE OAK  | 9    | 9                     |                     |                    |                       |                     |                    |                              |          |
| 6859 | LIVE OAK  | 10   | 10                    |                     |                    |                       |                     |                    |                              |          |
| 6860 | LIVE OAK  | 11   | 11                    |                     |                    |                       |                     |                    |                              |          |
| 6861 | LIVE OAK  | 13   | 13                    |                     |                    |                       |                     |                    |                              |          |
| 6862 | LIVE OAK  | 12   | 12                    |                     |                    |                       |                     |                    |                              |          |
| 6863 | LIVE OAK  | 12   | 12                    |                     |                    |                       |                     |                    |                              |          |
| 6864 | LIVE OAK  | 15   | 15                    |                     |                    |                       |                     |                    |                              |          |
| 6865 | LIVE OAK  | 10   | 10                    |                     |                    |                       |                     |                    |                              |          |
| 6866 | LIVE OAK  | 10   | 10                    |                     |                    |                       |                     |                    |                              |          |
| 6867 | LIVE OAK  | 12   | 12                    |                     |                    |                       |                     |                    |                              |          |
| 6868 | LIVE OAK  | 12   | 12                    |                     |                    |                       |                     |                    |                              |          |
| 6869 | LIVE OAK  | 11   | 11                    |                     |                    |                       |                     |                    |                              |          |
| 6870 | LIVE OAK  | 10   | 10                    |                     |                    |                       |                     |                    |                              |          |
| 6871 | LIVE OAK  | 10   | 10                    |                     |                    |                       |                     |                    |                              |          |
| 6872 | LIVE OAK  | 6    | 6                     |                     |                    |                       |                     |                    |                              |          |
| 6873 | LIVE OAK  | 16   |                       |                     | 16                 |                       |                     |                    | Easement, Removed            |          |
| 6874 | LIVE OAK  | 23   |                       |                     | 23                 |                       |                     |                    | Easement, Removed            |          |
| 6875 | LIVE OAK  | 25   |                       |                     | 25                 |                       |                     |                    | ROW, Removed                 |          |
| 6876 | LIVE OAK  | 19   |                       |                     | 19                 |                       |                     |                    | ROW, Removed                 |          |
| 6877 | LIVE OAK  | 15   |                       |                     | 15                 |                       |                     |                    | ROW, Removed                 |          |
| 6878 | LIVE OAK  | 15   |                       |                     | 15                 |                       |                     |                    | ROW, Removed                 |          |
| 6879 | ELM       | 19   |                       |                     | 19                 |                       |                     |                    | ROW, Removed                 |          |
| 6880 | ELM       | 12   |                       |                     | 12                 |                       |                     |                    | ROW, Removed                 |          |
| 6881 | LIVE OAK  | 25   |                       |                     | 25                 |                       |                     |                    | ROW, Removed                 |          |
| 6882 | LIVE OAK  | 24   |                       |                     | 24                 |                       |                     |                    | ROW, Removed                 |          |
| 6883 | LIVE OAK  | 16   |                       |                     | 16                 |                       |                     |                    |                              |          |
| 6884 | LIVE OAK  | 16   |                       |                     | 16                 |                       |                     |                    |                              |          |
| 6885 | LIVE OAK  | 23   |                       |                     | 23                 |                       |                     |                    |                              |          |
| 6886 | LIVE OAK  | 22   |                       |                     | 22                 |                       |                     |                    |                              |          |
| 6887 | LIVE OAK  | 27   |                       |                     | 27                 |                       |                     |                    |                              |          |
| 6888 | LIVE OAK  | 12   |                       |                     | 12                 |                       |                     |                    |                              |          |
| 6889 | LIVE OAK  | 13   |                       |                     | 13                 |                       |                     |                    |                              |          |
| 6890 | LIVE OAK  | 11   |                       |                     | 11                 |                       |                     |                    |                              |          |
| 6891 | LIVE OAK  | 15   |                       |                     | 15                 |                       |                     |                    |                              |          |
| 6892 | LIVE OAK  | 15   |                       |                     | 15                 |                       |                     |                    |                              |          |
| 6893 | PERSIMMON | 9    |                       |                     | 9                  |                       |                     |                    |                              |          |
| 6894 | LIVE OAK  | 23   |                       |                     | 23                 |                       |                     |                    |                              |          |
| 6895 | LIVE OAK  | 27   |                       |                     | 27                 |                       |                     |                    |                              |          |
| 6896 | PERSIMMON | 7    |                       |                     | 7                  |                       |                     |                    |                              |          |
| 6897 | PERSIMMON | 7    |                       |                     | 7                  |                       |                     |                    |                              |          |

| TAG# | SPECIES  | SIZE | LARGE SPECIES         |                     |                    | SMALL SPECIES         |                     |                    | PROTECTED CAL. INCHES EXEMPT | COMMENTS |
|------|----------|------|-----------------------|---------------------|--------------------|-----------------------|---------------------|--------------------|------------------------------|----------|
|      |          |      | SIGNIFICANT PRESERVED | SIGNIFICANT REMOVED | HERITAGE PRESERVED | SIGNIFICANT PRESERVED | SIGNIFICANT REMOVED | HERITAGE PRESERVED |                              |          |
| 6898 | LIVE OAK | 15   |                       |                     | 15                 |                       |                     |                    |                              |          |
| 6899 | LIVE OAK | 9    |                       |                     | 9                  |                       |                     |                    |                              |          |
| 6900 | ELM      | 7    |                       |                     | 7                  |                       |                     |                    |                              |          |
| 6901 | LIVE OAK | 10   |                       |                     | 10                 |                       |                     |                    |                              |          |
| 6902 | ELM      | 11   | </                    |                     |                    |                       |                     |                    |                              |          |



UNDERSIZED TREE INVENTORY

March 23, 2026

| TAG # | SPECIES   | SIZE |
|-------|-----------|------|
| 001   | CEDAR     | 5    |
| 002   | CEDAR     | 9    |
| 003   | CEDAR     | 7    |
| 004   | CEDAR     | 7    |
| 005   | PERSIMMON | 2.5  |
| 006   | ELM       | 5    |
| 007   | ELM       | 3    |
| 008   | PERSIMMON | 3    |
| 009   | CEDAR     | 7    |
| 010   | CEDAR     | 9    |
| 011   | CEDAR     | 4    |
| 012   | CEDAR     | 3    |
| 013   | CEDAR     | 4    |
| 014   | LIVE OAK  | 5    |
| 015   | LIVE OAK  | 5    |
| 016   | LIVE OAK  | 3    |
| 017   | CEDAR     | 4    |
| 019   | CEDAR     | 3    |
| 020   | LIVE OAK  | 7    |
| 021   | CEDAR     | 7    |
| 022   | CEDAR     | 2.5  |
| 023   | CEDAR     | 5    |
| 024   | LIVE OAK  | 5    |
| 025   | CEDAR     | 8    |
| 026   | CEDAR     | 3    |
| 027   | CEDAR     | 3    |
| 028   | PERSIMMON | 2.5  |
| 029   | CEDAR     | 4    |
| 030   | CEDAR     | 7    |
| 031   | CEDAR     | 5    |
| 032   | LIVE OAK  | 3    |
| 033   | PERSIMMON | 3.5  |
| 034   | PERSIMMON | 3    |
| 035   | CEDAR     | 4.5  |
| 036   | PERSIMMON | 4    |
| 037   | PERSIMMON | 3.5  |
| 038   | PERSIMMON | 3.5  |
| 039   | CEDAR     | 8    |
| 040   | CEDAR     | 7    |
| 041   | CEDAR     | 7    |
| 042   | CEDAR     | 8    |
| 043   | CEDAR     | 9    |
| 044   | CEDAR     | 9    |
| 045   | CEDAR     | 6    |
| 046   | PERSIMMON | 3    |
| 047   | PERSIMMON | 2.5  |
| 048   | CEDAR     | 3.5  |
| 049   | PERSIMMON | 3.5  |
| 050   | PERSIMMON | 4    |
| 051   | PERSIMMON | 4    |
| 052   | PERSIMMON | 4.5  |
| 053   | CEDAR     | 2.5  |
| 054   | CEDAR     | 3.5  |
| 055   | CEDAR     | 4    |
| 056   | CEDAR     | 3    |
| 057   | CEDAR     | 3    |
| 058   | CEDAR     | 3    |
| 059   | CEDAR     | 4    |
| 060   | CEDAR     | 2.5  |
| 061   | CEDAR     | 7    |
| 062   | CEDAR     | 4.5  |
| 063   | CEDAR     | 5    |
| 064   | CEDAR     | 7    |
| 065   | CEDAR     | 5    |
| 066   | CEDAR     | 5    |
| 067   | CEDAR     | 2.5  |
| 068   | CEDAR     | 3.5  |
| 069   | PERSIMMON | 3.5  |
| 070   | CEDAR     | 6    |
| 071   | CEDAR     | 4.5  |
| 072   | CEDAR     | 6    |
| 073   | CEDAR     | 5    |
| 074   | CEDAR     | 5    |
| 075   | CEDAR     | 9    |
| 076   | CEDAR     | 5    |
| 077   | CEDAR     | 3.5  |
| 078   | CEDAR     | 4    |
| 079   | CEDAR     | 5    |
| 080   | CEDAR     | 8    |
| 081   | CEDAR     | 5    |
| 082   | CEDAR     | 3.5  |
| 083   | CEDAR     | 2.5  |
| 084   | CEDAR     | 4.5  |
| 085   | CEDAR     | 5    |
| 086   | CEDAR     | 7    |
| 087   | CEDAR     | 3    |
| 088   | CEDAR     | 6    |
| 089   | CEDAR     | 7    |
| 090   | CEDAR     | 5    |
| 091   | CEDAR     | 8    |
| 092   | PERSIMMON | 3.5  |
| 093   | PERSIMMON | 2.5  |
| 094   | PERSIMMON | 4    |
| 095   | PERSIMMON | 3.5  |
| 096   | CEDAR     | 3    |
| 097   | CEDAR     | 4.5  |
| 098   | CEDAR     | 5    |
| 099   | CEDAR     | 3    |
| 100   | CEDAR     | 6    |
| 101   | CEDAR     | 5    |
| 102   | CEDAR     | 5    |
| 103   | CEDAR     | 2.5  |
| 104   | CEDAR     | 7    |
| 105   | CEDAR     | 6    |
| 106   | CEDAR     | 6    |
| 107   | CEDAR     | 6    |
| 108   | CEDAR     | 2.5  |
| 109   | CEDAR     | 6    |
| 110   | CEDAR     | 6    |
| 111   | CEDAR     | 4.5  |
| 112   | CEDAR     | 7    |
| 113   | CEDAR     | 4    |
| 114   | RED OAK   | 5    |
| 115   | CEDAR     | 9    |
| 116   | RED OAK   | 4    |
| 117   | CEDAR     | 3    |
| 118   | CEDAR     | 4    |
| 119   | CEDAR     | 4.5  |
| 120   | CEDAR     | 5    |
| 121   | CEDAR     | 7    |
| 122   | CEDAR     | 5    |
| 123   | CEDAR     | 5    |
| 124   | CEDAR     | 9    |
| 125   | CEDAR     | 6    |
| 126   | CEDAR     | 3    |
| 127   | CEDAR     | 8    |
| 128   | CEDAR     | 2.5  |
| 129   | CEDAR     | 3    |
| 130   | CEDAR     | 5    |
| 131   | CEDAR     | 7    |
| 132   | CEDAR     | 5    |
| 133   | CEDAR     | 4    |
| 134   | CEDAR     | 5    |
| 135   | CEDAR     | 8    |
| 136   | CEDAR     | 5    |
| 137   | CEDAR     | 8    |
| 138   | PERSIMMON | 3    |
| 139   | PERSIMMON | 4    |
| 140   | PERSIMMON | 4.5  |
| 141   | PERSIMMON | 4    |
| 142   | PERSIMMON | 3    |
| 143   | PERSIMMON | 3    |
| 144   | PERSIMMON | 4.5  |
| 145   | PERSIMMON | 3    |
| 146   | PERSIMMON | 3    |
| 147   | PERSIMMON | 2.5  |
| 148   | PERSIMMON | 4.5  |
| 149   | PERSIMMON | 2.5  |
| 150   | PERSIMMON | 3    |
| 151   | LIVE OAK  | 4    |
| 152   | PERSIMMON | 2.5  |
| 153   | PERSIMMON | 3    |
| 154   | PERSIMMON | 2.5  |
| 155   | CEDAR     | 7    |
| 156   | CEDAR     | 7    |
| 157   | CEDAR     | 3.5  |

| TAG # | SPECIES   | SIZE |
|-------|-----------|------|
| 158   | CEDAR     | 9    |
| 159   | CEDAR     | 4    |
| 160   | CEDAR     | 5    |
| 161   | CEDAR     | 7    |
| 162   | CEDAR     | 7    |
| 163   | CEDAR     | 5    |
| 164   | CEDAR     | 5    |
| 165   | CEDAR     | 6    |
| 166   | CEDAR     | 7    |
| 167   | CEDAR     | 7    |
| 168   | LIVE OAK  | 4.5  |
| 169   | CEDAR     | 4.5  |
| 170   | CEDAR     | 4    |
| 171   | CEDAR     | 4.5  |
| 172   | CEDAR     | 6    |
| 173   | CEDAR     | 6    |
| 174   | CEDAR     | 4    |
| 175   | CEDAR     | 6    |
| 176   | CEDAR     | 4.5  |
| 177   | CEDAR     | 4.5  |
| 178   | CEDAR     | 6    |
| 179   | CEDAR     | 3    |
| 180   | CEDAR     | 3    |
| 181   | CEDAR     | 5    |
| 182   | CEDAR     | 5    |
| 183   | CEDAR     | 6    |
| 184   | CEDAR     | 6    |
| 185   | CEDAR     | 5    |
| 186   | CEDAR     | 5    |
| 187   | CEDAR     | 5    |
| 188   | LIVE OAK  | 4.5  |
| 189   | CEDAR     | 3    |
| 190   | CEDAR     | 3.5  |
| 191   | CEDAR     | 7    |
| 192   | CEDAR     | 3.5  |
| 193   | CEDAR     | 7    |
| 194   | CEDAR     | 4    |
| 195   | CEDAR     | 5    |
| 196   | CEDAR     | 5    |
| 197   | CEDAR     | 6    |
| 198   | CEDAR     | 3    |
| 199   | CEDAR     | 4    |
| 200   | CEDAR     | 3.5  |
| 201   | CEDAR     | 4.5  |
| 202   | CEDAR     | 5    |
| 203   | CEDAR     | 4.5  |
| 204   | CEDAR     | 4    |
| 205   | CEDAR     | 7    |
| 206   | CEDAR     | 7    |
| 207   | CEDAR     | 3    |
| 208   | CEDAR     | 7    |
| 209   | CEDAR     | 6    |
| 210   | CEDAR     | 7    |
| 211   | CEDAR     | 4.5  |
| 212   | CEDAR     | 6    |
| 213   | CEDAR     | 6    |
| 214   | CEDAR     | 6    |
| 215   | CEDAR     | 7    |
| 216   | CEDAR     | 8    |
| 217   | CEDAR     | 5    |
| 218   | PERSIMMON | 3    |
| 219   | PERSIMMON | 2.5  |
| 220   | CEDAR     | 2.5  |
| 221   | PERSIMMON | 2.5  |
| 222   | CEDAR     | 2.5  |
| 223   | PERSIMMON | 3    |
| 224   | ELM       | 5    |
| 225   | PERSIMMON | 4.5  |
| 226   | PERSIMMON | 3    |
| 227   | PERSIMMON | 3    |
| 228   | CEDAR     | 6    |
| 229   | HACKBERRY | 6    |
| 230   | CEDAR     | 8    |
| 231   | LIVE OAK  | 5    |
| 232   | PERSIMMON | 3    |
| 233   | CEDAR     | 6    |
| 234   | CEDAR     | 8    |
| 235   | CEDAR     | 3.5  |
| 236   | PERSIMMON | 4    |
| 237   | PERSIMMON | 2.5  |
| 238   | CEDAR     | 6    |
| 239   | CEDAR     | 6    |
| 240   | CEDAR     | 7    |
| 241   | CEDAR     | 6    |
| 242   | CEDAR     | 6    |
| 243   | CEDAR     | 9    |
| 244   | CEDAR     | 9    |
| 245   | CEDAR     | 6    |
| 246   | CEDAR     | 6    |
| 247   | CEDAR     | 9.5  |
| 248   | CEDAR     | 7    |
| 249   | CEDAR     | 9    |
| 250   | CEDAR     | 5.5  |
| 251   | CEDAR     | 7    |
| 252   | CEDAR     | 6    |
| 253   | CEDAR     | 5    |
| 254   | CEDAR     | 6    |
| 255   | CEDAR     | 8    |
| 256   | CEDAR     | 5    |
| 257   | CEDAR     | 5    |
| 258   | CEDAR     | 6    |
| 259   | CEDAR     | 8    |
| 260   | CEDAR     | 7    |
| 261   | CEDAR     | 5.5  |
| 262   | CEDAR     | 7    |
| 263   | CEDAR     | 7    |
| 264   | CEDAR     | 4.5  |
| 265   | CEDAR     | 6    |
| 266   | CEDAR     | 6    |
| 267   | CEDAR     | 9    |
| 268   | CEDAR     | 8    |
| 269   | CEDAR     | 6    |
| 270   | CEDAR     | 4.5  |
| 271   | CEDAR     | 8.5  |
| 272   | CEDAR     | 6.5  |
| 273   | CEDAR     | 8    |
| 274   | CEDAR     | 6    |
| 275   | CEDAR     | 7    |
| 276   | CEDAR     | 4.5  |
| 277   | CEDAR     | 6    |
| 278   | CEDAR     | 4.5  |
| 279   | CEDAR     | 5    |
| 280   | LIVE OAK  | 3    |
| 281   | CEDAR     | 6    |
| 282   | CEDAR     | 5    |
| 283   | CEDAR     | 4.5  |
| 284   | CEDAR     | 7    |
| 285   | CEDAR     | 6    |
| 286   | LIVE OAK  | 5    |
| 287   | CEDAR     | 6.5  |
| 288   | CEDAR     | 4    |
| 289   | CEDAR     | 4    |
| 290   | CEDAR     | 4.5  |
| 291   | CEDAR     | 5    |
| 292   | CEDAR     | 5    |
| 293   | CEDAR     | 3.5  |
| 294   | CEDAR     | 9    |
| 295   | CEDAR     | 4.5  |
| 296   | CEDAR     | 3    |
| 297   | CEDAR     | 6    |
| 298   | CEDAR     | 5    |
| 299   | CEDAR     | 5    |
| 300   | CEDAR     | 4.5  |
| 301   | CEDAR     | 5    |
| 302   | LIVE OAK  | 4    |
| 303   | CEDAR     | 4    |
| 304   | CEDAR     | 6    |
| 305   | CEDAR     | 6    |
| 306   | CEDAR     | 6.5  |
| 307   | CEDAR     | 6.5  |
| 308   | CEDAR     | 5    |
| 309   | CEDAR     | 5    |
| 310   | CEDAR     | 3    |
| 311   | CEDAR     | 4    |
| 312   | CEDAR     | 4.5  |
| 313   | CEDAR     | 4    |
| 314   | CEDAR     | 3    |

| TAG # | SPECIES | SIZE |
|-------|---------|------|
| 315   | CEDAR   | 6.5  |
| 316   | CEDAR   | 8    |
| 317   | CEDAR   | 6    |
| 318   | CEDAR   | 5    |
| 319   | CEDAR   | 3.5  |
| 320   | CEDAR   | 8.5  |
| 321   | CEDAR   | 7.5  |
| 322   | CEDAR   | 6    |
| 323   | CEDAR   | 5    |
| 324   | CEDAR   | 5    |
| 325   | CEDAR   | 6    |
| 326   | CEDAR   | 4.5  |
| 327   | CEDAR   | 5.5  |
| 328   | CEDAR   | 6    |
| 329   | CEDAR   | 4.5  |
| 330   | CEDAR   | 5.5  |
| 331   | CEDAR   | 3    |
| 332   | CEDAR   | 6    |
| 333   | CEDAR   | 5    |
| 334   | CEDAR   | 6    |
| 335   | CEDAR   | 6    |
| 336   | CEDAR   | 5    |
| 337   | CEDAR   | 5.5  |
| 338   | CEDAR   | 3    |
| 339   | CEDAR   | 4    |
| 340   | CEDAR   | 4.5  |
| 341   | CEDAR   | 5    |
| 342   | CEDAR   | 4.5  |
| 343   | CEDAR   | 5    |
| 344   | CEDAR   | 6    |
| 345   | CEDAR   | 6    |
| 346   | CEDAR   | 4    |
| 347   | CEDAR   | 5.5  |
| 348   | CEDAR   | 4    |
| 349   | CEDAR   | 5    |
| 350   | CEDAR   | 7    |
| 351   | CEDAR   | 4    |
| 352   | CEDAR   | 8    |
| 353   | CEDAR   | 5    |
| 354   | CEDAR   | 6    |
| 355   | CEDAR   | 6    |
| 356   | CEDAR   | 5.5  |
| 357   | CEDAR   | 8    |
| 358   | CEDAR   | 5.5  |
| 359   | CEDAR   | 5.5  |
| 360   | CEDAR   | 3.5  |
| 361   | CEDAR   | 3    |
| 362   | CEDAR   | 5    |
| 363   | CEDAR   | 5    |
| 364   | CEDAR   | 5    |
| 365   | CEDAR   | 4    |
| 366   | CEDAR   | 4    |
| 367   | CEDAR   | 4    |
| 368   | CEDAR   | 5    |
| 369   | CEDAR   | 3.5  |
| 370   | CEDAR   | 4    |
| 371   | CEDAR   | 4.5  |
| 372   | CEDAR   | 5.5  |
| 373   | CEDAR   | 4    |
| 374   | CEDAR   | 4    |
| 375   | CEDAR   | 5    |
| 376   | CEDAR   | 5    |
| 377   | CEDAR   | 4    |
| 378   | CEDAR   | 7    |
| 379   | CEDAR   | 5    |
| 380   | CEDAR   | 5    |
| 381   | CEDAR   | 4    |
| 382   | CEDAR   | 6    |
| 383   | CEDAR   | 7    |
| 384   | CEDAR   | 4    |
| 385   | CEDAR   | 4.5  |
| 386   | CEDAR   | 6    |
| 387   | CEDAR   | 5    |
| 388   | CEDAR   | 6    |
| 389   | CEDAR   | 4    |
| 390   | CEDAR   | 6    |
| 391   | CEDAR   | 4    |
| 392   | CEDAR   | 3.5  |
| 393   | CEDAR   | 8    |
| 394   | CEDAR   | 4    |
| 395   | CEDAR   | 4    |
| 396   | CEDAR   | 6    |
| 397   | CEDAR   | 5.5  |
| 398   | CEDAR   | 6    |
| 399   | CEDAR   | 8    |
| 400   | CEDAR   | 6    |

Total Cal. Inches: 2048



The user of this file agrees to assume all responsibility for any modifications to or use of this drawing file that is inconsistent with the requirements of the Rules and Regulations of the Texas Board of Architectural Examiners. No person may make any modifications to this electronic drawing file without the Landscape Architect's express written permission.



Development Services Dept  
Failure to schedule a fencing inspection prior to start of work may result in a stop work order or a penalty of \$1,000.00 or both. UDC §35-523 (h)(2)

It shall be the responsibility of the permit holder to maintain a copy of the approved tree plans, approved tree permit and the conditions of approval readily available at all times.

DEVELOPMENT SERVICES  
Tree Pre-Construction Meeting  
Required prior to Site Work

DEVELOPMENT SERVICES  
TREE PROTECTION SECTION  
REVIEWED FOR COMPLIANCE

OWNER  
**TTM DEVELOPMENT LLC**  
2025 Guadalupe Street Suite 260  
Austin, TX 78705

PROJECT TITLE  
**Hideaway Village Tree Preservation Plan Revisions**  
Cielo Vista Drive  
San Antonio, TX 78255

PROJECT NUMBER  
2026-036  
DRAWN BY: jh      CHECKED BY: jr

REVISIONS  
NUMBER    DATE    DESCRIPTION  
L            4/5/26    City Comments

SHEET TITLE  
**TREE INVENTORY**

DATE  
April 7, 2026  
SHEET NUMBER

**TP1.7**