

| WL# | WORK FUNCTION | COMMENTS |
|-----|------------------|--|
| 1 | NBU Install | 3" PVC Primary Riser(3-3"Conduits) 125' 3Ø 4/0 UD Primary Wire to WL2 3- 200Amp Cut outs with |
| 2 | NBU Install | 3PH SPL Primary Pull box 430' 3Ø 4/0 UD Primary Wire to WL24 123' 1Ø 10/ UD Primary Wire to WL4 |
| 3 | Customer Install | 1-3" PVC Stubout For Future Use(A phase) |
| | NBU Install | 80' 350 UD Secondary to WL38 |
| | Customer Install | Secondary Pull box |
| 4 | NBU Install | 1-3" PVC Stubout 75kVA 1Ø 120/240 Trdnr 140' 1Ø 10/ UD Primary Wire to WL6 48' 350 UD Secondary to WL3 65' 350 UD Secondary to WL37 |
| 5 | Customer Install | 2-3" PVC Stubouts |
| | NBU Install | 65' 350 UD Secondary to WL36 |
| | Customer Install | Secondary Pull box |
| 6 | NBU Install | 1-3" PVC Stubout 75kVA 1Ø 120/240 Trdnr 180' 1Ø 10/ UD Primary Wire to WL9 48' 350 UD Secondary to WL5 48' 350 UD Secondary to WL7 |
| 7 | Customer Install | 2-3" PVC Stubouts |
| | NBU Install | 65' 350 UD Secondary to WL35 |
| | Customer Install | Secondary Pull box |
| 8 | NBU Install | 1-3" PVC Stubout 65' 350 UD Secondary to WL34 |
| | Customer Install | Secondary Pull box |
| 9 | NBU Install | 1-3" PVC Stubout 75kVA 1Ø 120/240 Trdnr 250' 1Ø 10/ UD Primary Wire to WL12 48' 350 UD Secondary to WL8 88' 350 UD Secondary to WL10 |
| 10 | Customer Install | 2-3" PVC Stubouts |
| | Customer Install | Secondary Pull box |
| 11 | Customer Install | 2-3" PVC Stubouts |
| | Customer Install | Secondary Pull box |
| 12 | NBU Install | 2-3" PVC Stubouts 50kVA 1Ø 120/240 Trdnr 148' 1Ø 10/ UD Primary Wire to WL14 88' 350 UD Secondary to WL11 88' 350 UD Secondary to WL13 |
| 13 | Customer Install | 1-3" PVC Stubout |
| | Customer Install | Secondary Pull box |
| 14 | NBU Install | 2-3" PVC Stubouts 1PH SPL Primary Pull box OPEN POINT |
| 15 | NBU Install | 188' 1Ø 10/ UD Primary Wire to WL15 245' 1Ø 10/ UD Primary Wire to WL32 45-2 Wood Pole |
| 16 | NBU Install | 1-3" 1Ø PVC Primary Riser 70' 1Ø OH 1Ø ACSR Primary to WL16 Connect OH 1Ø to Existing Pole Change from B to C Phase |
| 17 | Customer Install | Secondary Pull box |
| 18 | NBU Install | 2-3" PVC Stubouts 75kVA 1Ø 120/240 Trdnr 185' 1Ø 10/ UD Primary Wire to WL21 48' 350 UD Secondary to WL17 48' 350 UD Secondary to WL19 65' 350 UD Secondary to WL30 |
| 19 | Customer Install | Secondary Pull box |
| 20 | NBU Install | 2-3" PVC Stubouts |
| | Customer Install | Secondary Pull box |
| 21 | NBU Install | 1-3" PVC Stubout 100kVA 1Ø 120/240 Trdnr 150' 1Ø 10/ UD Primary Wire to WL24 48' 350 UD Secondary to WL20 48' 350 UD Secondary to WL22 75' 350 UD Secondary to WL27 |
| 22 | Customer Install | 1-3" PVC Stubout |
| | NBU Install | 48' 350 UD Secondary to WL23 |
| | Customer Install | Secondary Pull box |
| 23 | NBU Install | 2-3" PVC Stubouts |
| | Customer Install | 75' 12-2 UD Wire to WL24 |
| | Customer Install | Secondary Pull box |
| 24 | NBU Install | 1-3" PVC Stubout 1- 1 1/4"PVC For Light 3PH SPL Primary Pull box 225' 3Ø 4/0 UD Primary Wire to WL25 Aluminum Street Light with LED Fixture |
| 25 | Customer Install | 1-3" PVC Stubout For Future Use(A phase) |
| 26 | NBU Install | Connect to New 3Ø Pull box |
| 27 | NBU Install | Stub out here For Future Use |
| | Customer Install | Secondary Pull box |
| 28 | Customer Install | 3-3" PVC Stubouts |
| | Customer Install | Secondary Pull box |
| 29 | NBU Install | 2-3" PVC Stubouts |
| | Customer Install | 75' 12-2 UD Wire to WL42 |
| | Customer Install | Secondary Pull box |
| 30 | NBU Install | 1-3" PVC Stubout 1- 1 1/4"PVC For Light 48' 350 UD Secondary to WL29 |
| | Customer Install | Secondary Pull box |
| 31 | Customer Install | 2-3" PVC Stubouts |
| | Customer Install | Secondary Pull box |
| 32 | NBU Install | 2-3" PVC Stubouts 50kVA 1Ø 120/240 Trdnr 205' 1Ø 10/ UD Primary Wire to WL18 48' 350 UD Secondary to WL31 90' 350 UD Secondary to WL33 |
| 33 | Customer Install | 1-3" PVC Stubout |
| | NBU Install | 65' 12-2 UD Wire to WL41 |
| | Customer Install | Secondary Pull box |
| 34 | NBU Install | 2-3" PVC Stubouts |
| | Customer Install | 1- 1 1/4"PVC For Light |
| | Customer Install | 80' 12-2 UD Wire to WL40 |
| | Customer Install | Secondary Pull box |
| 35 | Customer Install | 2-3" PVC Stubouts |
| | Customer Install | 1- 1 1/4"PVC For Light |
| | Customer Install | Secondary Pull box |
| 36 | NBU Install | 2-3" PVC Stubouts |
| | Customer Install | Aluminum Street Light with LED Fixture |
| 37 | Customer Install | Secondary Pull box |
| | Customer Install | 2-3" PVC Stubouts |
| | Customer Install | Secondary Pull box |
| 38 | NBU Install | 2-3" PVC Stubouts |
| | Customer Install | 80' 12-2 UD Wire to WL39 |
| | Customer Install | Secondary Pull box |
| 39 | NBU Install | 1-3" PVC Stubout 1- 1 1/4"PVC For Light Aluminum Street Light with LED Fixture |
| 40 | Customer Install | 160' 12-2 UD Wire to WL43 |
| | NBU Install | 1- 1 1/4"PVC For Light |
| | Customer Install | Aluminum Street Light with LED Fixture |
| 41 | NBU Install | Aluminum Street Light with LED Fixture |
| 42 | NBU Install | Aluminum Street Light with LED Fixture |
| 43 | NBU Install | Aluminum Street Light with LED Fixture |

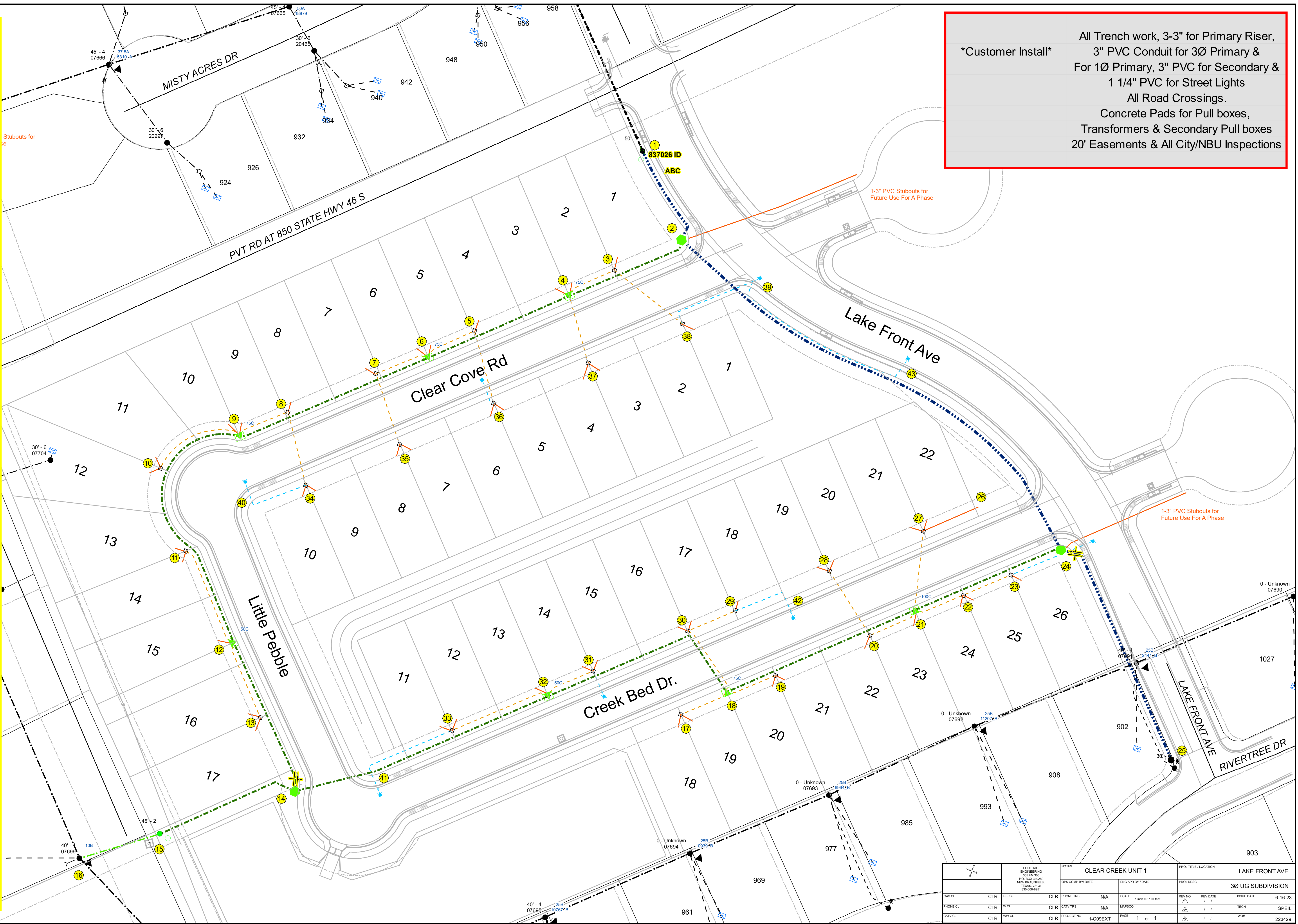

Customer Install

All Trench work, 3-3" for Primary Riser,
3" PVC Conduit for 3Ø Primary &
For 1Ø Primary, 3" PVC for Secondary &
1 1/4" PVC for Street Lights
All Road Crossings.
Concrete Pads for Pull boxes,
Transformers & Secondary Pull boxes
20' Easements & All City/NBU Inspections

| PROJECT TITLE / LOCATION | | LAKE FRONT AVE. | |
|--------------------------|-----|----------------------|-----|
| 3Ø UG SUBDIVISION | | | |
| DWG CL | CLR | ELE CL | CLR |
| PHONE CL | CLR | PHY CL | CLR |
| CATV CL | CLR | WW CL | CLR |
| PROJECT NO | | 1-C09EXT | |
| PAGE | | 1 OF 1 | |
| SCALE | | 1 inch = 37.50' feet | |
| DATE | | 6-16-23 | |
| TECH | | SPEIL | |
| WGR | | 223429 | |