

MATCHLINE H - SEE SHEET C6.03

CALL 154.255 ACRE TRACT
FLORIDA ROCK INDUSTRIES, INC.
(DOC. NO. 20180066654 OPR)

CONDUIT	SIZE/TYPE	MIN. DEPTH OF COVER
A (PRIMARY)	4-6" PVC (SCH 80)	36"
B (PRIMARY II)	3-6" PVC (SCH 40)	36"
C (SECONDARY)	2-6" PVC (SCH 40)	36"
D (DRAIN)	5-4" PVC (SCH 40)	36"
E (STREETLIGHT)	2-4" PVC (SCH 40)	36"

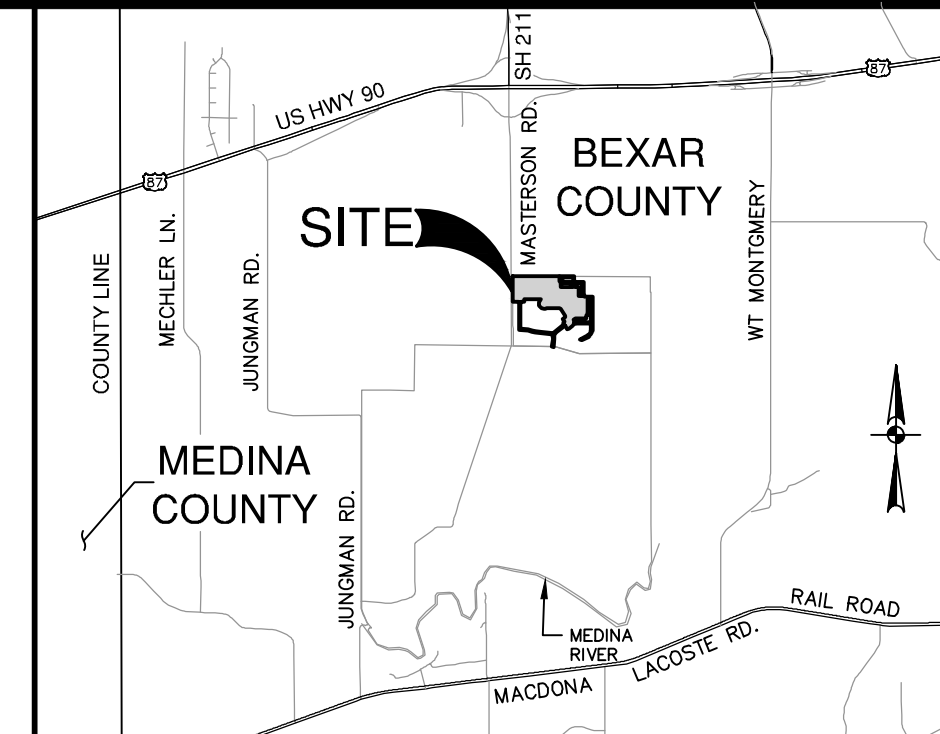

LOCATION MAP
NOT-TO-SCALE

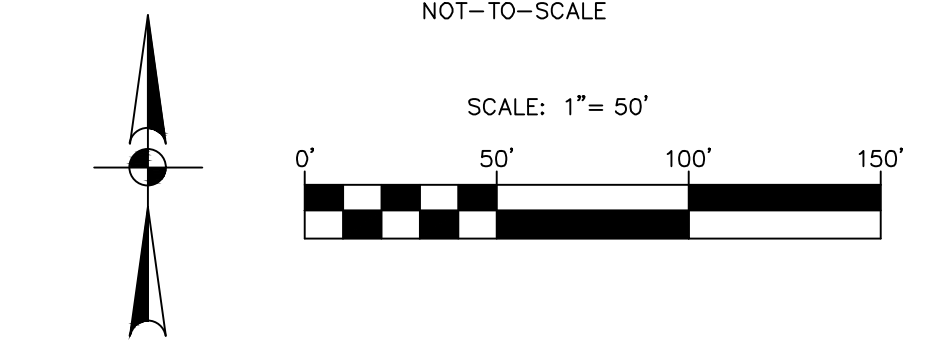

UTILITY LEGEND

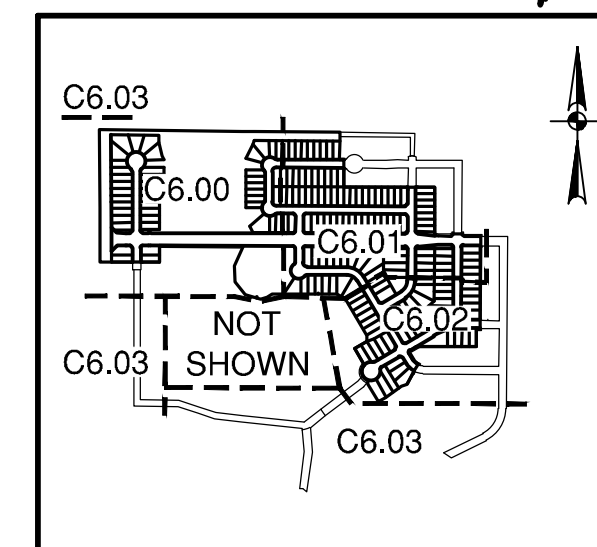
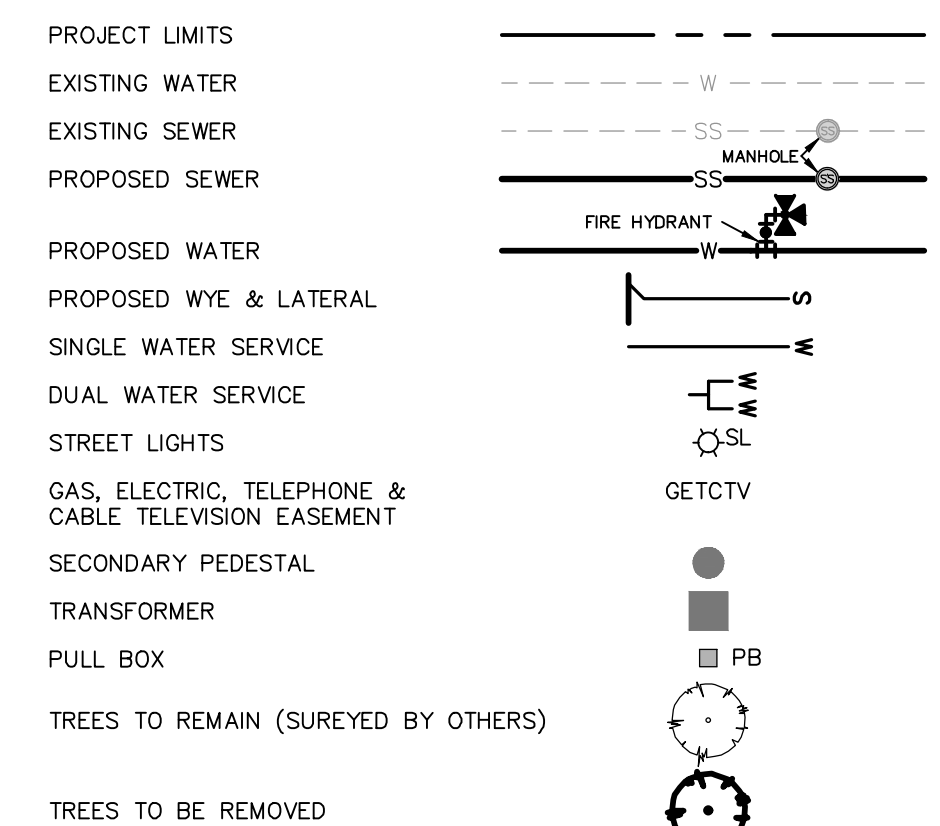

INDEX MAP
NOT-TO-SCALE

ROW PERMIT NOTE:

A BEXAR COUNTY PERMIT MUST BE OBTAINED BEFORE WORKING IN BEXAR COUNTY RIGHTS-OF-WAY.

CONDUIT NOTES:

- CONTRACTOR SHALL INSTALL PERMANENT MARKERS IN PROPOSED CURB WHERE CONDUITS CROSS THE ROADWAY (BOTH SIDES).
- CONDUITS SHALL BE PVC WITH MINIMUM BURY OF 36 INCHES BELOW PROPOSED FINISHED GRADE. SCHEDULE 80 TO BE USED FOR OPS CONDUITS, ALL OTHER CONDUITS ARE SCHEDULE 40.
- ALL CONDUITS SHALL BE EXTENDED BEHIND CURBS OR PROPOSED SIDEWALKS A MINIMUM OF 3 FEET AND CAPPED FOR FUTURE USE.
- ALL CONDUIT SLEEVES TO BE USED FOR ELECTRIC, GAS, OR TELECOMMUNICATION UTILITY CROSSINGS SHALL BE INSTALLED TO MEET OR EXCEED DESIGN REQUIREMENTS FOR THE UTILITY AGENCY WHICH THEY ARE SERVING, INCLUDING BUT NOT LIMITED TO THE DEPTH, TRENCH PLACEMENT, AND PROXIMITY TO OTHER UTILITIES. THE CONTRACTOR IS SOLELY RESPONSIBLE FOR VERIFYING AND INSTALLING THE CONDUIT SLEEVES TO MEET THESE SPECIFICATIONS INCLUDING COORDINATING WITH THE UTILITY AGENCY FOR ANY REQUIRED INSPECTIONS.

TRENCH EXCAVATION SAFETY PROTECTION:

CONTRACTOR AND/OR CONTRACTOR'S INDEPENDENTLY RETAINED EMPLOYEE OR STRUCTURAL DESIGN/ GEOTECHNICAL/ SAFETY/EQUIPMENT CONSULTANT, IF ANY, SHALL REVIEW THESE PLANS AND ANY AVAILABLE GEOTECHNICAL INFORMATION AND THE ANTICIPATED INSTALLATION SITES WITHIN THE PROJECT WORK AREA IN ORDER TO IMPLEMENT CONTRACTOR'S TRENCH EXCAVATION SAFETY PROTECTION SYSTEMS, PROGRAMS AND/OR PROCEDURES FOR THE PROJECT DESCRIBED IN THE CONTRACT DOCUMENTS. THE CONTRACTOR'S IMPLEMENTATION OF THESE SYSTEMS, PROGRAMS AND/OR PROCEDURES SHALL PROVIDE FOR ADEQUATE TRENCH EXCAVATION SAFETY PROTECTION THAT COMPLY WITH AS A MINIMUM, OSHA STANDARDS FOR TRENCH EXCAVATIONS. SPECIFICALLY, CONTRACTOR AND/OR CONTRACTOR'S INDEPENDENTLY RETAINED EMPLOYEE OR SAFETY CONSULTANT SHALL IMPLEMENT A TRENCH SAFETY PROGRAM IN ACCORDANCE WITH OSHA STANDARDS GOVERNING THE PRESENCE AND ACTIVITIES OF INDIVIDUALS WORKING IN AND AROUND TRENCH EXCAVATION.

CAUTION!!

CONTRACTOR SHALL BE REQUIRED TO LOCATE ALL PUBLIC OR PRIVATE UTILITIES INCLUDING BUT NOT LIMITING TO: WATER, SEWER, TELEPHONE AND FIBER OPTIC LINES, SITE LIGHTING ELECTRICAL, SECONDARY ELECTRICAL, PRIMARY ELECTRICAL DISTRIBUTION, LANDSCAPE IRRIGATION FACILITIES, AND GAS LINES. ANY UTILITY CONFLICTS THAT ARISE SHOULD BE COMMUNICATED TO THE ENGINEER IMMEDIATELY AND PRIOR TO CONSTRUCTION. THE CONTRACTOR SHALL CONTACT 1-800-DIG-TESS A MINIMUM OF 48 HOURS PRIOR TO THE START OF CONSTRUCTION. ANY DAMAGE TO EXISTING UTILITIES SHALL BE THE SOLE RESPONSIBILITY OF THE CONTRACTOR AND THE REPAIR SHALL BE AT CONTRACTOR'S SOLE EXPENSE WHETHER THE UTILITY IS SHOWN ON THESE PLANS OR NOT.

DATE	
NO.	REVISION

PAPE-DAWSON
2000 NW LOOP 410 I SAN ANTONIO, TX 78213 I 210.375.9000
TEXAS SURVEYING FIRM #470 I TEXAS SURVEYING FIRM #10028800

ESPINO TRACT UNIT 1
SAN ANTONIO, TEXAS
CONDUIT PLAN

PLAT NO. 25-11800194
JOB NO. 13240-04
DATE NOV 2025
DESIGNER PW
CHECKED DW DRAWN JV
SHEET 1 OF 4

Notes: Nov 17, 2025, 1:44pm User ID: r060160-gp@pape-dawson.com
File: C:\Users\jcc@pape-dawson.com\OneDrive\Documents\25-11800194\Conduit Plan-1324004.dwg

THIS DOCUMENT HAS BEEN PRODUCED FROM MATERIAL THAT WAS STORED AND/OR TRANSMITTED ELECTRONICALLY AND MAY HAVE BEEN INADVERTENTLY ALTERED. RELY ONLY ON FINAL HARD COPY MATERIALS BEARING THE CONSULTANTS ORIGINAL SIGNATURE AND SEAL. AERIAL IMAGERY PROVIDED BY GOOGLE/UNLESS OTHERWISE NOTED. Imagery © 2016, CAPOCO, Digital Globe, Texas Orthology Program, USDA Farm Service Agency.

CALLED 154.255 ACRE TRACT
FLORIDA ROCK INDUSTRIES, INC.
(DOC. NO. 2018006654 OPR)

CALLED 49.922 ACRE TRACT
MASTERTSON 90 INVESTORS LP
(DOC. NO. 20240032235 OPR)

CALLED 49.922 ACRE TRACT
MASTERTSON 90 INVESTORS LP
(DOC. NO. 20240032235 OPR)

CALLED 49.922 ACRE TRACT
MASTERTSON 90 INVESTORS LP
(DOC. NO. 20240032235 OPR)

CALLED 49.922 ACRE TRACT
MASTERTSON 90 INVESTORS LP
(DOC. NO. 20240032235 OPR)

CALLED 191.768 ACRE TRACT
MASTERTSON 90 INVESTORS LP
(DOC. NO. 20230221154 OPR)

CONDUIT	SIZE/TYPE	MIN. DEPTH OF COVER
A (PRIMARY)	4-6" PVC (SCH 80) 3-4" PVC (SCH 40)	36"
B (PRIMARY II)	3-6" PVC (SCH 80) 2-4" PVC (SCH 40)	36"
C (SECONDARY)	2-6" PVC (SCH 80) 2-4" PVC (SCH 40)	36"
D (DRAIN)	5-6" PVC (SCH 80) 4-4" PVC (SCH 40)	36"
E (STREETLIGHT)	2-4" PVC (SCH 40)	36"

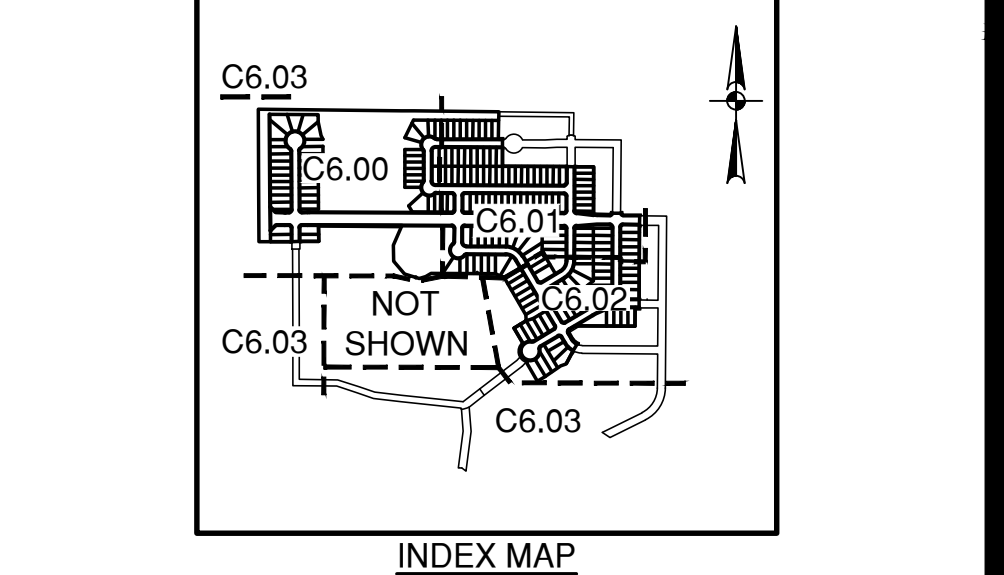
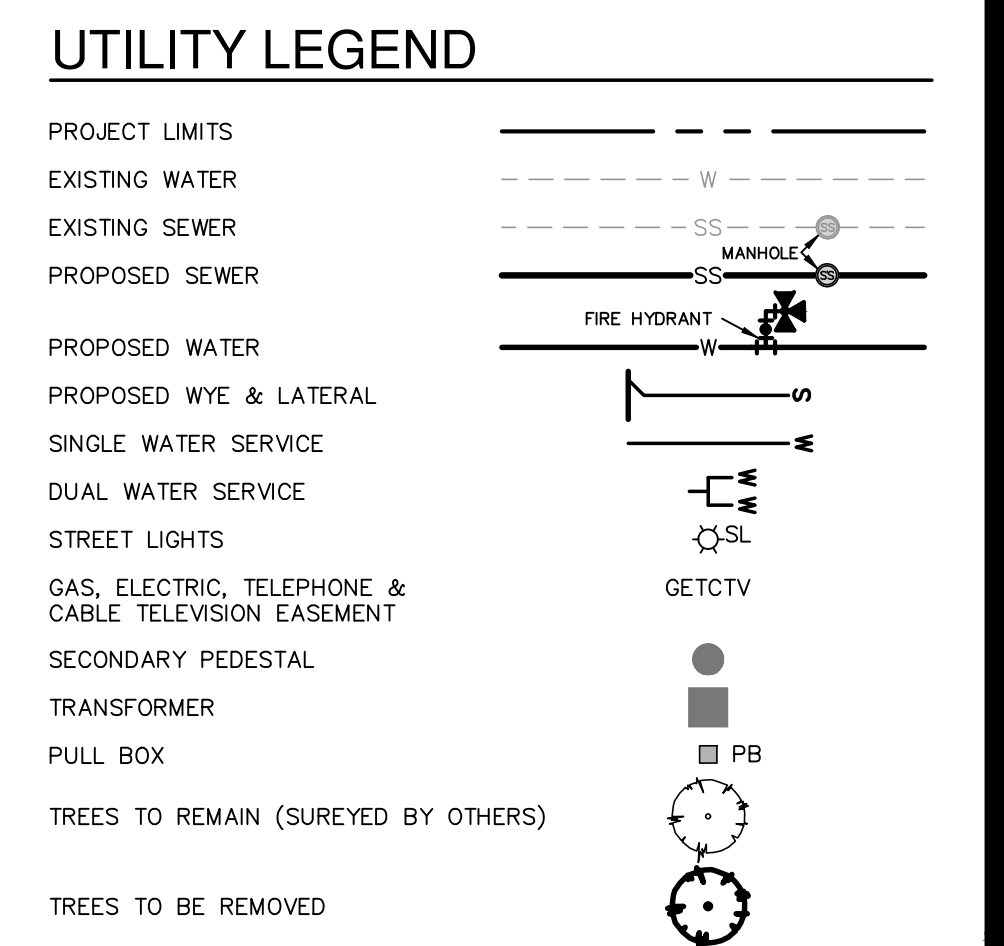
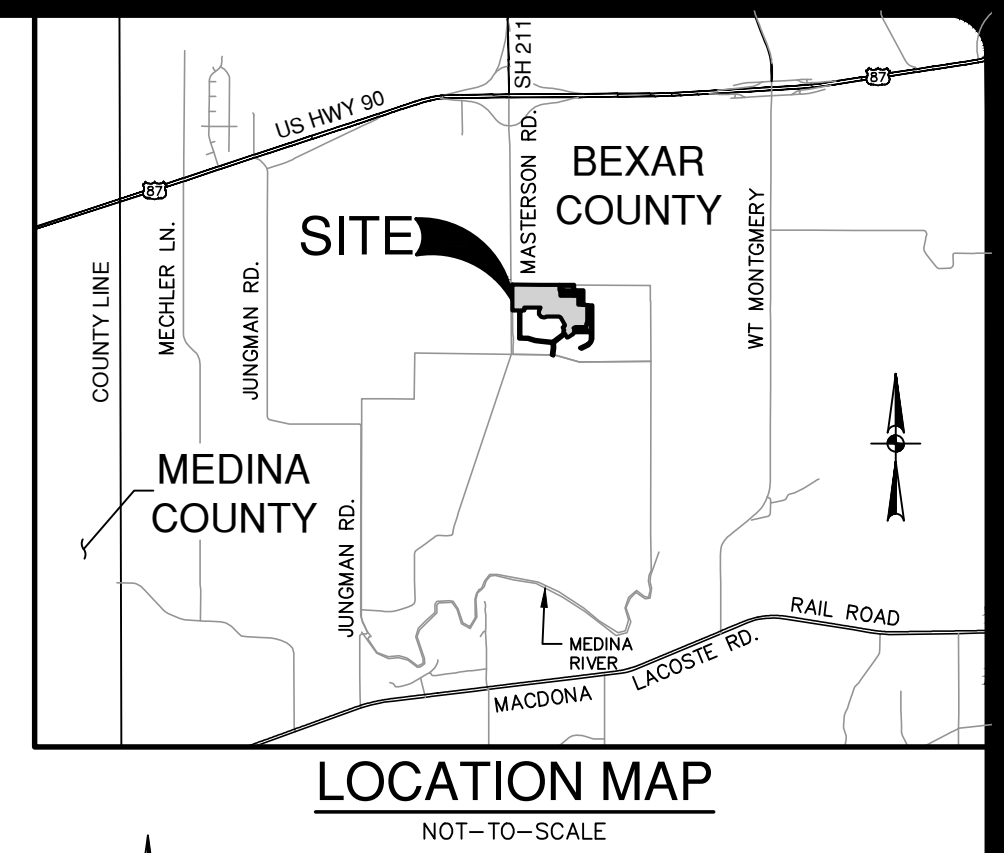

ROW PERMIT NOTE:
A BEXAR COUNTY PERMIT MUST BE OBTAINED BEFORE WORKING IN BEXAR COUNTY RIGHTS-OF-WAY.

- CONDUIT NOTES:**
- CONTRACTOR SHALL INSTALL PERMANENT MARKERS IN PROPOSED CURB WHERE CONDUITS CROSS THE ROADWAY (BOTH SIDES).
 - CONDUITS SHALL BE PVC WITH MINIMUM BURY OF 36 INCHES BELOW PROPOSED FINISHED GRADE. SCHEDULE 80 TO BE USED FOR OPS CONDUITS, ALL OTHER CONDUITS ARE SCHEDULE 40.
 - ALL CONDUITS SHALL BE EXTENDED BEHIND CURBS OR PROPOSED SIDEWALKS A MINIMUM OF 3 FEET AND CAPPED FOR FUTURE USE.
 - ALL CONDUIT SLEEVES TO BE USED FOR ELECTRIC, GAS, OR TELECOMMUNICATION UTILITY CROSSINGS SHALL BE INSTALLED TO MEET OR EXCEED DESIGN REQUIREMENTS FOR THE UTILITY AGENCY WHICH THEY ARE SERVING, INCLUDING BUT NOT LIMITED TO THE DEPTH, TRENCH PLACEMENT, AND PROXIMITY TO OTHER UTILITIES. THE CONTRACTOR IS SOLELY RESPONSIBLE FOR VERIFYING AND INSTALLING THE CONDUIT SLEEVES TO MEET THESE SPECIFICATIONS INCLUDING COORDINATING WITH THE UTILITY AGENCY FOR ANY REQUIRED INSPECTIONS.

TRENCH EXCAVATION SAFETY PROTECTION:
CONTRACTOR AND/OR CONTRACTOR'S INDEPENDENTLY RETAINED EMPLOYEE OR STRUCTURAL DESIGN/ GEOTECHNICAL/ SAFETY/EQUIPMENT CONSULTANT, IF ANY, SHALL REVIEW THESE PLANS AND ANY AVAILABLE GEOTECHNICAL INFORMATION AND THE ANTICIPATED INSTALLATION SITES WITHIN THE PROJECT WORK AREA IN ORDER TO IMPLEMENT CONTRACTOR'S TRENCH EXCAVATION SAFETY PROTECTION SYSTEMS, PROGRAMS AND/OR PROCEDURES FOR THE PROJECT DESCRIBED IN THE CONTRACT DOCUMENTS. THE CONTRACTOR'S IMPLEMENTATION OF THESE SYSTEMS, PROGRAMS AND/OR PROCEDURES SHALL PROVIDE FOR ADEQUATE TRENCH EXCAVATION SAFETY PROTECTION THAT COMPLY WITH AS A MINIMUM, OSHA STANDARDS FOR TRENCH EXCAVATIONS. SPECIFICALLY, CONTRACTOR AND/OR CONTRACTOR'S INDEPENDENTLY RETAINED EMPLOYEE OR SAFETY CONSULTANT SHALL IMPLEMENT A TRENCH SAFETY PROGRAM IN ACCORDANCE WITH OSHA STANDARDS GOVERNING THE PRESENCE AND ACTIVITIES OF INDIVIDUALS WORKING IN AND AROUND TRENCH EXCAVATION.

CAUTION!!
CONTRACTOR SHALL BE REQUIRED TO LOCATE ALL PUBLIC OR PRIVATE UTILITIES INCLUDING BUT NOT LIMITING TO: WATER, SEWER, TELEPHONE AND FIBER OPTIC LINES, SITE LIGHTING ELECTRIC, SECONDARY ELECTRIC, PRIMARY ELECTRICAL DISTRIBUTION, LANDSCAPE IRRIGATION FACILITIES, AND GAS LINES. ANY UTILITY CONFLICTS THAT ARISE SHOULD BE COMMUNICATED TO THE ENGINEER IMMEDIATELY AND PRIOR TO CONSTRUCTION. THE CONTRACTOR SHALL CONTACT 1-800-DIG-TESS A MINIMUM OF 48 HOURS PRIOR TO THE START OF CONSTRUCTION. ANY DAMAGE TO EXISTING UTILITIES SHALL BE THE SOLE RESPONSIBILITY OF THE CONTRACTOR AND THE REPAIR SHALL BE AT CONTRACTOR'S SOLE EXPENSE WHETHER THE UTILITY IS SHOWN ON THESE PLANS OR NOT.

NO.	REVISION	DATE

PAPE-DAWSON
2000 NW LOOP 410 | SAN ANTONIO, TX 78213 | 210.375.9000
TEXAS SURVEYING FIRM #10028800

ESPINO TRACT UNIT 1
SAN ANTONIO, TEXAS
CONDUIT PLAN

PLAT NO.	25-11800194
JOB NO.	13240-04
DATE	NOV 2025
DESIGNER	PW
CHECKED	DW DRAWN JV
SHEET	2 OF 4

Notes: Nov 17, 2025, 1:45pm User ID: r060616-gp@pds.com File: C:\Users\jcc@pds.com\OneDrive\Work\Projects\13240\CD\Conduit Plan-1324004.dwg

CONDUIT	SIZE/TYPE	MIN. DEPTH OF COVER
A (PRIMARY)	4-6" PVC (SCH 80) 3-4" PVC (SCH 40)	36"
B (PRIMARY II)	3-6" PVC (SCH 80) 2-4" PVC (SCH 40)	36"
C (SECONDARY)	2-6" PVC (SCH 80) 2-4" PVC (SCH 40)	36"
D (DRAIN)	5-6" PVC (SCH 80) 4-4" PVC (SCH 40)	36"
E (STREETLIGHT)	2-4" PVC (SCH 40)	36"

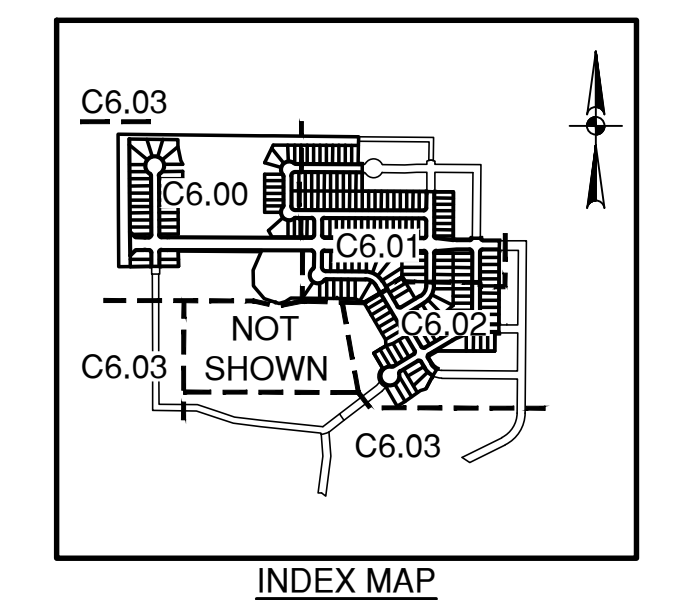
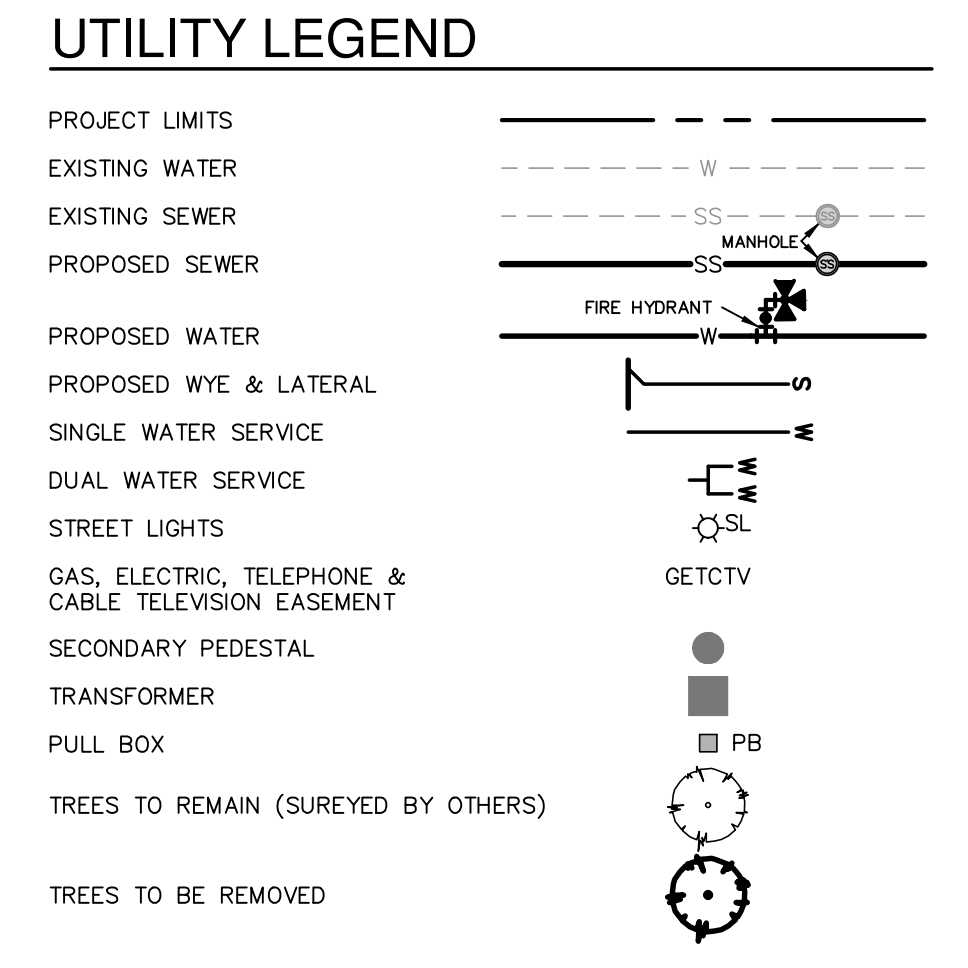
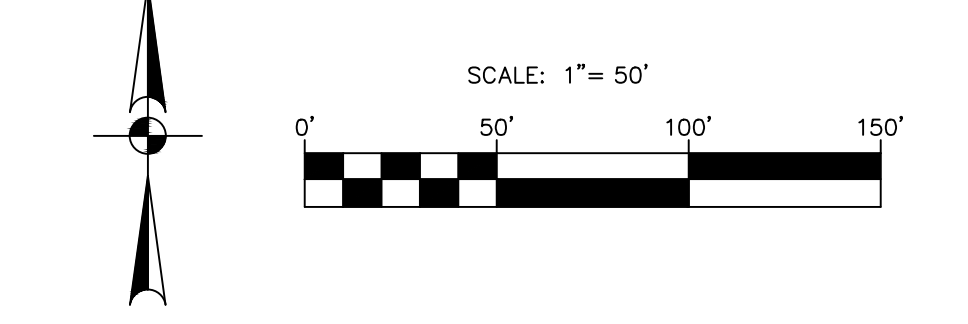
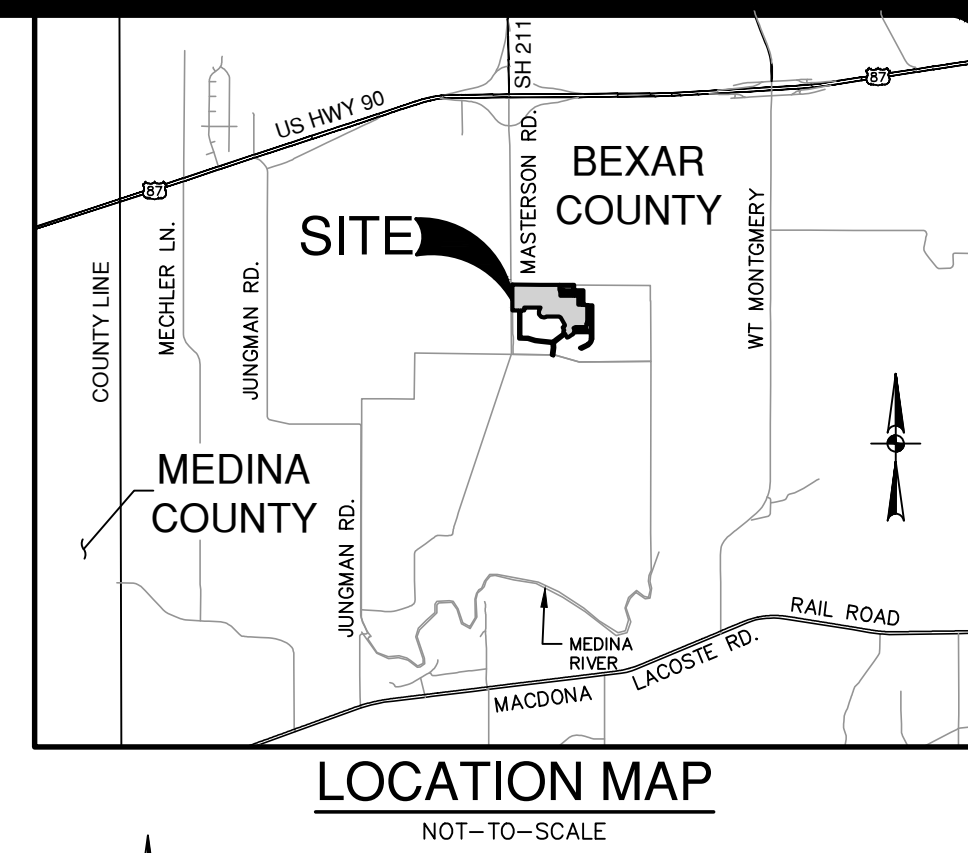

ROW PERMIT NOTE:
A BEXAR COUNTY PERMIT MUST BE OBTAINED BEFORE WORKING IN BEXAR COUNTY RIGHTS-OF-WAY.

- CONDUIT NOTES:**
- CONTRACTOR SHALL INSTALL PERMANENT MARKERS IN PROPOSED CURB WHERE CONDUITS CROSS THE ROADWAY (BOTH SIDES).
 - CONDUITS SHALL BE PVC WITH MINIMUM BURY OF 36 INCHES BELOW PROPOSED FINISHED GRADE. SCHEDULE 80 TO BE USED FOR OPS CONDUITS, ALL OTHER CONDUITS ARE SCHEDULE 40.
 - ALL CONDUITS SHALL BE EXTENDED BEHIND CURBS OR PROPOSED SIDEWALKS A MINIMUM OF 3 FEET AND CAPPED FOR FUTURE USE.
 - ALL CONDUIT SLEEVES TO BE USED FOR ELECTRIC, GAS, OR TELECOMMUNICATION UTILITY CROSSINGS SHALL BE INSTALLED TO MEET OR EXCEED DESIGN REQUIREMENTS FOR THE UTILITY AGENCY WHICH THEY ARE SERVING, INCLUDING BUT NOT LIMITED TO THE DEPTH, TRENCH PLACEMENT, AND PROXIMITY TO OTHER UTILITIES. THE CONTRACTOR IS SOLELY RESPONSIBLE FOR VERIFYING AND INSTALLING THE CONDUIT SLEEVES TO MEET THESE SPECIFICATIONS INCLUDING COORDINATING WITH THE UTILITY AGENCY FOR ANY REQUIRED INSPECTIONS.

TRENCH EXCAVATION SAFETY PROTECTION:
CONTRACTOR AND/OR CONTRACTOR'S INDEPENDENTLY RETAINED EMPLOYEE OR STRUCTURAL DESIGN/ GEOTECHNICAL/ SAFETY/EQUIPMENT CONSULTANT, IF ANY, SHALL REVIEW THESE PLANS AND ANY AVAILABLE GEOTECHNICAL INFORMATION AND THE ANTICIPATED INSTALLATION SITES WITHIN THE PROJECT WORK AREA IN ORDER TO IMPLEMENT CONTRACTOR'S TRENCH EXCAVATION SAFETY PROTECTION SYSTEMS, PROGRAMS AND/OR PROCEDURES FOR THE PROJECT DESCRIBED IN THE CONTRACT DOCUMENTS. THE CONTRACTOR'S IMPLEMENTATION OF THESE SYSTEMS, PROGRAMS AND/OR PROCEDURES SHALL PROVIDE FOR ADEQUATE TRENCH EXCAVATION SAFETY PROTECTION THAT COMPLY WITH AS A MINIMUM, OSHA STANDARDS FOR TRENCH EXCAVATIONS. SPECIFICALLY, CONTRACTOR AND/OR CONTRACTOR'S INDEPENDENTLY RETAINED EMPLOYEE OR SAFETY CONSULTANT SHALL IMPLEMENT A TRENCH SAFETY PROGRAM IN ACCORDANCE WITH OSHA STANDARDS GOVERNING THE PRESENCE AND ACTIVITIES OF INDIVIDUALS WORKING IN AND AROUND TRENCH EXCAVATION.

CAUTION!!
CONTRACTOR SHALL BE REQUIRED TO LOCATE ALL PUBLIC OR PRIVATE UTILITIES INCLUDING BUT NOT LIMITING TO: WATER, SEWER, TELEPHONE AND FIBER OPTIC LINES, SITE LIGHTING ELECTRIC, SECONDARY ELECTRIC, PRIMARY ELECTRICAL DISTRIBUTION, LANDSCAPE IRRIGATION FACILITIES, AND GAS LINES. ANY UTILITY CONFLICTS THAT ARISE SHOULD BE COMMUNICATED TO THE ENGINEER IMMEDIATELY AND PRIOR TO CONSTRUCTION. THE CONTRACTOR SHALL CONTACT 1-800-DIG-TESTS A MINIMUM OF 48 HOURS PRIOR TO THE START OF CONSTRUCTION. ANY DAMAGE TO EXISTING UTILITIES SHALL BE THE SOLE RESPONSIBILITY OF THE CONTRACTOR AND THE REPAIR SHALL BE AT CONTRACTOR'S SOLE EXPENSE WHETHER THE UTILITY IS SHOWN ON THESE PLANS OR NOT.

NO.	REVISION	DATE

PAPE-DAWSON
2000 NW LOOP 410 | SAN ANTONIO, TX 78213 | 210.375.9000
TEXAS SURVEYING FIRM #470 | TEXAS SURVEYING FIRM #10028800

ESPINO TRACT UNIT 1
SAN ANTONIO, TEXAS

CONDUIT PLAN

PLAT NO.	25-11800194
JOB NO.	13240-04
DATE	NOV 2025
DESIGNER	PW
CHECKED	DW DRAWN JV
SHEET	3 OF 4

Notes: Nov 17, 2025, 1:45pm User ID: r001616-gp161616
 File: C:\Users\jg001616\OneDrive\Documents\ESPO Tract\ESPO Conduit Plan-1324004.dwg

THIS DOCUMENT HAS BEEN PRODUCED FROM MATERIAL THAT WAS STORED AND/OR TRANSMITTED ELECTRONICALLY AND MAY HAVE BEEN INADVERTENTLY ALTERED. RELY ONLY ON FINAL HARDCOPY MATERIALS BEARING THE CONSULTANTS ORIGINAL SIGNATURE AND SEAL. AERIAL IMAGERY PROVIDED BY GOOGLE; UNLESS OTHERWISE NOTED. Imagery © 2016, CAPOOL/Digital Globe, Texas Orthology Program, USDA Farm Service Agency.

MATCHLINE G - SEE THIS SHEET

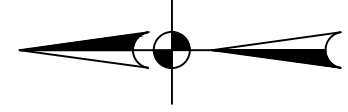

CALLED 191.768 ACRE TRACT
MASTERTSON 90 INVESTORS LP
(DOC. NO. 20230221154 OPR)

MATCHLINE B - SEE SHEET C6.00

VARIABLE WIDTH SANITARY SEWER
EASEMENT, ENTIRE EASEMENT TO
EXPIRE UPON INCORPORATION INTO
FUTURE PLATTED PUBLIC
RIGHT-OF-WAY.

CALLED 191.768 ACRE TRACT
MASTERTSON 90 INVESTORS LP
(DOC. NO. 20230221154 OPR)

VARIABLE WIDTH SANITARY SEWER
EASEMENT, ENTIRE EASEMENT TO
EXPIRE UPON INCORPORATION INTO
FUTURE PLATTED PUBLIC
RIGHT-OF-WAY.

100 YR ULTIMATE
DEVELOPMENT/
CLOMR FLOODPLAIN

VARIABLE WIDTH SANITARY SEWER
EASEMENT, ENTIRE EASEMENT TO
EXPIRE UPON INCORPORATION
INTO FUTURE PLATTED PUBLIC
RIGHT-OF-WAY.

276 L.F. CONCRETE ENCASEMENT

100 YR ULTIMATE
DEVELOPMENT/
CLOMR FLOODPLAIN

VARIABLE WIDTH SANITARY SEWER
EASEMENT, ENTIRE EASEMENT TO
EXPIRE UPON INCORPORATION INTO
FUTURE PLATTED PUBLIC
RIGHT-OF-WAY.

CALLED 191.768 ACRE TRACT
MASTERTSON 90 INVESTORS LP
(DOC. NO. 20230221154 OPR)

100 YR ULTIMATE
DEVELOPMENT/
CLOMR FLOODPLAIN

212 L.F. CONCRETE ENCASEMENT

VARIABLE WIDTH SANITARY SEWER
EASEMENT, ENTIRE EASEMENT TO
EXPIRE UPON INCORPORATION INTO
FUTURE PLATTED PUBLIC
RIGHT-OF-WAY.

VARIABLE WIDTH
SANITARY SEWER EASEMENT
(SEPARATE INSTRUMENT)
(SAWS PARCEL #P25-087)

EXISTING DIRT ROAD

30' VARIABLE WIDTH
SANITARY SEWER EASEMENT
(DOC. NO. 20220160175 OPR)

CONDUIT	SIZE/TYPER	MIN. DEPTH OF COVER
A	4-6" PVC (SCH 80)	36"
(PRIMARY)	3-4" PVC (SCH 40)	36"
B	3-6" PVC (SCH 80)	36"
(PRIMARY II)	2-4" PVC (SCH 40)	36"
C	2-6" PVC (SCH 80)	36"
(SECONDARY)	2-4" PVC (SCH 40)	36"
D	3-4" PVC (SCH 80)	36"
(DRAIN)	4-4" PVC (SCH 40)	36"
E	2-4" PVC (SCH 40)	36"
(STREETLIGHT)		

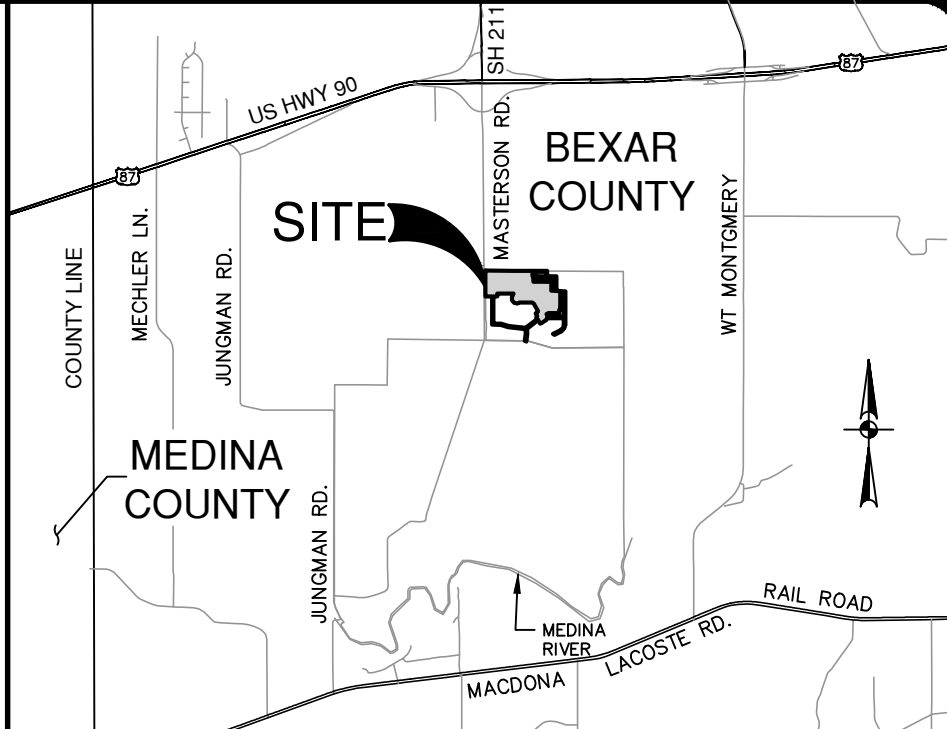

LOCATION MAP

NOT-TO-SCALE

SCALE: 1" = 50'



UTILITY LEGEND

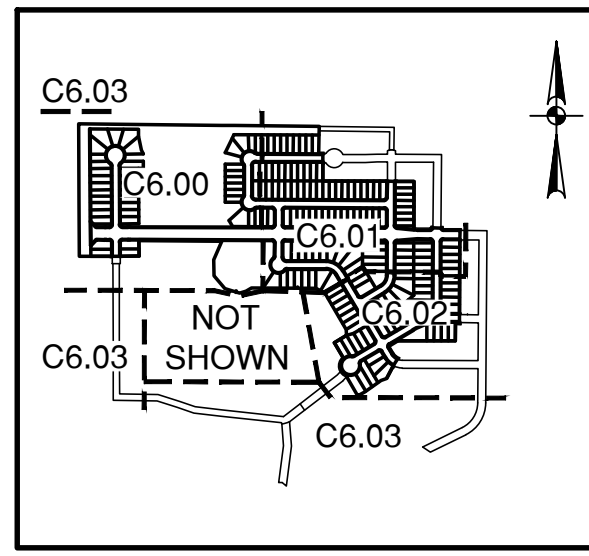
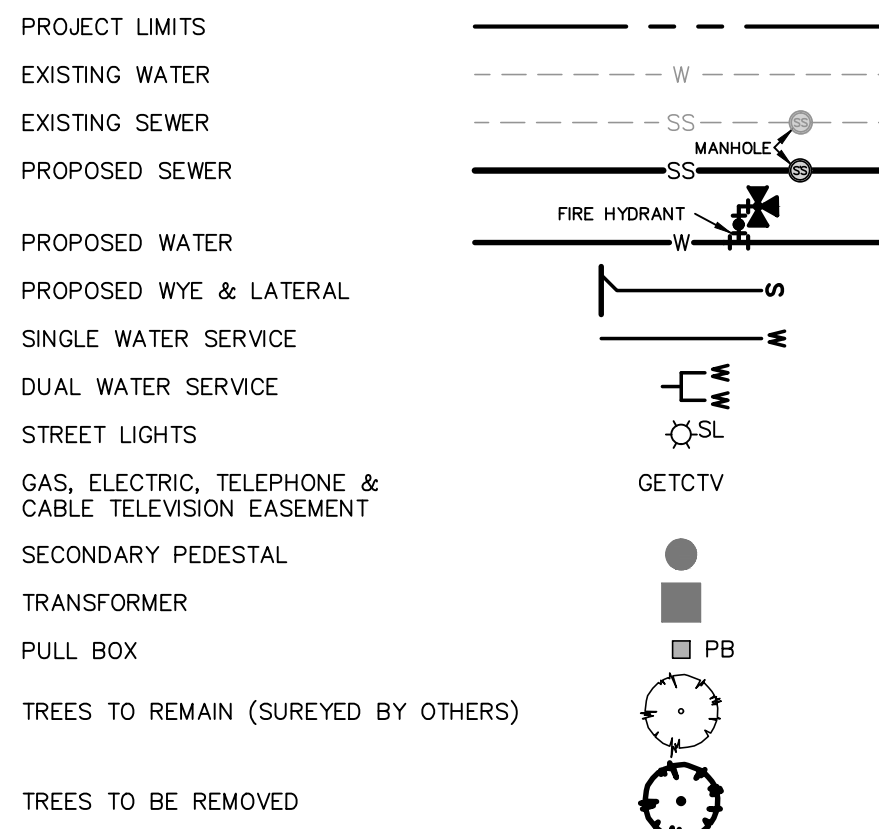

INDEX MAP

NOT-TO-SCALE

ROW PERMIT NOTE:

A BEXAR COUNTY PERMIT MUST BE OBTAINED BEFORE WORKING IN BEXAR COUNTY RIGHTS-OF-WAY.

CONDUIT NOTES:

- CONTRACTOR SHALL INSTALL PERMANENT MARKERS IN PROPOSED CURB WHERE CONDUITS CROSS THE ROADWAY (BOTH SIDES).
- CONDUITS SHALL BE PVC WITH MINIMUM BURY OF 36 INCHES BELOW PROPOSED FINISHED GRADE. SCHEDULE 80 TO BE USED FOR OPS CONDUITS, ALL OTHER CONDUITS ARE SCHEDULE 40.
- ALL CONDUITS SHALL BE EXTENDED BEHIND CURBS OR PROPOSED SIDEWALKS A MINIMUM OF 3 FEET AND CAPPED FOR FUTURE USE.
- ALL CONDUIT SLEEVES TO BE USED FOR ELECTRIC, GAS, OR TELECOMMUNICATION UTILITY CROSSINGS SHALL BE INSTALLED TO MEET OR EXCEED DESIGN REQUIREMENTS FOR THE UTILITY AGENCY WHICH THEY ARE SERVING, INCLUDING BUT NOT LIMITED TO THE DEPTH, TRENCH PLACEMENT, AND PROXIMITY TO OTHER UTILITIES. THE CONTRACTOR IS SOLELY RESPONSIBLE FOR VERIFYING AND INSTALLING THE CONDUIT SLEEVES TO MEET THESE SPECIFICATIONS INCLUDING COORDINATING WITH THE UTILITY AGENCY FOR ANY REQUIRED INSPECTIONS.

TRENCH EXCAVATION SAFETY PROTECTION:

CONTRACTOR AND/OR CONTRACTOR'S INDEPENDENTLY RETAINED EMPLOYEE OR STRUCTURAL DESIGN/ GEOTECHNICAL/ SAFETY/EQUIPMENT CONSULTANT, IF ANY, SHALL REVIEW THESE PLANS AND ANY AVAILABLE GEOTECHNICAL INFORMATION AND THE ANTICIPATED INSTALLATION SITES WITHIN THE PROJECT WORK AREA IN ORDER TO IMPLEMENT CONTRACTOR'S TRENCH EXCAVATION SAFETY PROTECTION SYSTEMS, PROGRAMS AND/OR PROCEDURES FOR THE PROJECT DESCRIBED IN THE CONTRACT DOCUMENTS. THE CONTRACTOR'S IMPLEMENTATION OF THESE SYSTEMS, PROGRAMS AND/OR PROCEDURES SHALL PROVIDE FOR ADEQUATE TRENCH EXCAVATION SAFETY PROTECTION THAT COMPLY WITH AS A MINIMUM, OSHA STANDARDS FOR TRENCH EXCAVATIONS. SPECIFICALLY, CONTRACTOR AND/OR CONTRACTOR'S INDEPENDENTLY RETAINED EMPLOYEE OR SAFETY CONSULTANT SHALL IMPLEMENT A TRENCH SAFETY PROGRAM IN ACCORDANCE WITH OSHA STANDARDS GOVERNING THE PRESENCE AND ACTIVITIES OF INDIVIDUALS WORKING IN AND AROUND TRENCH EXCAVATION.

CAUTION!!

CONTRACTOR SHALL BE REQUIRED TO LOCATE ALL PUBLIC OR PRIVATE UTILITIES INCLUDING BUT NOT LIMITING TO: WATER, SEWER, TELEPHONE AND FIBER OPTIC LINES, SITE LIGHTING ELECTRIC, SECONDARY ELECTRIC, PRIMARY ELECTRICAL DISTRIBUTION, LANDSCAPE IRRIGATION FACILITIES, AND GAS LINES. ANY UTILITY CONFLICTS THAT ARISE SHOULD BE COMMUNICATED TO THE ENGINEER IMMEDIATELY AND PRIOR TO CONSTRUCTION. THE CONTRACTOR SHALL CONTACT 1-800-DIG-TESTS A MINIMUM OF 48 HOURS PRIOR TO THE START OF CONSTRUCTION. ANY DAMAGE TO EXISTING UTILITIES SHALL BE THE SOLE RESPONSIBILITY OF THE CONTRACTOR AND THE REPAIR SHALL BE AT CONTRACTOR'S SOLE EXPENSE WHETHER THE UTILITY IS SHOWN ON THESE PLANS OR NOT.

NO.	REVISION	DATE

PAPE-DAWSON
2000 NW LOOP 410 | SAN ANTONIO, TX 78213 | 210.375.9000
TEXAS SURVEYING FIRM #10028800

ESPINO TRACT UNIT 1
SAN ANTONIO, TEXAS
CONDUIT PLAN

PLAT NO. 25-11800194
JOB NO. 13240-04
DATE NOV 2025
DESIGNER PW
CHECKED DW DRAWN JV
SHEET 4 OF 4

Notes: Nov 17, 2025, 1:45pm, User ID: rosaflo@pape-dawson.com, File: C:\Users\rosaflo\OneDrive\Documents\250194\Conduit Plan-1324004.dwg

THIS DOCUMENT HAS BEEN PRODUCED FROM MATERIAL THAT WAS STORED AND/OR TRANSMITTED ELECTRONICALLY AND MAY HAVE BEEN INADVERTENTLY ALTERED. RELY ONLY ON FINAL HARDCOPY MATERIALS BEARING THE CONSULTANTS ORIGINAL SIGNATURE AND SEAL. AERIAL IMAGERY PROVIDED BY GOOGLE; UNLESS OTHERWISE NOTED. Imagery © 2016, CAPOOL Digital Globe, Texas Orthology Program, USDA Farm Service Agency.