

Brooke Paup, *Chairwoman*
Bobby Janecka, *Commissioner*
Catarina R. Gonzales, *Commissioner*
Kelly Keel, *Executive Director*



TEXAS COMMISSION ON ENVIRONMENTAL QUALITY

Protecting Texas by Reducing and Preventing Pollution

May 13, 2026

Kim Keefer, P.E.
PAPE-DAWSON ENGINEERS
800 E. Sonterra Blvd., Suite 400
San Antonio, TX 78258

Re: Municipal Operations & Consulting
Guajolote East Lift Station and Force Main
Permit No. WQ0016171-001
WWPR Log No. 0526/038
CN605108091, RN111506457
Bexar County

Dear Ms. Keefer:

We received the project summary transmittal letter dated 05/05/2026.

The Texas Commission on Environmental Quality (TCEQ) rules which regulate the design, installation, and testing of domestic wastewater treatment projects are found in 30 TAC, Chapter 217, titled Design Criteria for Wastewater Systems.

Section 217.6(d), relating to case-by-case reviews, states in part that upon receipt of a summary transmittal letter, the executive director may approve of the project without reviewing a complete set of plans and specifications.

Under the authority of 30 TAC §217.6(e), a technical review of complete plans and specifications for this project is not required, and **the project proposed in the summary transmittal letter is approved for construction. Please note that this conditional approval does not relieve the applicant of any responsibilities to obtain all other necessary permits or authorizations, such as a wastewater treatment permit or any other authorization as required by Chapter 26 of the Texas Water Code.** Below are provisional requirements in 30 TAC Chapter 217, which must be met as a condition of approval. These items are provided as a reminder. If you have already met these requirements, please disregard this additional notice.

- You must keep records of certain materials for the life of the project and be prepared to provide them to TCEQ upon request. These materials include an engineering report, test results, a summary transmittal letter, and the final version of the project plans and specifications. These materials shall be prepared and sealed by a Professional Engineer licensed in the State of Texas and must show substantial compliance with 30 TAC Chapter 217. All plans and specifications must conform to any wastewater discharge requirements authorized in a permit issued by TCEQ. Specific items that must be addressed in the engineering report are discussed in 30 TAC §217.6(d). Additionally, the engineering report must include all constants, graphs, equations, and calculations needed to show substantial compliance with 30 TAC Chapter 217. The items which shall be included in the summary transmittal letter are addressed in 30 TAC §217.6(d)(1)-(9).

Kim Keefer, P.E.
Page 2
May 13, 2026

- Any deviations from 30 TAC Chapter 217 shall be disclosed in the summary transmittal letter, and the technical justifications for those deviations shall be provided in the engineering report. Any deviations from 30 TAC Chapter 217 shall be based on the best professional judgement of the licensed professional engineer sealing the materials and the engineer's judgement that the design would not result in a threat to public health or the environment.
- Any variance from a 30 TAC Chapter 217 requirement disclosed in your summary transmittal letter is approved. If in the future, additional variances from the requirements in 30 TAC Chapter 217 are desired for the project, each variance must be requested in writing by the design engineer. TCEQ will then consider granting a written approval to the additional variance requests for the specific project and the specific circumstances.
- Within 60 days of construction completion, an appointed engineer shall notify both the Wastewater Permitting Section of the TCEQ Water Quality Division and the appropriate TCEQ Regional Office of the completion date. The engineer shall also provide written certification that all construction, materials, and equipment were substantially in accordance with the approved project, and the rules of TCEQ, as well as provide any change orders filed with TCEQ throughout the duration of project construction. All notifications, certifications, and change orders must include the signed and dated seal of a Professional Engineer licensed in the State of Texas.

This approval does not mean that future projects will be approved without a complete plans and specifications review. TCEQ will provide notification whenever a project is to undergo a complete plans and specifications review. Please note 30 TAC §217.7(a) states, "Approval given by the executive director or other authorized review authority does not relieve an owner of any liability or responsibility with respect to designing, constructing, or operating a collection system or treatment facility in accordance with applicable commission rules and the associated wastewater permit".

If you have any questions or if we can be of any further assistance, please call me at (512) 239-4552.

Sincerely,



Kimberly Kendall, P.E.
Water Quality Division (MC 148)
Texas Commission on Environmental Quality

KK/tc

cc: TCEQ, Region 13 Office

May 5, 2026

RECEIVED

MAY 11 2026

CITY DIVISION
TCEQ

Mr. Baltazar Lucero-Ramirez, P.E.
TCEQ – MC 148
P.O. Box 13087
Austin, Texas 78711-3087

*NDD
Permit #?
Kimberly Kendall
5/11/26*

Re: Chapter 217.6 Summary Transmittal Letter
Guajolote East Lift Station and Force Main

*0526/038
CX/605108091
RV/111506457*

Permittee: Municipal Operations & Consulting

Permit Number: _____

Project Name: Guajolote East Lift Station and Force Main

County(s): Bexar County

Grant No.: N/A

16171001

Dear Mr. Lucero-Ramirez:

The purpose of this letter is to provide the Texas Commission on Environmental Quality (TCEQ) with the information necessary to comply with the requirements of §217.6(c) of the TCEQ's rules entitled "DESIGN CRITERIA FOR DOMESTIC WASTEWATER SYSTEMS." The necessary information includes:

1. Name and address of the engineering firm: Pape-Dawson, 800 E. Sonterra Blvd., Suite 400, San Antonio, Texas 78258.
2. Name, phone number, and email address of the design engineer: Kim Keefer, P.E., Phone (210)-375-9000, kkeefer@pape-dawson.com
3. The project is located in Bexar County
4. Project Name: Guajolote East Lift Station and Force Main.
5. Name of the entity that proposes to own, operate, and maintain the project: Municipal Operation & Consulting, Inc.
6. The plans and specifications which describe the project identified in this letter are in substantial compliance with all the requirements of Chapter 217.
7. There are no innovative or nonconforming technologies proposed as part of the project identified in this letter.

gpm can be conveyed by the lead pump. The incoming peak wet weather flow (842 gpm) can be conveyed with the lead and lag pumps operating in parallel, leaving the third pump as a standby pump. The pumps will automatically alternate as the lead, lag, and standby pumps to promote even wear and extend service life. The design includes automatic operation capability of the pumps, controlled by a submersible level sensor with float switch backups. The wet well has sufficient volume between the “All Pumps Off” and “Lead Pump On,” “Lag Pump On” and “Standby Pump On” to operate below the incoming gravity main elevation into the wet well to disallow storage within the incoming gravity main system. All pump activation levels are below the spill elevation.

- The force main is anticipated to have a discharge velocity of approximately 2.29 feet per second (fps) with one pump in operation, 4.27 fps with two pumps operating in parallel, and 5.60 fps with all three pumps operating in parallel. Calculations indicate that the 160 psi rated HDPE force main pipe is able to withstand surge pressures in the event of a power outage under the condition where all three pumps are operating.
- The lift station is located outside of the 100-year floodplain and will receive electrical service from three phase 460 volt power from CPS Energy. In the event of a power outage the lift station design includes an automatic transfer switch and emergency power generator (with 48-hour fuel tank) rated to operate the entire lift station.
- Lift station alarm notification is accomplished through an onsite alarm and light fixture as well as an autodialer to be monitored by the operator.

If you have questions regarding this project, please feel free to contact me at kkeefe@pape-dawson.com

Sincerely,
Pape-Dawson



Kim Keefer, P.E.
Managing Vice President, Water/Wastewater Infrastructure

cc: TCEQ Waste Section Manager – San Antonio

123\56\22\Word\Letters\TCEQ Summary Transmittal Letter\260505a1.docx

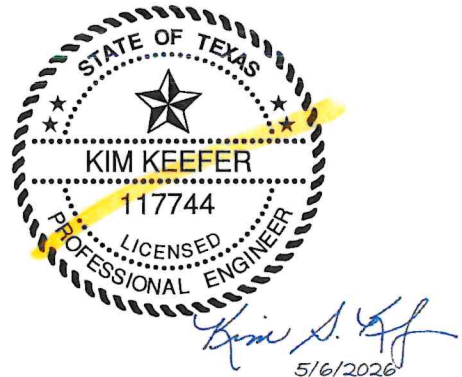



N.T.S.

BEXAR COUNTY

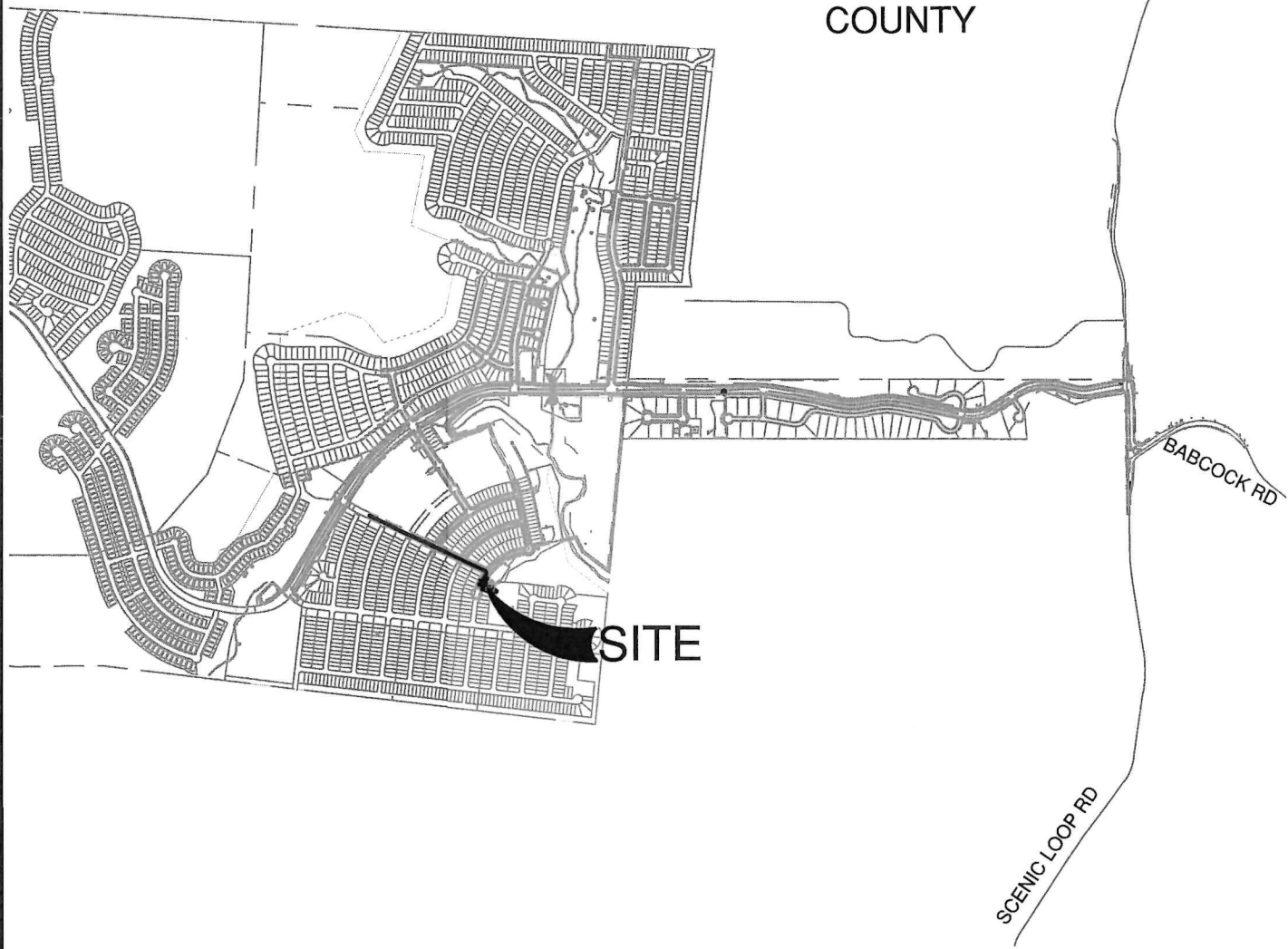

SITE

SCENIC LOOP RD

BABCOCK RD

Date: April 14, 2026, 9:48 AM - User ID: Aloughlin
File: P:\23\38\22\Design\Exhibits\260414_1235622-Location Map.dwg

JOB NO. 12356-22
 DATE APRIL 2026
 DESIGNER RM
 CHECKED KK DRAWN AL
 SHEET 1 of 1

**GUAJOLOTE EAST LIFT
 STATION & FORCE MAIN**
 SAN ANTONIO, TEXAS
 SITE LOCATION MAP

PAPE-DAWSON
 2000 NW LOOP 410 | SAN ANTONIO, TX 78213 | 210.375.9000
 TEXAS ENGINEERING FIRM #470 | TEXAS SURVEYING FIRM #10028800

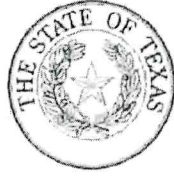

TPDES PERMIT NO. WQ0016171001
[For TCEQ office use only - EPA I.D.
No. TX0142981]

TEXAS COMMISSION ON ENVIRONMENTAL QUALITY
P.O. Box 13087
Austin, Texas 78711-3087

PERMIT TO DISCHARGE WASTES
under provisions of
Section 402 of the Clean Water Act
and Chapter 26 of the Texas Water Code

Municipal Operations, LLC

whose mailing address is

P.O. Box 1689
Spring, Texas 77383

is authorized to treat and discharge wastes from the Guajolote Ranch Wastewater Treatment Facility, SIC Code 4952

located approximately 1.75 miles west-southwest of the intersection of Babcock Road and Scenic Loop Road, in Bexar County, Texas 78023

via pipe to Helotes Creek, thence to a pond, thence to Helotes Creek, thence to Culebra Creek, thence to Lower Leon Creek in Segment No. 1906 of the San Antonio River Basin

only according to effluent limitations, monitoring requirements, and other conditions set forth in this permit, as well as the rules of the Texas Commission on Environmental Quality (TCEQ), the laws of the State of Texas, and other orders of the TCEQ. The issuance of this permit does not grant to the permittee the right to use private or public property for conveyance of wastewater along the discharge route described in this permit. This includes, but is not limited to, property belonging to any individual, partnership, corporation, or other entity. Neither does this permit authorize any invasion of personal rights nor any violation of federal, state, or local laws or regulations. It is the responsibility of the permittee to acquire property rights as may be necessary to use the discharge route.

This permit shall expire at midnight, **five years from the date of issuance.**

ISSUED DATE:

10/28/85

Brooke J. Paup
For the Commission