



GVEC LEGEND

- 3-4" ABC PHASE - 1000MCM AL 25kV WITH (1) 2 1/2" PVC FOR FIBER
- 3-2 1/2" ABC PHASE - 1/0 AL 25kV
- 1-2 1/2" A PHASE - 1/0 AL 25kV
- 1-2 1/2" B PHASE - 1/0 AL 25kV
- 1-2 1/2" C PHASE - 1/0 AL 25kV
- 1-2 1/2" SECONDARY - 350 TPLX WITH (1) 2 1/2" SPARE CONDUIT
- 1-2 1/2" SECONDARY - 4/0 TPLX WITH (1) 2 1/2" SPARE CONDUIT
- 1-1" STREET LIGHT - 12/2 W/GND
- BACK OF P.U.E.
- SECONDARY PEDESTAL
- TRANSFORMER
- 200A 1Ø SWITCH CABINET
- 200A SWITCH CABINET
- SWITCHGEAR
- 600A ENCLOSURE
- EASEMENT AREA
- NEW OVH POWER LINE
- EXISTING OVH POWER LINE
- NEW POWER POLE
- EXISTING POWER POLE
- URD RISER
- STREET LIGHT
- ANCHOR

LOCATION MAP N.T.S.

MATERIAL LIST

Quantity	CU	Description
8,200	U1/0AL25KV	1/0 AL 25KV Aluminum URD Primary Cable
5,500	U350ALTP	350 MCM URD Triplex Secondary Cable
1,800	U4/0ALTP	4/0 MCM URD Triplex Secondary Cable
1,900	U12/2UFVW/GRD	12/2 UF Copper with Ground Street Light Cable
40	UK6-350	Secondary Pedestal, Fed with 350 MCM URD Triplex
20	UK6-4-0	Secondary Pedestal, Fed with 4/0 MCM URD Triplex
22	M60-C3LED	54W LED Type 3 LT for Aluminum Pole
22	UP30-5AL	30ft Aluminum Street Light Pole
1,000	UPVC 1	1" Schedule 40 PVC
22,000	UPVC 2 1/2	2.5" Schedule 40 PVC
2	UVG5- Small	14.4 kv Single Phase Open Transformer (75kVA and below)
21	UVG7- Small	14.4 kv Single Phase Loop Transformer (75kVA and below)
1	UVG7- Large	14.4 kv Single Phase Loop Transformer (over 100 kVA)
1	UVG5- Small	14.4 kv Single Phase Radial Transformer (75kVA and below)
1	100 PAD 14.4 120	100kVA Padmount Transformer
16	75 PAD 14.4 120	75kVA Padmount Transformer
6	50 PAD 14.4 120	50kVA Padmount Transformer
2	37.5 PAD 14.4 120	37.5kVA Padmount Transformer
3	UVM31-2	1 Phase Switch Cabinet, 2-Way
1	UVM31-3	1 Phase Switch Cabinet, 3-Way
1	UVM2-5W#4-1-0	14.4kV Three Phase Pothead Wood Pole #4-1-0 OH

NOTE: G.V.E.C. WILL MAINTAIN 5' EASEMENT FOR SERVICE ENTRANCE TO DWELLING. THIS EASEMENT WILL VARY DEPENDING UPON LOCATION OF DWELLING.

G.V.E.C. SHALL HAVE ACCESS TO THE METER LOCATIONS FROM THE FRONT YARDS WITH THE METER LOCATIONS NOT BEING LOCATED WITHIN A FENCED AREA.

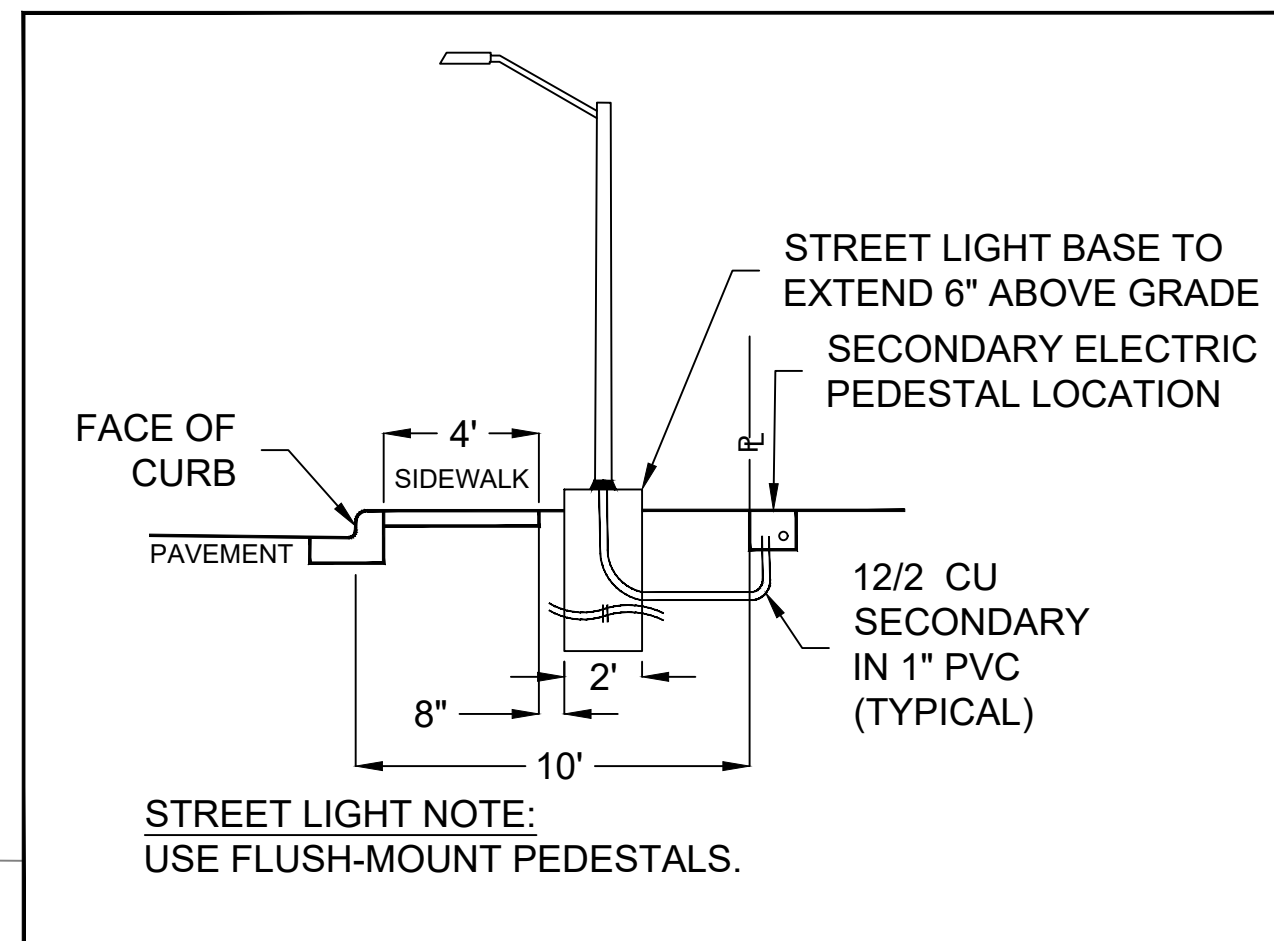
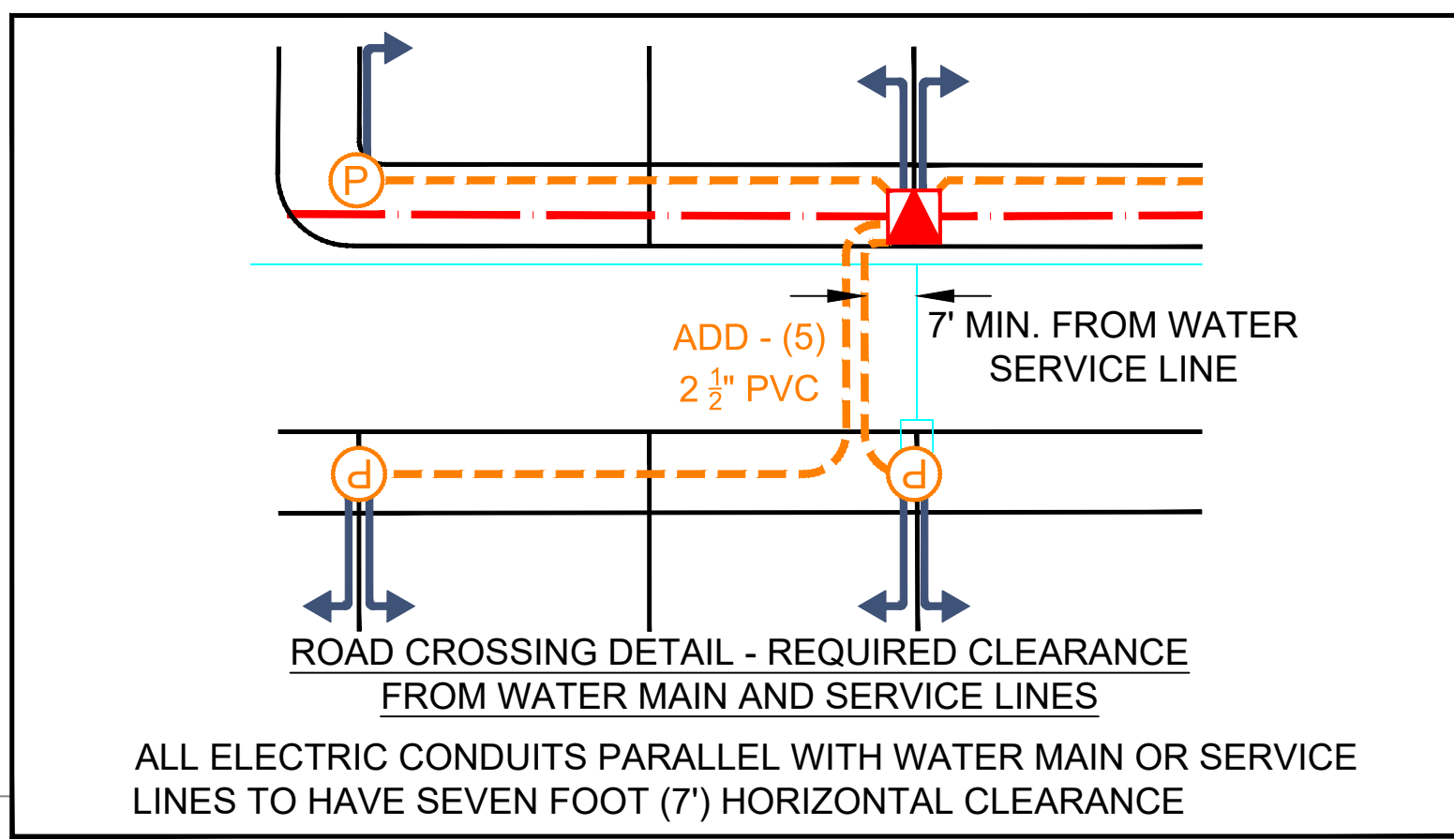
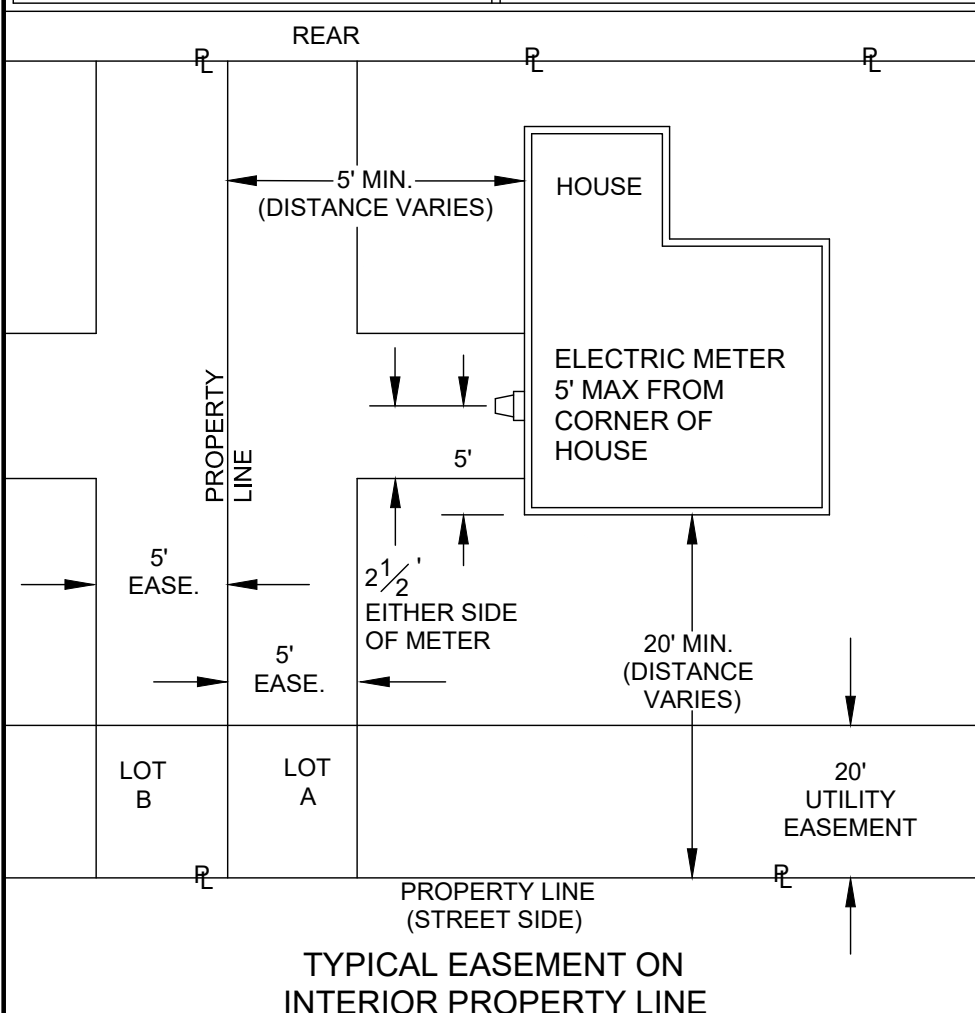

WO# 2069299
132 LOTS
22 LIGHTS

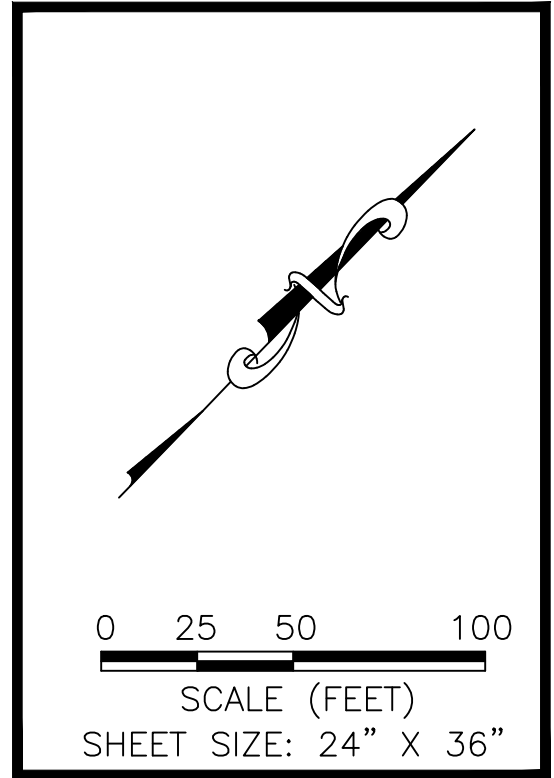

ABS: 20
98.846 ACS PARKSIDE SUB

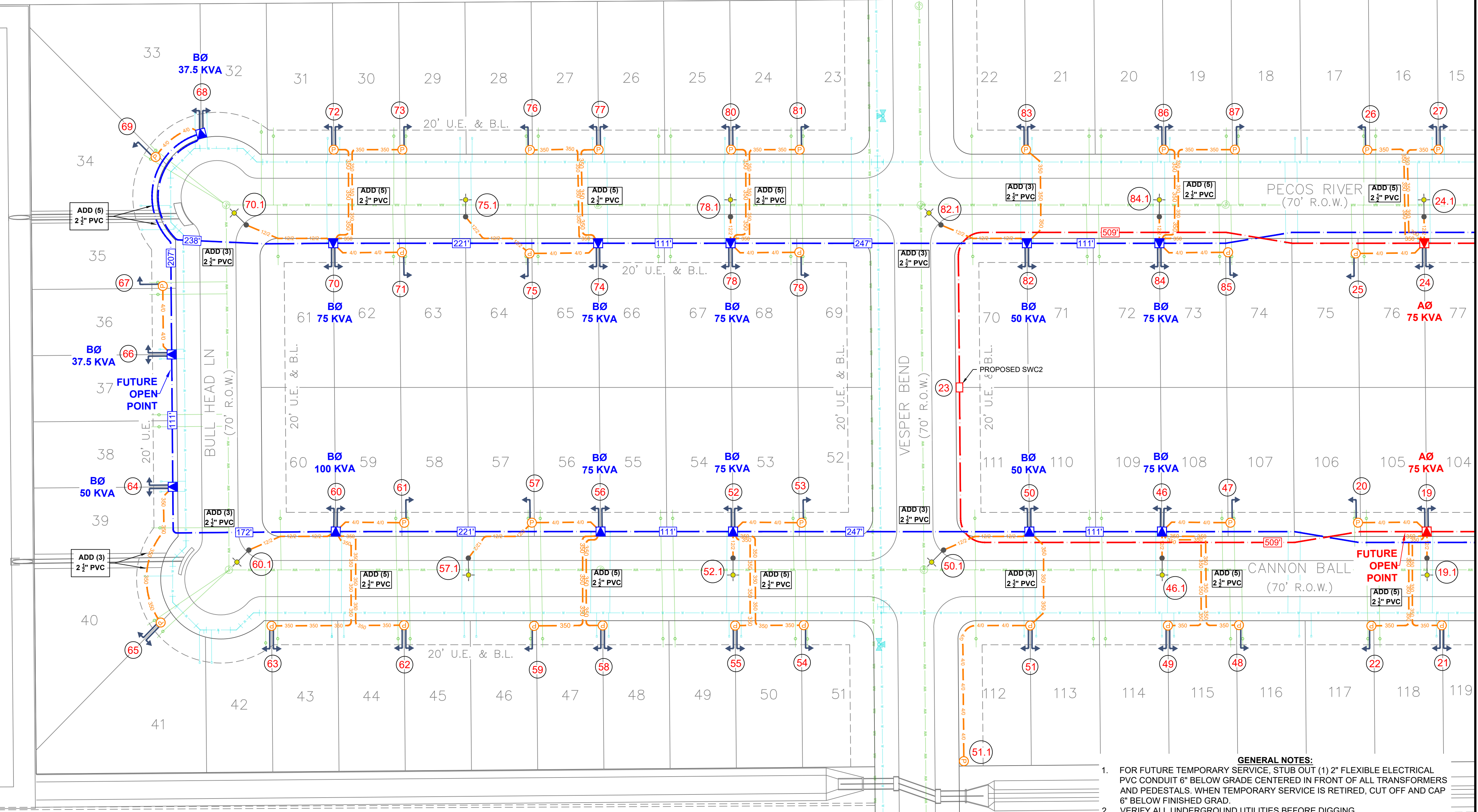

- GENERAL NOTES:**
- FOR FUTURE TEMPORARY SERVICE, STUB OUT (1) 1/2" FLEXIBLE ELECTRICAL PVC CONDUIT 6" BELOW GRADE CENTERED IN FRONT OF ALL TRANSFORMERS AND PEDESTALS. WHEN TEMPORARY SERVICE IS RETIRED, CUT OFF AND CAP 6" BELOW FINISHED GRAD.
 - VERIFY ALL UNDERGROUND UTILITIES BEFORE DIGGING.
 - GVEC TO HAVE 5' WIDE ELECTRIC EASEMENT ON ALL ROAD CROSSINGS IN WHICH ELECTRIC LINES ARE PLACED.
 - INSTALL THE CORRECT KV RATED PARKING STAND ARRESTORS AND LIGHTNING ARRESTORS FOR ALL OPEN POINT TRANSFORMERS.
 - ALL UNDERGROUND CONDUIT FOR GVEC ELECTRIC FACILITIES TO BE SCHEDULE 40, GRAY PVC UNLESS OTHERWISE SPECIFIED BY GVEC STAFF.
 - ALL CROSSINGS TO BE INSTALLED BY THE DEVELOPER'S CIVIL CONTRACTOR ACCORDING TO THE GVEC APPROVED FOR CONSTRUCTION DESIGN.
 - ALL ROAD CROSSINGS MUST CROSS ANY WET UTILITIES THAT ARE IN THE ROADWAY OR ROW AS WELL AND BE INSPECTED BY GVEC PERSONNEL.
 - WATER PROVIDED BY: SPRINGS HILL SUD
 - SEWER PROVIDED BY: GBRA

*** THE QUANTITIES SHOWN ON THE PLANS AND THE BID DOCUMENTS ARE ESTIMATED QUANTITIES AND BASED ON THE PLAN SET AND TO BE USED FOR BIDDING PURPOSE ONLY. THE CONTRACTOR IS RESPONSIBLE FOR DETERMINING ACTUAL QUANTITIES. THE CONTRACTOR SHALL BE RESPONSIBLE TO RESOLVE ANY PERCEIVED DISCREPANCIES IN THE QUANTITIES WITH THE OWNER PRIOR BEGINNING ANY CONSTRUCTION WORK.



PARKSIDE SOUTH UNIT 1	
DESIGN: S. KOHLENBERG	DATE: 09/29/2025
BY: S. KOHLENBERG	SCALE: SEE SCALE BAR
NO: 2069299	REV: 1 OF 2

Date: 9/29/2025 3:17 PM User: JEFFREY KOHLENBERG File: T:\GVEC\2025\PARKSIDE SOUTH UNIT 1.DWG

ISSUED FOR CONSTRUCTION

MATCHLINE - REFER TO SHEET 2

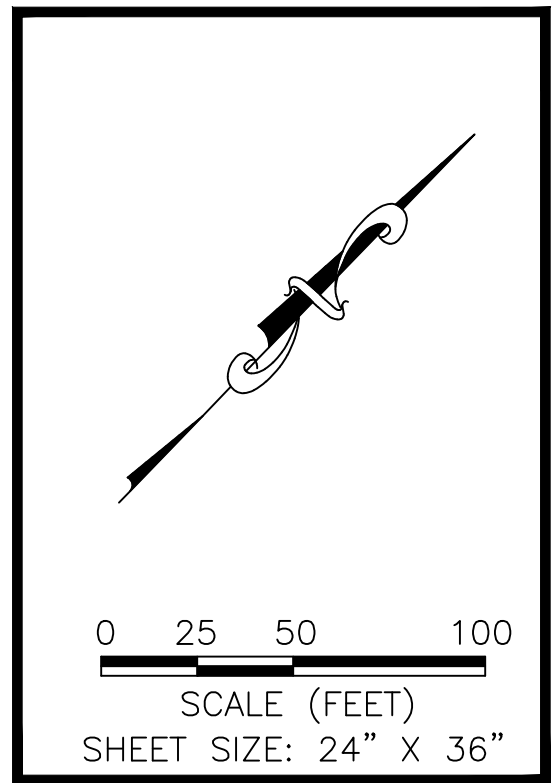

GVEC LEGEND

- 3-4" ABC PHASE - 1000MCM AL 25KV
- WITH (1) 2 1/2" PVC FOR FIBER
- 3-2 1/2" ABC PHASE - 1/0 AL 25KV
- 1-2 1/2" A PHASE - 1/0 AL 25KV
- 1-2 1/2" B PHASE - 1/0 AL 25KV
- 1-2 1/2" C PHASE - 1/0 AL 25KV
- 1-2 1/2" SECONDARY - 350 TPLX WITH (1) 2 1/2" SPARE CONDUIT
- 1-2 1/2" SECONDARY - 4/0 TPLX WITH (1) 2 1/2" SPARE CONDUIT
- 1-1" STREET LIGHT - 12/2 W/GND
- BACK OF P.U.E.
- P SECONDARY PEDESTAL
- ▲ ▲ ▲ TRANSFORMER
- 200A 1Ø SWITCH CABINET
- 200A SWITCH CABINET
- SWITCHGEAR
- 600A ENCLOSURE
- EASEMENT AREA
- NEW OVH POWER LINE
- EXISTING OVH POWER LINE
- NEW POWER POLE
- EXISTING POWER POLE
- URD RISER
- STREET LIGHT
- ANCHOR



- GENERAL NOTES:**
1. FOR FUTURE TEMPORARY SERVICE, STUB OUT (1) 2" FLEXIBLE ELECTRICAL PVC CONDUIT 6" BELOW GRADE CENTERED IN FRONT OF ALL TRANSFORMERS AND PEDESTALS. WHEN TEMPORARY SERVICE IS RETIRED, CUT OFF AND CAP 6" BELOW FINISHED GRAD.
 2. VERIFY ALL UNDERGROUND UTILITIES BEFORE DIGGING.
 3. GVEC TO HAVE 5' WIDE ELECTRIC EASEMENT ON ALL ROAD CROSSINGS IN WHICH ELECTRIC LINES ARE PLACED.
 4. INSTALL THE CORRECT KV RATED PARKING STAND ARRESTORS AND LIGHTNING ARRESTORS FOR ALL OPEN POINT TRANSFORMERS.
 5. ALL UNDERGROUND CONDUIT FOR GVEC ELECTRIC FACILITIES TO BE SCHEDULE 40, GRAY PVC UNLESS OTHERWISE SPECIFIED BY GVEC STAFF.
 6. ALL CROSSINGS TO BE INSTALLED BY THE DEVELOPER'S CIVIL CONTRACTOR ACCORDING TO THE GVEC APPROVED FOR CONSTRUCTION DESIGN.
 7. ALL ROAD CROSSINGS MUST CROSS ANY WET UTILITIES THAT ARE IN THE ROADWAY OR ROW AS WELL AND BE INSPECTED BY GVEC PERSONNEL.
 8. WATER PROVIDED BY: SPRINGS HILL SUD
 9. SEWER PROVIDED BY: GBRA

MATCHLINE - REFER TO SHEET 1

Date: 9/29/2025 3:17 PM User: JEFFREY KOHLENBERG File: T:\GVEC\2025\PARKSIDE SOUTH UNIT 1\PARKSIDE SOUTH UNIT 1.DWG

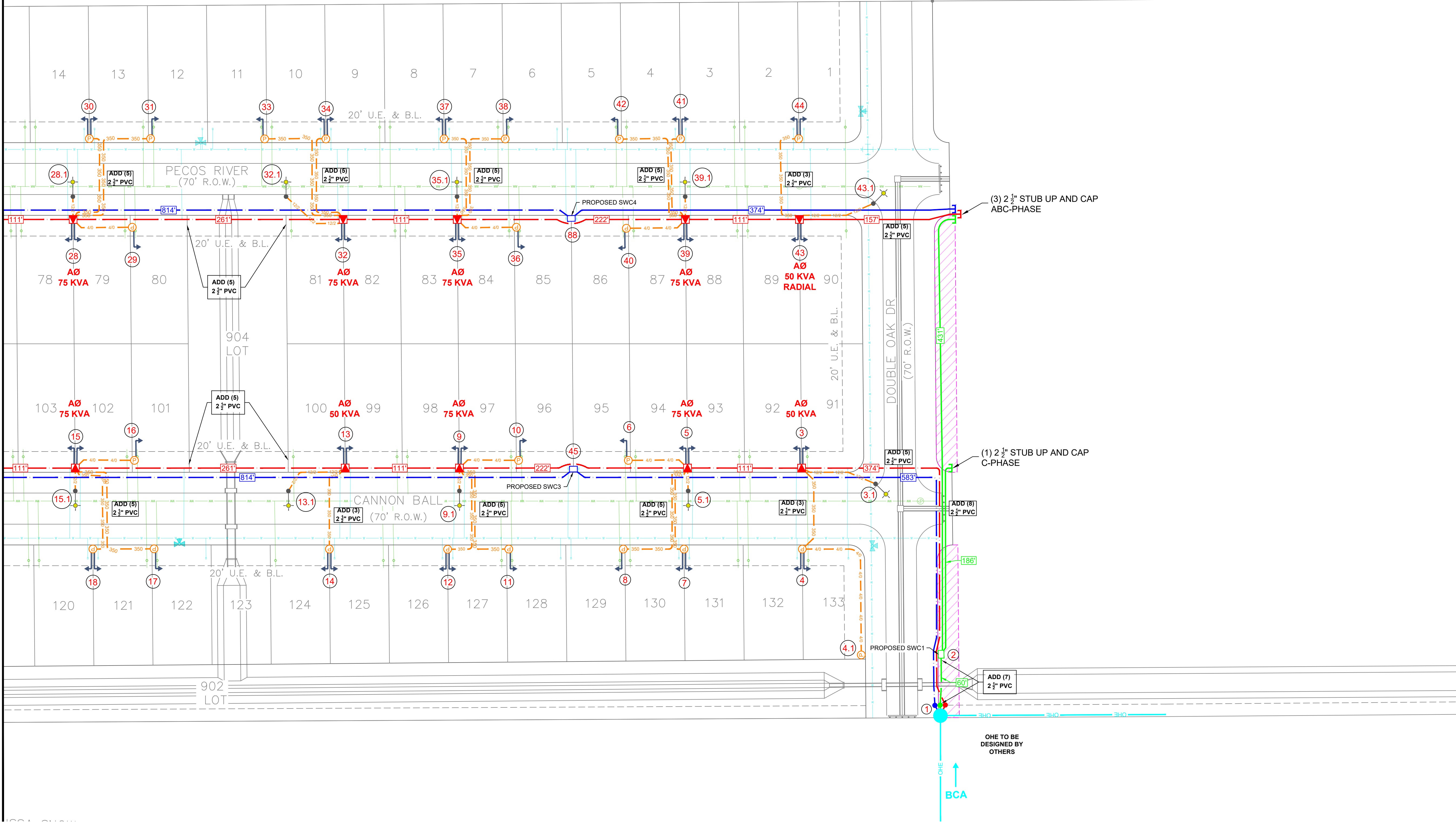

ISSUED FOR CONSTRUCTION

*** THE QUANTITIES SHOWN ON THE PLANS AND THE BID DOCUMENTS ARE ESTIMATED QUANTITIES AND BASED ON THE PLAN SET AND TO BE USED FOR BIDDING PURPOSE ONLY. THE CONTRACTOR IS RESPONSIBLE FOR DETERMINING ACTUAL QUANTITIES. THE CONTRACTOR SHALL BE RESPONSIBLE TO RESOLVE ANY PERCEIVED DISCREPANCIES IN THE QUANTITIES WITH THE OWNER PRIOR BEGINNING ANY CONSTRUCTION WORK.

M&S ENGINEERING
 ELECTRICAL | CIVIL | MEP
 TEXAS REGISTERED ENGINEERING FIRM F-1394

gvec
 Delivering more.™

PARKSIDE SOUTH UNIT 1	
DESIGNER S. KOHLENBERG	DATE 09/29/2025
CHECKER S. KOHLENBERG	SCALE SEE SCALE BAR
JOB NO. 2069299	PAGE 2 OF 2

1

RISER POLE

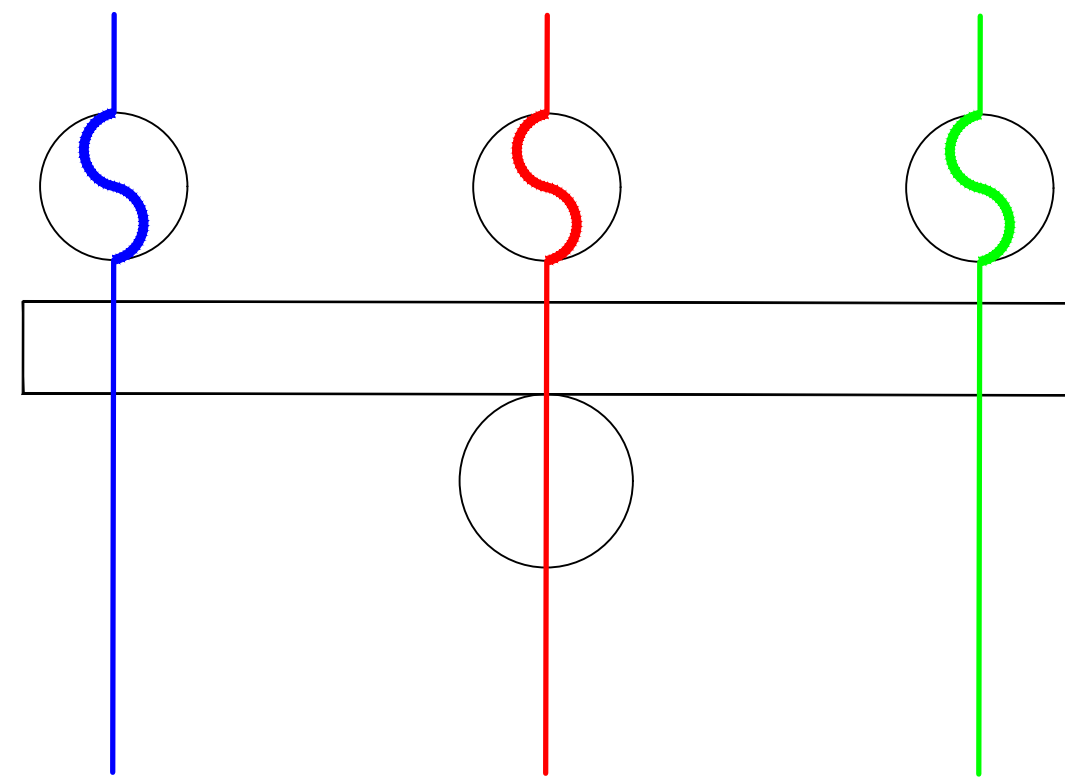

I - (1) AØ RISER AND (1) 65A S&C FUSE
 (1) BØ RISER AND (1) 65A S&C FUSE
 (1) CØ RISER AND (1) 65A S&C FUSE

2

SWITCH CABINET 1

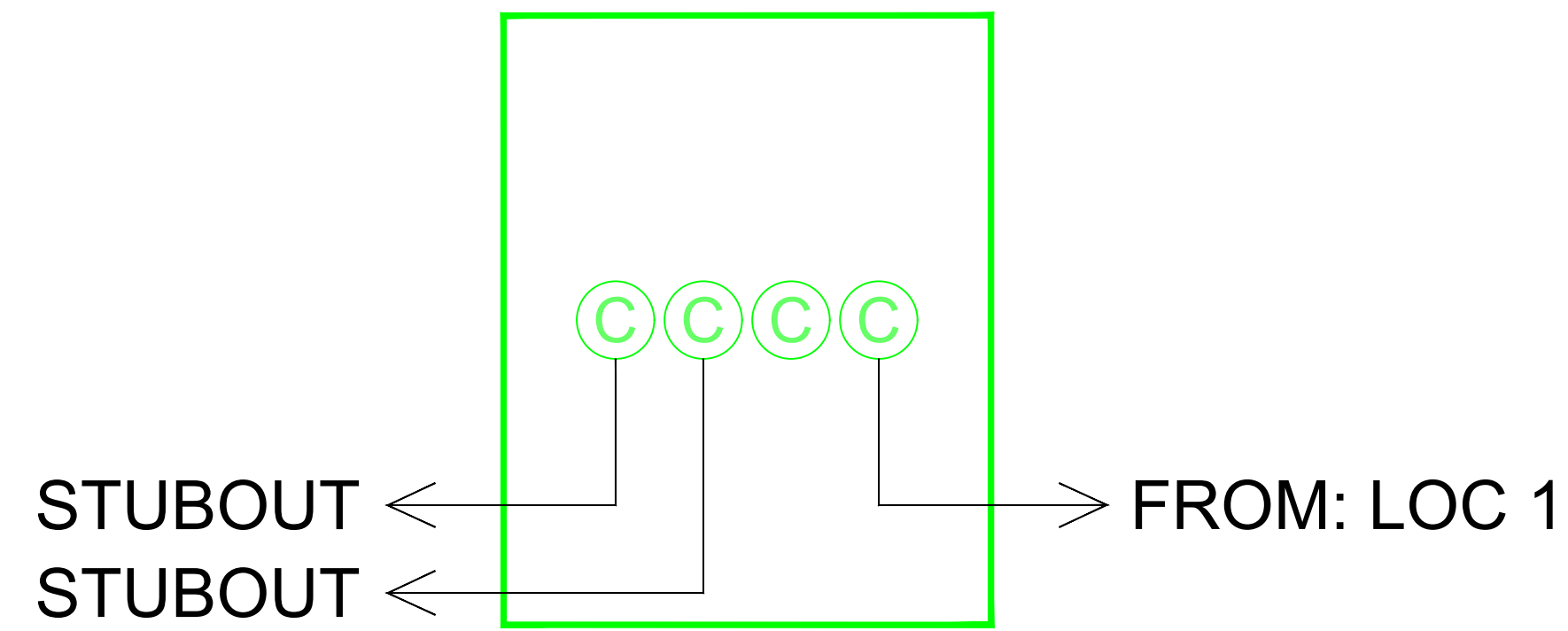

DOUBLE OAK DR

23

SWITCH CABINET 2

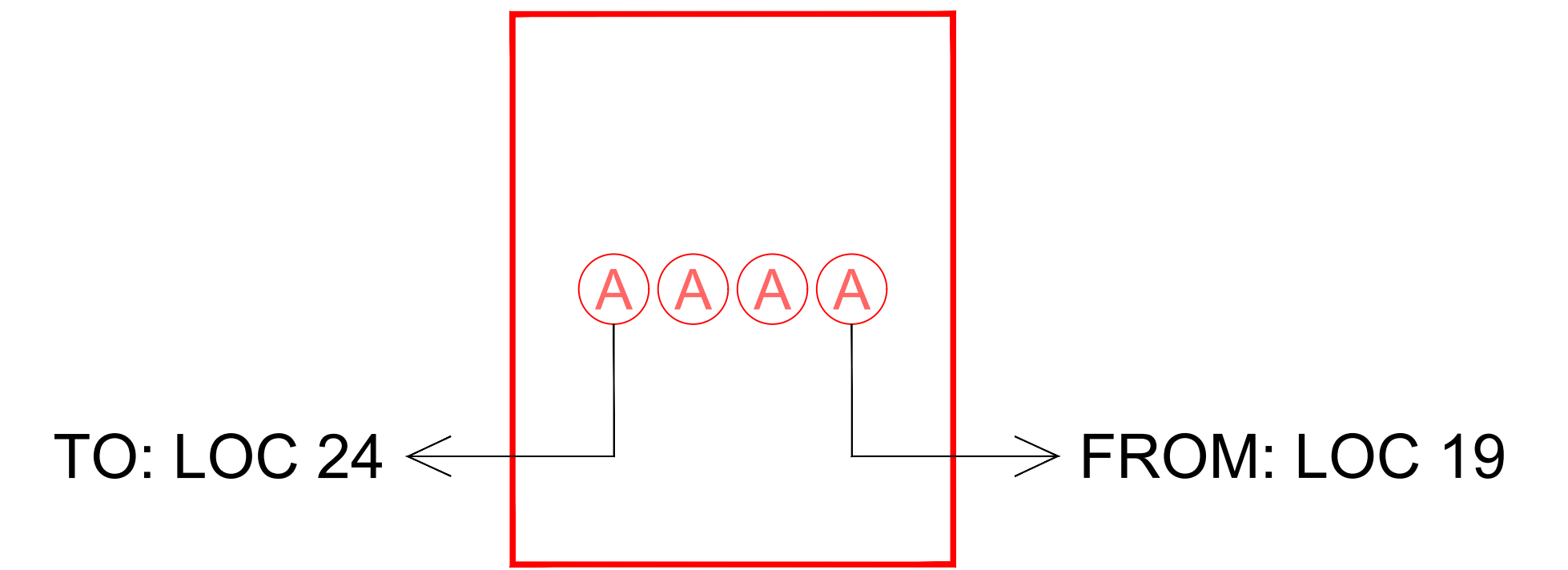

VESPER BEND

45

SWITCH CABINET 3

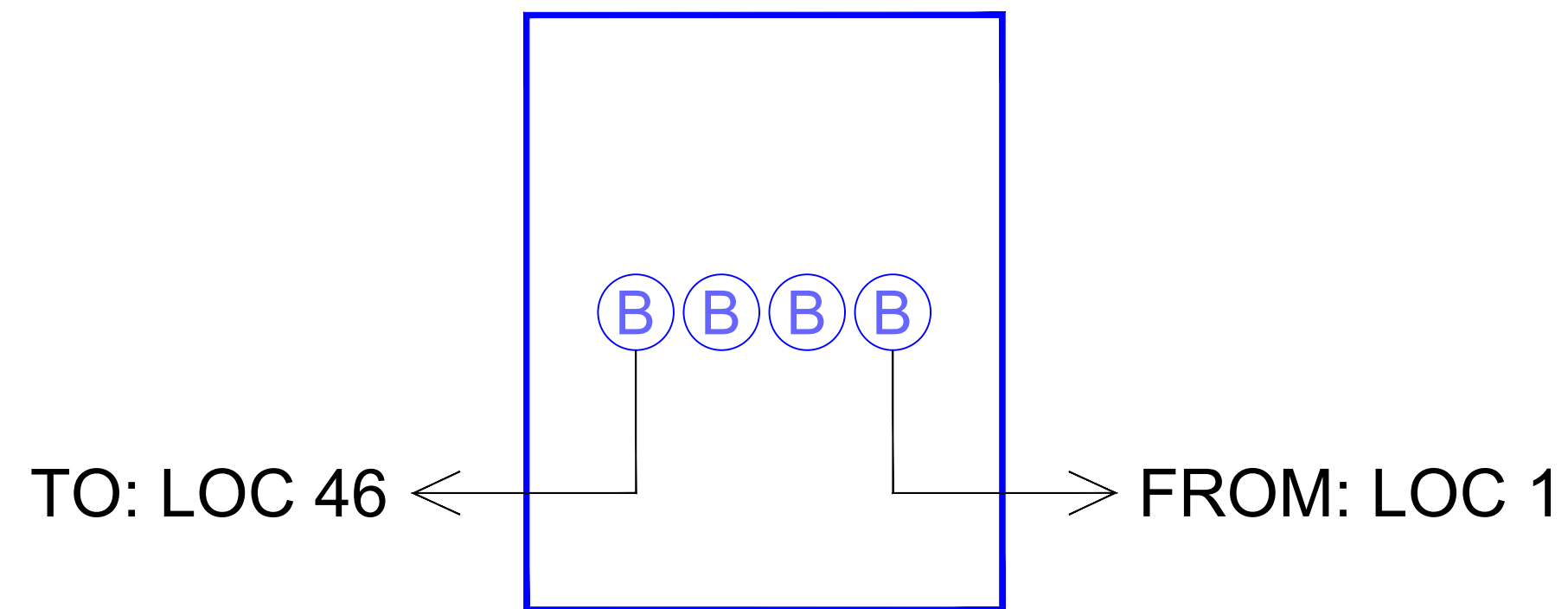

CANNON BALL

88

SWITCH CABINET 4

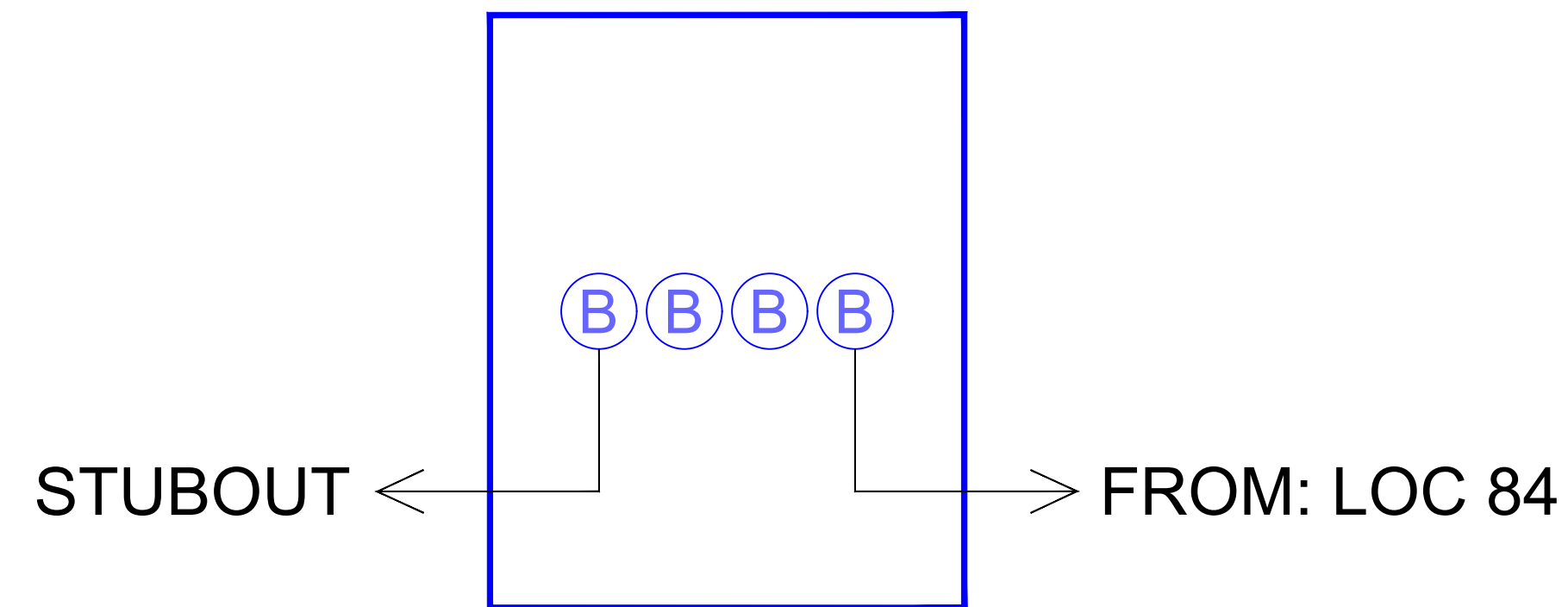

PECOS RIVER



ISSUED FOR CONSTRUCTION

*** THE QUANTITIES SHOWN ON THE PLANS AND THE BID DOCUMENTS ARE ESTIMATED QUANTITIES AND BASED ON THE PLAN SET AND TO BE USED FOR BIDDING PURPOSE ONLY. THE CONTRACTOR IS RESPONSIBLE FOR DETERMINING ACTUAL QUANTITIES. THE CONTRACTOR SHALL BE RESPONSIBLE TO RESOLVE ANY PERCEIVED DISCREPANCIES IN THE QUANTITIES WITH THE OWNER PRIOR BEGINNING ANY CONSTRUCTION WORK.



PARKSIDE SOUTH UNIT 1	
DESIGN: S. KOHLENBERG	DATE: 09/29/2025
BY: S. KOHLENBERG	SCALE: N/A
NO: 2069299	REV: DETAILS