

STATE OF TEXAS
DEPARTMENT OF TRANSPORTATION
PLANS OF PROPOSED
STATE HIGHWAY IMPROVEMENT

FED. RD. DIV. NO.		PROJECT NO.		
CONT	SECT	JOB		HIGHWAY
0100	02			122
DIST		COUNTY		SHEET NO.
15		BEXAR		1

INDEX OF SHEETS

SHEET NO.	DESCRIPTION
1	COVER SHEET
2	PROJECT LAYOUT
3	EXISTING TYPICAL SECTION
4	PROPOSED TYPICAL SECTION
5	SCHEDULE OF BARRICADES
6	TCP NARRATIVE
7	ROADWAY, SIGNING, MARKINGS AND DELINEATION
8	MISCELLANEOUS CURB AND SIDEWALK DETAILS

PROJECT NO.
CSJ: 0100-02-

BEXAR COUNTY
HWY 122 SPUR

FUNCTIONAL CLASSIFICATION = STATE HIGHWAY SPUR
DESIGN SPEED = 50 MPH
A.D.T. (2012) =
A.D.T. (2032) =

LIMITS
FROM: 0.300 MILES EAST OF IH 410 & S PRESA ST INTERSECTION
TO: 0.379 MILES EAST OF IH 410 & S PRESA ST INTERSECTION

FOR WORK CONSISTING OF ROADWAY WIDENING AND PAVEMENT MARKINGS TO
PROVIDE FOR A LEFT-TURN LANE

HWY 122 SPUR	CSJ: 0100-02-		
ROADWAY :	= 414.91 FT	= 0.079 MI	
BRIDGE:	= 0.00 FT	= 0.000 MI	
TOTAL:	= 414.91 FT	= 0.079 MI	

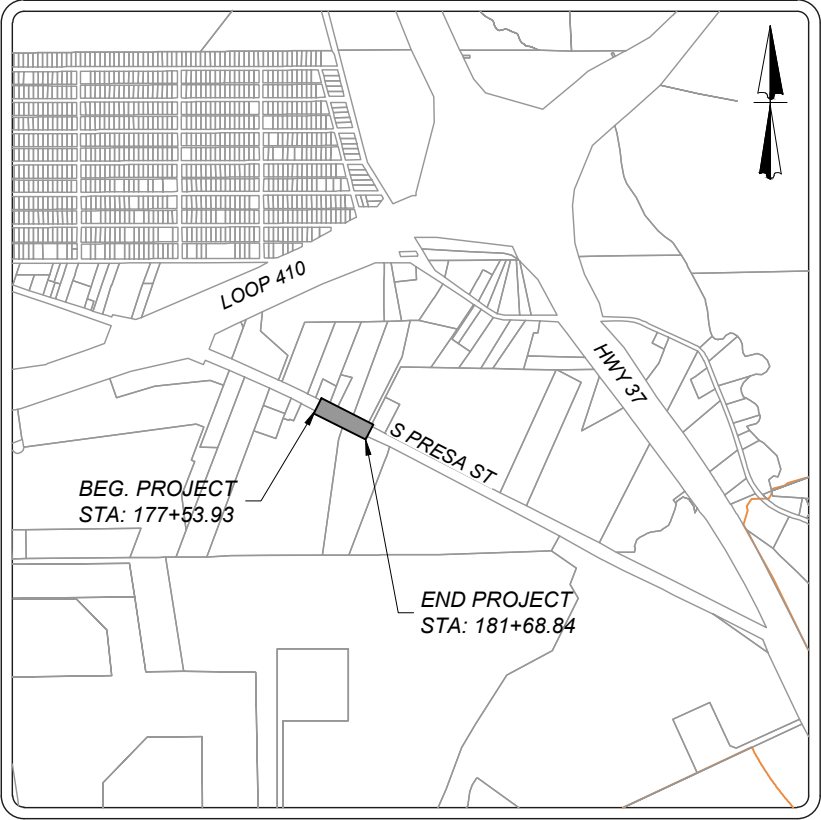

N.T.S.

EXCEPTIONS: NONE
EQUATIONS: NONE
R.R. CROSSINGS: NONE



Travis R. Elseth
7/8/24



D:\enr\jun_09_2024_8_27pm - User: jrb - LAYOUT.dwg
File: K:\1027\01\02\Design\Gis\1027-001 L1\2 - LAYOUT.dwg

LEGEND

PROPOSED PAVEMENT



DIRECTION OF TRAFFIC



SAWCUT LINE



SCALE : 1"=50'

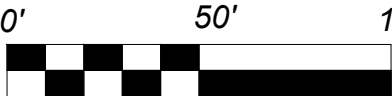

Travis R. Elseth
7/8/24

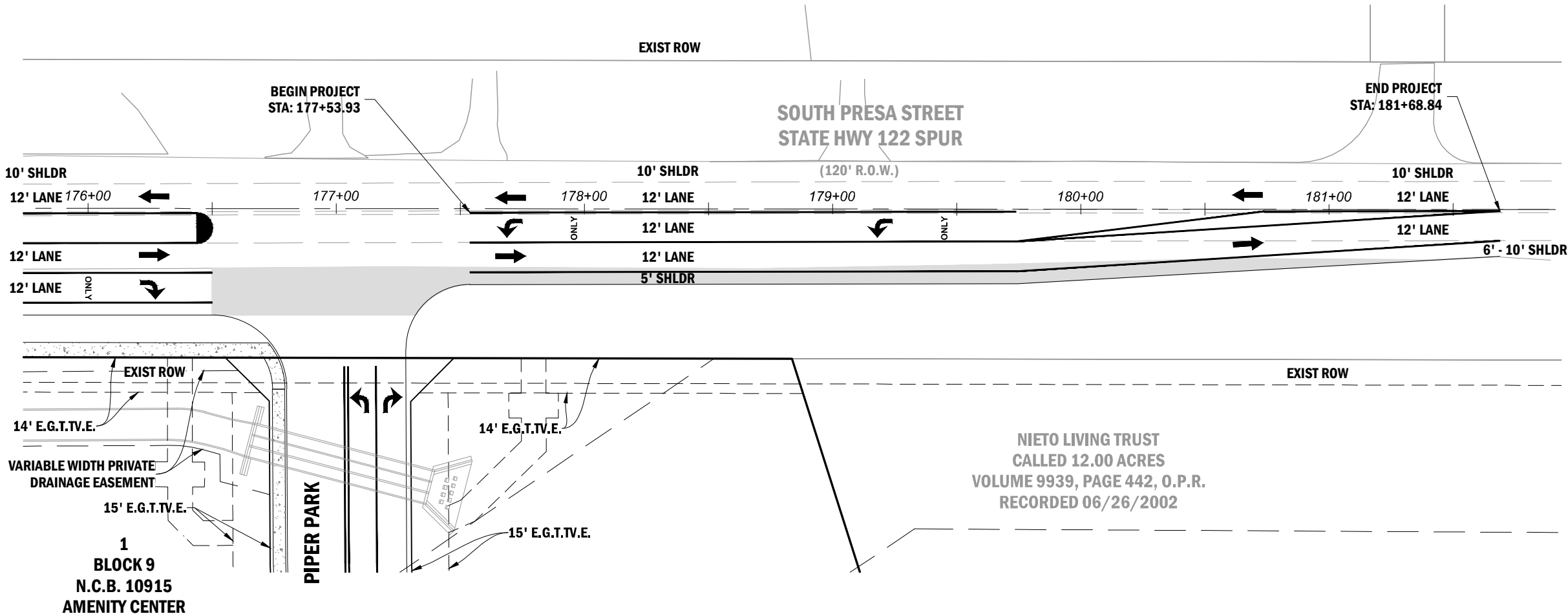

PRESA GROVE
BEXAR COUNTY, TEXAS
PROJECT LAYOUT

FED. RD. DIV. NO.		PROJECT NO.		
CONT	SECT	JOB	HIGHWAY	
0100	02		122	
DIST	COUNTY		SHEET NO.	
15	BEXAR		2	

Date: Jun 09, 2024, 8:28pm User: jls - edwardell
File: K:\1027\01\02\Design\Gvd\10001 L1\3 - Typ_Ext.dwg

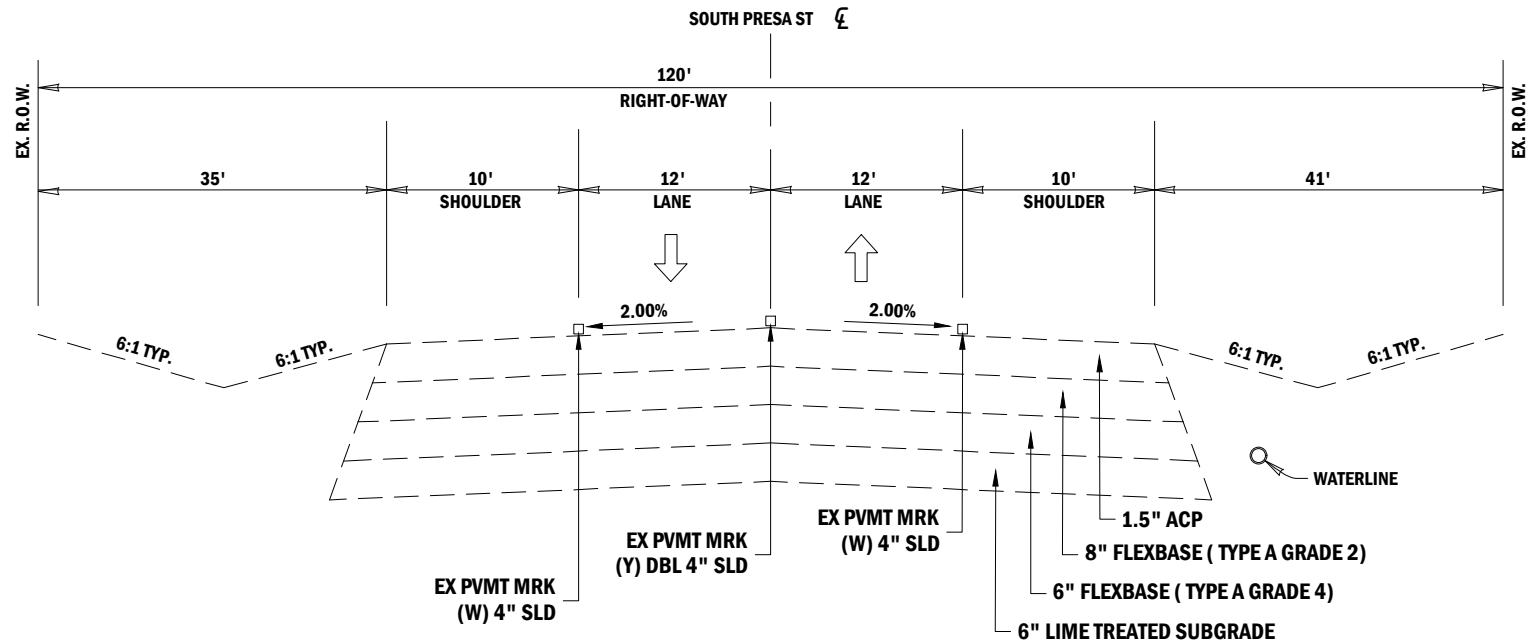

EXISTING TYPICAL SECTION

SOUTH PRESA STREET
SATE HIGHWAY 122 SPUR
STA: 177+53.93 - STA: 181+68.84

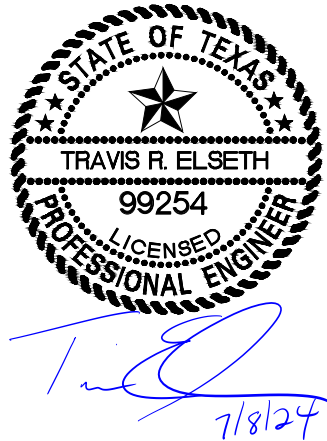

FED. RD. DIV. NO.		PROJECT NO.	
CONT	SECT	JOB	HIGHWAY
0100	02		122
DIST	COUNTY		SHEET NO.
15	BEXAR		3

PRESA GROVE
BEXAR COUNTY, TEXAS
EXISTING TYPICAL SECTION

D:\Jun 09 2024 8:28pm User: jrb-edwards
File: K:\1027\01\02\Design\GVA\10001 L1\4 - Typ_Pb.dwg

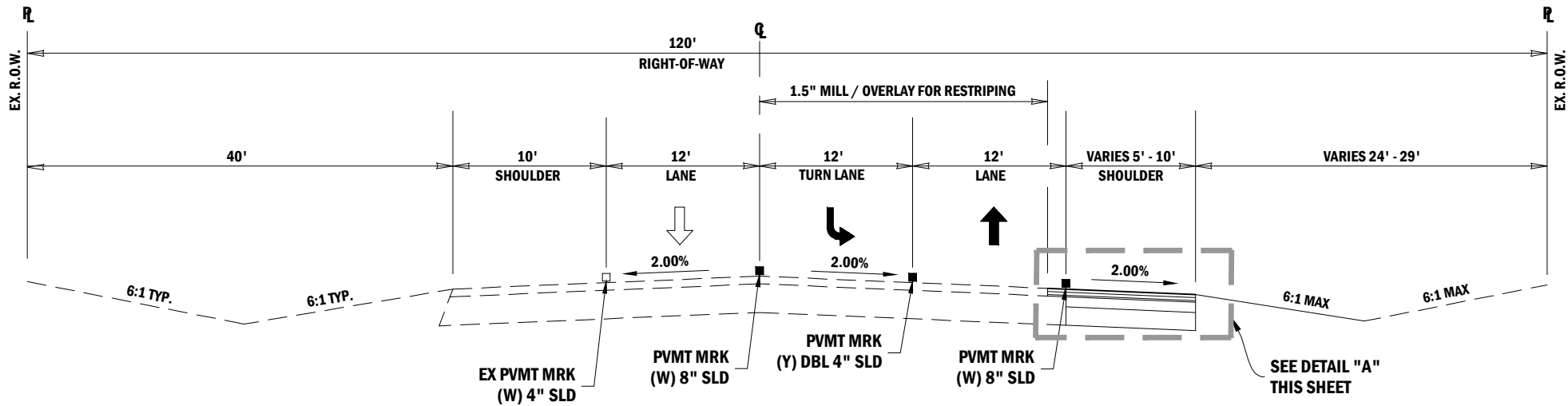

PROPOSED TYPICAL SECTION

SOUTH PRESA STREET
STATE HIGHWAY 122 SPUR
STA: 177+53.93 - STA: 181+68.84

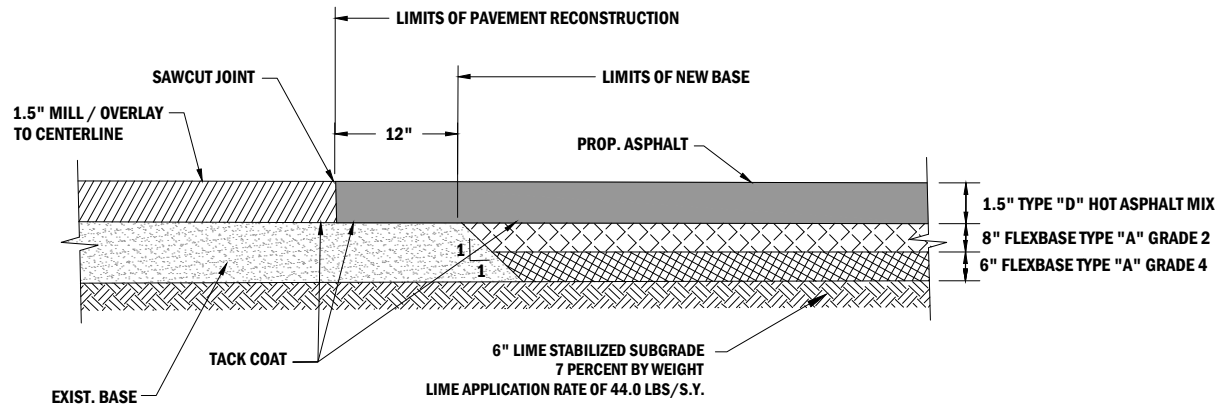

DETAIL "A"
N.T.S.

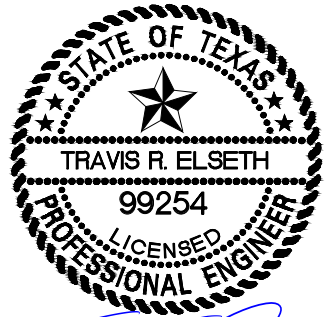

Travis R. Elseth
7/8/24

PRESA GROVE
BEXAR COUNTY, TEXAS
PROPOSED TYPICAL SECTION

FED. RD. DIV. NO.		PROJECT NO.		
CONT	SECT	JOB		HIGHWAY
0100	02			122
DIST	COUNTY			SHEET NO.
15	BEXAR			4

DETOURS, BARRICADES, WARNING SIGNS, SEQUENCE OF WORK, ETC.

THE CONTRACTOR'S ATTENTION IS DIRECTED TO THE REQUIREMENTS OF ITEM 7, "LEGAL RELATIONS AND RESPONSIBILITIES TO THE PUBLIC", OF THE STANDARD SPECIFICATIONS. IN ADDITION TO THESE REQUIREMENTS, THE FOLLOWING PROVISIONS SHALL ALSO GOVERN ON THIS CONTRACT:

1. GENERAL

- TRAFFIC MUST BE HANDLED THROUGHOUT THE PROJECT DURING CONSTRUCTION. THE CONTRACTOR IS RESPONSIBLE FOR PROVIDING A SAFE AND COMFORTABLE PASSAGE FOR VEHICULAR AND PEDESTRIAN TRAFFIC WITH MINIMAL INCONVENIENCE TO THE PUBLIC, AS SHOWN IN THE PLANS OR AS DIRECTED/APPROVED BY THE ENGINEER.
- THE CONTRACTOR MAY PROPOSE/RECOMMEND MODIFICATIONS TO THE SEQUENCE OF WORK FOR CONSIDERATION BY THE ENGINEER. ANY MAJOR RECOMMENDED MODIFICATION BY THE CONTRACTOR SHALL INCLUDE ANY CHANGES TO THE VARIOUS BID ITEMS, IMPACT TO TRAFFIC, EFFECT OF OVERALL PROJECT IN TIME AND COST, ETC. IF THIS PROPOSAL IS IMPLEMENTED, THE CONTRACTOR WILL BE RESPONSIBLE FOR DEVELOPING DETAILED PLAN SHEETS TO BE SEALED BY A LICENSED PROFESSIONAL ENGINEER FOR INCLUSION WITH THE CHANGE ORDER. THE CONTRACTOR CANNOT PROCEED WITH ANY CONSTRUCTION OPERATIONS BASED ON A REVISED PHASE/SEQUENCE UNTIL WRITTEN APPROVAL IS OBTAINED FROM HE ENGINEER. IF AT ANY TIME DURING CONSTRUCTION THE CONTRACTOR'S PROPOSED PLAN OF OPERATION FOR HANDLING TRAFFIC DOES NOT PROVIDE FOR SAFE AND COMFORTABLE MOVEMENT, THE CONTRACTOR WILL IMMEDIATELY CHANGE THEIR OPERATION TO CORRECT THE UNSATISFACTORY CONDITION.
- DO NOT STORE ANY CONSTRUCTION MATERIAL OR EQUIPMENT AT ANY LOCATION THAT WILL CONSTITUTE A HAZARD AND WILL ENDANGER TRAFFIC.
- THE CONTRACTOR WILL PROVIDE ADVANCE NOTIFICATION TO THE ENGINEER OF IMPENDING / UPCOMING LANE CLOSURES FOR ALL TEMPORARY AND / OR PERMANENT LANE, RAMP, CONNECTOR, FRONTAGE, SHOULDER, ETC. CLOSURES OR DETOURS. SEE GENERAL NOTES FOR NOTIFICATION REQUIREMENTS.
- ACCESS TO ADJOINING PROPERTY MUST BE MAINTAINED AT ALL TIMES.
- TEMPORARY DRAINAGE IS THE RESPONSIBILITY OF THE CONTRACTOR.
- AT NO TIME SHALL TWO CONSECUTIVE INTERSECTING ROADWAYS BE CLOSED AT ONE TIME DURING CONSTRUCTION.
- AT NO TIME SHALL TWO CONSECUTIVE RAMPS BE CLOSED AT ONE TIME DURING CONSTRUCTION OR OVERLAY OPERATIONS.
- REMOVAL AND DISPOSAL OF EXISTING ABANDONED UTILITIES (EITHER PREVIOUSLY ABANDONED OR ABANDONED DURING THIS PROJECT) REQUIRED TO SUPPORT THIS PROJECT'S CONSTRUCTION SHALL BE PERFORMED UNDER THE OVERALL PREPARE RIGHT-OF-WAY ITEM (ITEM 100).
- COORDINATE WITH ADJACENT PROJECTS.
- COVER PERMANENT SIGNS IF NOT USED. THIS IS SUBSIDIARY TO ITEM 502.
- EXCAVATION WITHIN 5 FEET OF AN EXISTING CPS ENERGY POLE WILL REQUIRE POLE BRACING. CONTACT CPS ENERGY UTILITY COORDINATION TO REQUEST POLE BRACING. THE ESTIMATED DURATION FOR THE POLE BRACING PROCESS IS APPROXIMATELY 6 TO 8 WEEKS.
- COORDINATE WITH THE CITY OF SAN ANTONIO OR TXDOT FOR SIGNAL TIMING REVISIONS, AS NECESSARY.

2. SEQUENCE OF WORK

THE SEQUENCE OF WORK WILL BE AS FOLLOWS UNLESS OTHERWISE DIRECTED/APPROVED BY THE TXDOT INSPECTOR. THIS PROJECT WILL BE CONSTRUCTED IN (2) PHASES. BEFORE THE COMMENCEMENT OF EACH PHASE, INSTALL TRAFFIC CONTROL DEVICES AND SW3P MEASURES AS SHOWN AND/OR DIRECTED BY THE TXDOT INSPECTOR. APPROVAL BY THE ENGINEER MUST BE OBTAINED PRIOR TO THE BEGINNING OF CONSTRUCTION. REFER TO "BARRICADES AND CONSTRUCTION STANDARDS". A BRIEF DESCRIPTION OF THESE PHASES ARE AS FOLLOWS:

PHASE I:

THE INTENT OF PHASE I IS TO WIDEN THE EASTBOUND PAVEMENT FROM STA 177+53.93 TO STA 181+68.84. UTILIZE TRAFFIC CONTROL PLAN STANDARD TCP (2-4)-18 FOR PLACEMENT OF SIGNS AND BARRICADES. THE OUTSIDE LANE CLOSURE SHALL BE OPEN BACK TO TRAFFIC AT THE END OF EACH WORKING DAY AND VERTICAL DROP OFF SLOPES, AS PER TREATMENT FOR VARIOUS END CONDITIONS PLAN SHEET.

- INSTALL TEMPORARY SIGNS AND BARRICADES ACCORDING TO TCP TYPICAL AND TCP (2-4)-18 STANDARD.
- SET SW3P ELEMENTS AS SHOWN ON PLANS.
- CONSTRUCT THE EASTBOUND PAVEMENT AS SHOWN ON PLANS.
- DROP OFF CONDITIONS OF GREATER THAN 2" MUST HAVE A 3:1 SLOPE AT THE END OF EACH DAY.

PHASE II:

THE INTENT OF THIS PHASE IS TO PLACE ALL FINAL PAVEMENT MARKINGS, INSTALL FINAL SIGNAGE, AND CONDUCT FINAL PROJECT CLEAN-UP WORK.

3. SAFETY

- THE CONTRACTOR WILL PROVIDE, CONSTRUCT AND MAINTAIN BARRICADES AND SIGNS IN ACCORDANCE WITH STATE STANDARDS BC (1-12) 14. ANY SIGNS REQUIRED THAT ARE NOT DETAILED IN THE STANDARD SHEETS SHALL BE IN CONFORMANCE WITH THE "TEXAS MANUAL ON UNIFORM TRAFFIC CONTROL DEVICES FOR STREETS AND HIGHWAYS" AND THE "STANDARD HIGHWAY SIGN DESIGNS FOR TEXAS."
- BARRICADES AND WARNING SIGNS SHALL BE PLACED AS INDICATED ON THE PLANS. THIS SHALL BE CONSIDERED THE MINIMUM REQUIRED TO PROVIDE FOR THE SAFETY OF TRAFFIC DURING CONSTRUCTION. THE CONTRACTOR SHALL PROVIDE AND MAINTAIN OTHER SUCH BARRICADES AND SIGNS DEEMED NECESSARY BY THE ENGINEER OR AS DIRECTED BY FIELD CONDITIONS, TO PROVIDE FOR THE PASSAGE OF TRAFFIC IN SAFETY AT ALL TIMES.
- THE CONTRACTOR SHALL PROVIDE AND MAINTAIN FLAGGERS AS DIRECTED / APPROVED BY THE ENGINEER, AT SUCH POINTS, AND FOR SUCH PERIODS OF TIME AS MAY BE REQUIRED, TO PROVIDE FOR THE SAFETY OF THE TRAVELING PUBLIC AND THE CONTRACTOR'S PERSONNEL.
- THE CONTRACTOR SHALL KEEP THE ROADWAY CLEAN AND FREE OF DIRT OR OTHER MATERIALS DURING HAULING OPERATIONS. IF THE CONTRACTOR DOES NOT MAINTAIN A CLEAN ROADWAY, THEY SHALL CEASE ALL CONSTRUCTION OPERATIONS, WHEN DIRECTED BY THE ENGINEER, TO CLEAN THE ROADWAY TO THE SATISFACTION OF THE ENGINEER.

4. HAULING EQUIPMENT

- THE USE OF RUBBER-TIRED EQUIPMENT WILL BE REQUIRED FOR MOVING DIRT OR OTHER MATERIALS ALONG OR ACROSS PAVED SURFACES. WHERE THE CONTRACTOR DESIRES TO MOVE ANY EQUIPMENT NOT LICENSED FOR OPERATION ON PUBLIC HIGHWAYS, ON OR ACROSS PAVEMENT, THEY SHALL PROTECT THE PAVEMENT FROM DAMAGE AS DIRECTED / APPROVED BY THE ENGINEER.
- THROUGHOUT CONSTRUCTION OPERATIONS, THE CONTRACTOR WILL BE REQUIRED TO CONDUCT THEIR HAULING OPERATIONS IN A MANNER SUCH THAT VEHICLES WILL NOT HAUL OVER PREVIOUSLY RECOMPACTED SUBGRADE OR COMPACTED BASE MATERIAL, EXCEPT N SHORT SECTIONS FOR DUMPING MANIPULATIONS.

5. FINAL CLEAN UP

UPON COMPLETION OF THE WORK AND BEFORE FINAL ACCEPTANCE AND FINAL PAYMENT IS MADE, THE CONTRACTOR SHALL CLEAR AND REMOVE FROM THE SITE ALL SURPLUS AND DISCARDED MATERIALS AND DEBRIS OF EVERY KIND AND LEAVE THE ENTIRE PROJECT IN A SMOOTH, NEAT AND SIGHTLY CONDITION.

6. PAYMENT

ALL BARRICADES, SIGNS, AND FLAGGERS SHALL BE SUBSIDIARY TO ITEM 502 BARRICADES, SIGNS AND TRAFFIC HANDLING. ALL EROSION AND SEDIMENT CONTROL DEVICES WILL BE PAID FOR UNDER ITEM 506 TEMPORARY EROSION, SEDIMENTATION, AND ENVIRONMENTAL CONTROLS. ALL WORK ZONE PAVEMENT MARKINGS WILL BE PAID FOR UNDER ITEM 662 WORK ZONE PAVEMENT MARKINGS. ALL OTHER WORK AND MATERIALS SHALL BE SUBSIDIARY TO THE VARIOUS BID ITEMS UNLESS OTHERWISE INDICATED IN THE PLANS.

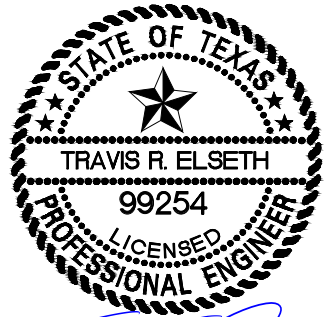

Handwritten signature of Travis R. Elseth and the date 7/8/24.

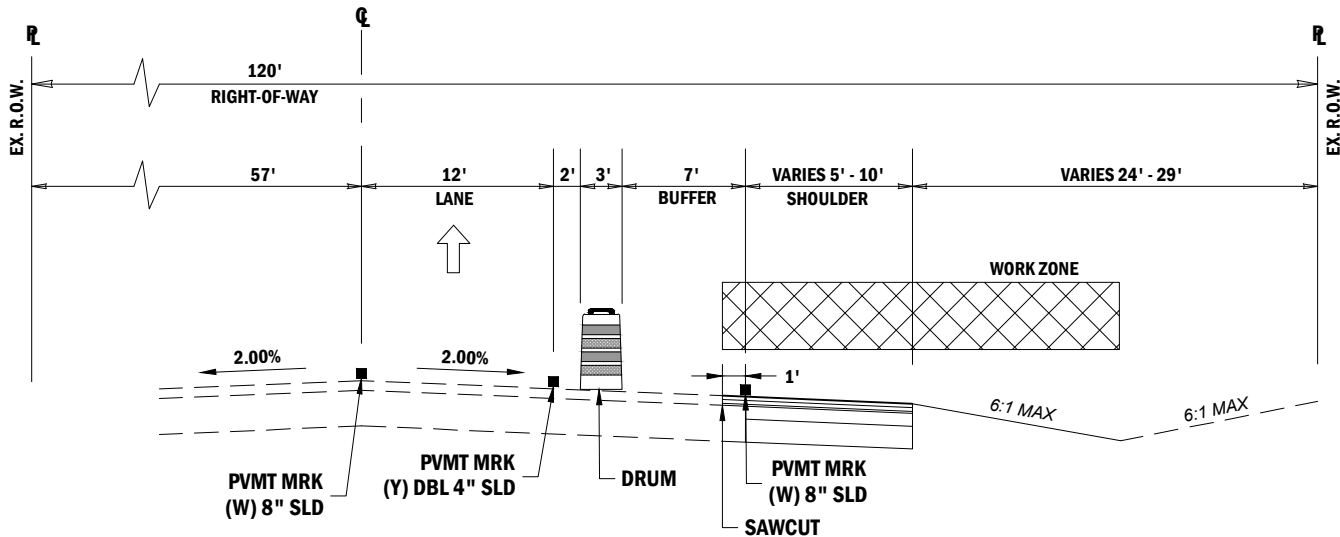

STATE HWY 122 SPUR TYPICAL SECTION
BEGIN TO END OF PROJECT

FED. RD. DIV. NO.		PROJECT NO.	
CONT	SECT	JOB	HIGHWAY
0100	02		122
DIST	COUNTY		SHEET NO.
15	BEXAR		6

REFL PAV MRKR TY I-C-R @ 20' O.C.

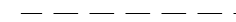

C

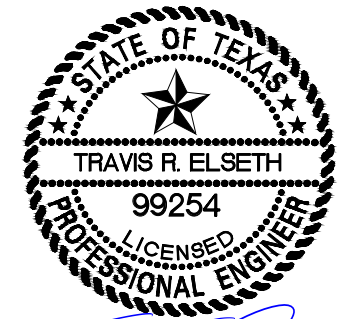
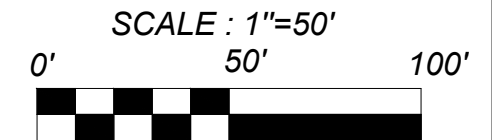

7/8/24

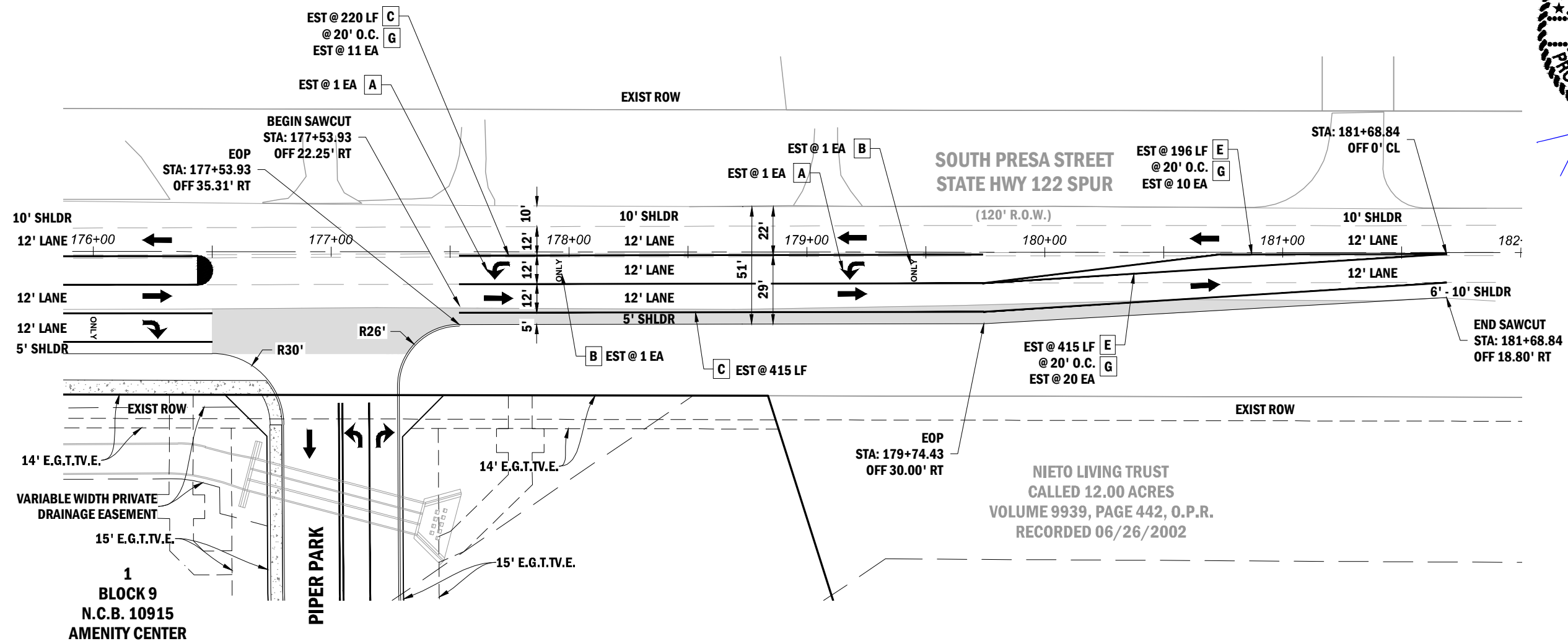

PRESA GROVE
BEXAR COUNTY, TEXAS

ROADWAY, SIGNING, MARKINGS AND DELINEATION

FED. RD. DIV. NO.	PROJECT NO.		
CONT	SECT	JOB	HIGHWAY
0100	02		122
DIST	COUNTY		SHEET NO.
15	BEXAR		7

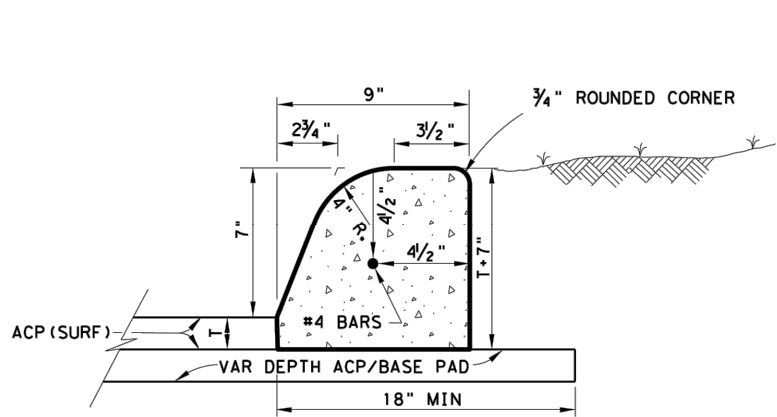

CONCRETE CURB (TYPE 1)
W/ ACP

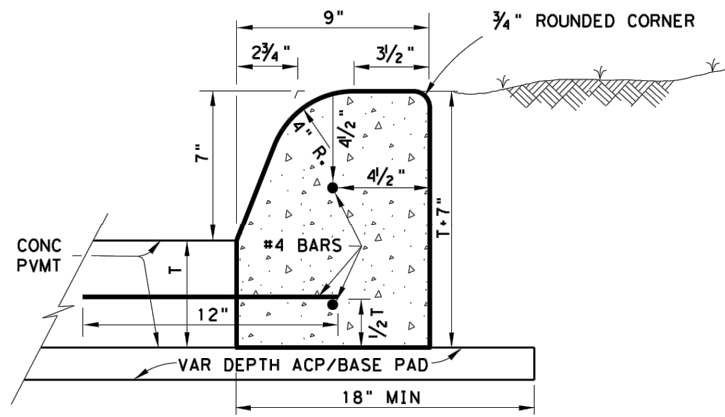

CONCRETE CURB (TYPE 1)
W/ CONC PAVEMENT

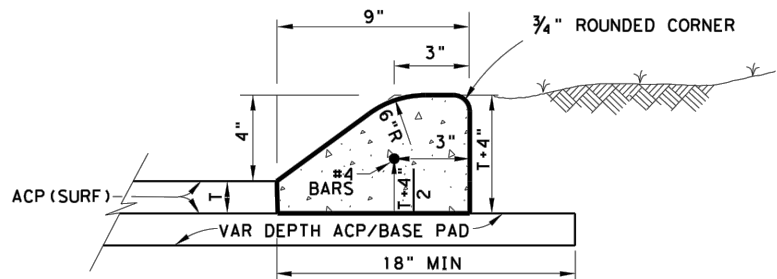

CONCRETE CURB (TYPE 2)
W/ ACP

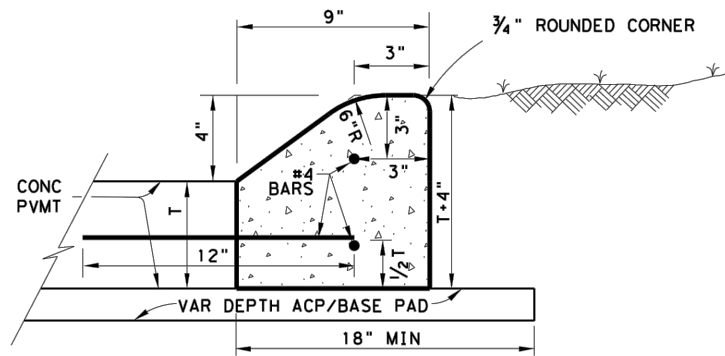

CONCRETE CURB (TYPE 2)
W/ CONC PAVEMENT

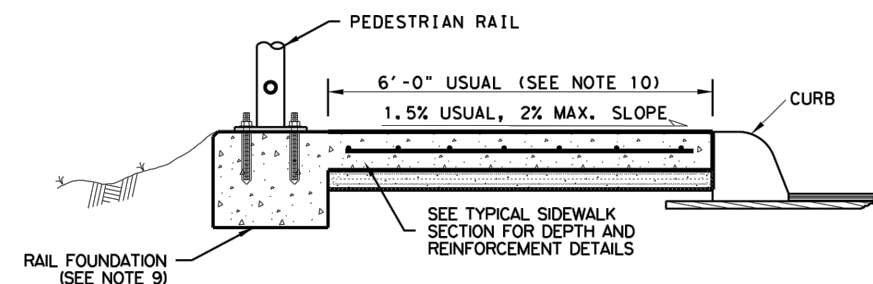

TYPICAL SIDEWALK SECTION
WITH PEDESTRIAN RAIL

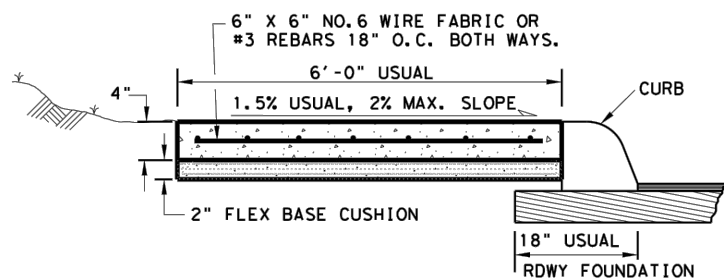

TYPICAL SIDEWALK SECTION

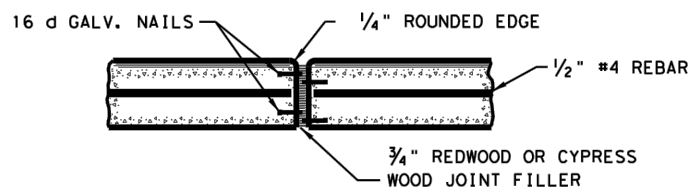

TYPICAL CURB EXPANSION JOINT DETAIL

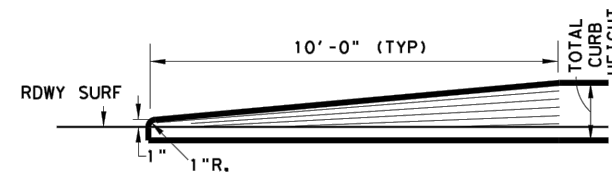

TRANSITION FOR CONCRETE CURB ENDS

SEE CURB DETAIL FOR REINFORCEMENT

GENERAL NOTES:

1. CONCRETE CURB TYPE 1 AND 2 SHOWN SHALL MEET THE MINIMUM SPECIFICATION REQUIREMENTS OF CLASS "A" CONCRETE PER ITEM 529 AND 421.
2. ALL REINFORCING STEEL SHALL BE GRADE 60
3. WHERE CONCRETE CURB IS PLACED ON EXISTING CONCRETE PAVEMENT, THE PAVEMENT SHALL BE DRILLED AND THE REINFORCING BARS GROUTED IN PLACE.
4. EXPANSION AND CONTRACTION JOINTS SHALL BE CONSTRUCTED TO MATCH PAVEMENT JOINTS IN ALL CURBS AND CURB AND GUTTER ADJACENT TO JOINTED CONCRETE PAVEMENT. WHERE PLACEMENT OF CURB OR CURB AND GUTTER IS NOT ADJACENT TO CONCRETE PAVEMENT, EXPANSION JOINTS SHALL BE PROVIDED AT STRUCTURES, CURB RETURNS AT STREETS, AND AT LOCATIONS DIRECTED BY THE ENGINEER.
5. VERTICAL AND HORIZONTAL DOWEL BARS AND TRANSVERSE REINFORCING BARS SHALL BE PLACED AT 4 FEET C-C, UNLESS OTHERWISE SHOWN.
6. ONE-HALF INCH EXPANSION JOINT MATERIAL SHALL BE PROVIDED WHERE CURB OR CURB AND GUTTER IS ADJACENT TO SIDEWALK OR RIPRAP, THIS IS SUBSIDIARY TO THE CURB, ITEM 529.
7. LAYDOWN CURB AT DRIVEWAYS WILL BE PAID AS SUBSIDIARY TO ITEM 530.
8. FOR SIDEWALK DETAILS AT DRIVEWAYS, SEE SAN ANTONIO DISTRICT STANDARD "DRIVEWAY DETAILS".
9. SEE PEDESTRIAN HANDRAIL DETAILS STANDARD "PRD" FOR MORE INFORMATION. CONCRETE RAIL FOUNDATION TO BE POURED WITH THE SIDEWALK BUT PAYMENT IS SUBSIDIARY TO ITEM 450 "RAILING".
10. CLEAR SIDEWALK WIDTH EXCLUDING THE PEDESTRIAN RAIL FOUNDATION SHALL BE 6' UNLESS OTHERWISE SPECIFIED IN THE PLANS

© 2020 Texas Department of Transportation
San Antonio District

**MISCELLANEOUS CURB
AND SIDEWALK DETAILS**
San Antonio District Standard
Sheet (1 of 2)

T:\Engdata\Standards\MiscCurbdetails.dgn		PREPARED BY AND FOR USE OF TxDOT.			
ORIGINAL DRAWING DATE:	STATE DISTRICT	FEDERAL REGION	FEDERAL AID PROJECT	SHEET	
09-01-08	SAT	6		8	
10-10-17 sidewalk width equals 6' usual	COUNTY	CONTROL	SECTION	JOB	HIGHWAY
07-22-20 9' curb + curb w/ conc pvmt det.	BEXAR				

GROOVED JOINTS IN THE SIDE WALK SHALL BE AT A MAX. SPACING OF 10 FT. AND SHALL HAVE 3/4" EXPANSION JOINTS AT A MAX. SPACING OF 60' AND TO COINSIDE WITH THE CURB EXP. JOINTS.

EXPANSION JOINTS TO BE PLACED AT BEGINNING AND END OF CURVES, DRIVEWAYS WHEELCHAIR RAMPS, INLETS, ILLUMINATION/ SIGNAL FOUNDATIONS AND OTHER FIXED OBJECTS.