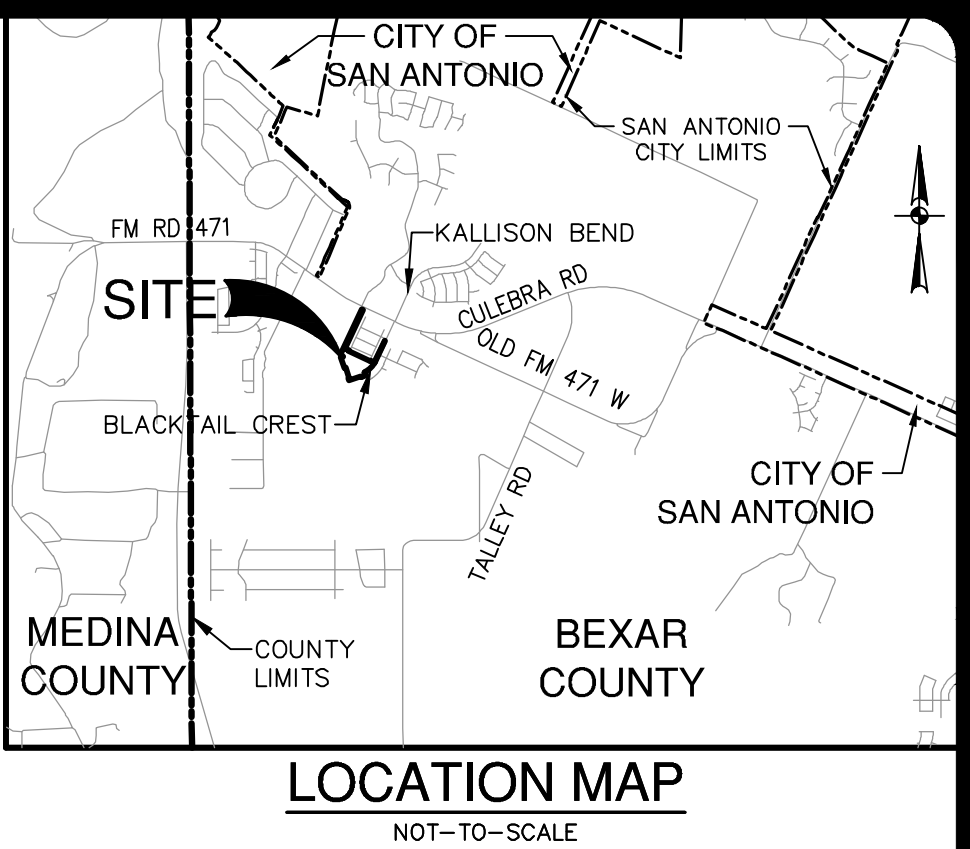
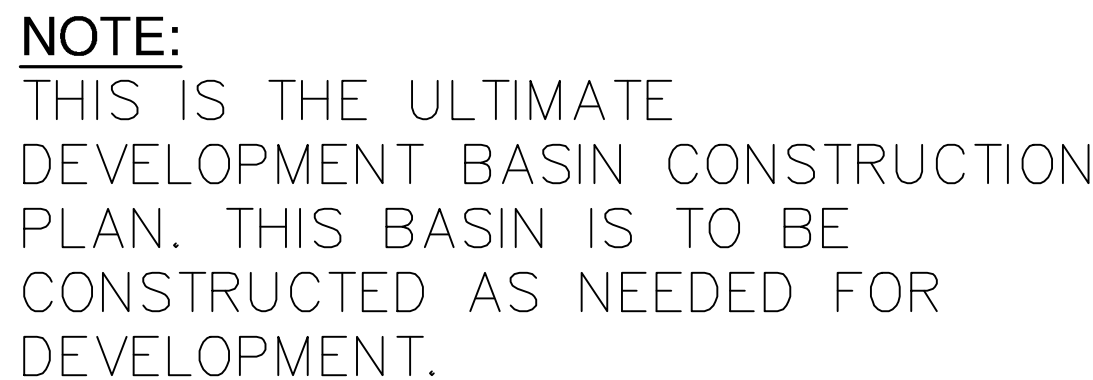
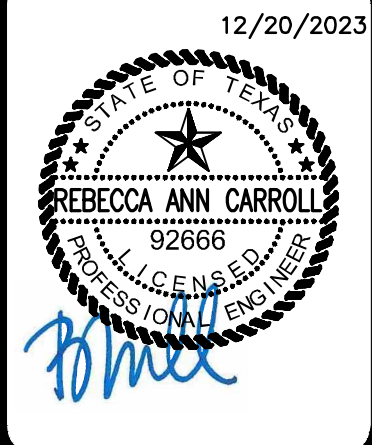

1. THE CONTRACTOR WILL BE RESPONSIBLE FOR DETERMINING EXACT LOCATION OF ALL UTILITIES AND DRAINAGE STRUCTURES WHETHER EXISTING OR NOT. PRIOR TO THE START OF CONSTRUCTION, THE CONTRACTOR SHALL UNCOVER EXISTING UTILITIES PRIOR TO CONSTRUCTION TO VERIFY SIZE, GRADE, AND LOCATION. THE CONTRACTOR SHALL NOTIFY THE ENGINEER IMMEDIATELY OF ANY DEVIATIONS FROM PLANS PRIOR TO BEGINNING CONSTRUCTION. ANY DAMAGE TO EXISTING UTILITIES, WHETHER SHOWN ON THE PLANS OR NOT, SHALL BE THE CONTRACTOR'S RESPONSIBILITY TO REPAIR, AT HIS EXPENSE.
2. ALL CONCRETE FOR TxDOT DRAINAGE STRUCTURES SHALL MEET TxDOT SPECIFICATIONS. ALL OTHER CONCRETE SHALL BE CLASS "A" 3000 PSI CYLINDER STRENGTH IN 28 DAYS.
3. REFERENCE DRAINAGE DETAILS FOR PIPE TRENCH DETAILS, BOX CULVERT, HEADWALL, AND WINGWALL CONSTRUCTION DETAILS, AND BOX CULVERT BEDDING AND EXCAVATION LIMITS.
4. CONTRACTOR SHALL GROUT ALL CURB INLETS AND JUNCTION BOXES TO PROVIDE FOR POSITIVE DRAINAGE.
5. EARTHEN CHANNELS WILL BE VEGETATED BY SEEDING OR SODDING. BOX OF THE CHANNEL SURFACE MUST HAVE ESTABLISHED VEGETATION BEFORE THE CITY OF SAN ANTONIO WILL ACCEPT.
6. CONTRACTOR SHALL MATCH TOP OF CHANNEL TO NATURAL GROUND SURFACE. MAINTAIN A MINIMUM CHANNEL DEPTH OF "D" AS SHOWN IN THE PROFILE.

CONTRACTOR AND/OR CONTRACTOR'S INDEPENDENTLY RETAINED EMPLOYEE OR STRUCTURAL DESIGN/ GEOTECHNICAL/ SAFETY/EQUIPMENT CONSULTANT, IF ANY, SHALL REVIEW THESE PLANS AND ANY AVAILABLE GEOTECHNICAL DATA AND RECORDS FOR THE PROJECT DESCRIBED IN THESE PLANS. THE PROJECT WORK AREA IN ORDER TO IMPLEMENT CONTRACTOR'S TRENCH EXCAVATION SAFETY PROTECTION SYSTEMS, PROGRAMS AND RECORDS. THE CONTRACTOR SHALL MAINTAIN AND PRESERVE ALL RECORDS OF THE CONTRACTOR'S IMPLEMENTATION OF THESE SYSTEMS, PROGRAMS, AND/OR PROCEDURES SHALL PROVIDE FOR ADEQUATE TRENCH EXCAVATION SAFETY PROTECTION THAT COMPLY WITH AS A MINIMUM, OSHA STANDARDS AND ANY APPLICABLE STATE OR LOCAL REGULATIONS. CONTRACTOR'S INDEPENDENTLY RETAINED EMPLOYEE OR SAFETY CONSULTANT SHALL IMPLEMENT A TRENCH SAFETY PROGRAM IN ACCORDANCE WITH THE TRENCH EXCAVATION SAFETY PROTECTION ACTIVITIES OF INDIVIDUALS WORKING IN AND AROUND TRENCH EXCAVATION.

CAUTION!!

CONTRACTOR SHALL BE REQUIRED TO LOCATE ALL PUBLIC OR PRIVATE UTILITIES INCLUDING BUT NOT LIMITED TO: WATER, SEWER, TELEPHONE AND FIBER OPTIC LINES, SITE LIGHTING ELECTRIC, SECONDARY ELECTRIC, PRIMARY ELECTRIC, GAS, CABLE, AND TELEPHONE LINES. CONTRACTOR SHALL ADVISE ANY UTILITY CONFLICTS THAT ARISE SHOULD BE COMMUNICATED TO THE ENGINEER IMMEDIATELY AND PRIOR TO CONSTRUCTION. THE CONTRACTOR SHALL BE RESPONSIBLE FOR THE PROTECTION OF ALL UTILITIES FROM THE START OF CONSTRUCTION. ANY DAMAGE TO EXISTING UTILITIES SHALL BE THE SOLE RESPONSIBILITY OF THE CONTRACTOR AND THE REPAIR SHALL BE THE RESPONSIBILITY OF THE CONTRACTOR. THE UTILITY IS SHOWN ON THESE PLANS OR NOT.

[illegible]

PAPE-DAWSON
ENGINEERS

SAN ANTONIO | AUSTIN | HOUSTON | FORT WORTH | DALLAS
2000 NW LOOP 410 | SAN ANTONIO, TX 78213 | 210.375.9000
TYPE FIRM REGISTRATION #470 | TBPBLS FIRM REGISTRATION #10028600

PRESERVE AT CULEBRA-UNIT 3
BEXAR COUNTY, TEXAS

DETENTION BASIN
ULTIMATE DEVELOPMENT

PLAT NO. 21-11800169
 JOB NO. 11668-04
 DATE DECEMBER 2023
 DESIGNER JB
 CHECKED DRAWN JP
 SHEET 1 OF 1