

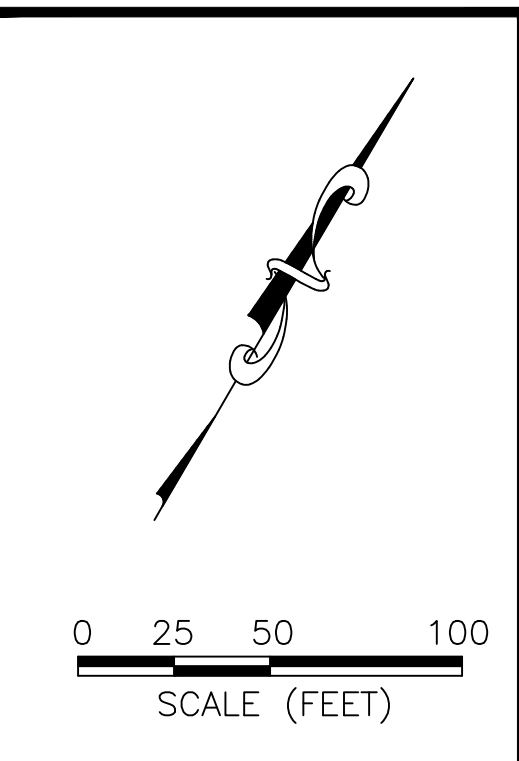

LOCATION MAP
N.T.S.

GVEC LEGEND

- 3-4" ABC PHASE - 1000MCM AL 25KV WITH (1) 2 1/2" PVC FOR FIBER
- 3-2 1/2" ABC PHASE - 1/0 AL 25KV
- 1-2 1/2" A PHASE - 1/0 AL 25KV
- 1-2 1/2" B PHASE - 1/0 AL 25KV
- 1-2 1/2" C PHASE - 1/0 AL 25KV
- 1-2 1/2" SECONDARY - 350 TPLX WITH (1) 2 1/2" SPARE CONDUIT
- 1-2 1/2" SECONDARY - 4/0 TPLX WITH (1) 2 1/2" SPARE CONDUIT
- 1-1" STREET LIGHT - 12/2 W/GND
- BACK OF P.U.E.
- SECONDARY PEDESTAL
- TRANSFORMER
- 200A 1Ø SWITCH CABINET
- 200A SWITCH CABINET
- SWITCHGEAR
- 600A ENCLOSURE
- EASEMENT AREA
- NEW OVH POWER LINE
- EXISTING OVH POWER LINE
- NEW POWER POLE
- EXISTING POWER POLE
- URD RISER
- STREET LIGHT
- ANCHOR



**WO# 2095279
95 LOTS
19 LIGHTS**

**UPLINE DEVICE
P401**

- GENERAL NOTES:**
- FOR FUTURE TEMPORARY SERVICE, STUB OUT (1) 2" FLEXIBLE ELECTRICAL PVC CONDUIT 6" BELOW GRADE CENTERED IN FRONT OF ALL TRANSFORMERS AND PEDESTALS. WHEN TEMPORARY SERVICE IS RETIRED, CUT OFF AND CAP 6" BELOW FINISHED GRAD.
 - VERIFY ALL UNDERGROUND UTILITIES BEFORE DIGGING.
 - GVEC TO HAVE 5' WIDE ELECTRIC EASEMENT ON ALL ROAD CROSSINGS IN WHICH ELECTRIC LINES ARE PLACED.
 - INSTALL THE CORRECT KV RATED PARKING STAND ARRESTORS AND LIGHTNING ARRESTORS FOR ALL OPEN POINT TRANSFORMERS.
 - ALL UNDERGROUND CONDUIT FOR GVEC ELECTRIC FACILITIES TO BE SCHEDULE 40, GRAY PVC UNLESS OTHERWISE SPECIFIED BY GVEC STAFF.
 - ALL CROSSINGS TO BE INSTALLED BY THE DEVELOPER'S CIVIL CONTRACTOR ACCORDING TO THE GVEC APPROVED FOR CONSTRUCTION DESIGN.
 - ALL ROAD CROSSINGS MUST CROSS ANY WET UTILITIES THAT ARE IN THE ROADWAY OR ROW AS WELL AND BE INSPECTED BY GVEC PERSONNEL.
 - WATER PROVIDED BY: CITY OF SCHERTZ
 - SEWER PROVIDED BY: CITY OF SCHERTZ

MATERIAL LIST

Quantity	CJ	Description
11,600	U1/0AL25KV	1/0 AL 25KV Aluminum URD Primary Cable
3,680	U350ALTP	350 MCM URD Triplex Secondary Cable
1,060	U4/0ALTP	4/0 MCM URD Triplex Secondary Cable
1,950	U12/2UFWGRD	12/2 UF Copper with Ground Street Light Cable
28	UK6-350	Secondary Pedestal, Fed with 350 MCM URD Triplex
11	UK6-4-0	Secondary Pedestal, Fed with 4/0 MCM URD Triplex
19	M60-C3LED	54W LED Type 3 LT for Aluminum Pole
19	UP30-5AL	30ft Aluminum Street Light Pole
1,200	UPVC1	1" Schedule 40 PVC
20,900	UPVC2 1/2	2.5" Schedule 40 PVC
1	UVG5- Small	14.4 kv Single Phase Open Transformer (75kVA and below)
8	UVG7- Small	14.4 kv Single Phase Radial Transformer (75kVA and below)
1	UVG6- Large	14.4 kv Single Phase Radial Transformer (Over 100kVA)
7	UVG7-LARGE	14.4 kv Single Phase Loop Transformer (over 100 kVA)
8	100 PAD 14.4 120	100kVA Padmount Transformer
2	75 PAD 14.4 120	75kVA Padmount Transformer
7	50 PAD 14.4 120	50kVA Padmount Transformer
2	UVM31-2	1 Phase Switch Cabinet, 2-Way
2	UVM32-2	2 Phase Switch Cabinet, 2-Way
2	UVM33-4	3 Phase Switch Cabinet, 4-Way
1	UVM33-3	3 Phase Switch Cabinet, 3-Way
1	UVM2-6W#4-1-0	14.4kv Three Phase Pothead with Spare Wood Pole#4-1-0 OH

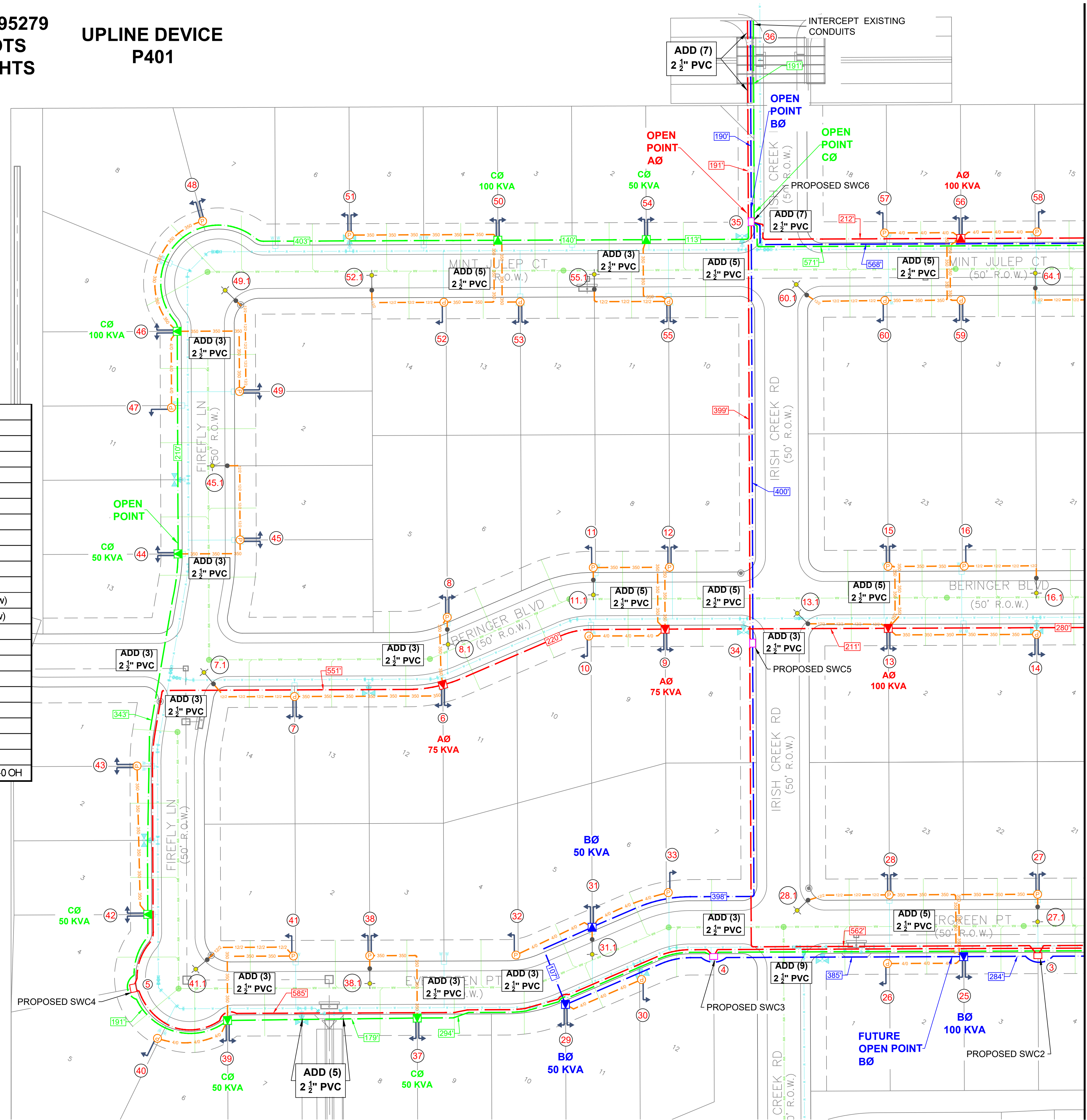
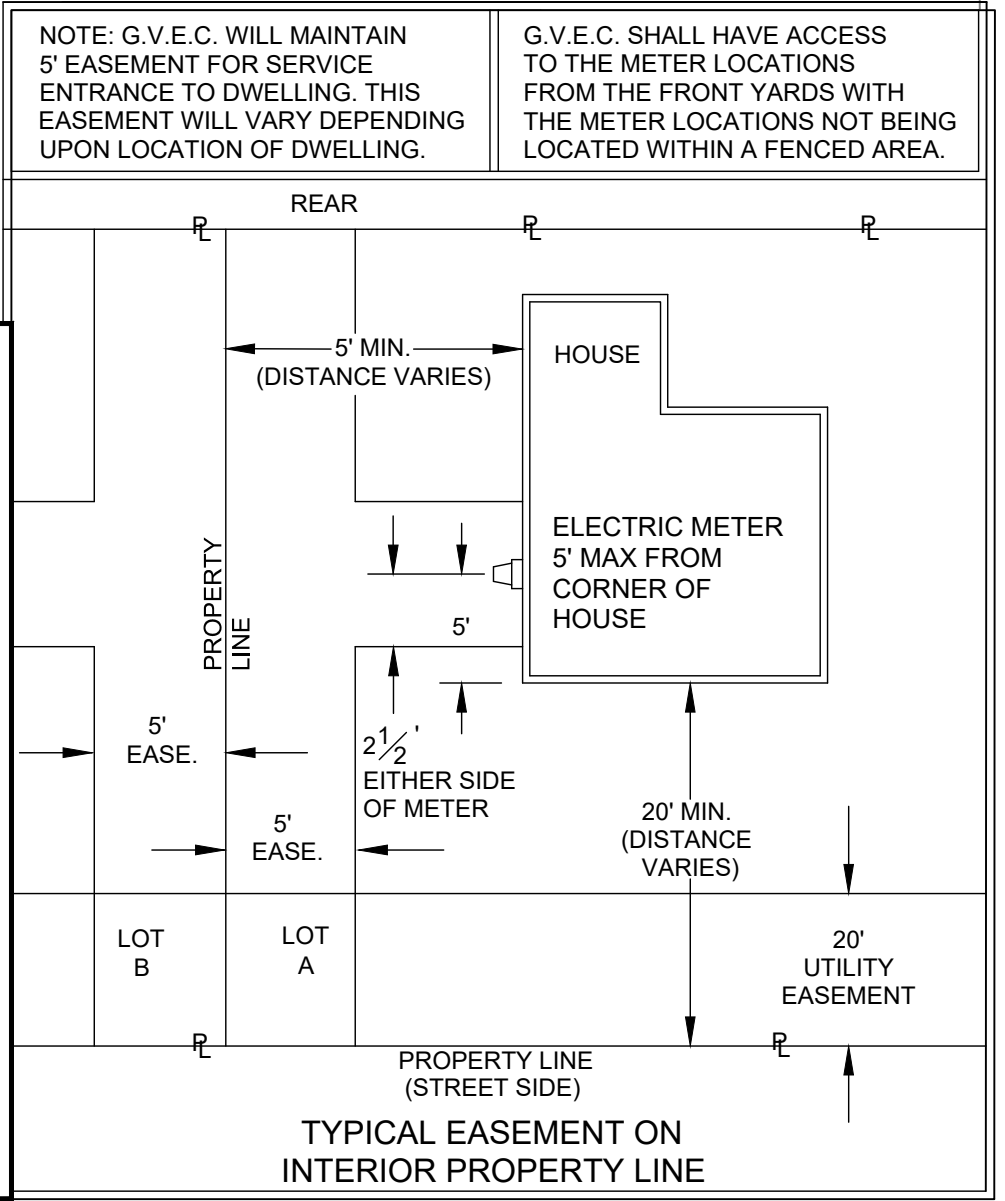
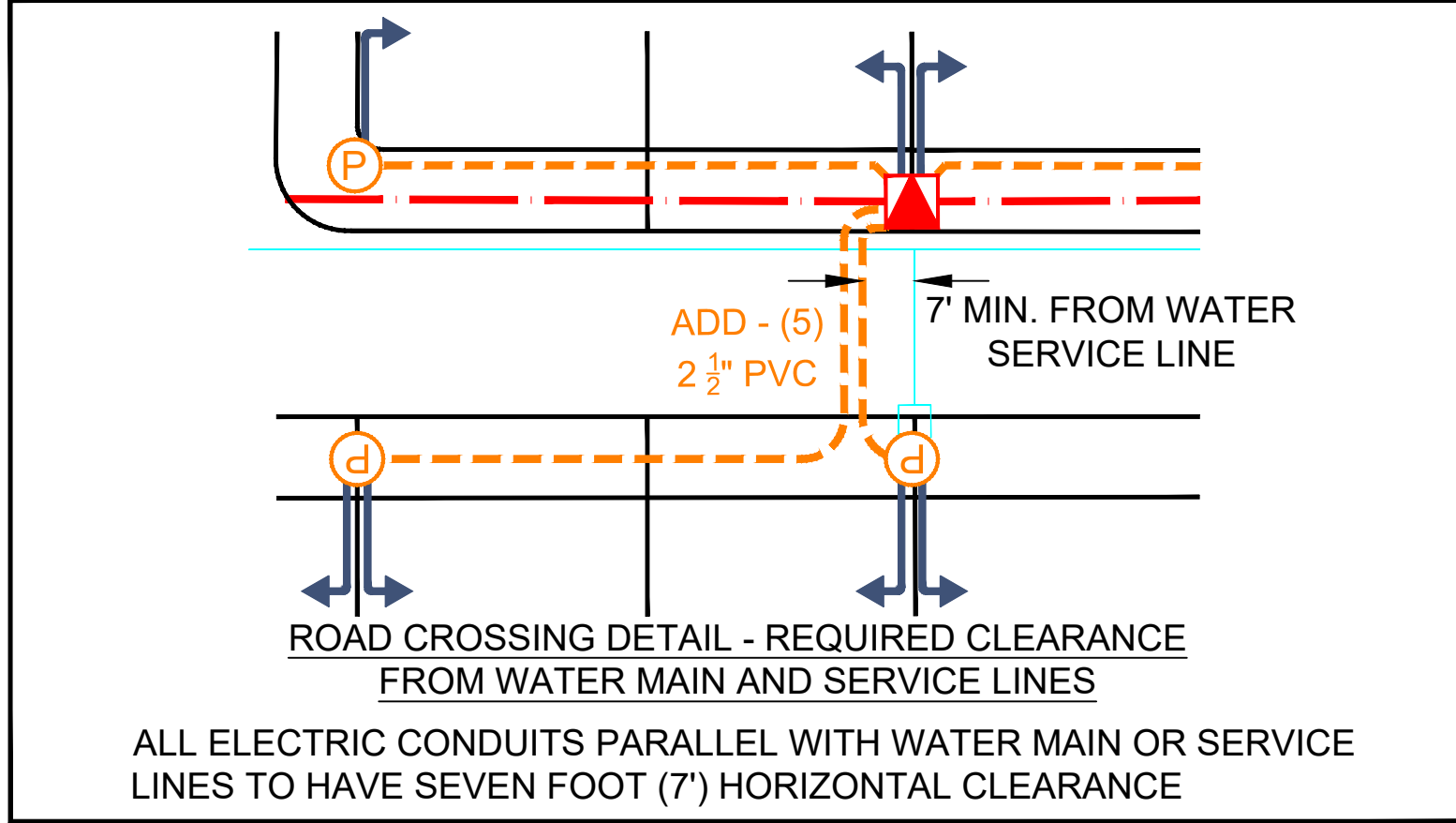
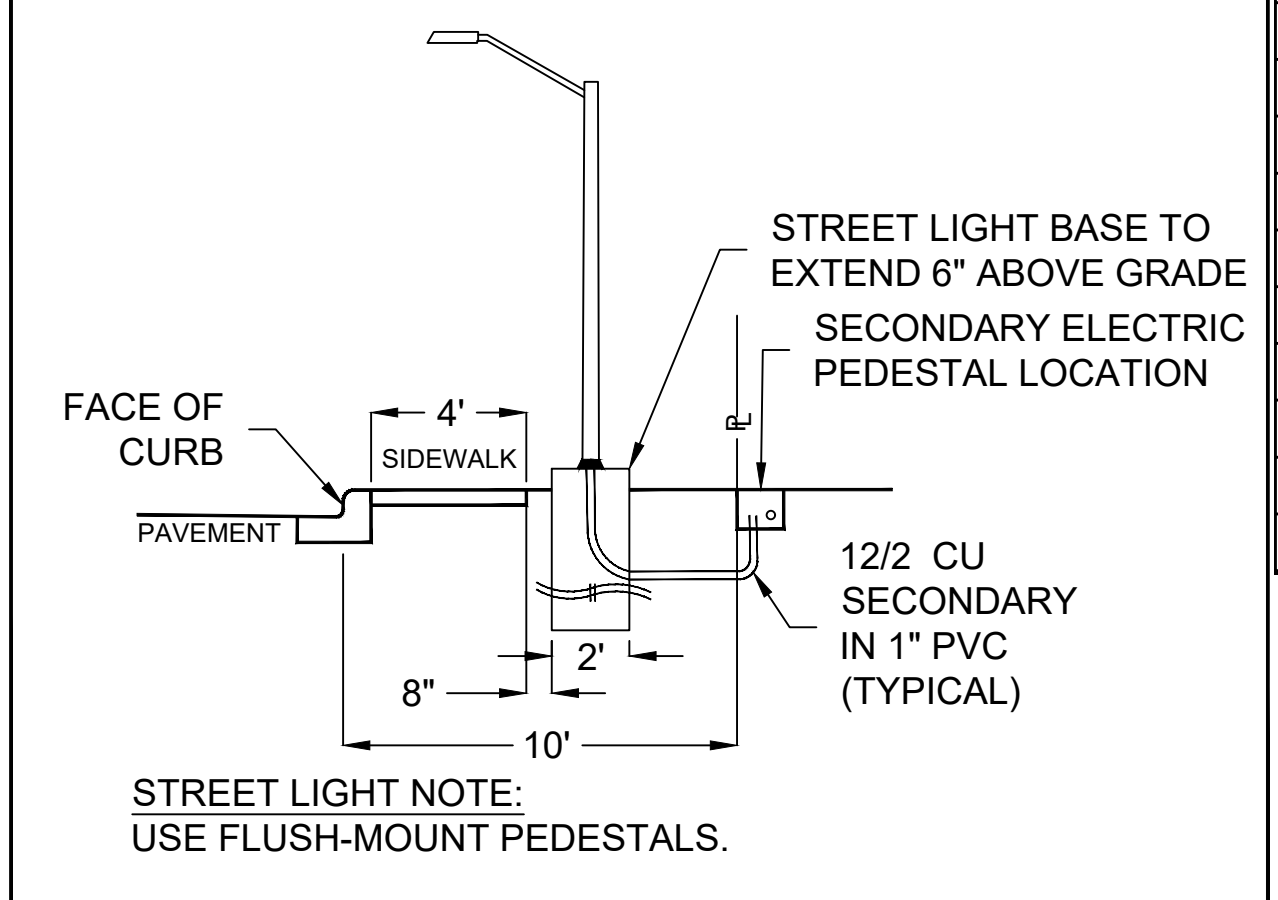

MATCHLINE - REFER TO SHEET 2

ISSUED FOR CONSTRUCTION

*** THE QUANTITIES SHOWN ON THE PLANS AND THE BID DOCUMENTS ARE ESTIMATED QUANTITIES AND BASED ON THE PLAN SET AND TO BE USED FOR BIDDING PURPOSE ONLY. THE CONTRACTOR IS RESPONSIBLE FOR DETERMINING ACTUAL QUANTITIES. THE CONTRACTOR SHALL BE RESPONSIBLE TO RESOLVE ANY PERCEIVED DISCREPANCIES IN THE QUANTITIES WITH THE OWNER PRIOR BEGINNING ANY CONSTRUCTION WORK.

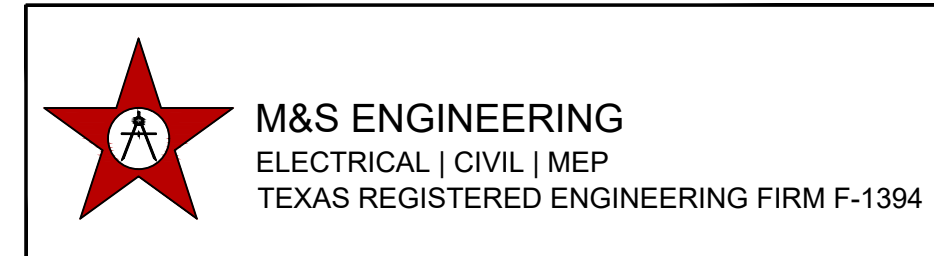

SAVANNAH FARMS UNIT 1

DESIGNER	S. KOHLENBERG	DATE	3/16/2026
SCALE	G. WILLIAMS	SCALE	SEE SCALE BAR
NO.	2095279	SHEET	1 OF 2

Date: 3/16/2026 9:40 AM User: JEFFREY KOHLENBERG File: T:\GVEC\2025\SAVANNAH FARMS UNIT 1\SAVANNAH FARMS UNIT 1.DWG

MATCHLINE - REFER TO SHEET 1

Date: 3/16/2026 9:40 AM User: JEFFREY KOHLENBERG
File: T:\GVEC\2025\SAVANNAH FARMS UNIT 1\SAVANNAH FARMS UNIT 1.DWG

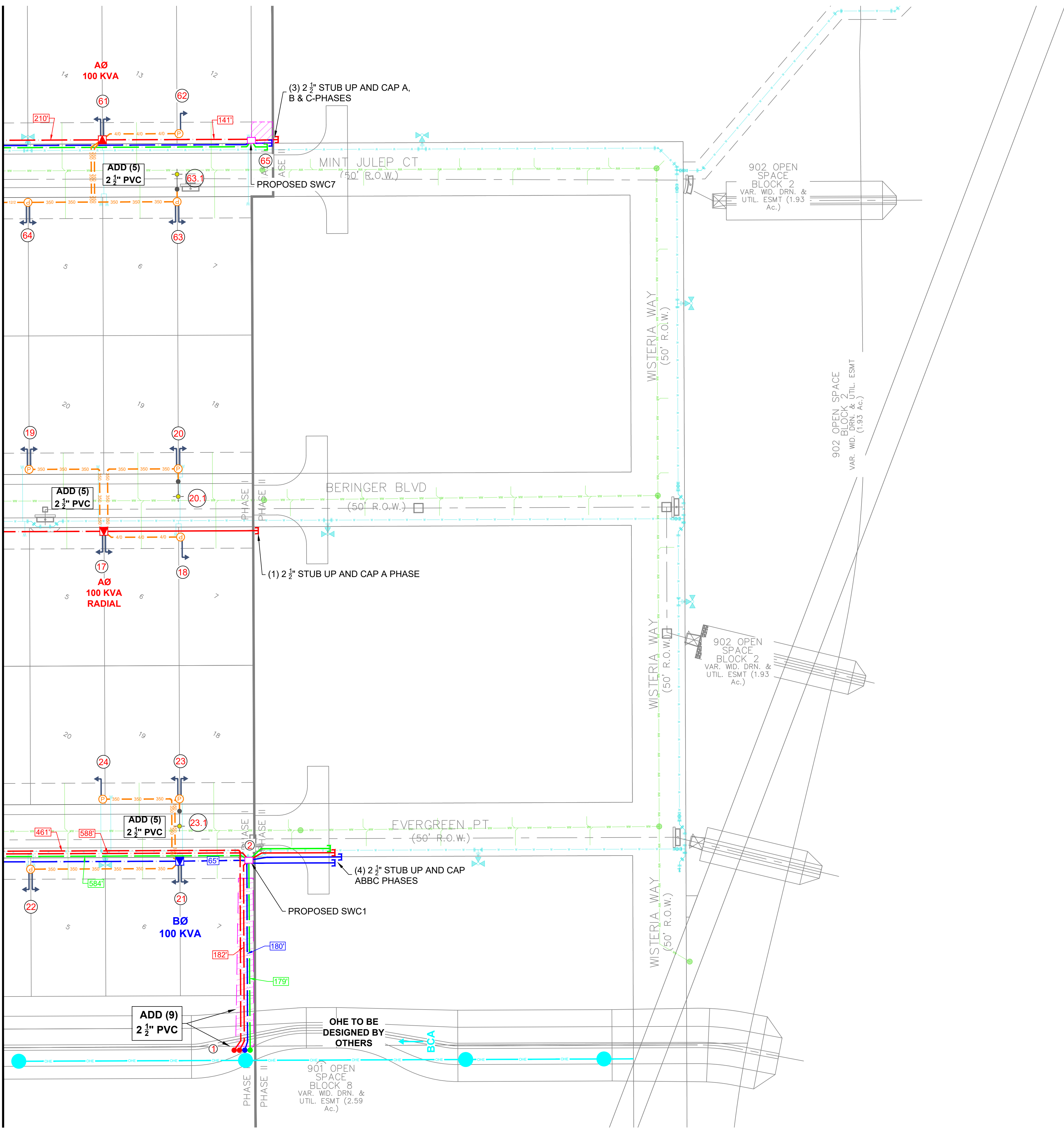

GVEC LEGEND

- 3-4" ABC PHASE - 1000MCM AL 25KV WITH (1) 2 1/2" PVC FOR FIBER
- 3-2 1/2" ABC PHASE - 1/0 AL 25KV
- 1-2 1/2" A PHASE - 1/0 AL 25KV
- 1-2 1/2" B PHASE - 1/0 AL 25KV
- 1-2 1/2" C PHASE - 1/0 AL 25KV
- 1-2 1/2" SECONDARY - 350 TPLX WITH (1) 2 1/2" SPARE CONDUIT
- 1-2 1/2" SECONDARY - 4/0 TPLX WITH (1) 2 1/2" SPARE CONDUIT
- 1-1" STREET LIGHT - 12/2 WGND
- BACK OF P.U.E.
- SECONDARY PEDESTAL
- TRANSFORMER
- 200A 1Ø SWITCH CABINET
- 200A SWITCH CABINET
- SWITCHGEAR
- 600A ENCLOSURE
- EASEMENT AREA
- NEW OVH POWER LINE
- EXISTING OVH POWER LINE
- NEW POWER POLE
- EXISTING POWER POLE
- URD RISER
- STREET LIGHT
- ANCHOR

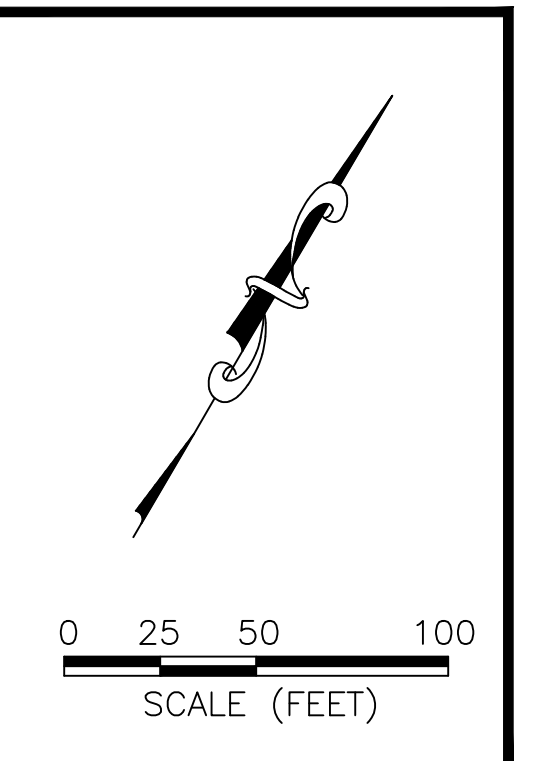

ISSUED FOR CONSTRUCTION

*** THE QUANTITIES SHOWN ON THE PLANS AND THE BID DOCUMENTS ARE ESTIMATED QUANTITIES AND BASED ON THE PLAN SET AND TO BE USED FOR BIDDING PURPOSE ONLY. THE CONTRACTOR IS RESPONSIBLE FOR DETERMINING ACTUAL QUANTITIES. THE CONTRACTOR SHALL BE RESPONSIBLE TO RESOLVE ANY PERCEIVED DISCREPANCIES IN THE QUANTITIES WITH THE OWNER PRIOR BEGINNING ANY CONSTRUCTION WORK.

M&S ENGINEERING
ELECTRICAL | CIVIL | MEP
TEXAS REGISTERED ENGINEERING FIRM F-1394

gvec
Delivering more.™

STATE OF TEXAS
JEROME J. VERNON
150144
LICENSED PROFESSIONAL ENGINEER
3/13/2026

SAVANNAH FARMS UNIT 1	
DESIGN: S.KOHLBERG	DATE: 3/16/2026
BY: G. WILLIAMS	SCALE: SEE SCALE BAR
NO: 2095279	PAGE: 2 OF 2

1 RISER POLE

I - (2) AØ RISER AND (2) 65A S&C FUSE
 (1) CØ RISER AND (1) 65A S&C FUSE
 (1) BØ RISER AND (1) 65A S&C FUSE

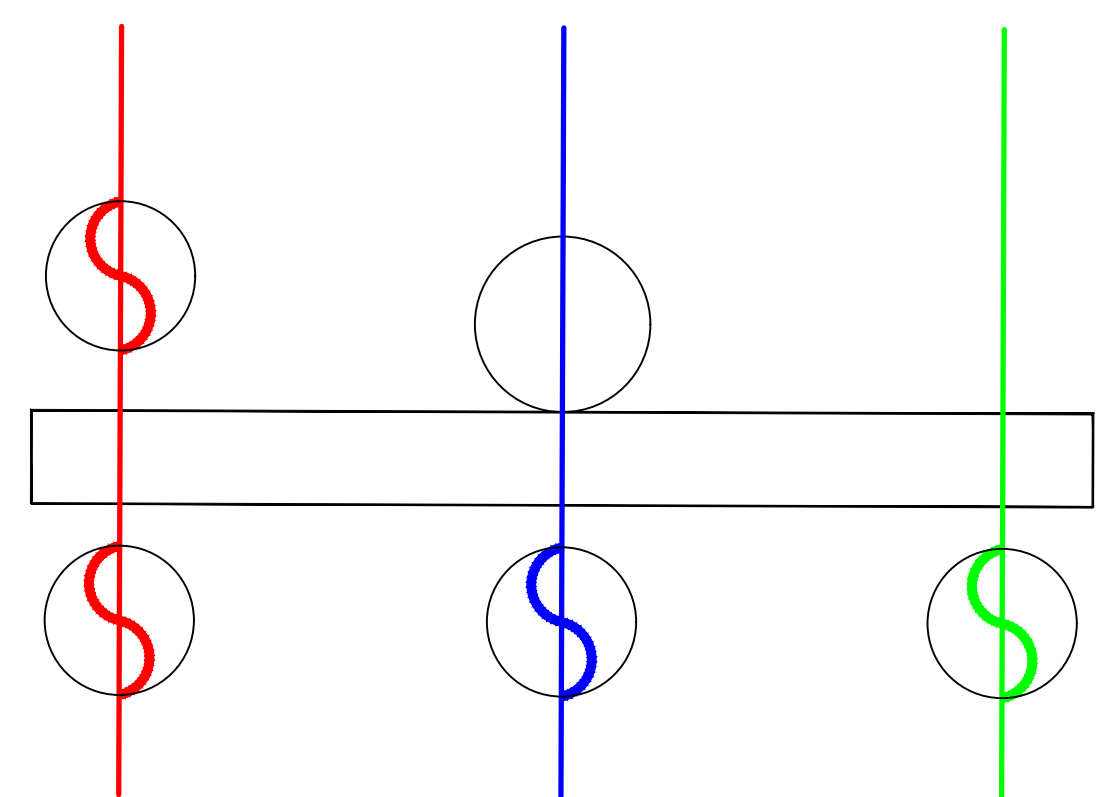

2 SWITCH CABINET 1

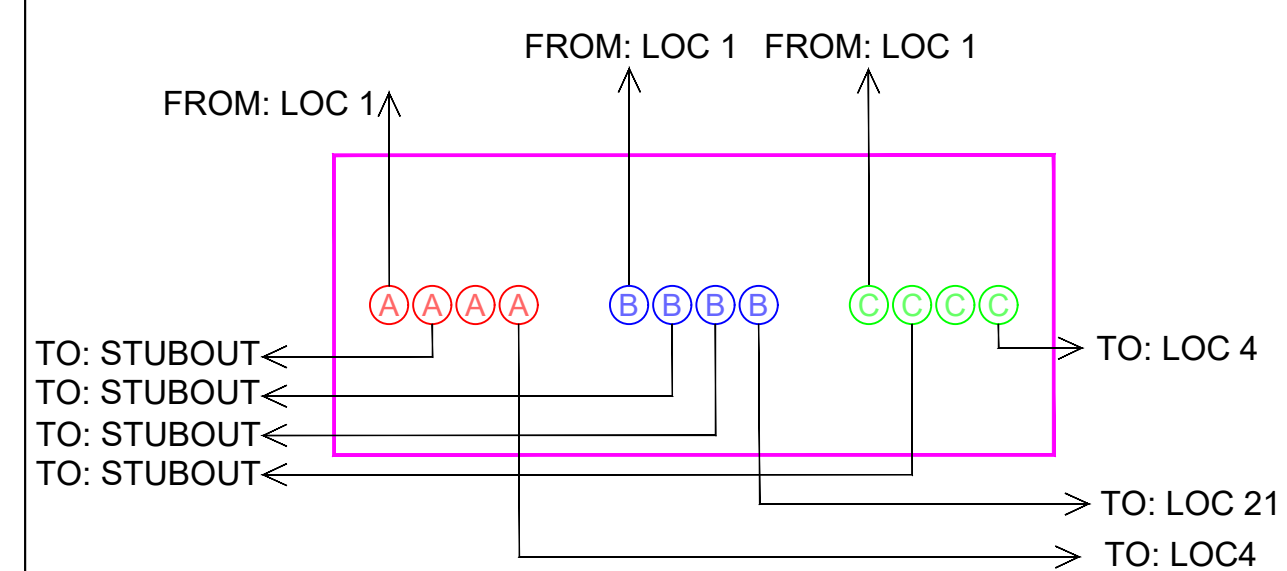

EVERGREEN PT

3 SWITCH CABINET 2

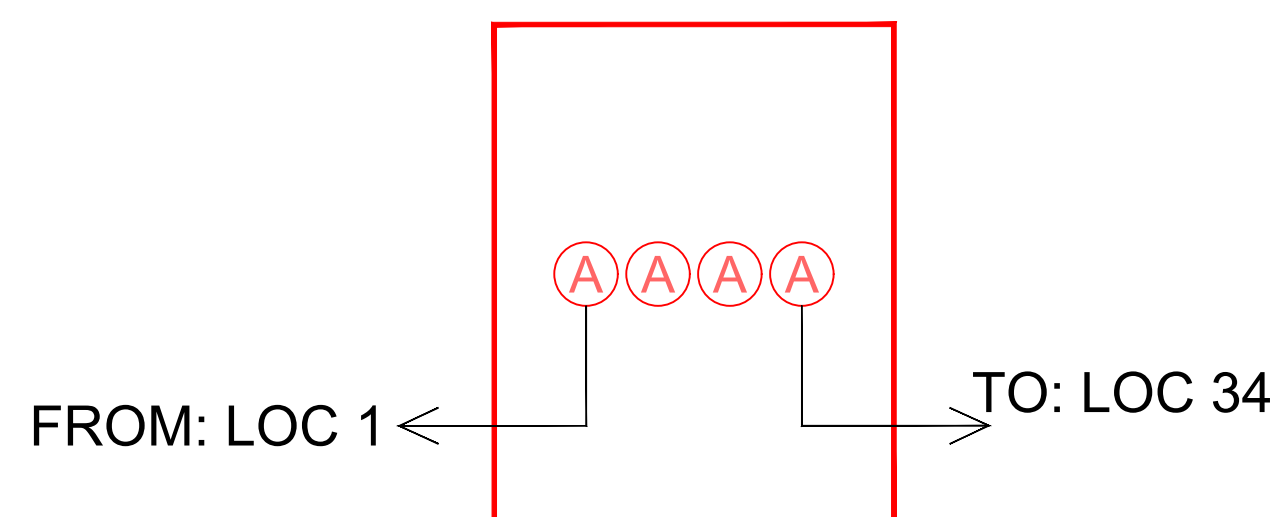

EVERGREEN PT

4 SWITCH CABINET 3

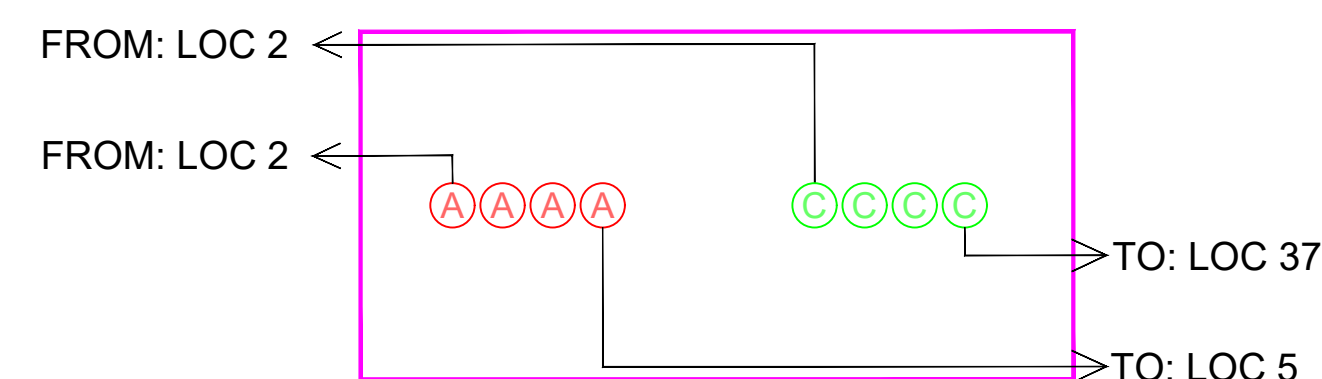

EVERGREEN PT

5 SWITCH CABINET 4

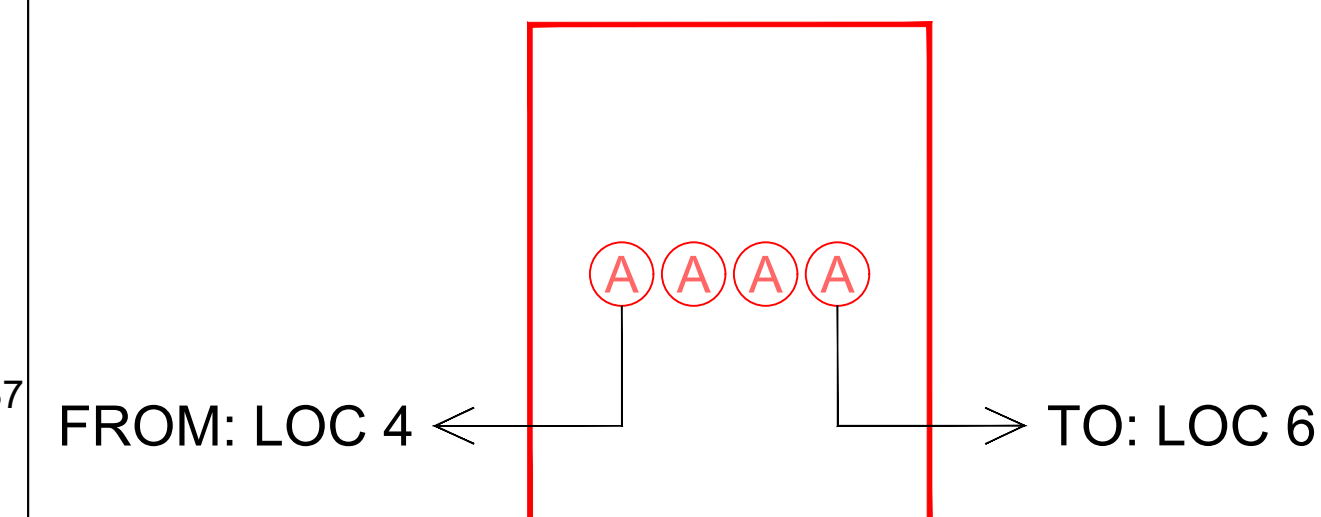

EVERGREEN PT

34 SWITCH CABINET 5

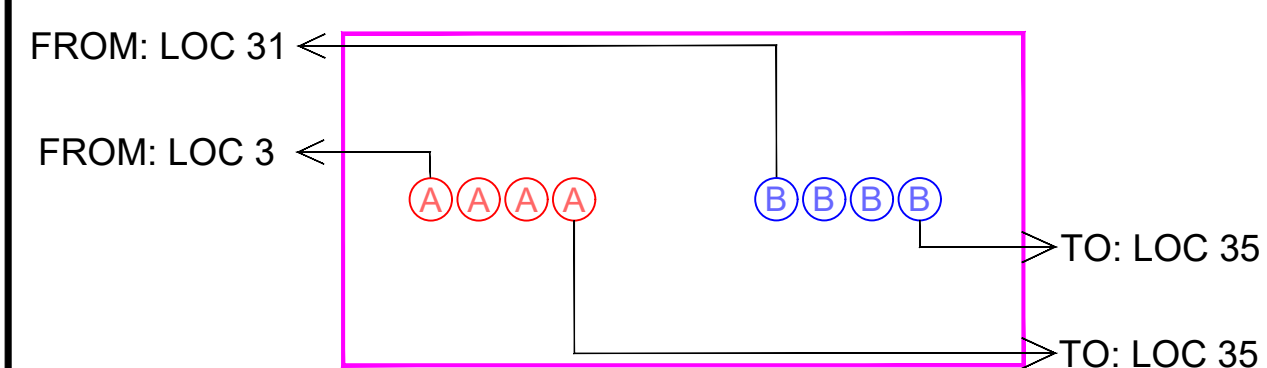

IRISH CREEK RD

35 SWITCH CABINET 6

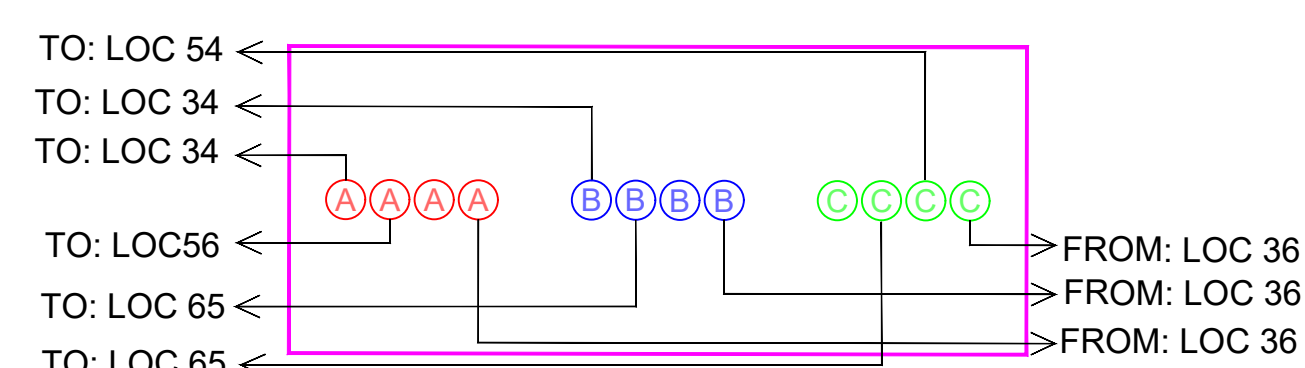

IRISH CREEK RD

65 SWITCH CABINET 7

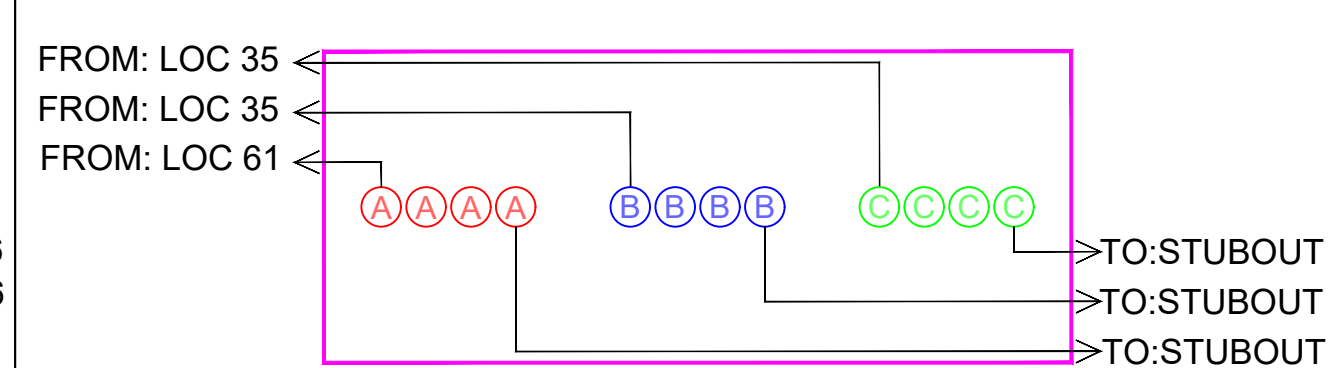

MINT JULEP CT



ISSUED FOR CONSTRUCTION

*** THE QUANTITIES SHOWN ON THE PLANS AND THE BID DOCUMENTS ARE ESTIMATED QUANTITIES AND BASED ON THE PLAN SET AND TO BE USED FOR BIDDING PURPOSE ONLY. THE CONTRACTOR IS RESPONSIBLE FOR DETERMINING ACTUAL QUANTITIES. THE CONTRACTOR SHALL BE RESPONSIBLE TO RESOLVE ANY PERCEIVED DISCREPANCIES IN THE QUANTITIES WITH THE OWNER PRIOR BEGINNING ANY CONSTRUCTION WORK.

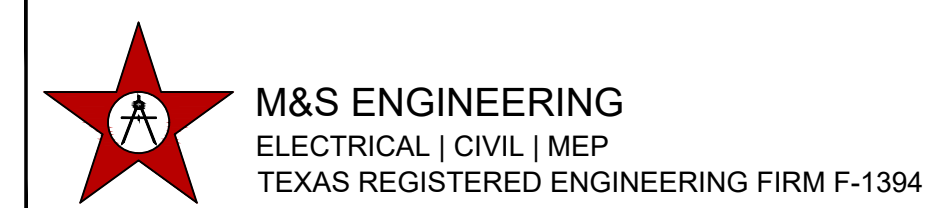

SAVANNAH FARMS UNIT 1	
DESIGN: S. KOHLENBERG	DATE: 3/16/2026
BY: G. WILLIAMS	SCALE: N/A
NO: 2095279	REV: DETAILS