

NO.	REVISION DESCRIPTION	REVISION DATE
1	GBR COMMENTS	06/03/2022
2	GVSD COMMENTS	06/17/2022
3	CONR COMMENTS REVIEW 4: PAVEMENT MARKING	06/20/2023

DATE:	JUNE 2023
DRAWN BY:	RR
DESIGNED BY:	MA
REVIEWED BY:	CC
HMT PROJECT NO.:	011.031

SHEET
C4.7

STREET PAVEMENT MARKINGS
(1 OF 7)

SOUTH POINT UNIT 4

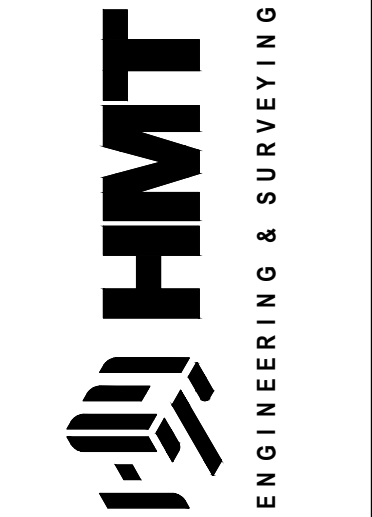

290 S. CASTELL AVE., STE. 100
NEW BRAUNFELS, TX 78130
TBPE FIRM F-10961
TBPLS FIRM 1053600

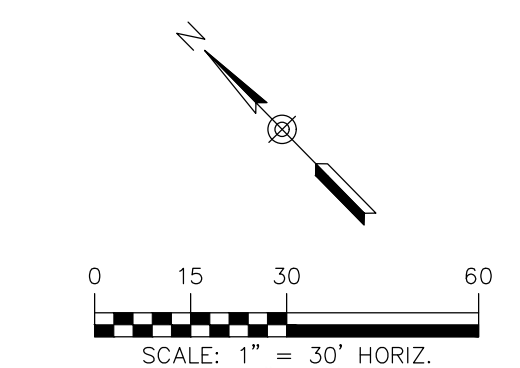
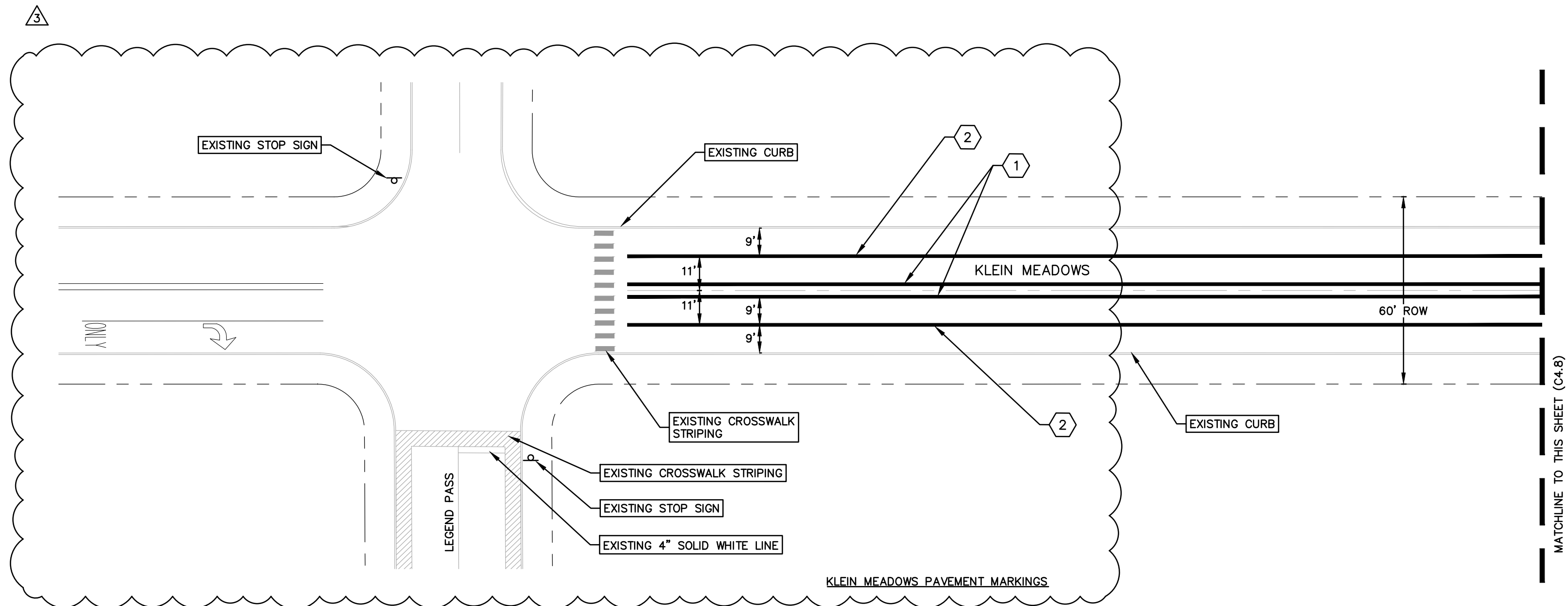
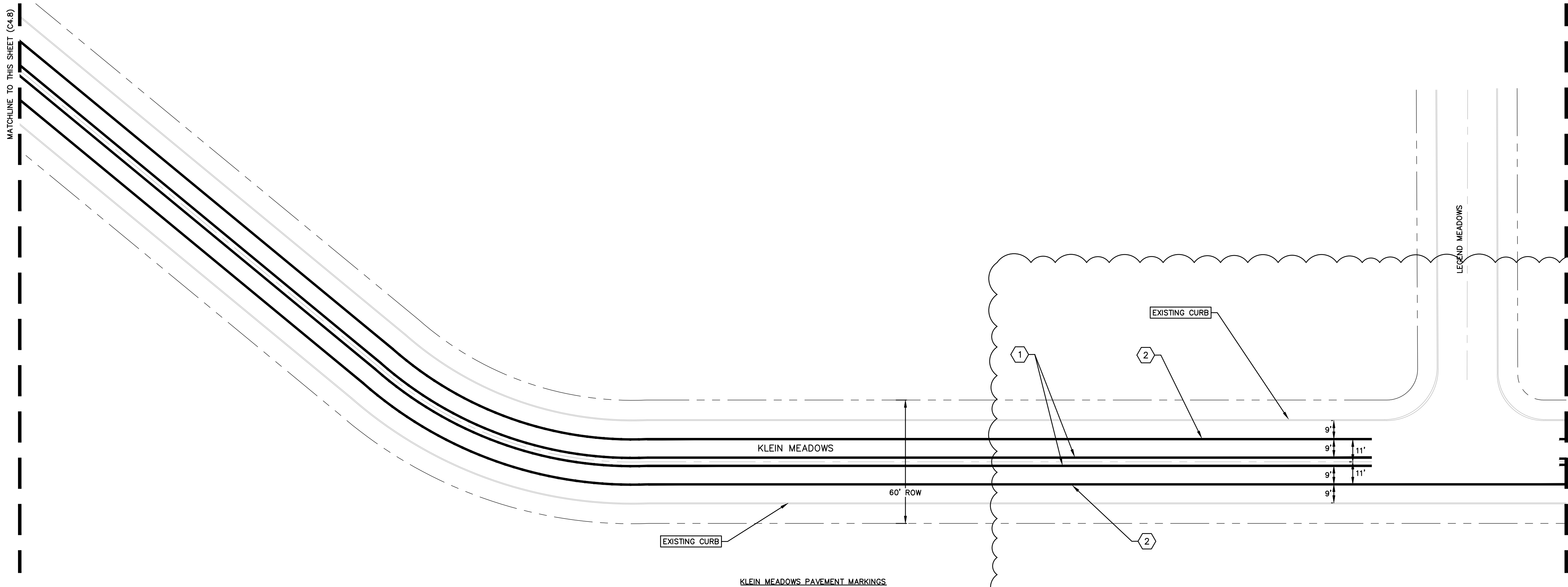

PAVEMENT MARKING LEGEND	
ITEM	NOTE
①	THERMOPLASTIC 4" DOUBLE YELLOW SOLID LINE W/ TYPE II A-A RAISED REFLECTIVE PAVEMENT MARKING SPACE AT 20' O.C.
②	THERMOPLASTIC 4" SINGLE WHITE SOLID EDGE LINE
③	THERMOPLASTIC WHITE TRAFFIC MARKING TEXT, TYPE I-C
④	THERMOPLASTIC WHITE ARROW, TYPE I-C
⑤	THERMOPLASTIC 24" WHITE CROSSWALK LINES
⑥	THERMOPLASTIC 24" WHITE STOP LINE
⑦	THERMOPLASTIC 8" SINGLE WHITE SOLID LINE W/ TYPE I-C RAISED REFLECTIVE PAVEMENT MARKING SPACE AT 20' O.C.

NOTE: REFER TO TxDOT DETAILS PM(1)-20, PM(2)-20, PM(3)-20, & PM(4)-20 ON SHEET C4.17

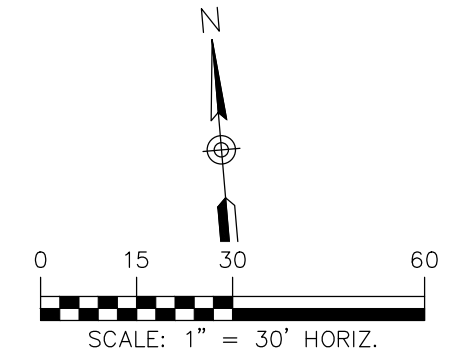

- LEGEND**
- B.L. BUILDING SETBACK LINE
U.E. UTILITY EASEMENT
D.E. DRAINAGE EASEMENT
A.D.A. RAMP
ACCESSIBLE CROSSING AREA
CONTRACTOR TO ENSURE MAX 2% CROSS SLOPE IN THESE AREAS
SIDEWALK RAMP TYPE
TO BE CONSTRUCTED AT TIME OF STREET CONSTRUCTION
(SEE DETAIL SHEET C4.7)
SIDEWALK TO BE CONSTRUCTED BY SITE DEVELOPMENT CONTRACTOR
SIDEWALK TO BE CONSTRUCTED WITH FUTURE UNIT

- NOTES**
- LOCAL STREETS WERE DESIGNED TO POSTED SPEED LIMIT OF **25** MPH.
 - IN WASHOUT CROWN AREAS, THE CURB ON THE HIGH SIDE OF THE STREET SHOULD BE SPILL CURB AS DESIGNATED ON THE PLANS.
 - CONTRACTOR TO CONSTRUCT SIDEWALK RAMPS WITH STREETS.
 - CONTRACTOR TO ENSURE POSITIVE DRAINAGE AWAY FROM STREET STUB OUT ENDS SO THAT NO "PONDING" OF WATER OCCURS.
 - PER NEW BRAUNFELS ORDINANCE SEC. 114-98(a)(6) ALL DRIVEWAY LOCATED ON A SINGLE FAMILY RESIDENCE ON A LOCAL STREET SHALL HAVE A MINIMUM SPACING OF 20'

SIGNAGE NOTES

INSTALLATION

THE CONTRACTOR SHALL FURNISH AND INSTALL ALL REGULATORY, WARNING AND STREET NAME SIGNS AND SIGN MOUNTS IN ACCORDANCE WITH APPROVED ENGINEERING PLANS.

MOUNTING

THE WEDGE ANCHOR STEEL SYSTEM AND THIN-WALLED TUBING POST SHALL BE USED FOR SIGNS WITH UP TO 10 SQUARE FEET OF SIGN AREA. MATERIALS AND INSTALLATION SHOULD FOLLOW THE TEXAS DEPARTMENT OF TRANSPORTATION (TxDOT) TRAFFIC STANDARDS SMD (GEN) - 08 AND SMD (TWT) - 08.

THE TRIANGULAR SLIP BASE SYSTEM AND 10 BWG TUBING POST SHALL BE USED FOR SIGNS THAT HAVE 10 TO 16 SQUARE FEET OF SIGN AREA. MATERIALS AND INSTALLATION SHOULD FOLLOW THE TxDOT TRAFFIC STANDARDS SMD (GEN) - 08 AND SMD (SLIP-1-3) - 08.

OBJECT MARKERS MATERIALS AND INSTALLATION SHOULD FOLLOW THE TxDOT TRAFFIC STANDARDS D & OM (1 - 5) - 10.

THE LOCATION OF ALL EXISTING UNDERGROUND UTILITIES ARE SHOWN IN APPROXIMATE LOCATIONS ONLY. THE CONTRACTOR SHALL DETERMINE THE EXACT LOCATION OF ALL EXISTING UTILITIES BEFORE COMMENCING WORK. THE CONTRACTOR WILL AGREE TO BE FULLY RESPONSIBLE FOR ANY AND ALL DAMAGES WHICH MIGHT BE INCURRED BY THEIR FAILURE TO EXACTLY LOCATE AND PRESERVE ANY AND ALL UNDERGROUND UTILITIES, STRUCTURES OR FACILITIES. CONTRACTOR SHALL NOTIFY ENGINEER OF ANY DISCREPANCIES 24-HOURS PRIOR TO COMMENCING CONSTRUCTION.

290 S. CASTELL AVE., STE. 100
NEW BRAUNFELS, TX 78130
TBPE FIRM F-10961
TBPLS FIRM 1053600

HMT
ENGINEERING & SURVEYING

STATE OF TEXAS
CHRISTOPHER J. CRIM
111347
LICENSED PROFESSIONAL ENGINEER
06/20/2023

STREET PAVEMENT MARKINGS
(2 OF 7)

SOUTH POINT UNIT 4

NO.	REVISION	DESCRIPTION	REVISION DATE
1	GBRA COMMENTS		06/03/2022
2	GVSD COMMENTS		08/17/2022
3	CONB COMMENTS	REVIEW 4: PAVEMENT MARKING	06/20/2023

DATE:	JUNE 2023
DRAWN BY:	RR
DESIGNED BY:	MA
REVIEWED BY:	CC

HMT PROJECT NO.:	011.031
SHEET	C4.8

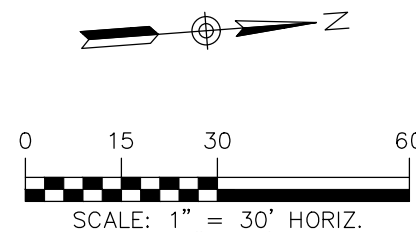
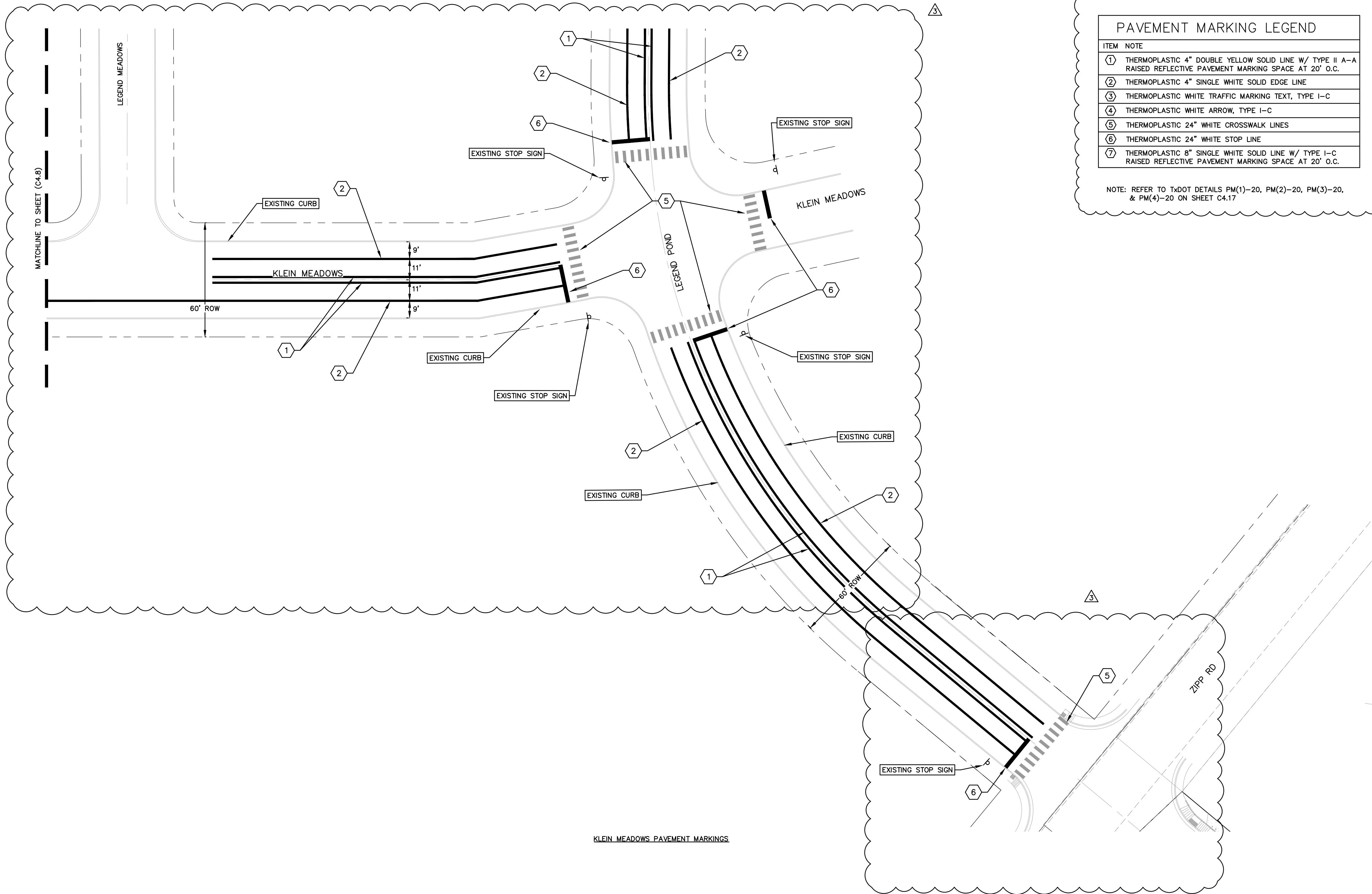

PAVEMENT MARKING LEGEND	
ITEM	NOTE
①	THERMOPLASTIC 4" DOUBLE YELLOW SOLID LINE W/ TYPE II A-A RAISED REFLECTIVE PAVEMENT MARKING SPACE AT 20' O.C.
②	THERMOPLASTIC 4" SINGLE WHITE SOLID EDGE LINE
③	THERMOPLASTIC WHITE TRAFFIC MARKING TEXT, TYPE I-C
④	THERMOPLASTIC WHITE ARROW, TYPE I-C
⑤	THERMOPLASTIC 24" WHITE CROSSWALK LINES
⑥	THERMOPLASTIC 24" WHITE STOP LINE
⑦	THERMOPLASTIC 8" SINGLE WHITE SOLID LINE W/ TYPE I-C RAISED REFLECTIVE PAVEMENT MARKING SPACE AT 20' O.C.

NOTE: REFER TO TxDOT DETAILS PM(1)-20, PM(2)-20, PM(3)-20, & PM(4)-20 ON SHEET C4.17

LEGEND	
B.L.	BUILDING SETBACK LINE
U.E.	UTILITY EASEMENT
D.E.	DRAINAGE EASEMENT
A.D.A. RAMP	ACCESSIBLE CROSSING AREA CONTRACTOR TO ENSURE MAX 2% CROSS SLOPE IN THESE AREAS
2.0% MAX	SIDEWALK RAMP TYPE TO BE CONSTRUCTED AT TIME OF STREET CONSTRUCTION (SEE DETAIL SHEET C4.7)
	SIDEWALK TO BE CONSTRUCTED BY SITE DEVELOPMENT CONTRACTOR
	SIDEWALK TO BE CONSTRUCTED WITH FUTURE UNIT

NOTES

- LOCAL STREETS WERE DESIGNED TO POSTED SPEED LIMIT OF **25 MPH**.
- IN WASHOUT CROWN AREAS, THE CURB ON THE HIGH SIDE OF THE STREET SHOULD BE SPILL CURB AS DESIGNATED ON THE PLANS.
- CONTRACTOR TO CONSTRUCT SIDEWALK RAMPS WITH STREETS.
- CONTRACTOR TO ENSURE POSITIVE DRAINAGE AWAY FROM STREET STUB OUT ENDS SO THAT NO "PONDING" OF WATER OCCURS.
- PER NEW BRAUNFELS ORDINANCE SEC. 114-98(a)(6) ALL DRIVEWAY LOCATED ON A SINGLE FAMILY RESIDENCE ON A LOCAL STREET SHALL HAVE A MINIMUM SPACING OF 20'

SIGNAGE NOTES

INSTALLATION

THE CONTRACTOR SHALL FURNISH AND INSTALL ALL REGULATORY, WARNING AND STREET NAME SIGNS AND SIGN MOUNTS IN ACCORDANCE WITH APPROVED ENGINEERING PLANS.

MOUNTING

THE WEDGE ANCHOR STEEL SYSTEM AND THIN-WALLED TUBING POST SHALL BE USED FOR SIGNS WITH UP TO 10 SQUARE FEET OF SIGN AREA. MATERIALS AND INSTALLATION SHOULD FOLLOW THE TEXAS DEPARTMENT OF TRANSPORTATION (TXDOT) TRAFFIC STANDARDS SMD (GEN) - 08 AND SMD (TWT) - 08.

THE TRIANGULAR SLIP BASE SYSTEM AND 10 BWG TUBING POST SHALL BE USED FOR SIGNS THAT HAVE 10 TO 16 SQUARE FEET OF SIGN AREA. MATERIALS AND INSTALLATION SHOULD FOLLOW THE TXDOT TRAFFIC STANDARDS SMD (GEN) - 08 AND SMD (SLIP-1-3)- 08.

OBJECT MARKERS MATERIALS AND INSTALLATION SHOULD FOLLOW THE TXDOT TRAFFIC STANDARDS D & OM (1 - 5) - 10.

THE LOCATION OF ALL EXISTING UNDERGROUND UTILITIES ARE SHOWN IN APPROXIMATE LOCATIONS ONLY. THE CONTRACTOR SHALL DETERMINE THE EXACT LOCATION OF ALL EXISTING UTILITIES BEFORE COMMENCING WORK. THE CONTRACTOR WILL AGREE TO BE FULLY RESPONSIBLE FOR ANY AND ALL DAMAGES WHICH MIGHT BE INCURRED BY THEIR FAILURE TO EXACTLY LOCATE AND PRESERVE ANY AND ALL UNDERGROUND UTILITIES, STRUCTURES OR FACILITIES. CONTRACTOR SHALL NOTIFY ENGINEER OF ANY DISCREPANCIES 24-HOURS PRIOR TO COMMENCING CONSTRUCTION.

290 S. CASTELL AVE., STE. 100
NEW BRAUNFELS, TX 78130
TBPE FIRM F-10961
TBPLS FIRM 1053600



STREET PAVEMENT MARKINGS
(3 OF 7)

SOUTH POINT UNIT 4

NO.	REVISION	DESCRIPTION	REVISION DATE
1	GBR	COMMENTS	06/03/2022
2	GVSD	COMMENTS	08/17/2022
3	CONR	COMMENTS REVIEW 4: PAVEMENT MARKING	06/20/2023

DATE: JUNE 2023

DRAWN BY: RR

DESIGNED BY: MA

REVIEWED BY: CC

HMT PROJECT NO.: 011.031

SHEET
C4.9

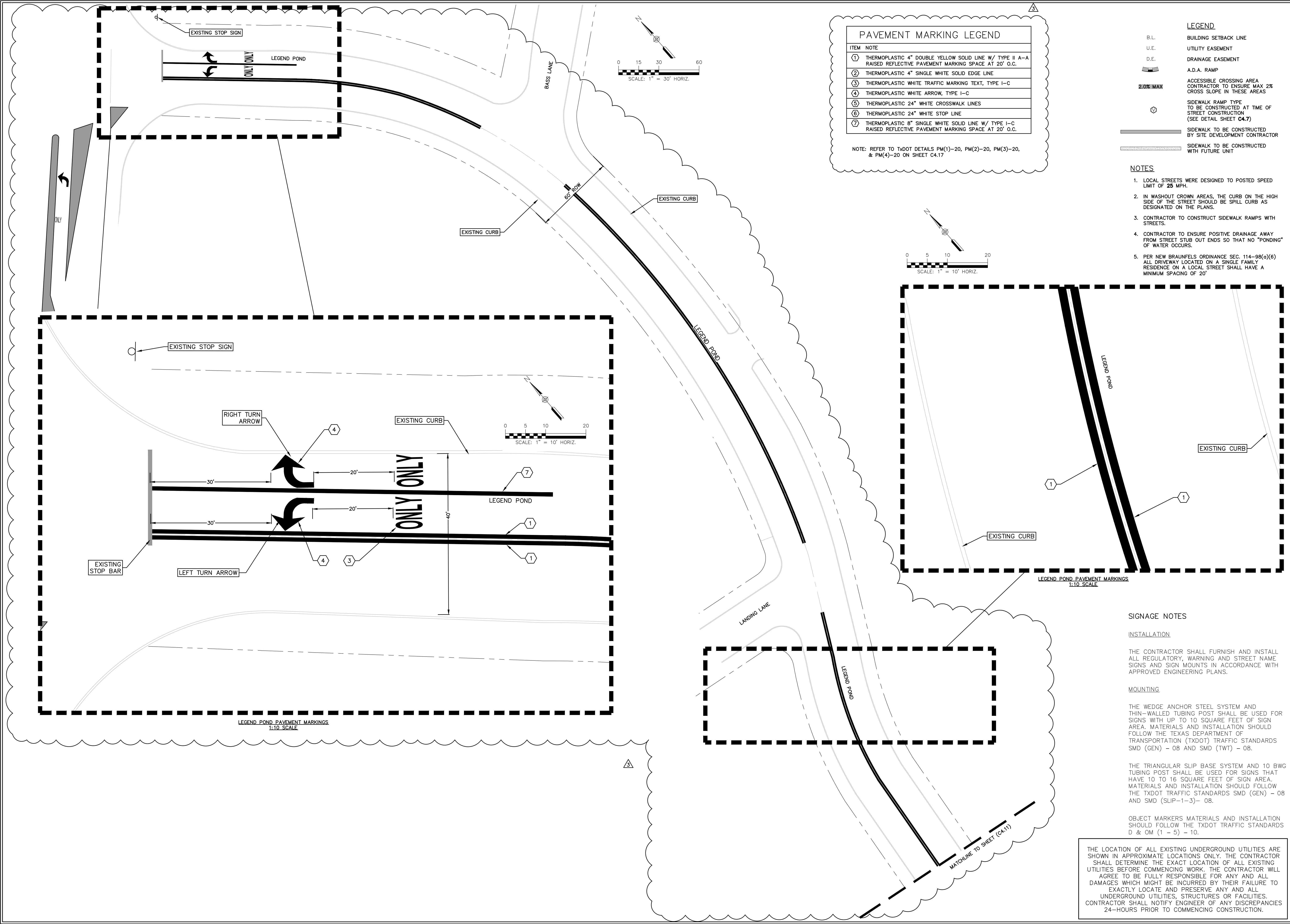

PAVEMENT MARKING LEGEND	
ITEM	NOTE
①	THERMOPLASTIC 4" DOUBLE YELLOW SOLID LINE W/ TYPE II A-A RAISED REFLECTIVE PAVEMENT MARKING SPACE AT 20' O.C.
②	THERMOPLASTIC 4" SINGLE WHITE SOLID EDGE LINE
③	THERMOPLASTIC WHITE TRAFFIC MARKING TEXT, TYPE I-C
④	THERMOPLASTIC WHITE ARROW, TYPE I-C
⑤	THERMOPLASTIC 24" WHITE CROSSWALK LINES
⑥	THERMOPLASTIC 24" WHITE STOP LINE
⑦	THERMOPLASTIC 8" SINGLE WHITE SOLID LINE W/ TYPE I-C RAISED REFLECTIVE PAVEMENT MARKING SPACE AT 20' O.C.

NOTE: REFER TO TxDOT DETAILS PM(1)-20, PM(2)-20, PM(3)-20, & PM(4)-20 ON SHEET C4.17

LEGEND	
B.L.	BUILDING SETBACK LINE
U.E.	UTILITY EASEMENT
D.E.	DRAINAGE EASEMENT
A.D.A. RAMP	ACCESSIBLE CROSSING AREA CONTRACTOR TO ENSURE MAX 2% CROSS SLOPE IN THESE AREAS
2.0% MAX	SIDEWALK RAMP TYPE TO BE CONSTRUCTED AT TIME OF STREET CONSTRUCTION (SEE DETAIL SHEET C4.7)
	SIDEWALK TO BE CONSTRUCTED BY SITE DEVELOPMENT CONTRACTOR
	SIDEWALK TO BE CONSTRUCTED WITH FUTURE UNIT

- NOTES
- LOCAL STREETS WERE DESIGNED TO POSTED SPEED LIMIT OF 25 MPH.
 - IN WASHOUT CROWN AREAS, THE CURB ON THE HIGH SIDE OF THE STREET SHOULD BE SPILL CURB AS DESIGNATED ON THE PLANS.
 - CONTRACTOR TO CONSTRUCT SIDEWALK RAMPS WITH STREETS.
 - CONTRACTOR TO ENSURE POSITIVE DRAINAGE AWAY FROM STREET STUB OUT ENDS SO THAT NO "PONDING" OF WATER OCCURS.
 - PER NEW BRAUNFELS ORDINANCE SEC. 114-98(a)(6) ALL DRIVEWAY LOCATED ON A SINGLE FAMILY RESIDENCE ON A LOCAL STREET SHALL HAVE A MINIMUM SPACING OF 20'

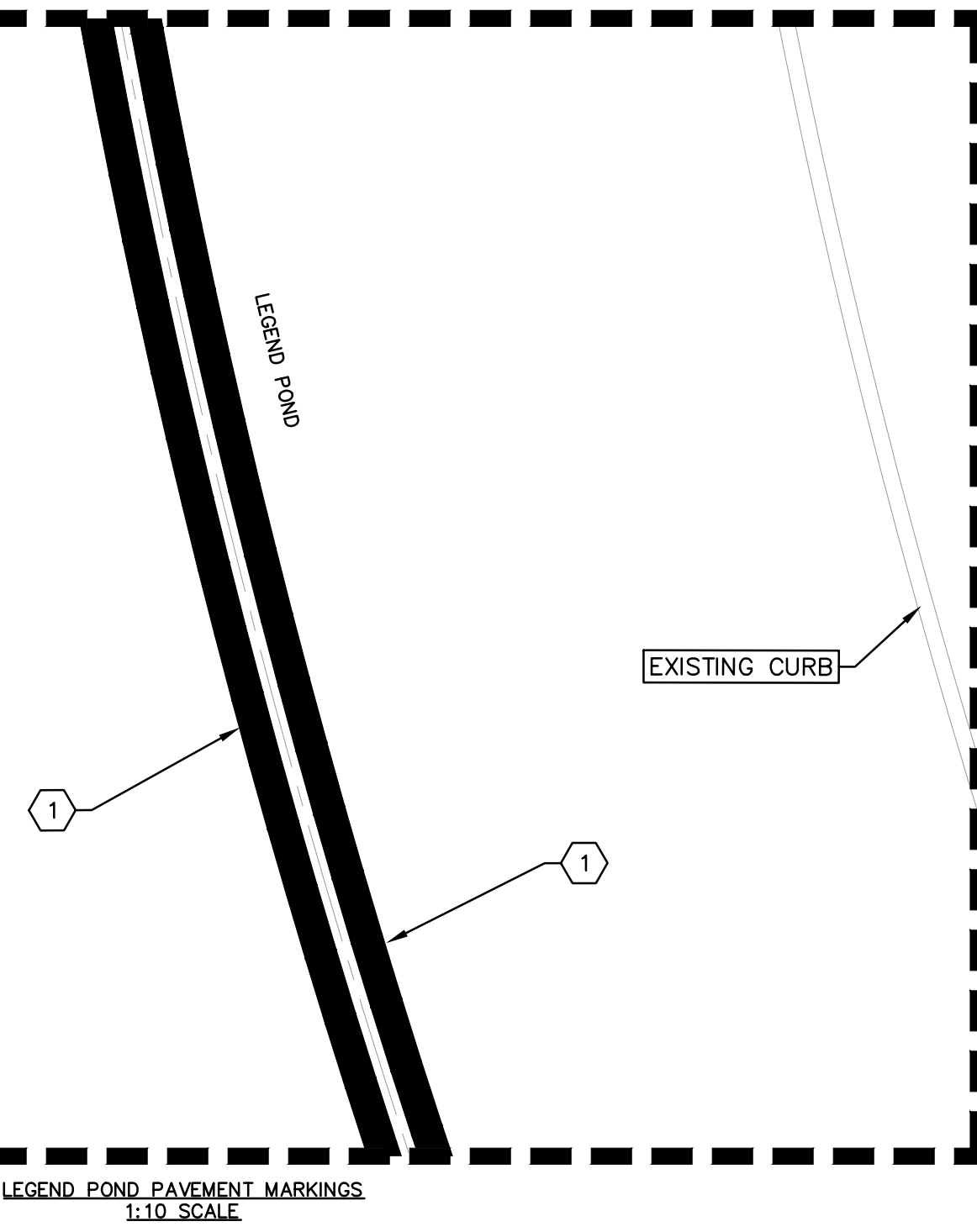
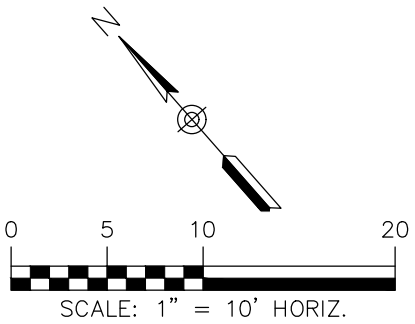

SIGNAGE NOTES

INSTALLATION

THE CONTRACTOR SHALL FURNISH AND INSTALL ALL REGULATORY, WARNING AND STREET NAME SIGNS AND SIGN MOUNTS IN ACCORDANCE WITH APPROVED ENGINEERING PLANS.

MOUNTING

THE WEDGE ANCHOR STEEL SYSTEM AND THIN-WALLED TUBING POST SHALL BE USED FOR SIGNS WITH UP TO 10 SQUARE FEET OF SIGN AREA. MATERIALS AND INSTALLATION SHOULD FOLLOW THE TEXAS DEPARTMENT OF TRANSPORTATION (TxDOT) TRAFFIC STANDARDS SMD (GEN) - 08 AND SMD (TWT) - 08.

THE TRIANGULAR SLIP BASE SYSTEM AND 10 BWG TUBING POST SHALL BE USED FOR SIGNS THAT HAVE 10 TO 16 SQUARE FEET OF SIGN AREA. MATERIALS AND INSTALLATION SHOULD FOLLOW THE TxDOT TRAFFIC STANDARDS SMD (GEN) - 08 AND SMD (SLIP-1-3) - 08.

OBJECT MARKERS MATERIALS AND INSTALLATION SHOULD FOLLOW THE TxDOT TRAFFIC STANDARDS D & OM (1 - 5) - 10.

THE LOCATION OF ALL EXISTING UNDERGROUND UTILITIES ARE SHOWN IN APPROXIMATE LOCATIONS ONLY. THE CONTRACTOR SHALL DETERMINE THE EXACT LOCATION OF ALL EXISTING UTILITIES BEFORE COMMENCING WORK. THE CONTRACTOR WILL AGREE TO BE FULLY RESPONSIBLE FOR ANY AND ALL DAMAGES WHICH MIGHT BE INCURRED BY THEIR FAILURE TO EXACTLY LOCATE AND PRESERVE ANY AND ALL UNDERGROUND UTILITIES, STRUCTURES OR FACILITIES. CONTRACTOR SHALL NOTIFY ENGINEER OF ANY DISCREPANCIES 24-HOURS PRIOR TO COMMENCING CONSTRUCTION.

290 S. CASTELL AVE., STE. 100
NEW BRAUNFELS, TX 78130
TBPE FIRM F-10961
TBPLS FIRM 1053600

HMT
ENGINEERING & SURVEYING

STREET PAVEMENT MARKINGS
(4 OF 7)

SOUTH POINT UNIT 4

NO.	REVISION DESCRIPTION	REVISION DATE
1	GBRA COMMENTS	06/03/2022
2	GVSD COMMENTS	06/17/2022
3	CONR COMMENTS REVIEW 4: PAVEMENT MARKING	06/20/2023

DATE: JUNE 2023

DRAWN BY: RR

DESIGNED BY: MA

REVIEWED BY: CC

HMT PROJECT NO.: 011.031

SHEET

C4.10

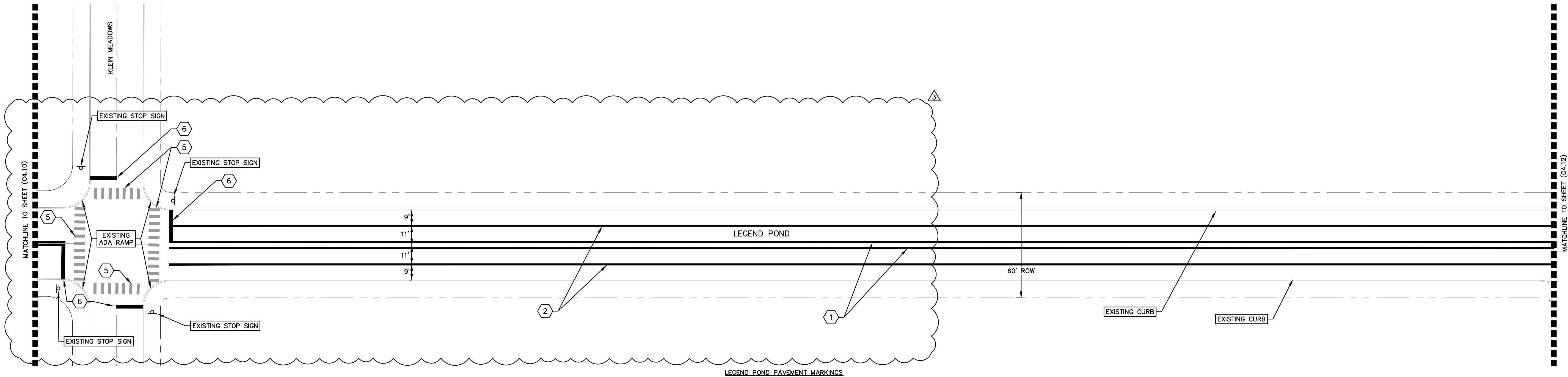

PAVEMENT MARKING LEGEND	
ITEM	NOTE
①	THERMOPLASTIC 4\"
②	THERMOPLASTIC 4\"
③	THERMOPLASTIC WHITE TRAFFIC MARKING TEXT, TYPE I-C
④	THERMOPLASTIC WHITE ARROW, TYPE I-C
⑤	THERMOPLASTIC 24\"
⑥	THERMOPLASTIC 24\"
⑦	THERMOPLASTIC 8\"

NOTE: REFER TO TxDOT DETAILS PM(1)-20, PM(2)-20, PM(3)-20, & PM(4)-20 ON SHEET C4.17

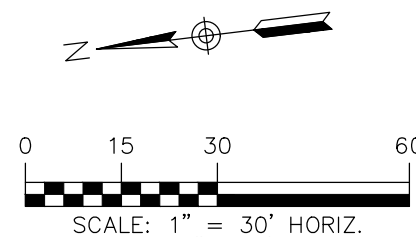

LEGEND	
B.L.	BUILDING SETBACK LINE
U.E.	UTILITY EASEMENT
D.E.	DRAINAGE EASEMENT
A.D.A. RAMP	ACCESSIBLE CROSSING AREA CONTRACTOR TO ENSURE MAX 2% CROSS SLOPE IN THESE AREAS
	SIDEWALK RAMP TYPE TO BE CONSTRUCTED AT TIME OF STREET CONSTRUCTION (SEE DETAIL SHEET C4.7)
	SIDEWALK TO BE CONSTRUCTED BY SITE DEVELOPMENT CONTRACTOR
	SIDEWALK TO BE CONSTRUCTED WITH FUTURE UNIT

- NOTES
- LOCAL STREETS WERE DESIGNED TO POSTED SPEED LIMIT OF **25** MPH.
 - IN WASHOUT CROWN AREAS, THE CURB ON THE HIGH SIDE OF THE STREET SHOULD BE SPILL CURB AS DESIGNATED ON THE PLANS.
 - CONTRACTOR TO CONSTRUCT SIDEWALK RAMPS WITH STREETS.
 - CONTRACTOR TO ENSURE POSITIVE DRAINAGE AWAY FROM STREET STUB OUT ENDS SO THAT NO "PONDING" OF WATER OCCURS.
 - PER NEW BRAUNFELS ORDINANCE SEC. 114-98(a)(6) ALL DRIVEWAY LOCATED ON A SINGLE FAMILY RESIDENCE ON A LOCAL STREET SHALL HAVE A MINIMUM SPACING OF 20'

SIGNAGE NOTES

INSTALLATION

THE CONTRACTOR SHALL FURNISH AND INSTALL ALL REGULATORY, WARNING AND STREET NAME SIGNS AND SIGN MOUNTS IN ACCORDANCE WITH APPROVED ENGINEERING PLANS.

MOUNTING

THE WEDGE ANCHOR STEEL SYSTEM AND THIN-WALLED TUBING POST SHALL BE USED FOR SIGNS WITH UP TO 10 SQUARE FEET OF SIGN AREA. MATERIALS AND INSTALLATION SHOULD FOLLOW THE TEXAS DEPARTMENT OF TRANSPORTATION (TXDOT) TRAFFIC STANDARDS SMD (GEN) - 08 AND SMD (TWT) - 08.

THE TRIANGULAR SLIP BASE SYSTEM AND 10 BWG TUBING POST SHALL BE USED FOR SIGNS THAT HAVE 10 TO 16 SQUARE FEET OF SIGN AREA. MATERIALS AND INSTALLATION SHOULD FOLLOW THE TXDOT TRAFFIC STANDARDS SMD (GEN) - 08 AND SMD (SLIP-1-3) - 08.

OBJECT MARKERS MATERIALS AND INSTALLATION SHOULD FOLLOW THE TXDOT TRAFFIC STANDARDS D & OM (1 - 5) - 10.

THE LOCATION OF ALL EXISTING UNDERGROUND UTILITIES ARE SHOWN IN APPROXIMATE LOCATIONS ONLY. THE CONTRACTOR SHALL DETERMINE THE EXACT LOCATION OF ALL EXISTING UTILITIES BEFORE COMMENCING WORK. THE CONTRACTOR WILL AGREE TO BE FULLY RESPONSIBLE FOR ANY AND ALL DAMAGES WHICH MIGHT BE INCURRED BY THEIR FAILURE TO EXACTLY LOCATE AND PRESERVE ANY AND ALL UNDERGROUND UTILITIES, STRUCTURES OR FACILITIES. CONTRACTOR SHALL NOTIFY ENGINEER OF ANY DISCREPANCIES 24-HOURS PRIOR TO COMMENCING CONSTRUCTION.

290 S. CASTELL AVE., STE. 100
NEW BRAUNFELS, TX 78130
TBPE FIRM F-10961
TBPLS FIRM 1053600



STREET PAVEMENT MARKINGS
(5 OF 7)

SOUTH POINT UNIT 4

REVISION		DATE
NO.	DESCRIPTION	
1	GBRA COMMENTS	06/03/2022
2	GVSD COMMENTS	06/17/2022
3	CONB COMMENTS REVIEW 4: PAVEMENT MARKING	06/20/2023

DATE: JUNE 2023

DRAWN BY: RR

DESIGNED BY: MA

REVIEWED BY: CC

HMT PROJECT NO.: 011.031

SHEET
C4.11

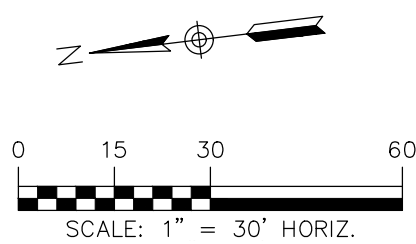
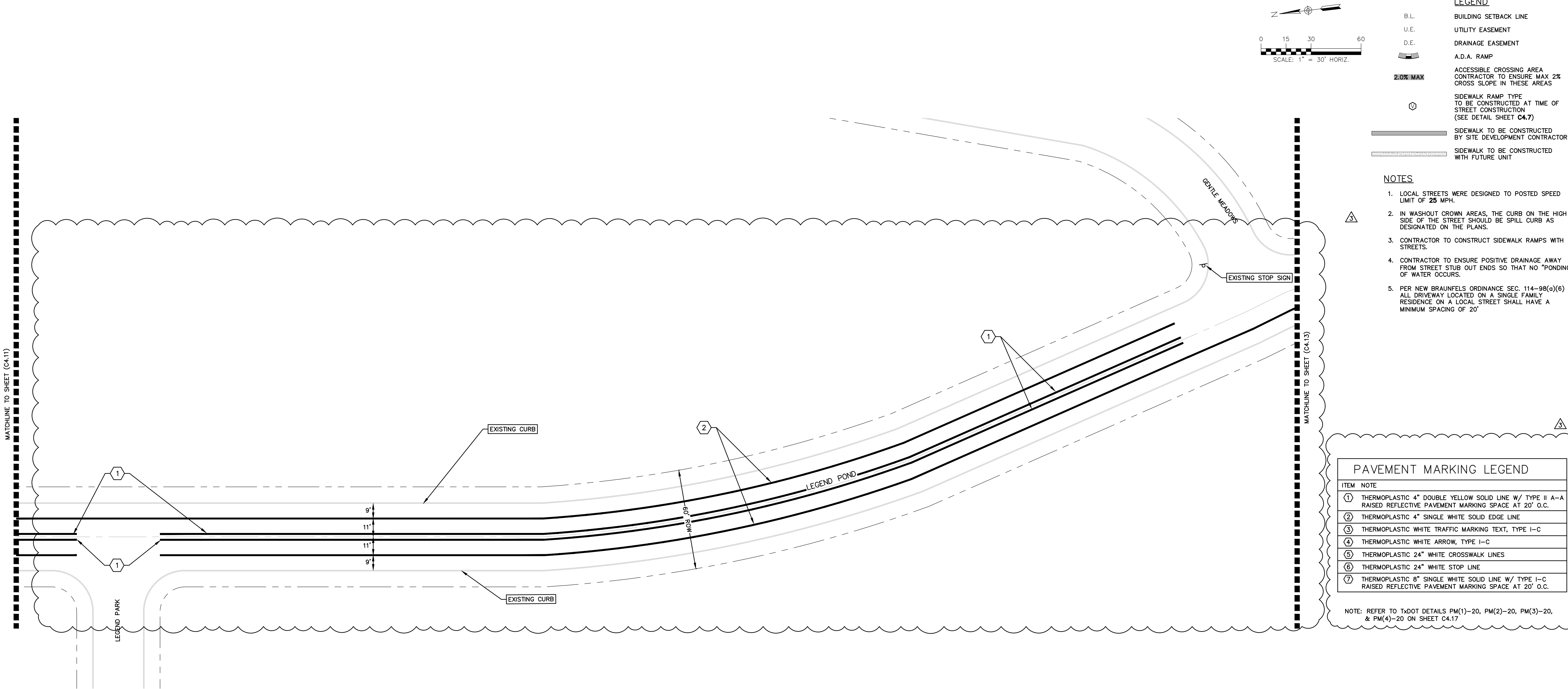

- LEGEND**
- | | |
|------|--|
| B.L. | BUILDING SETBACK LINE |
| U.E. | UTILITY EASEMENT |
| D.E. | DRAINAGE EASEMENT |
| | A.D.A. RAMP |
| | 2.0% MAX |
| | SIDEWALK RAMP TYPE
TO BE CONSTRUCTED AT TIME OF
STREET CONSTRUCTION
(SEE DETAIL SHEET C4.7) |
| | SIDEWALK TO BE CONSTRUCTED
BY SITE DEVELOPMENT CONTRACTOR |
| | SIDEWALK TO BE CONSTRUCTED
WITH FUTURE UNIT |

- NOTES**
1. LOCAL STREETS WERE DESIGNED TO POSTED SPEED LIMIT OF **25** MPH.
 2. IN WASHOUT CROWN AREAS, THE CURB ON THE HIGH SIDE OF THE STREET SHOULD BE SPILL CURB AS DESIGNATED ON THE PLANS.
 3. CONTRACTOR TO CONSTRUCT SIDEWALK RAMPS WITH STREETS.
 4. CONTRACTOR TO ENSURE POSITIVE DRAINAGE AWAY FROM STREET STUB OUT ENDS SO THAT NO "PONDING" OF WATER OCCURS.
 5. PER NEW BRAUNFELS ORDINANCE SEC. 114-98(a)(6) ALL DRIVEWAY LOCATED ON A SINGLE FAMILY RESIDENCE ON A LOCAL STREET SHALL HAVE A MINIMUM SPACING OF 20'

PAVEMENT MARKING LEGEND	
ITEM	NOTE
①	THERMOPLASTIC 4" DOUBLE YELLOW SOLID LINE W/ TYPE II A-A RAISED REFLECTIVE PAVEMENT MARKING SPACE AT 20' O.C.
②	THERMOPLASTIC 4" SINGLE WHITE SOLID EDGE LINE
③	THERMOPLASTIC WHITE TRAFFIC MARKING TEXT, TYPE I-C
④	THERMOPLASTIC WHITE ARROW, TYPE I-C
⑤	THERMOPLASTIC 24" WHITE CROSSWALK LINES
⑥	THERMOPLASTIC 24" WHITE STOP LINE
⑦	THERMOPLASTIC 8" SINGLE WHITE SOLID LINE W/ TYPE I-C RAISED REFLECTIVE PAVEMENT MARKING SPACE AT 20' O.C.

NOTE: REFER TO TxDOT DETAILS PM(1)-20, PM(2)-20, PM(3)-20, & PM(4)-20 ON SHEET **C4.17**

SIGNAGE NOTES

INSTALLATION

THE CONTRACTOR SHALL FURNISH AND INSTALL ALL REGULATORY, WARNING AND STREET NAME SIGNS AND SIGN MOUNTS IN ACCORDANCE WITH APPROVED ENGINEERING PLANS.

MOUNTING

THE WEDGE ANCHOR STEEL SYSTEM AND THIN-WALLED TUBING POST SHALL BE USED FOR SIGNS WITH UP TO 10 SQUARE FEET OF SIGN AREA. MATERIALS AND INSTALLATION SHOULD FOLLOW THE TEXAS DEPARTMENT OF TRANSPORTATION (TxDOT) TRAFFIC STANDARDS SMD (GEN) - 08 AND SMD (TWT) - 08.

THE TRIANGULAR SLIP BASE SYSTEM AND 10 BWG TUBING POST SHALL BE USED FOR SIGNS THAT HAVE 10 TO 16 SQUARE FEET OF SIGN AREA. MATERIALS AND INSTALLATION SHOULD FOLLOW THE TxDOT TRAFFIC STANDARDS SMD (GEN) - 08 AND SMD (SLIP-1-3) - 08.

OBJECT MARKERS MATERIALS AND INSTALLATION SHOULD FOLLOW THE TxDOT TRAFFIC STANDARDS D & OM (1 - 5) - 10.

THE LOCATION OF ALL EXISTING UNDERGROUND UTILITIES ARE SHOWN IN APPROXIMATE LOCATIONS ONLY. THE CONTRACTOR SHALL DETERMINE THE EXACT LOCATION OF ALL EXISTING UTILITIES BEFORE COMMENCING WORK. THE CONTRACTOR WILL AGREE TO BE FULLY RESPONSIBLE FOR ANY AND ALL DAMAGES WHICH MIGHT BE INCURRED BY THEIR FAILURE TO EXACTLY LOCATE AND PRESERVE ANY AND ALL UNDERGROUND UTILITIES, STRUCTURES OR FACILITIES. CONTRACTOR SHALL NOTIFY ENGINEER OF ANY DISCREPANCIES 24-HOURS PRIOR TO COMMENCING CONSTRUCTION.

290 S. CASTELL AVE., STE. 100
NEW BRAUNFELS, TX 78130
TBPE FIRM F-10961
TBPLS FIRM 1053600

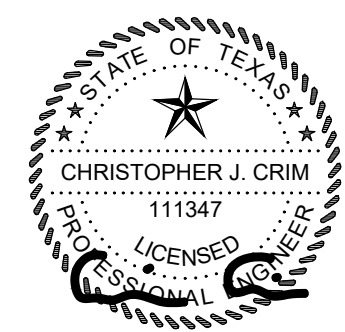

STREET PAVEMENT MARKINGS
(6 OF 7)

SOUTH POINT UNIT 4

NO.	REVISION	DESCRIPTION	REVISION DATE
1	GBRA COMMENTS		06/03/2022
2	GVSD COMMENTS		06/17/2022
3	CONB COMMENTS	REVIEW 4: PAVEMENT MARKING	06/20/2023

DATE:	JUNE 2023
DRAWN BY:	RR
DESIGNED BY:	MA
REVIEWED BY:	CC

HMT PROJECT NO.:
011.031

SHEET
C4.12

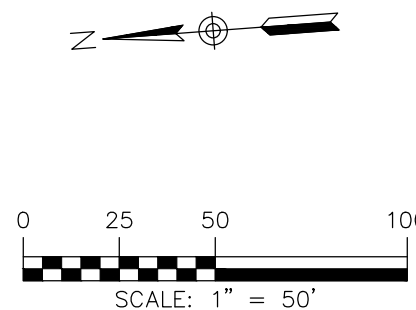
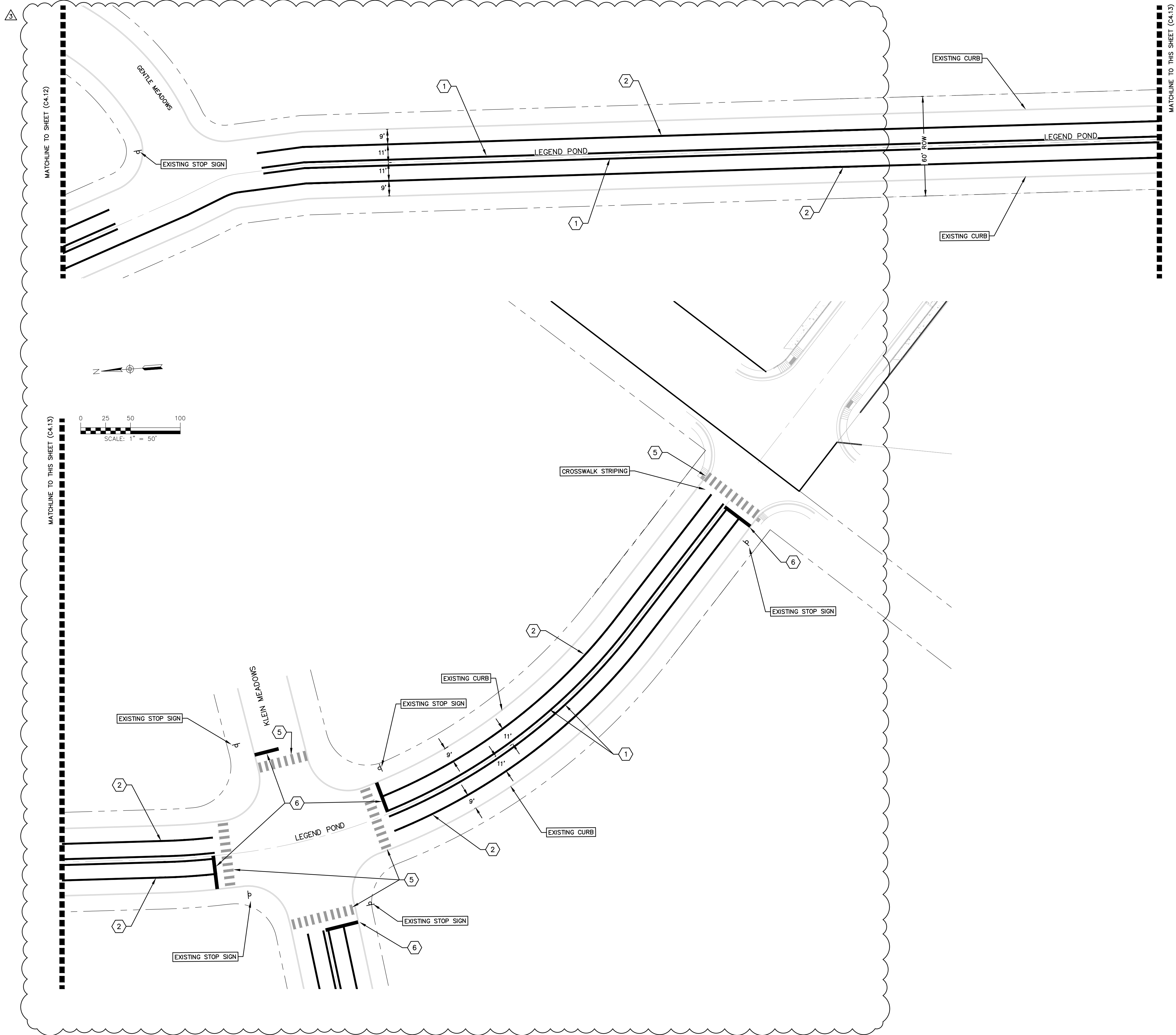

LEGEND	
B.L.	BUILDING SETBACK LINE
U.E.	UTILITY EASEMENT
D.E.	DRAINAGE EASEMENT
A.D.A. RAMP	ACCESSIBLE CROSSING AREA CONTRACTOR TO ENSURE MAX 2% CROSS SLOPE IN THESE AREAS
	SIDEWALK RAMP TYPE TO BE CONSTRUCTED AT TIME OF STREET CONSTRUCTION (SEE DETAIL SHEET C4.7)
	SIDEWALK TO BE CONSTRUCTED BY SITE DEVELOPMENT CONTRACTOR
	SIDEWALK TO BE CONSTRUCTED WITH FUTURE UNIT

- NOTES
- LOCAL STREETS WERE DESIGNED TO POSTED SPEED LIMIT OF 25 MPH.
 - IN WASHOUT CROWN AREAS, THE CURB ON THE HIGH SIDE OF THE STREET SHOULD BE SPILL CURB AS DESIGNATED ON THE PLANS.
 - CONTRACTOR TO CONSTRUCT SIDEWALK RAMPS WITH STREETS.
 - CONTRACTOR TO ENSURE POSITIVE DRAINAGE AWAY FROM STREET STUB OUT ENDS SO THAT NO "PONDING" OF WATER OCCURS.
 - PER NEW BRAUNFELS ORDINANCE SEC. 114-98(a)(6) ALL DRIVEWAY LOCATED ON A SINGLE FAMILY RESIDENCE ON A LOCAL STREET SHALL HAVE A MINIMUM SPACING OF 20'

PAVEMENT MARKING LEGEND	
ITEM	NOTE
①	THERMOPLASTIC 4" DOUBLE YELLOW SOLID LINE W/ TYPE II A-A RAISED REFLECTIVE PAVEMENT MARKING SPACE AT 20' O.C.
②	THERMOPLASTIC 4" SINGLE WHITE SOLID EDGE LINE
③	THERMOPLASTIC WHITE TRAFFIC MARKING TEXT, TYPE I-C
④	THERMOPLASTIC WHITE ARROW, TYPE I-C
⑤	THERMOPLASTIC 24" WHITE CROSSWALK LINES
⑥	THERMOPLASTIC 24" WHITE STOP LINE
⑦	THERMOPLASTIC 8" SINGLE WHITE SOLID LINE W/ TYPE I-C RAISED REFLECTIVE PAVEMENT MARKING SPACE AT 20' O.C.

NOTE: REFER TO TxDOT DETAILS PM(1)-20, PM(2)-20, PM(3)-20, & PM(4)-20 ON SHEET C4.17

SIGNAGE NOTES

INSTALLATION

THE CONTRACTOR SHALL FURNISH AND INSTALL ALL REGULATORY, WARNING AND STREET NAME SIGNS AND SIGN MOUNTS IN ACCORDANCE WITH APPROVED ENGINEERING PLANS.

MOUNTING

THE WEDGE ANCHOR STEEL SYSTEM AND THIN-WALLED TUBING POST SHALL BE USED FOR SIGNS WITH UP TO 10 SQUARE FEET OF SIGN AREA. MATERIALS AND INSTALLATION SHOULD FOLLOW THE TEXAS DEPARTMENT OF TRANSPORTATION (TxDOT) TRAFFIC STANDARDS SMD (GEN) - 08 AND SMD (TWT) - 08.

THE TRIANGULAR SLIP BASE SYSTEM AND 10 BWG TUBING POST SHALL BE USED FOR SIGNS THAT HAVE 10 TO 16 SQUARE FEET OF SIGN AREA. MATERIALS AND INSTALLATION SHOULD FOLLOW THE TxDOT TRAFFIC STANDARDS SMD (GEN) - 08 AND SMD (SLIP-1-3) - 08.

OBJECT MARKERS MATERIALS AND INSTALLATION SHOULD FOLLOW THE TxDOT TRAFFIC STANDARDS D & OM (1 - 5) - 10.

THE LOCATION OF ALL EXISTING UNDERGROUND UTILITIES ARE SHOWN IN APPROXIMATE LOCATIONS ONLY. THE CONTRACTOR SHALL DETERMINE THE EXACT LOCATION OF ALL EXISTING UTILITIES BEFORE COMMENCING WORK. THE CONTRACTOR WILL AGREE TO BE FULLY RESPONSIBLE FOR ANY AND ALL DAMAGES WHICH MIGHT BE INCURRED BY THEIR FAILURE TO EXACTLY LOCATE AND PRESERVE ANY AND ALL UNDERGROUND UTILITIES, STRUCTURES OR FACILITIES. CONTRACTOR SHALL NOTIFY ENGINEER OF ANY DISCREPANCIES 24-HOURS PRIOR TO COMMENCING CONSTRUCTION.

290 S. CASTELL AVE., STE. 100
NEW BRAUNFELS, TX 78130
TBPE FIRM F-10961
TBPLS FIRM 1053600



STREET PAVEMENT MARKINGS
(7 OF 7)

SOUTH POINT UNIT 4

NO.	REVISION	DESCRIPTION	REVISION DATE
1	GBRA COMMENTS		06/03/2022
2	GVSD COMMENTS		06/17/2022
3	CONB COMMENTS	REVIEW 4: PAVEMENT MARKING	06/20/2023

DATE: JUNE 2023

DRAWN BY: RR

DESIGNED BY: MA

REVIEWED BY: CC

HMT PROJECT NO.: 011.031

SHEET
C4.13