

Dates: April 26, 2023, 3:40 PM - User ID: clodner
Files: P:\24\62\13\Design\Civil\Exhibits\246213 Conduit Plan.dwg

THIS DOCUMENT HAS BEEN PRODUCED FROM MATERIAL THAT WAS STORED AND/OR TRANSMITTED ELECTRONICALLY AND MAY HAVE BEEN INADVERTENTLY ALTERED. RELY ONLY ON FINAL HARDCOPY MATERIALS BEARING THE CONSULTANT'S ORIGINAL SIGNATURE AND SEAL. AERIAL IMAGERY PROVIDED BY GOOGLE/US UNLESS OTHERWISE NOTED. Imagery © 2016, CAROL Digital Globe, Texas Orthoregistry Program, USDA Farm Service Agency.

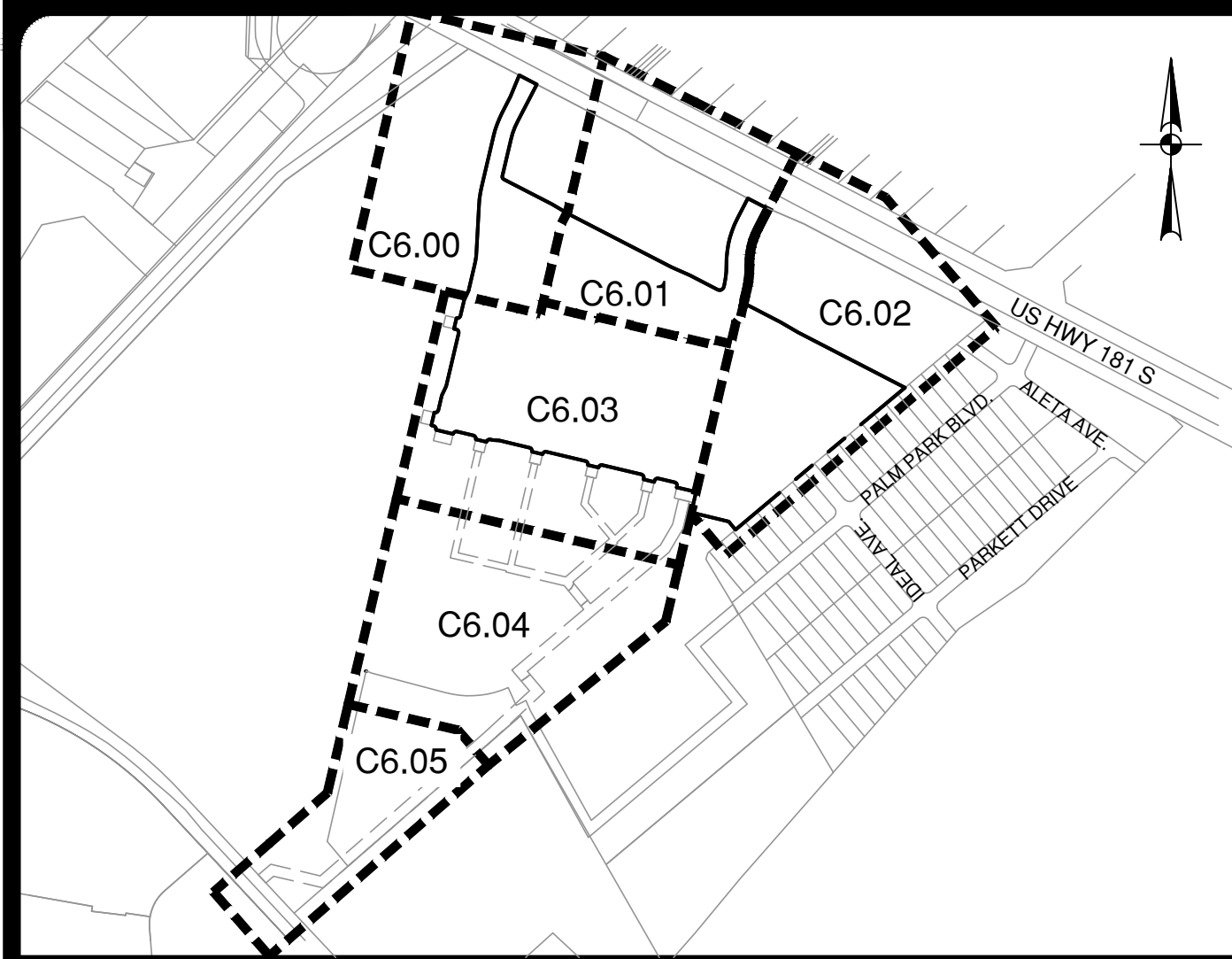

INDEX MAP
NOT-TO-SCALE

CONDUIT	SIZE/TYPE	MIN. DEPTH OF COVER
A (SECONDARY)	2-4" PVC (SCH 40)	36"
B (PRIMARY)	2-4" PVC (SCH 80)	36"
C (PRIMARY II)	2-4" PVC (SCH 40)	36"
D (LANDSCAPE)	2-4" PVC (SCH 40)	36"
E (STREETLIGHT)	1-4" PVC (SCH 40)	36"
F (TEXAS GAS)	3-6" PVC (SCH 80)	48"
G (TEXAS GAS)	3-6" PVC (SCH 80)	60"

CONDUIT	SIZE/TYPE	MIN. DEPTH OF COVER
H (TEXAS GAS)	2-6" PVC (SCH 80)	60"
I (TEXAS GAS)	2-6" PVC (SCH 80)	48"
J (TEXAS GAS)	2-4" PVC (SCH 80)	36"
K (PRIMARY III)	2-4" PVC (SCH 40)	36"

REMAINDER OF 240.10 ACRES
DAVIS MCCRARY PROPERTY TRUST
VOL. 5429 PGS. 878 O.P.R.
DESCRIBED IN VOL. 3040 PG. 708 O.P.R.

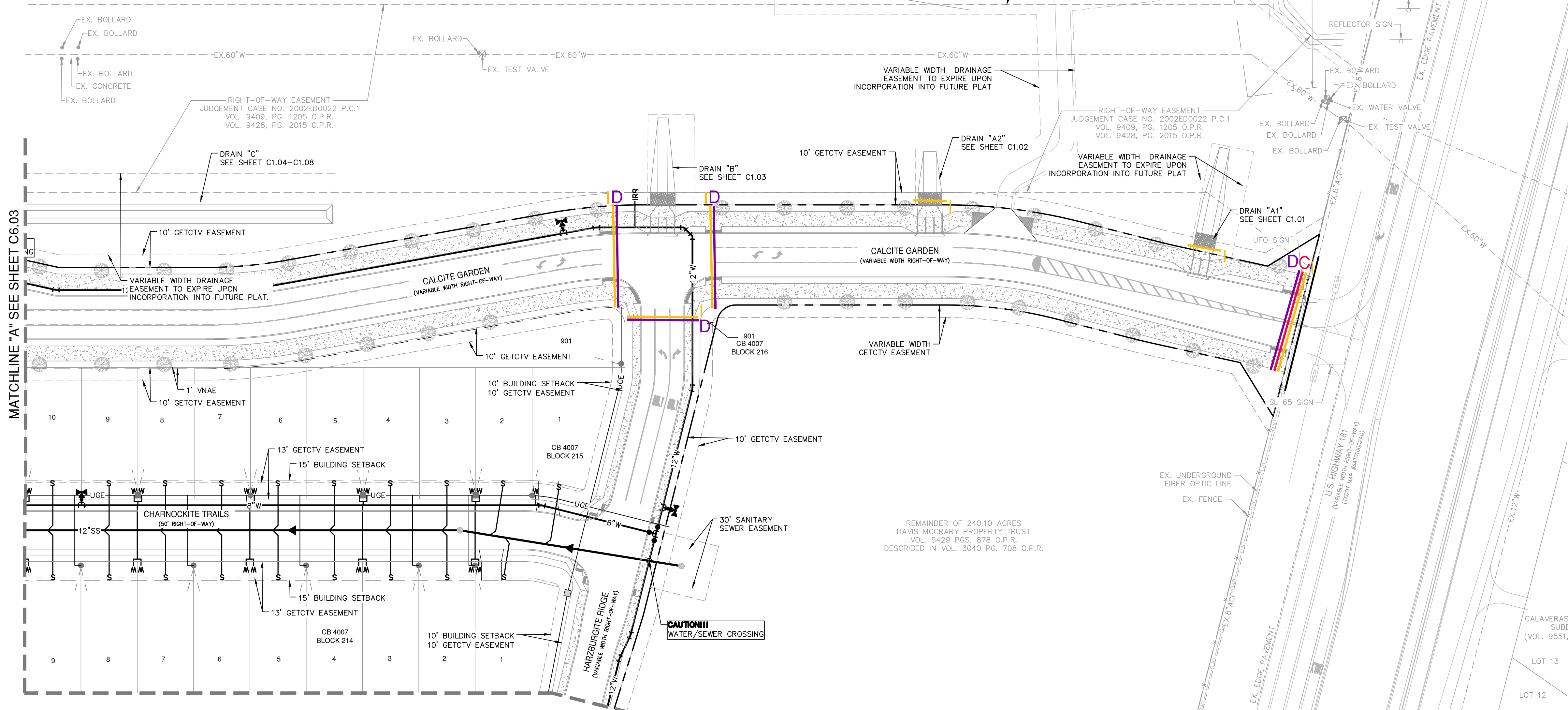

MATCHLINE "B" SEE SHEET C6.01

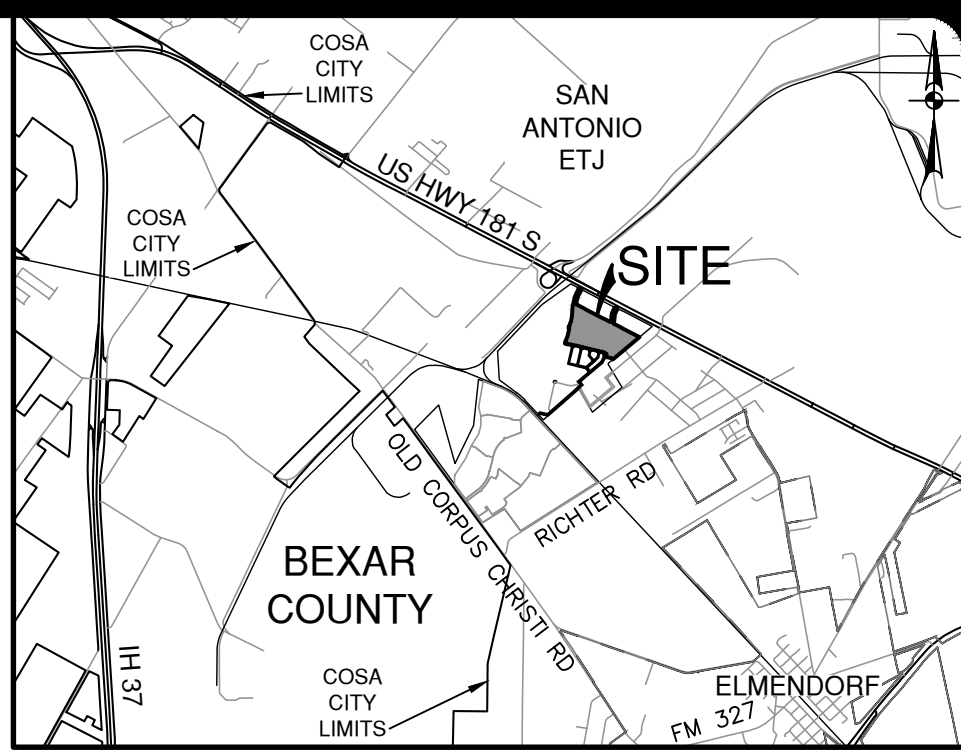

LOCATION MAP
NOT-TO-SCALE

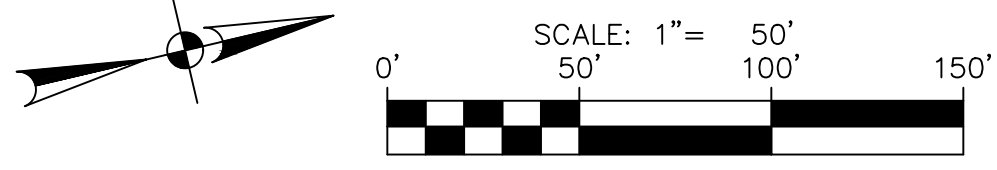

UTILITY LEGEND

PROJECT LIMITS	---
EXISTING WATER	---
EXISTING SEWER	---
PROPOSED SEWER	---
PROPOSED WATER	---
UNDERGROUND FIBER OPTIC	---
OVERHEAD ELECTRICAL	---
PROPOSED WYE & LATERAL	---
SINGLE WATER SERVICE	---
DUAL WATER SERVICE	---
STREET LIGHTS	---
CLEAR VISION EASEMENT	---
GAS, ELECTRIC, TELEPHONE & CABLE TELEVISION EASEMENT	---
UTILITY POLE	---
SECONDARY PEDESTAL	---
TRANSFORMER	---
PULL BOX	---
EXISTING TREES TO REMAIN UNDISTURBED	---
EXISTING TREES TO BE REMOVED	---

ROW PERMIT NOTE:

A BEXAR COUNTY PERMIT MUST BE OBTAINED BEFORE WORKING IN BEXAR COUNTY RIGHTS-OF-WAY.

CONDUIT NOTES:

- CONTRACTOR SHALL INSTALL PERMANENT MARKERS IN PROPOSED CURB WHERE CONDUITS CROSS THE ROADWAY (BOTH SIDES).
- CONDUITS SHALL BE PVC WITH MINIMUM BURY OF 36 INCHES BELOW PROPOSED FINISHED GRADE. SCHEDULE 80 TO BE USED FOR CPS CONDUITS, ALL OTHER CONDUITS ARE SCHEDULE 40.
- ALL CONDUITS SHALL BE EXTENDED BEHIND CURBS OR PROPOSED SIDEWALKS A MINIMUM OF 3 FEET AND CAPPED FOR FUTURE USE.
- ALL CONDUIT SLEEVES TO BE USED FOR ELECTRIC, GAS, OR TELECOMMUNICATION UTILITY CROSSINGS SHALL BE INSTALLED TO MEET OR EXCEED DESIGN REQUIREMENTS FOR THE UTILITY AGENCY WHICH THEY ARE SERVING, INCLUDING BUT NOT LIMITED TO THE DEPTH, TRENCH PLACEMENT, AND PROXIMITY TO OTHER UTILITIES. THE CONTRACTOR IS SOLELY RESPONSIBLE FOR VERIFYING AND INSTALLING THE CONDUIT SLEEVES TO MEET THESE SPECIFICATIONS INCLUDING COORDINATING WITH THE UTILITY AGENCY FOR ANY REQUIRED INSPECTIONS.

TRENCH EXCAVATION SAFETY PROTECTION:

CONTRACTOR AND/OR CONTRACTOR'S INDEPENDENTLY RETAINED EMPLOYEE OR STRUCTURAL DESIGN/ GEOTECHNICAL/ SAFETY/EQUIPMENT CONSULTANT, IF ANY, SHALL REVIEW THESE PLANS AND ANY AVAILABLE GEOTECHNICAL INFORMATION AND THE ANTICIPATED INSTALLATION SITES WITHIN THE PROJECT WORK AREA IN ORDER TO IMPLEMENT CONTRACTOR'S TRENCH EXCAVATION SAFETY PROTECTION SYSTEMS, PROGRAMS AND /OR PROCEDURES FOR THE PROJECT DESCRIBED IN THE CONTRACT DOCUMENTS. THE CONTRACTOR'S IMPLEMENTATION OF THESE SYSTEMS, PROGRAMS AND/OR PROCEDURES SHALL PROVIDE FOR ADEQUATE TRENCH EXCAVATION SAFETY PROTECTION THAT COMPLY WITH AS A MINIMUM, OSHA STANDARDS FOR TRENCH EXCAVATIONS. SPECIFICALLY, CONTRACTOR AND/OR CONTRACTOR'S INDEPENDENTLY RETAINED EMPLOYEE OR SAFETY CONSULTANT SHALL IMPLEMENT A TRENCH SAFETY PROGRAM IN ACCORDANCE WITH OSHA STANDARDS GOVERNING THE PRESENCE AND ACTIVITIES OF INDIVIDUALS WORKING IN AND AROUND TRENCH EXCAVATION.

CAUTION!!

CONTRACTOR SHALL BE REQUIRED TO LOCATE ALL PUBLIC OR PRIVATE UTILITIES INCLUDING BUT NOT LIMITING TO: WATER, SEWER, TELEPHONE AND FIBER OPTIC LINES, SITE LIGHTING ELECTRICAL, SECONDARY ELECTRICAL, PRIMARY ELECTRICAL DUCTBANKS, LANDSCAPE IRRIGATION FACILITIES, AND GAS LINES. ANY UTILITY CONFLICTS THAT ARISE SHOULD BE COMMUNICATED TO THE ENGINEER IMMEDIATELY AND PRIOR TO CONSTRUCTION. THE CONTRACTOR SHALL CONTACT 1-800-DIG-TESTS A MINIMUM OF 48 HOURS PRIOR TO THE START OF CONSTRUCTION. ANY DAMAGE TO EXISTING UTILITIES SHALL BE THE SOLE RESPONSIBILITY OF THE CONTRACTOR AND THE REPAIR SHALL BE AT CONTRACTOR'S SOLE EXPENSE WHETHER THE UTILITY IS SHOWN ON THESE PLANS OR NOT.

DATE	
NO.	
REVISION	

PAPE-DAWSON ENGINEERS
2000 NW LOOP 410 | SAN ANTONIO, TX 78213 | 210.375.9000
TEXAS SURVEYING FIRM #10028800

STONE GARDEN - UNIT 4A
BEXAR COUNTY, TEXAS
OVERALL UTILITY PLAN

PLAT NO.	24-11800158
JOB NO.	12482-13
DATE	NOVEMBER 2024
DESIGNER	CL
CHECKED	DW DRAWN
SHEET	C6.00

CONDUIT	SIZE/TYPE	MIN. DEPTH OF COVER
H (TEXAS GAS)	2-6" PVC (SCH 80) 1-12" PVC (SCH 80)	60"
I (TEXAS GAS)	2-6" PVC (SCH 80) 1-12" PVC (SCH 80)	48"
J (TEXAS GAS)	2-6" PVC (SCH 80) 1-12" PVC (SCH 80)	36"
K (PRIMARY III)	2-4" PVC (SCH 40) 7-6" PVC (SCH 80)	36" 36"

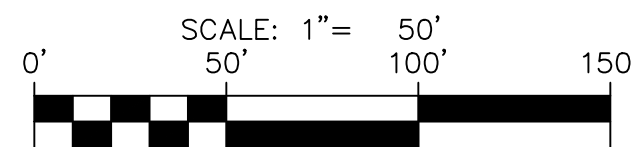
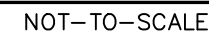

PROJECT LIMITS

EXISTING WATER

EXISTING SEWER

PROPOSED SEWER

PROPOSED WATER

UNDERGROUND FIBER OPTIC

OVERHEAD ELECTRICAL

PROPOSED WYE & LATERAL

SINGLE WATER SERVICE

DUAL WATER SERVICE

STREET LIGHTS

CLEAR VISION EASEMENT

Gas, Electric, Telephone & Cable Television Easement

UTILITY POLE

SECONDARY PEDESTAL

TRANSFORMER

PULL BOX

EXISTING TREES TO REMAIN UNDISTURBED

EXISTING TREES TO BE REMOVED

The legend defines symbols for various utilities and features. It includes: Project Limits (dashed line), Existing Water (solid line), Existing Sewer (dashed line), Proposed Sewer (solid line with cross-hatches), Proposed Water (solid line), Underground Fiber Optic (dashed line), Overhead Electrical (solid line with cross-hatches), Proposed Wye & Lateral (solid line with a T-junction), Single Water Service (solid line with a valve symbol), Dual Water Service (solid line with two valve symbols), Street Lights (star symbol with SL), Clear Vision Easement (dashed line with CVE), Gas, Electric, Telephone & Cable Television Easement (dashed line with GETCTV), Utility Pole (circle with UP), Secondary Pedestal (solid circle), Transformer (solid square), Pull Box (open square with PB), Existing Trees to Remain Undisturbed (solid line drawing of a tree), and Existing Trees to Be Removed (dashed line drawing of a tree).

A BEXAR COUNTY PERMIT MUST BE OBTAINED BEFORE WORKING IN BEXAR COUNTY RIGHTS-OF-WAY.

1. CONTRACTOR SHALL INSTALL PERMANENT MARKERS IN PROPOSED CURBS WHERE CONDUITS CROSS THE ROADWAY (BOTH SIDES).
2. CONDUITS SHALL BE PVC WITH MINIMUM BURIAL OF 36 INCHES BELOW PROPOSED FINISHED GRADE. SCHEDULE 80 TO BE USED FOR CPS CONDUITS, ALL OTHER CONDUITS ARE SCHEDULE 40.
3. ALL CONDUITS SHALL BE EXTENDED BEHIND CURBS OR PROPOSED SIDEWALKS A MINIMUM OF 3 FEET AND CAPPED FOR FUTURE USE.
4. ALL CONDUIT SLEEVES TO BE USED FOR ELECTRIC, GAS, OR TELECOMMUNICATION UTILITY CROSSINGS SHALL BE INSTALLED TO MEET OR EXCEED DESIGN REQUIREMENTS FOR THE UTILITY AGENCY WHICH IS PROVIDING THE SERVICE, INCLUDING BUT NOT LIMITED TO THE DEPTH OF THE TRENCH, PLACEMENT, AND PROXIMITY TO OTHER UTILITIES. THE CONTRACTOR IS SOLELY RESPONSIBLE FOR VERIFYING AND INSTALLING THE CONDUIT SLEEVES TO MEET THESE SPECIFICATIONS INCLUDING COORDINATING WITH THE UTILITY AGENCY FOR ANY REQUIRED INSPECTIONS.

CONTRACTOR AND/OR CONTRACTOR'S INDEPENDENTLY RETAINED EMPLOYEE OR STRUCTURAL DESIGN/ GEOTECHNICAL/ SAFETY/EQUIPMENT CONSULTANT, IF ANY, SHALL REVIEW THESE PLANS AND ANY AVAILABLE GEOTECHNICAL INFORMATION AND THE ANTICIPATED INSTALLATION SITES WITHIN THE PROJECT AREA TO DETERMINE THE NECESSITY FOR TRENCH EXCAVATION SAFETY PROTECTION SYSTEMS, PROGRAMS AND/OR PROCEDURES FOR THE PROJECT DESCRIBED IN THE CONTRACT DOCUMENTS. THE CONTRACTOR'S IMPLEMENTATION OF THESE SYSTEMS, PROGRAMS AND/OR PROCEDURES SHALL PROVIDE FOR ADEQUATE TRENCH EXCAVATION SAFETY FOR ALL EMPLOYEES AND CONTRACTORS SERVING THE PROJECT FOR TRENCH EXCAVATIONS. SPECIFICALLY, CONTRACTOR AND/OR CONTRACTOR'S INDEPENDENTLY RETAINED EMPLOYEE OR SAFETY CONSULTANT SHALL IMPLEMENT A TRENCH SAFETY PROGRAM IN ACCORDANCE WITH THE OSHA REQUIREMENTS REGARDING THE ACTIVITIES OF INDIVIDUALS WORKING IN AND AROUND TRENCH EXCAVATIONS.

CONTRACTOR SHALL BE REQUIRED TO LOCATE ALL PUBLIC OR PRIVATE UTILITIES INCLUDING BUT NOT LIMITING TO: WATER, SEWER, TELEPHONE AND FIBER OPTIC LINES, SITE LIGHTING ELECTRICAL, SECONDARY ELECTRIC, PRIMARY ELECTRICAL, DUCTBANKS, LANDSCAPE IRRIGATION FACILITIES, AND GAS LINES. ANY UTILITY CONFLICTS THAT ARISE SHOULD BE COMMUNICATED TO THE ENGINEER IMMEDIATELY AND PRIOR TO CONSTRUCTION. THE CONTRACTOR SHALL CONTACT A 800-368-7853 A MINIMUM OF 48 HOURS PRIOR TO THE START OF CONSTRUCTION. ANY DAMAGE TO EXISTING UTILITIES SHALL BE THE SOLE RESPONSIBILITY OF THE CONTRACTOR AND THE REPAIR SHALL BE AT CONTRACTOR'S SOLE EXPENSE WHETHER THE UTILITY IS SHOWN ON THESE PLANS OR NOT.

[illegible]

**PAPE-DAWSON
ENGINEERS**

2000 NW LOOP 410 I SAN ANTONIO, TX 78213 I 210.375.9000
TEXAS ENGINEERING FIRM #470 I TEXAS SURVEYING FIRM #10028800

STONE GARDEN - UNIT 4A
BEXAR COUNTY, TEXAS

BEXAR COUNTY, TEXAS

OVERALL UTILITY PLAN

PLAT NO. 24-11800158
JOB NO. 12482-13
DATE NOVEMBER 2024
DESIGNER CL
CHECKED DW DRAWN JR
SHEET C6.01

ROW PERMIT NOTE:

A BEXAR COUNTY PERMIT MUST BE OBTAINED BEFORE WORKING IN BEXAR COUNTY RIGHTS-OF-WAY.

CONDUIT NOTES:

- CONTRACTOR SHALL INSTALL PERMANENT MARKERS IN PROPOSED CURB WHERE CONDUITS CROSS THE ROADWAY (BOTH SIDES).
- CONDUITS SHALL BE PVC WITH MINIMUM BURY OF 36 INCHES BELOW PROPOSED FINISHED GRADE. SCHEDULE 80 TO BE USED FOR GPS CONDUITS, ALL OTHER CONDUITS ARE SCHEDULE 40.
- ALL CONDUITS SHALL BE EXTENDED BEHIND CURBS OR PROPOSED SIDEWALKS A MINIMUM OF 3 FEET AND CAPPED FOR FUTURE USE.
- ALL CONDUIT SLEEVES TO BE USED FOR ELECTRIC, GAS, OR TELECOMMUNICATION UTILITY CROSSINGS SHALL BE INSTALLED TO MEET OR EXCEED DESIGN REQUIREMENTS FOR THE UTILITY AGENCY WHICH THEY ARE SERVING, INCLUDING BUT NOT LIMITED TO THE DEPTH, TRENCH PLACEMENT, AND PROXIMITY TO OTHER UTILITIES. THE CONTRACTOR IS SOLELY RESPONSIBLE FOR VERIFYING AND INSTALLING THE CONDUIT SLEEVES TO MEET THESE SPECIFICATIONS INCLUDING COORDINATING WITH THE UTILITY AGENCY FOR ANY REQUIRED INSPECTIONS.

TRENCH EXCAVATION SAFETY PROTECTION:

CONTRACTOR AND/OR CONTRACTOR'S INDEPENDENTLY RETAINED EMPLOYEE OR STRUCTURAL DESIGN/ GEOTECHNICAL/ SAFETY/EQUIPMENT CONSULTANT, IF ANY, SHALL REVIEW THESE PLANS AND ANY AVAILABLE GEOTECHNICAL INFORMATION AND THE ANTICIPATED INSTALLATION SITES WITHIN THE PROJECT WORK AREA IN ORDER TO IMPLEMENT CONTRACTOR'S TRENCH EXCAVATION SAFETY PROTECTION SYSTEMS, PROGRAMS AND PROCEDURES FOR THE PROJECT DESCRIBED IN THE CONTRACT DOCUMENTS. THE CONTRACTOR'S IMPLEMENTATION OF THESE SYSTEMS, PROGRAMS AND/OR PROCEDURES SHALL PROVIDE FOR ADEQUATE TRENCH EXCAVATION SAFETY PROTECTION THAT COMPLY WITH AS A MINIMUM, OSHA STANDARDS FOR TRENCH EXCAVATIONS. SPECIFICALLY, CONTRACTOR AND/OR CONTRACTOR'S INDEPENDENTLY RETAINED EMPLOYEE OR SAFETY CONSULTANT SHALL IMPLEMENT A TRENCH SAFETY PROGRAM IN ACCORDANCE WITH OSHA STANDARDS GOVERNING THE PRESENCE AND ACTIVITIES OF INDIVIDUALS WORKING IN AND AROUND TRENCH EXCAVATION.

CAUTION!!

CONTRACTOR SHALL BE REQUIRED TO LOCATE ALL PUBLIC OR PRIVATE UTILITIES INCLUDING BUT NOT LIMITING TO: WATER, SEWER, TELEPHONE AND FIBER OPTIC LINES, SITE LIGHTING ELECTRIC, SECONDARY ELECTRIC, PRIMARY ELECTRICAL DUCTBANKS, LANDSCAPE IRRIGATION FACILITIES, AND GAS LINES. ANY UTILITY CONFLICTS THAT ARISE SHOULD BE COMMUNICATED TO THE ENGINEER IMMEDIATELY AND PRIOR TO CONSTRUCTION. THE CONTRACTOR SHALL CONTACT 1-800-DIG-TESS A MINIMUM OF 48 HOURS PRIOR TO THE START OF CONSTRUCTION. ANY DAMAGE TO EXISTING UTILITIES SHALL BE THE SOLE RESPONSIBILITY OF THE CONTRACTOR AND THE REPAIR SHALL BE AT CONTRACTOR'S SOLE EXPENSE WHETHER THE UTILITY IS SHOWN ON THESE PLANS OR NOT.

UTILITY LEGEND

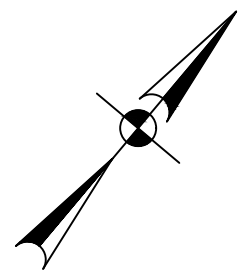
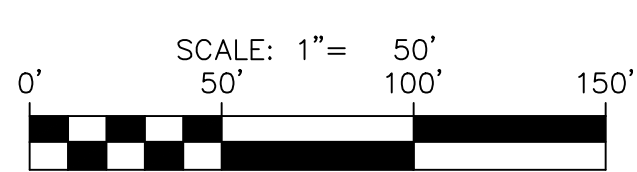
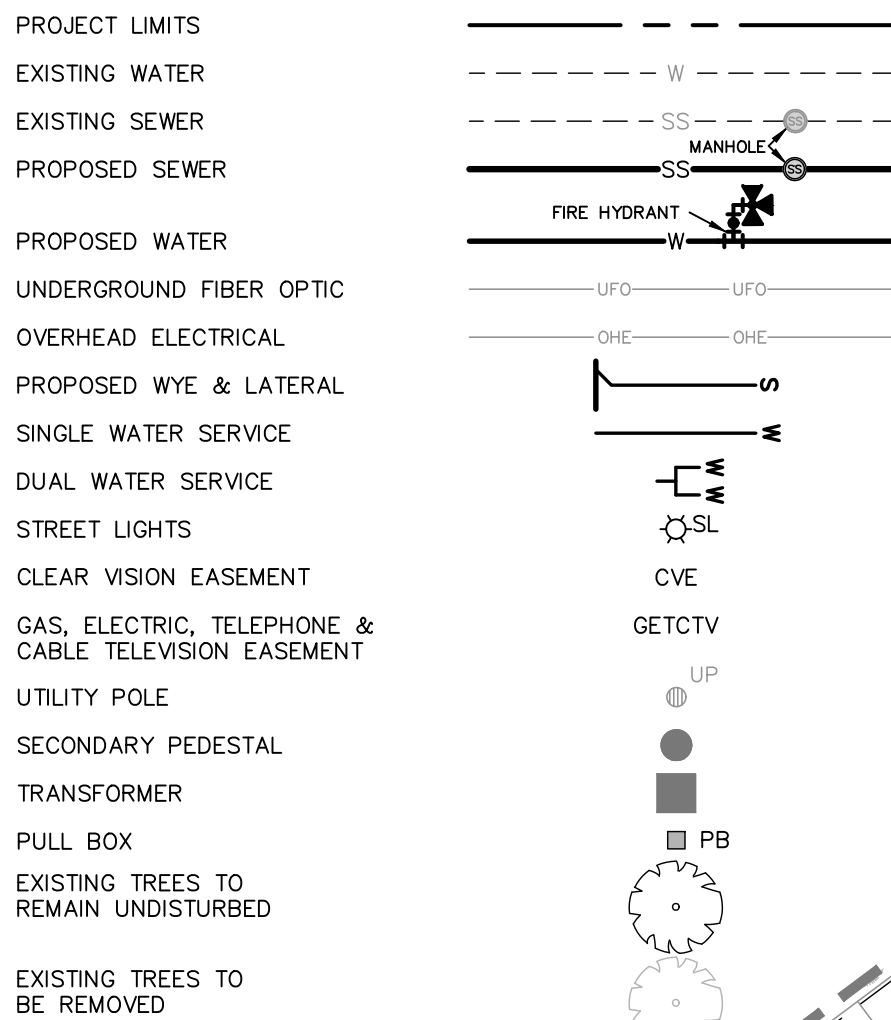

CONDUIT	SIZE/TYPE	MIN. DEPTH OF COVER
A (SECONDARY)	2-4" PVC (SCH 40)	36"
B (PRIMARY)	2-4" PVC (SCH 40)	36"
C (PRIMARY II)	2-4" PVC (SCH 40)	36"
D (LANDSCAPE)	2-4" PVC (SCH 40)	36"
E (STREETLIGHT)	1-4" PVC (SCH 40)	36"
F (TEXAS GAS)	3-6" PVC (SCH 80)	48"
G (TEXAS GAS)	3-6" PVC (SCH 80)	60"

CONDUIT	SIZE/TYPE	MIN. DEPTH OF COVER
H (TEXAS GAS)	2-6" PVC (SCH 80)	60"
I (TEXAS GAS)	2-6" PVC (SCH 80)	48"
J (TEXAS GAS)	2-6" PVC (SCH 80)	36"
K (PRIMARY II)	2-4" PVC (SCH 40)	36"
	7-8" PVC (SCH 80)	36"

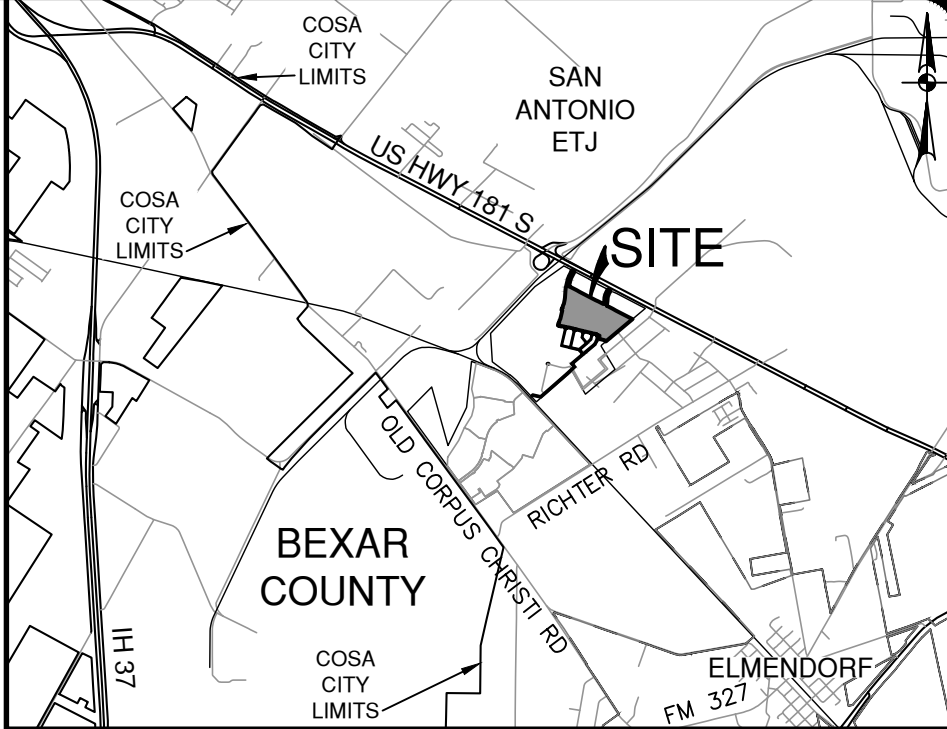
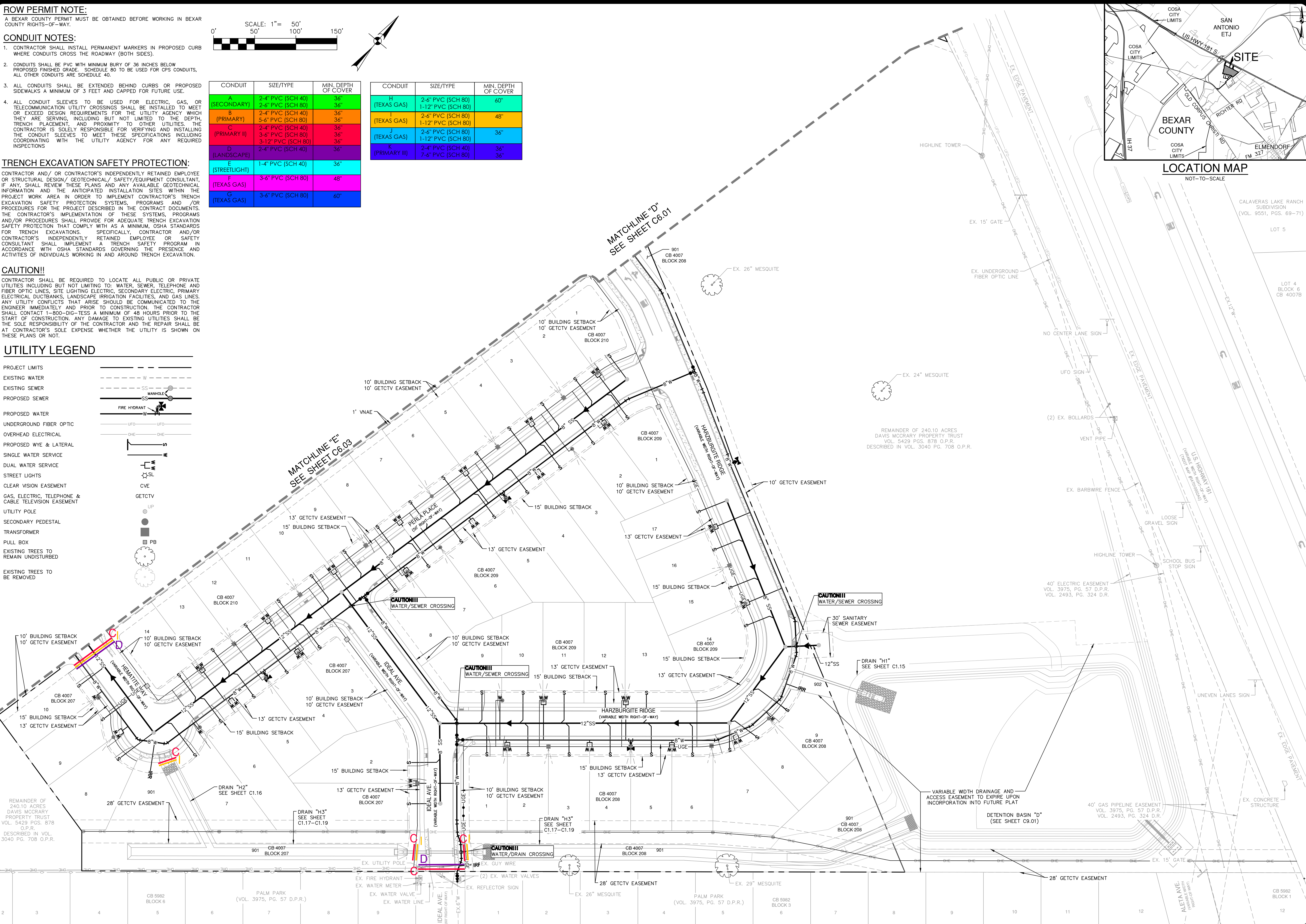

DATE	
NO.	
REVISION	

PAPE-DAWSON ENGINEERS
2000 NW LOOP 410 | SAN ANTONIO, TX 78213 | 210.375.9000
TEXAS ENGINEERING FIRM #470 | TEXAS SURVEYING FIRM #10028800

STONE GARDEN - UNIT 4A
BEXAR COUNTY, TEXAS
OVERALL UTILITY PLAN

PLAT NO.	24-11800158
JOB NO.	12482-13
DATE	NOVEMBER 2024
DESIGNER	CL
CHECKED	DW
DRAWN	JR
SHEET	C6.02

MATCHLINE "A" SEE SHEET C6.00

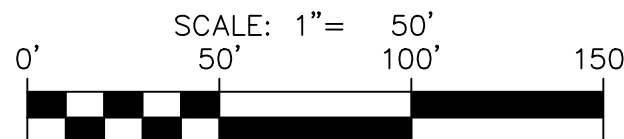
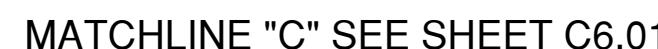

CAUTION!!

CONTRACTOR SHALL BE REQUIRED TO LOCATE ALL PUBLIC OR PRIVATE UTILITIES INCLUDING BUT NOT LIMITING TO: WATER, SEWER, TELEPHONE, AND FIBER OPTIC LINES, STEAM, LIGHTING, ELTRIC, SECONDARY ELECTRIC, PRIMARY ELECTRIC, DUCTBANKS, LANDSCAPE IRRIGATION, UTILITIES, AND GAS LINES. ANY UTILITY CONTACTS THAT ARISE SHOULD BE COMMUNICATED TO THE ENGINEER IMMEDIATELY AND PRIOR TO CONSTRUCTION. THE CONTRACTOR SHALL BE REQUIRED TO STOP WORK IMMEDIATELY IF ANY UTILITY IS LOCATED WITHIN 100'-0" TO 150'-0" DIGGING A MINIMUM OF 48 HOURS PRIOR TO THE START OF CONSTRUCTION. ANY DAMAGE TO EXISTING UTILITIES SHALL BE THE SOLE RESPONSIBILITY OF THE CONTRACTOR AND THE REPAIR SHALL BE AT CONTRACTOR'S SOLE EXPENSE WHETHER THE UTILITY IS SHOWN ON

PLAT NO. 24-11800158
JOB NO. 12482-13
DATE NOVEMBER 2024
DESIGNER CL
CHECKED DW DRAWN JR
SHEET C6.03

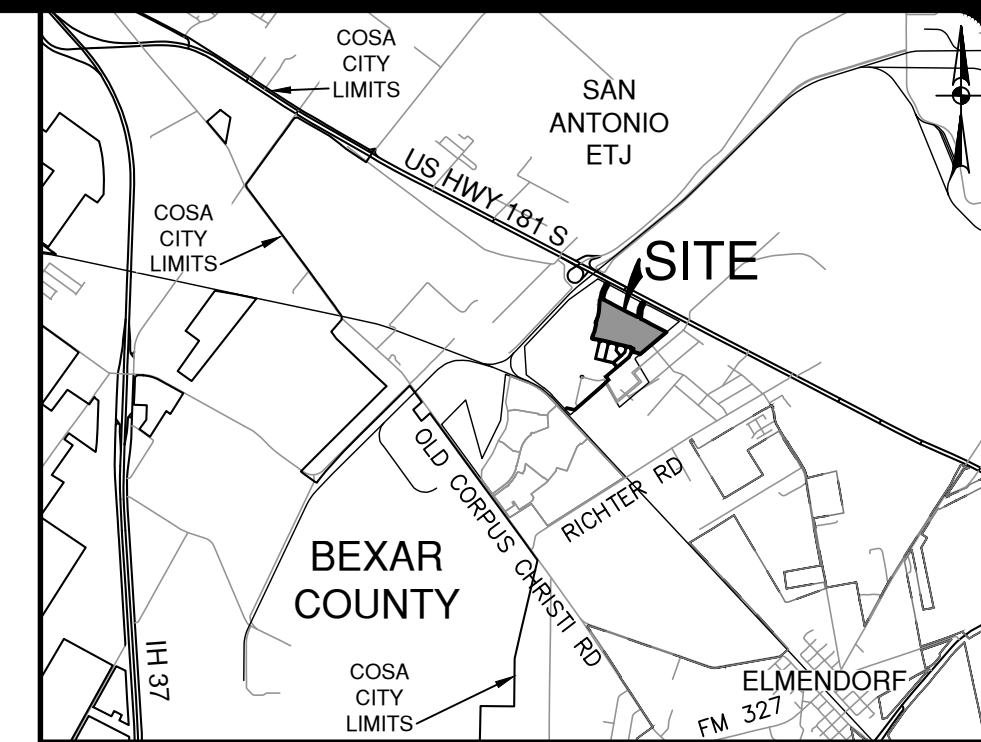

LOCATION MAP

NOT-TO-SCALE

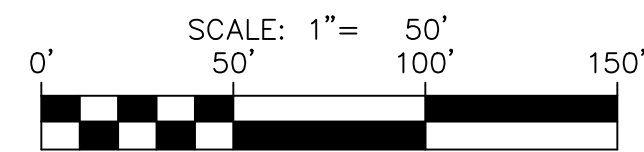

PROJECT LIMITS

EXISTING WATER

EXISTING SEWER

PROPOSED SEWER

PROPOSED WATER

UNDERGROUND FIBER OPTIC

OVERHEAD ELECTRICAL

PROPOSED WYE & LATERAL

SINGLE WATER SERVICE

DUAL WATER SERVICE

STREET LIGHTS

CLEAR VISION EASEMENT

GAS, ELECTRIC, TELEPHONE &
CABLE TELEVISION EASEMENT

UTILITY POLE

SECONDARY PEDESTAL

TRANSFORMER

PULL BOX

EXISTING TREES TO
REMAIN UNDISTURBED

EXISTING TREES TO
BE REMOVED

The legend defines the symbols used on the utility map:

- PROJECT LIMITS:** Indicated by a dashed line.
- EXISTING WATER:** Represented by a solid line with a 'W' label.
- EXISTING SEWER:** Represented by a solid line with an 'SS' label.
- PROPOSED SEWER:** Represented by a solid line with an 'SS' label.
- PROPOSED WATER:** Represented by a solid line with a 'W' label.
- UNDERGROUND FIBER OPTIC:** Represented by a dashed line with 'UFO' labels at both ends.
- OVERHEAD ELECTRICAL:** Represented by a solid line with 'OHE' labels at both ends.
- PROPOSED WYE & LATERAL:** Represented by a T-junction symbol.
- SINGLE WATER SERVICE:** Represented by a line ending in a single 'W' service symbol.
- DUAL WATER SERVICE:** Represented by a line ending in two 'W' service symbols.
- STREET LIGHTS:** Represented by a sun-like symbol with 'SL' in the center.
- CLEAR VISION EASEMENT:** Represented by a circle with 'CVE' below it.
- GAS, ELECTRIC, TELEPHONE & CABLE TELEVISION EASEMENT:** Represented by a circle with 'GETCTV' below it.
- UTILITY POLE:** Represented by a circle with 'UP' above it.
- SECONDARY PEDESTAL:** Represented by a solid black circle.
- TRANSFORMER:** Represented by a solid black square.
- PULL BOX:** Represented by an open square with 'PB' to its right.
- EXISTING TREES TO REMAIN UNDISTURBED:** Represented by a circle with a cross-hatch pattern.
- EXISTING TREES TO BE REMOVED:** Represented by a circle with a solid black fill.

ROW PERMIT NOTE:

A BEXAR COUNTY PERMIT MUST BE OBTAINED BEFORE WORKING IN BEXAR COUNTY RIGHTS-OF-WAY.

CONDUIT NOTES:

1. CONTRACTOR SHALL INSTALL PERMANENT MARKERS IN PROPOSED CURBS WHERE CONDUITS CROSS THE ROADWAY (BOTH SIDES).
2. CONDUITS SHALL BE PVC WITH MINIMUM BURIAL OF 36 INCHES BELOW PROPOSED FINISHED GRADE. SCHEDULE 80 TO BE USED FOR CPS CONDUITS, ALL OTHER CONDUITS ARE SCHEDULE 40.
3. ALL CONDUITS SHALL BE EXTENDED BEHIND CURBS OR PROPOSED SIDEWALKS A MINIMUM OF 3 FEET AND CAPPED FOR FUTURE USE.
4. ALL CONDUIT SLEEVES TO BE USED FOR ELECTRIC, GAS, OR TELECOMMUNICATION UTILITY CROSSINGS SHALL BE INSTALLED TO MEET OR EXCEED DESIGN REQUIREMENTS FOR THE UTILITY AGENCY WHICH IS PROVIDING THE SERVICE, INCLUDING, BUT NOT LIMITED TO THE DEPTH, TRENCH PLACEMENT, AND PROXIMITY TO OTHER UTILITIES. THE CONTRACTOR IS SOLELY RESPONSIBLE FOR VERIFYING AND INSTALLING THE CONDUIT SLEEVES TO MEET THESE SPECIFICATIONS INCLUDING COORDINATING WITH THE UTILITY AGENCY FOR ANY REQUIRED INSPECTIONS.

TRENCH EXCAVATION SAFETY PROTECTION

CONTRACTOR AND/OR CONTRACTOR'S INDEPENDENTLY RETAINED EMPLOYEE OR STRUCTURAL DESIGN/ GEOTECHNICAL/ SAFETY/EQUIPMENT CONSULTANT, IF ANY, SHALL REVIEW THESE PLANS AND ANY AVAILABLE GEOTECHNICAL INFORMATION AND THE ANTICIPATED INSTALLATION SITES WITHIN THE PROJECT WORK AREA IN ORDER TO IDENTIFY ANY POTENTIAL TRENCH EXCAVATION SAFETY PROTECTION SYSTEMS, PROGRAMS AND/OR PROCEDURES FOR THE PROJECT DESCRIBED IN THE CONTRACT DOCUMENTS. THE CONTRACTOR'S IMPLEMENTATION OF THESE SYSTEMS, PROGRAMS AND/OR PROCEDURES SHALL PROVIDE FOR ADEQUATE TRENCH EXCAVATION SAFETY PROTECTION TO EMPLOYEES AND ANY MINOR CONTRACTOR'S EMPLOYEES FOR TRENCH EXCAVATIONS. SPECIFICALLY, CONTRACTOR AND/OR CONTRACTOR'S INDEPENDENTLY RETAINED EMPLOYEE OR SAFETY CONSULTANT SHALL IMPLEMENT A TRENCH SAFETY PROGRAM IN ACCORDANCE WITH OSHA STANDARDS REGARDING THE DESIGN AND ACTIVITIES OF INDIVIDUALS WORKING ABOVE AND UNDER TRENCH EXCAVATION.

CAUTION!!

CONTRACTOR SHALL BE REQUIRED TO LOCATE ALL PUBLIC OR PRIVATE UTILITIES INCLUDING BUT NOT LIMITING TO: WATER, SEWER, TELEPHONE AND FIBER OPTIC LINES, SITE LIGHTING ELECTRICAL, SECONDARY ELECTRIC, PRIMARY ELECTRICAL DUCTBANKS, LANDSCAPE IRRIGATION FACILITIES, AND GAS LINES. ANY UTILITY CONFLICTS THAT ARISE SHOULD BE COMMUNICATED TO THE ENGINEER IMMEDIATELY AND PRIOR TO CONSTRUCTION. THE CONTRACTOR SHALL CONTACT 1-800-DIG-TESS A MINIMUM OF 48 HOURS PRIOR TO THE START OF ANY CONSTRUCTION. ANY DAMAGE TO EXISTING UTILITIES SHALL BE THE SOLE RESPONSIBILITY OF THE CONTRACTOR AND THE REPAIR SHALL BE AT CONTRACTOR'S SOLE EXPENSE WHETHER THE UTILITY IS SHOWN ON THESE PLANS OR NOT.

CONDUIT	SIZE/TYPE	MIN. DEPTH OF COVER
A (SECONDARY)	2-4" PVC (SCH 40)	36"
B (PRIMARY)	2-6" PVC (SCH 80)	36"
C (PRIMARY II)	2-4" PVC (SCH 40)	36"
D (LANDSCAPE)	3-6" PVC (SCH 80)	36"
E (STREETLIGHT)	3-12" PVC (SCH 80)	36"
F (TEXAS GAS)	2-4" PVC (SCH 40)	48"
G (TEXAS GAS)	3-6" PVC (SCH 80)	60"

CONDUIT	SIZE/TYPE	MIN. DEPTH OF COVER
H (TEXAS GAS)	2-6" PVC (SCH 80) 1-12" PVC (SCH 80)	60"
I (TEXAS GAS)	2-6" PVC (SCH 80) 1-12" PVC (SCH 80)	48"
J (TEXAS GAS)	2-6" PVC (SCH 80) 1-12" PVC (SCH 80)	36"
K (PRIMARY III)	2-4" PVC (SCH 40) 7-6" PVC (SCH 80)	36" 36"

[illegible]

**PAPE-DAWSON
ENGINEERS**

2000 NW LOOP 410 | SAN ANTONIO, TX 78213 | 210.375.9000
TEXAS ENGINEERING FIRM #470 | TEXAS SURVEYING FIRM #10028800

STONE GARDEN - UNIT 4A
BEXAR COUNTY, TEXAS

OVERALL UTILITY PLAN

PLAT NO. 24-11800158
JOB NO. 12482-13
DATE NOVEMBER 2024
DESIGNER CL
CHECKED DW DRAWN JR
SHEET C6.04

