

Date: Nov 13, 2024, 2:52pm User ID: odcadta  
File: P:\130453\20\Design\Civil\Tree\Tree Plan Cover.dwg

THIS DOCUMENT HAS BEEN PRODUCED FROM MATERIAL THAT WAS STORED AND/OR TRANSMITTED ELECTRONICALLY AND MAY HAVE BEEN INADVERTENTLY ALTERED. RELY ONLY ON FINAL HARDCOPY MATERIALS BEARING THE CONSULTANT'S ORIGINAL SIGNATURE AND SEAL. AERIAL IMAGERY PROVIDED BY GOOGLE® UNLESS OTHERWISE NOTED. Imagery © 2016, CAPOCO, Digital Globe, Texas Orthology Program, USDA Farm Service Agency.

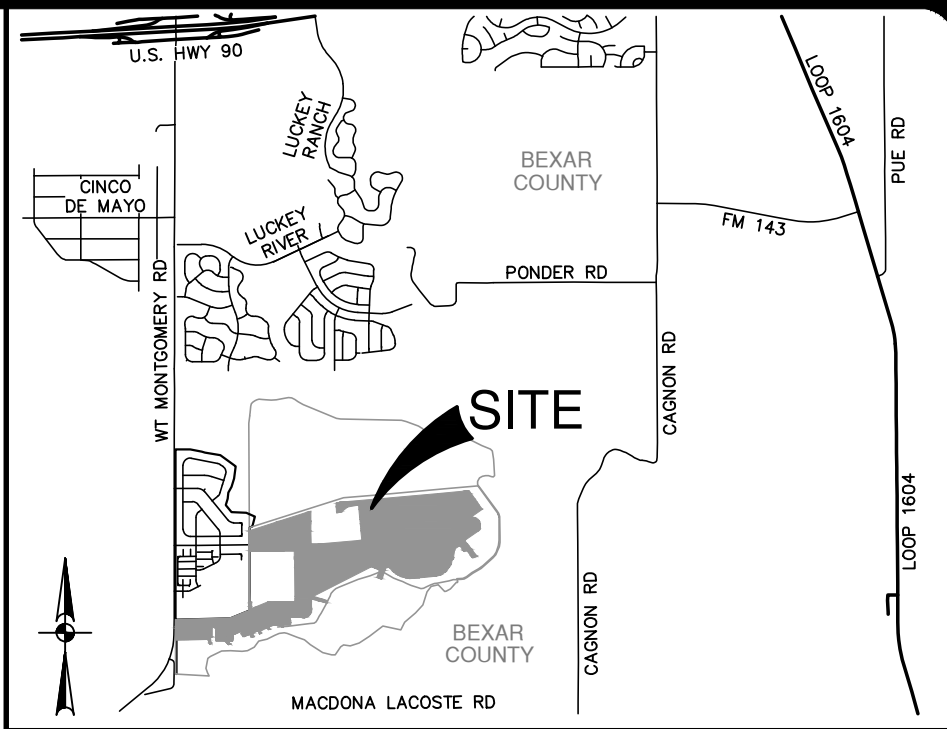

LOCATION MAP  
NOT-TO-SCALE

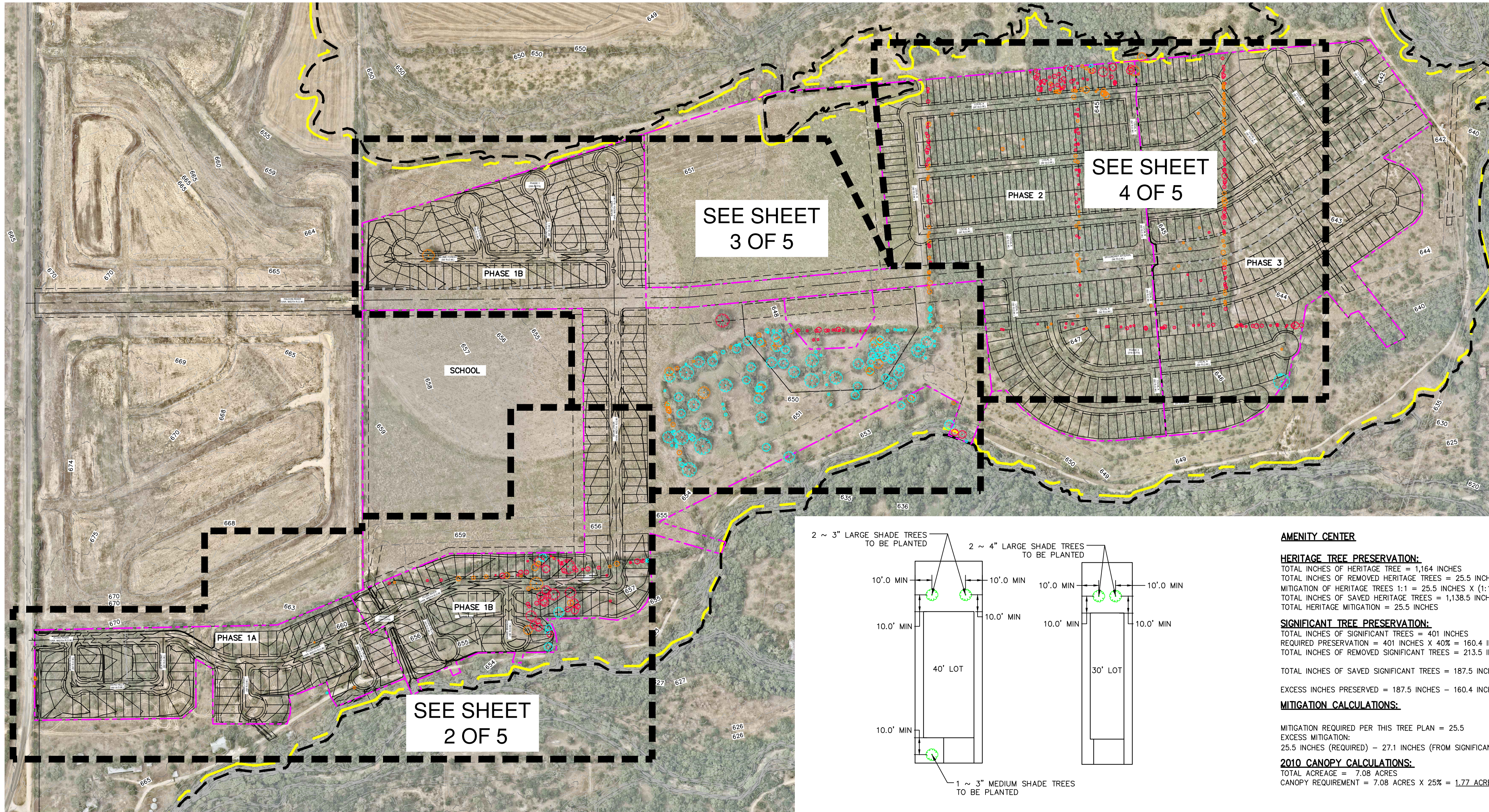
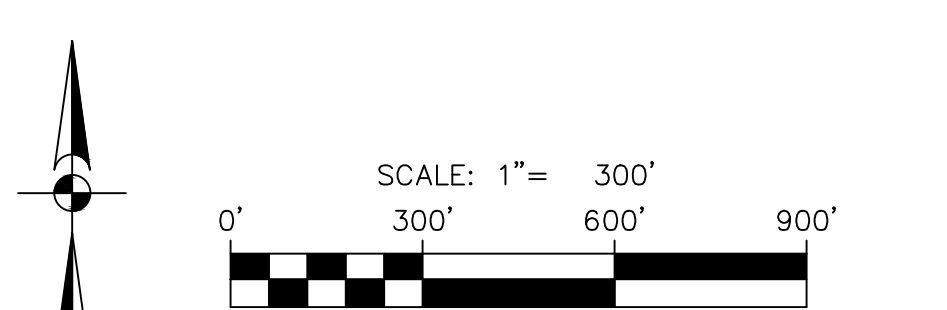

LEGEND

- 100-YEAR FEMA FLOODPLAIN
- 30' FLOODPLAIN BUFFER
- UNIT BOUNDARY
- PROPOSED EASEMENT
- EXEMPT TREES TO BE REMOVED
- PROTECTED TREES TO BE REMOVED
- TREES SAVED

AMENITY CENTER

HERITAGE TREE PRESERVATION:

TOTAL INCHES OF HERITAGE TREE = 1,164 INCHES  
TOTAL INCHES OF REMOVED HERITAGE TREES = 25.5 INCHES  
MITIGATION OF HERITAGE TREES 1:1 = 25.5 INCHES X (1:1 RATIO) = 25.5 INCHES  
TOTAL INCHES OF SAVED HERITAGE TREES = 1,138.5 INCHES  
TOTAL HERITAGE MITIGATION = 25.5 INCHES

SIGNIFICANT TREE PRESERVATION:

TOTAL INCHES OF SIGNIFICANT TREES = 401 INCHES  
REQUIRED PRESERVATION = 401 INCHES X 40% = 160.4 INCHES  
TOTAL INCHES OF REMOVED SIGNIFICANT TREES = 213.5 INCHES

TOTAL INCHES OF SAVED SIGNIFICANT TREES = 187.5 INCHES  
EXCESS INCHES PRESERVED = 187.5 INCHES - 160.4 INCHES = 27.1 INCHES

MITIGATION CALCULATIONS:

MITIGATION REQUIRED PER THIS TREE PLAN = 25.5  
EXCESS MITIGATION:  
25.5 INCHES (REQUIRED) - 27.1 INCHES (FROM SIGNIFICANT TREES) = 1.6 INCHES (EXCESS)

2010 CANOPY CALCULATIONS:

TOTAL ACREAGE = 7.08 ACRES  
CANOPY REQUIREMENT = 7.08 ACRES X 25% = 1.77 ACRES OF REQUIRED CANOPY

HERITAGE TREE PRESERVATION:

TOTAL INCHES OF HERITAGE TREE = 3,126.5 INCHES  
TOTAL INCHES OF REMOVED HERITAGE TREES = 1,101.5 INCHES  
MITIGATION OF HERITAGE TREES 3:1 = 1012.5 INCHES X (3:1 RATIO) = 3,037.5 INCHES  
MITIGATION OF HERITAGE TREES 1:1 = 89 INCHES X (1:1 RATIO) = 89 INCHES  
TOTAL INCHES OF SAVED HERITAGE TREES = 1,830.5 INCHES  
TOTAL HERITAGE MITIGATION = 3,126.5 INCHES

SIGNIFICANT TREE PRESERVATION:

TOTAL INCHES OF SIGNIFICANT TREES = 3,248.5 INCHES  
REQUIRED PRESERVATION = 3,248.5 INCHES X 35% = 1,137 INCHES  
TOTAL INCHES OF REMOVED SIGNIFICANT TREES = 2,567.5 INCHES  
TOTAL INCHES OF SAVED SIGNIFICANT TREES = 681 INCHES  
ADDITIONAL MITIGATION REQUIRED = 1,137 INCHES - 681 INCHES = 456 INCHES  
PERCENTAGE OF TREES PRESERVED = 456/3,248.5 = 14.0%

FLOODPLAIN BUFFER CALCULATIONS:

TOTAL INCHES OF HERITAGE TREES INSIDE FLOODPLAIN BUFFER = 70.5 INCHES  
TOTAL INCHES OF SIGNIFICANT TREES INSIDE FLOODPLAIN BUFFER = 12.8 INCHES  
REQUIRED TREE PRESERVATION AREA = 12.8 INCHES X (80% MIN) = 10.24 INCHES  
PROPOSED TREE PRESERVATION AREA = 12.8 INCHES  
EXCESS INCHES PRESERVED = 12.8 INCHES - 10.24 INCHES = 2.56 INCHES

MITIGATION CALCULATIONS:

MITIGATION REQUIRED PER THIS TREE PLAN = 3,126.5 INCHES + 456 INCHES = 3,582.5 INCHES  
REQUIRED STREETScape:

SECONDARY ARTERIAL = (5,210 LF X 80%) = 4,168 LF X 1 TREE/50 LF X 2 SIDES OF ROW = 168 TREES  
STREETSCAPE REQUIRED = 168 TREES - 1.5" TREES REQUIRED  
STREETSCAPE TREES PROVIDED = 168 - 3" TREES

MITIGATION FROM STREETSCAPE = (1.5" X 168 TREES) = 252 INCHES

TOTAL MITIGATION PER LOT PROVIDED:  
2 - 3" TREES PER LOT WILL BE PLANTED (1.5" TREES REQUIRED PER UDC)

TOTAL INCHES PROVIDED PER 40' LOT = 2 (3" PROVIDED - 1.5" REQUIRED PER UDC) + 1 (1.5" PROVIDED) = 4.5 INCH PER LOT  
TOTAL INCHES PROVIDED PER 30' LOT = 2 (4" PROVIDED - 1.5" REQUIRED PER UDC) = 5.0 INCH PER LOT

MITIGATION FROM LOTS = (4.5 INCH PER LOT X 585 LOTS) + (5.0 INCH PER LOT X 231 LOTS) = 3,787.5 INCHES

EXCESS MITIGATION:  
3,582.5 INCHES (REQUIRED) - 252 INCHES (FROM STREETSCAPE) - 3,787.5 INCHES (FROM LOTS) = 2.56 (FROM FLOODPLAIN BUFFER) = 459.56 INCHES (EXCESS)

2010 CANOPY CALCULATIONS:

TOTAL ACREAGE = 176.77 ACRES  
TOTAL LOTS = 816 LOTS  
CANOPY REQUIREMENT = 169.69 ACRES X 38% = 64.48 ACRES OF REQUIRED CANOPY  
PROVIDED CANOPY:  
TOTAL PLANTED TREES PER LOT = 3 TREES/LOT  
(2 OF THE 3 TREES REQUIRED SHALL BE PLANTED ON THE SOUTH OR WEST SIDE OF HOUSE FOR ENERGY CONSERVATION CREDIT OF 1.5/TREE)  
2 LARGE TREES/LOT X 816 LOTS X 1,200 SQUARE FEET/TREE X 1 ACRE/43,560 SQUARE FEET X 90% = 40.46 ACRES  
1 MEDIUM TREE/LOT X 816 LOTS X 875 SQUARE FEET/TREE X 1 ACRE/43,560 SQUARE FEET X 90% = 14.75 ACRES  
ENERGY CREDITS: 816 LOTS X 2 TREES/LOT X 1,200 SQUARE FEET/TREE X 1 ACRE/43,560 SQUARE FEET X 90% X 50% = 20.23 ACRES  
EXCESS CANOPY = 75.44 ACRES (PROVIDED) - 64.48 ACRES (REQUIRED RESIDENTIAL) = 10.96 ACRES (EXCESS)

TREE PROTECTION AND PRESERVATION GENERAL NOTES:

- NO UTILITY OR STREET EXCAVATION WORK SHALL BEGIN IN AREAS WHERE TREE PRESERVATION AND TREATMENT MEASURES HAVE NOT BEEN COMPLETED AND APPROVED.
- TREE PROTECTION FENCING SHALL BE REQUIRED. TREE PROTECTION FENCING SHALL BE INSTALLED, MAINTAINED AND REPAIRED BY THE CONTRACTOR DURING SITE CONSTRUCTION. DURING CONSTRUCTION ACTIVITY, AT LEAST A SIX-INCH LAYER OF COARSE MULCH SHALL BE PLACED AND MAINTAINED OVER THE ROOT PROTECTION ZONE (NO SEPARATE PAY ITEM).
- THE CONTRACTOR SHALL AVOID CUTTING ROOTS LARGER THAN ONE INCH IN DIAMETER WHEN EXCAVATING NEAR EXISTING TREES. EXCAVATION IN THE VICINITY OF TREES SHALL PROCEED WITH CAUTION. THE CONTRACTOR SHALL CONTACT THE CITY INSPECTOR FOR GUIDANCE.
- ROOTS WILL BE CUT WITH A ROCK SAW OR BY HAND, NOT BY AN EXCAVATOR OR OTHER ROAD CONSTRUCTION EQUIPMENT.
- ALL CURB AND SIDEWALK WORK SHALL USE ALTERNATIVE CONSTRUCTION METHODS TO MINIMIZE EXTENSIVE ROOT DAMAGE TO TREES (REFER TO DETAILS).
- EXPOSED ROOTS SHALL BE COVERED AT THE END OF THE DAY USING TECHNIQUES SUCH AS COVERING WITH SOIL, MULCH, OR WET BURLAP.
- NO EQUIPMENT, VEHICLES OR MATERIALS SHALL OPERATE OR BE STORED WITHIN THE ROOT PROTECTION ZONE OF ANY TREE NEAR THE PROJECT. ROOT PROTECTION ZONE IS 1 FOOT OF RADIUS PER INCH OF TREE'S DIAMETER. A 10-INCH DIAMETER TREE WOULD HAVE A 10 FOOT RADIUS ROOT PROTECTION ZONE AROUND THE TREE. ROOTS OR BRANCHES IN CONFLICT WITH THE CONSTRUCTION SHALL BE CUT CLEANLY ACCORDING TO PROPER PRUNING METHODS. OAK WOUNDS SHALL BE PAINTED OVER WITHIN 30 MINUTES TO PREVENT OAK WILT.
- NO WIRES, NAILS OR OTHER MATERIAL MAY BE ATTACHED TO PROTECTED TREES.
- TREES, TREE LIMBS, BUSHES AND SHRUBS LOCATED ON THE CITY STREET OR ALLEY, RIGHT-OF-WAY OR PERMANENT EASEMENTS WHICH INTERFERE WITH PROPOSED CONSTRUCTION ACTIVITIES SHALL BE PROPERLY PRUNED FOLLOWING THE ANSI A-300 STANDARDS FOR PRUNING. ALL TREE PRUNING SHALL BE COMPLETED BY A CITY OF SAN ANTONIO TREE MAINTENANCE LICENSED CONTRACTOR (ARTICLE 21-71, CITY CODE) ONLY AFTER APPROVAL FROM THE CAPITAL PROJECT MANAGER'S THROUGH THE INSPECTOR.
- NO EXCESSIVE TREE TRIMMING WILL BE PERMITTED.
- ALL DEBRIS GENERATED BY THE PRUNING AND TRIMMING OF THE TREES AND / OR BUSHES SHALL BECOME THE PROPERTY OF THE CONTRACTOR AND SHALL BE DISPOSED OF PROPERLY (NO SEPARATE PAY ITEM).
- TREES MUST BE MAINTAINED IN GOOD HEALTH THROUGHOUT THE CONSTRUCTION PROCESS. MAINTENANCE MAY INCLUDE, BUT NOT LIMITED TO: WATERING THE ROOT PROTECTION ZONE, WASHING FOLIAGE, FERTILIZATION, PRUNING, ADDITIONAL MULCH APPLICATIONS AND OTHER MAINTENANCE AS NEEDED ON THE PROJECT.
- ANY TREE REMOVAL SHALL BE APPROVED BY THE CITY ARBORIST. (207-0278)
- TREES WHICH ARE DAMAGED OR LOST DUE TO THE CONTRACTOR'S NEGLIGENCE DURING CONSTRUCTION SHALL BE MITIGATED TO THE CITY'S SATISFACTION.
- TREE PLANTING FOR MITIGATION OR ENHANCEMENT: ALL PLANTED TREES SHALL BE MAINTAINED IN A HEALTHY CONDITION AT ALL TIMES. THIS INCLUDES IRRIGATION, FERTILIZING, PRUNING AND OTHER MAINTENANCE AS NEEDED ON THE PROJECT. TREES THAT DIE WITHIN TWELVE (12) MONTHS SHALL BE REPLACED WITH A TREE EQUAL SIZE AND SPECIES.
- EXISTING AND PROPOSED GRADES WILL BE REQUIRED ON THE TREE PRESERVATION PLANS FOR FUTURE UNITS PRIOR TO ANY TREE REMOVAL OR SITE WORK WITHIN THOSE UNITS.
- TREE PLANTING SOIL REQUIREMENT NOTE: PER 35-523(M)(7); ALL TREE PLANTING SUBJECT TO SECTION 35-523(M) SHALL BE REQUIRED TO BE PLANTED IN SOIL THAT IS SUITABLE FOR ESTABLISHING AND SUSTAINING THE PLANTINGS, IN ADDITION TO CONTAINING SUITABLE SOIL PARTICLE SIZE AND DEPTH OF SOIL ZONE. THE SOIL MUST CONTAIN SUFFICIENT ORGANIC MATTER AND NUTRIENTS. TESTING AND CONFIRMATION BY A LANDSCAPE ARCHITECT, OR A TEXAS LICENSED SOIL TESTING FIRM SHALL BE COMPLETED TO ENSURE THE SOILS ARE SUITABLE. IN LIEU OF CONFIRMATION BY A LANDSCAPE ARCHITECT, OR A TEXAS LICENSED SOIL TESTING FIRM, SOIL MAY BE AMENDED WITH COMPOST BY ADDING THREE (3) INCHES OF COMPOST BLENDED INTO EVERY ONE (1) FOOT OF SOIL. FOR COMPLETE SOIL REPLACEMENT, SUCH AS TREE PLANTINGS, AN AMOUNT OF TWENTY-FIVE (25) PERCENT COMPOST MAY BE ADDED TO SEVENTY-FIVE (75) PERCENT NATIVE SOIL.

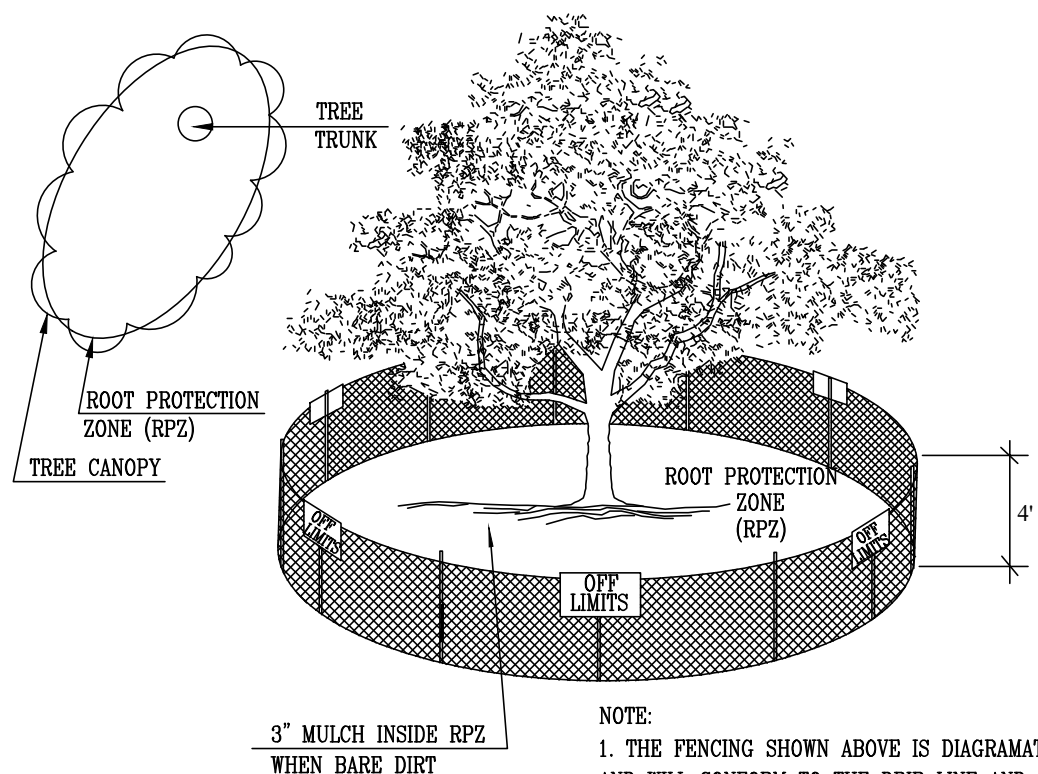

1.1.2 LEVEL I & FENCE PROTECTION

N. T. S.

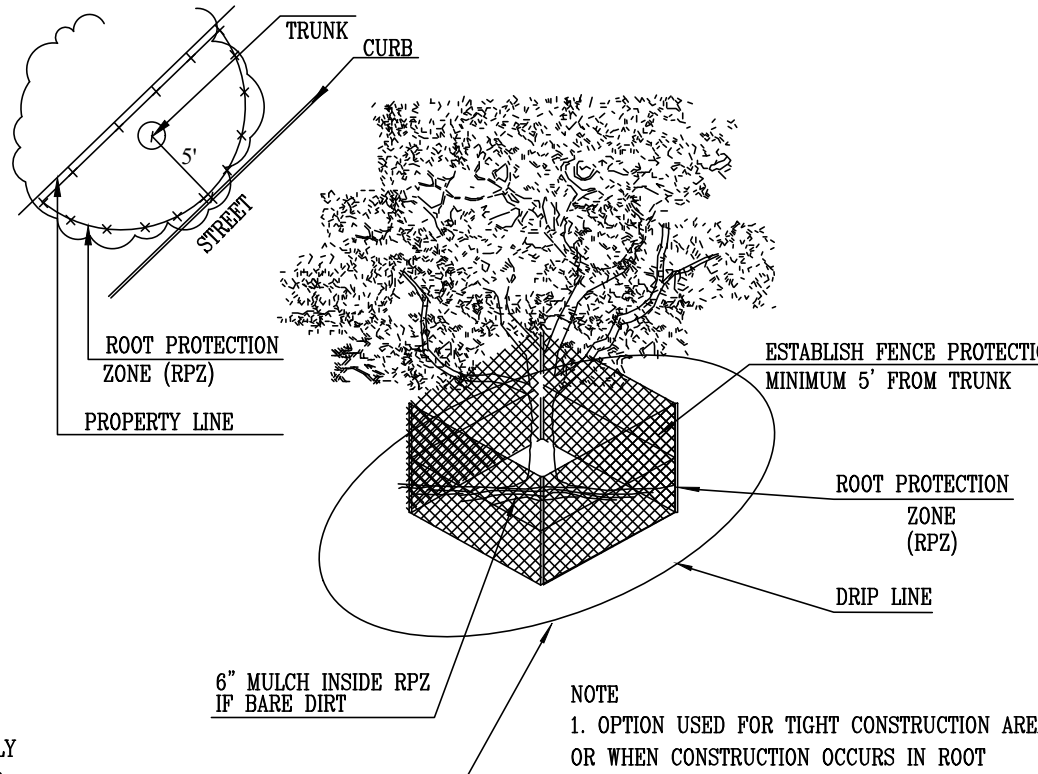

1.1.3 LEVEL II & FENCE PROTECTION

N. T. S.

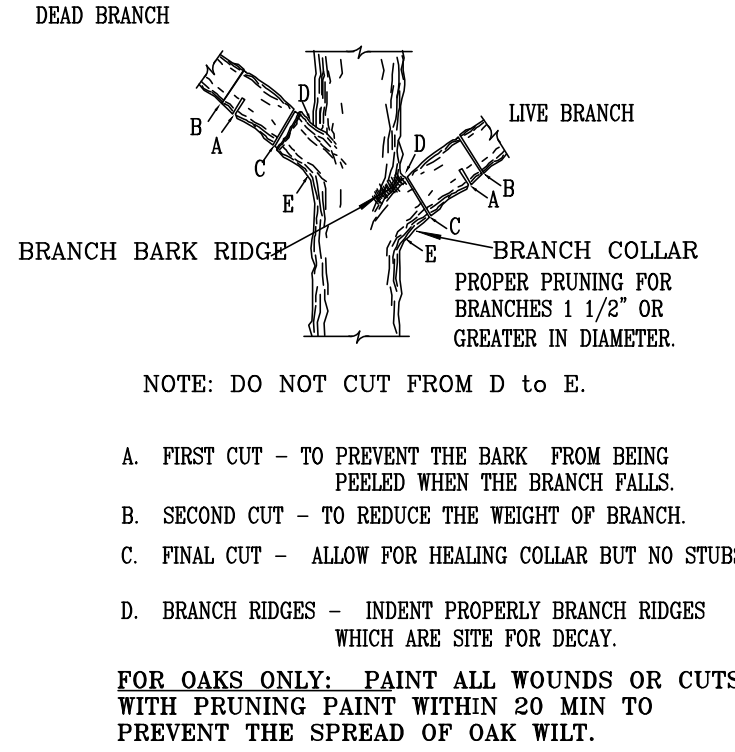

1.1.4 BRANCH PRUNING DETAIL

N. T. S.

NO.	REVISION	DATE

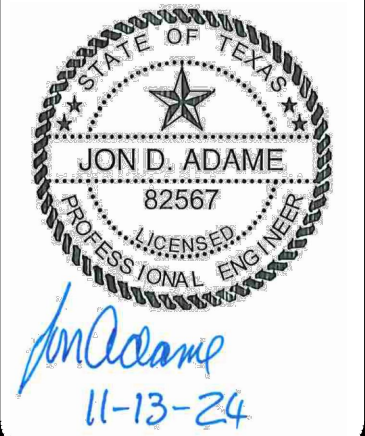



**PAPE-DAWSON**  
**ENGINEERS**  
2000 NW LOOP 410 | SAN ANTONIO, TX 78213 | 210.375.9000  
TEXAS ENGINEERING FIRM #470 | TEXAS SURVEYING FIRM #1008800

**BLOSSOM RANCH**  
SAN ANTONIO, TEXAS  
TREE PRESERVATION PLAN

PLAT NO.	-
JOB NO.	13055-03
DATE	OCTOBER 2024
DESIGNER	AD
CHECKED	AS
DRAWN	AD
SHEET	1 OF 5

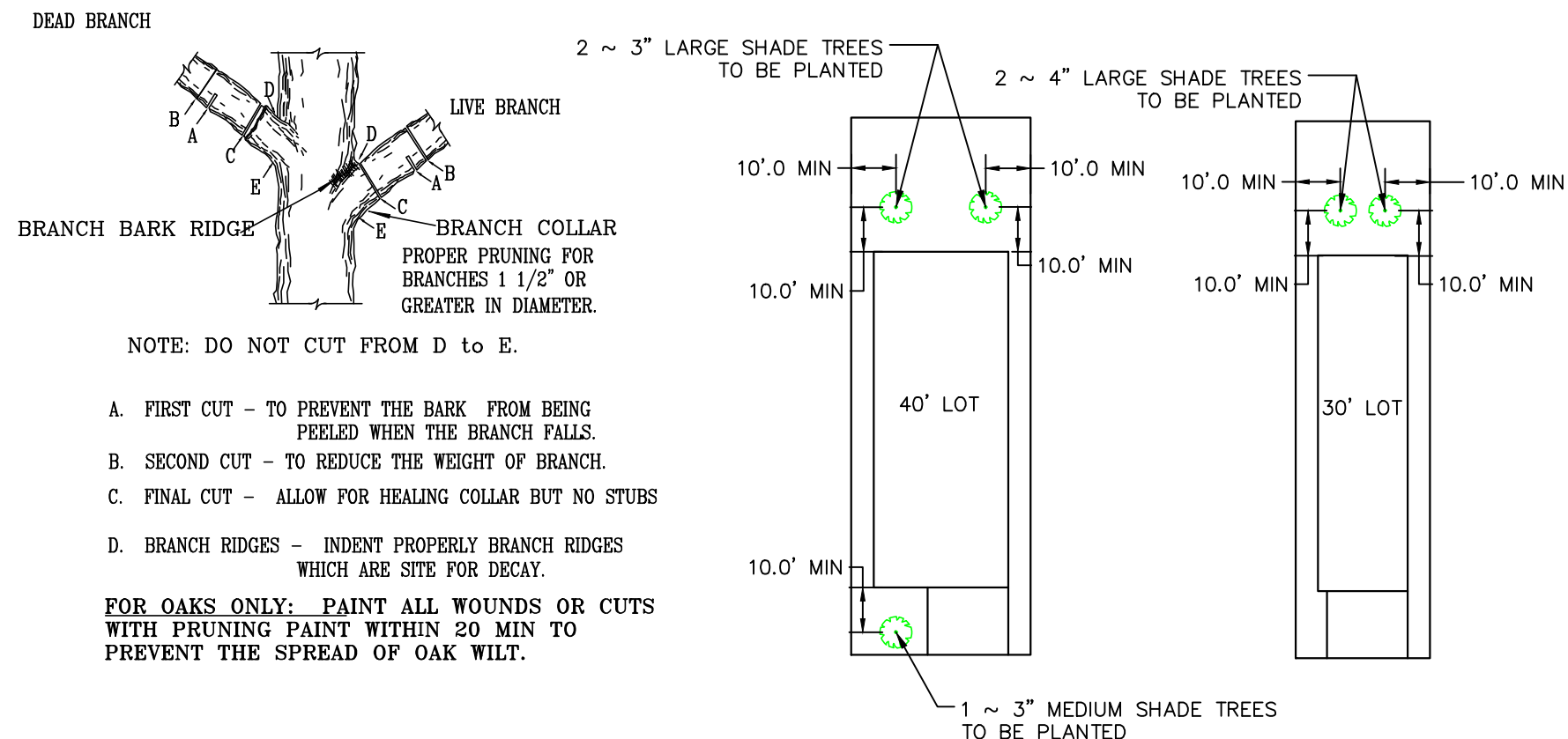
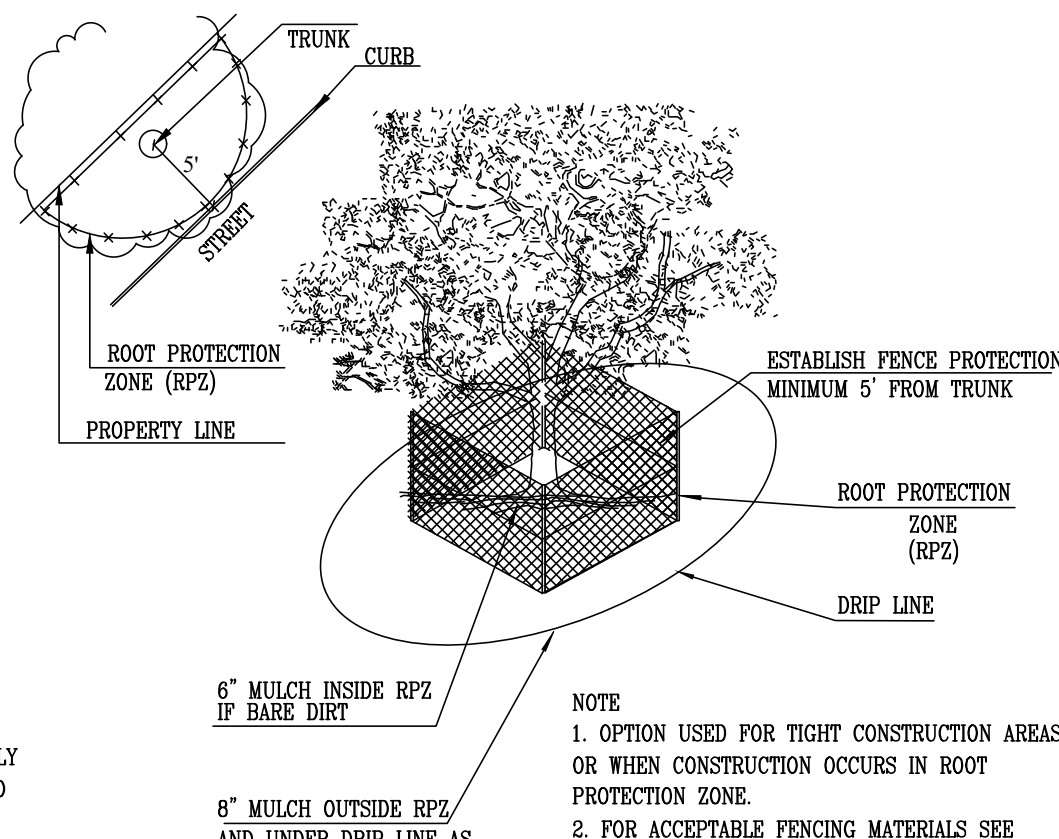



- 
 100-YEAR FEMA FLOODPLAIN  
 30' FLOODPLAIN BUFFER  
 UNIT BOUNDARY  
 PROPOSED EASEMENT  
 EXEMPT TREES TO BE REMOVED  
 PROTECTED TREES TO BE REMOVED  
 TREES SAVED

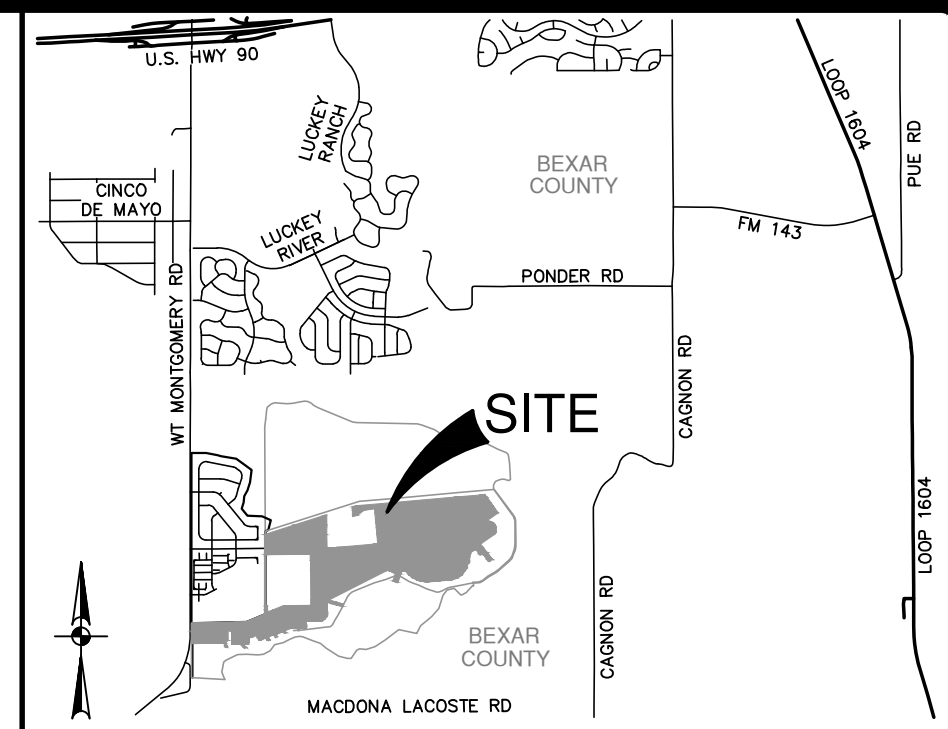

### LOCATION MAP

NOT-TO-SCALE

MATCHLINE "A" - SEE SHEET 3 OF 5

MATCHLINE "A" - SEE SHEET 3 OF 5

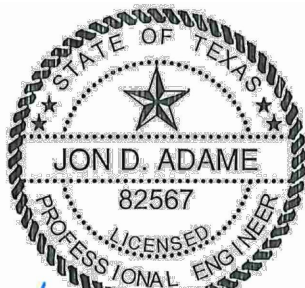

11-13-24



**PAPE-DAWSON  
ENGINEERS**

2000 NW LOOP 410 I SAN ANTONIO, TX 78213 I 210.375.9000  
TEXAS ENGINEERING FIRM #470 I TEXAS SURVEYING FIRM #10028800

**BLOSSOM RANCH**  
**SAN ANTONIO, TEXAS**

# TREE PRESERVATION PLAN

PLAT NO. \_\_\_\_\_  
JOB NO. 13055-03  
DATE OCTOBER 2024  
DESIGNER \_\_\_\_\_ AD  
CHECKED AS DRAWN AD  
SHEET **2 OF 5**

Date: Nov 13, 2024, 2:54pm User ID: adavila  
File: C:\Users\LOCAL\_~1\Temp\AcPublish\_12104\Tree Plan.dwg

THIS DOCUMENT HAS BEEN PRODUCED FROM MATERIAL THAT WAS STORED AND/OR TRANSMITTED ELECTRONICALLY AND MAY HAVE BEEN INADVERTENTLY ALTERED. RELY ONLY ON FINAL HARDCOPY MATERIALS BEARING THE CONSULTANT'S ORIGINAL SIGNATURE AND SEAL. AERIAL IMAGERY PROVIDED BY GOOGLE® UNLESS OTHERWISE NOTED. Imagery © 2016, CAPCOG Digital Globe, Texas OrthoImagery Program, USDA Farm Service Agency.



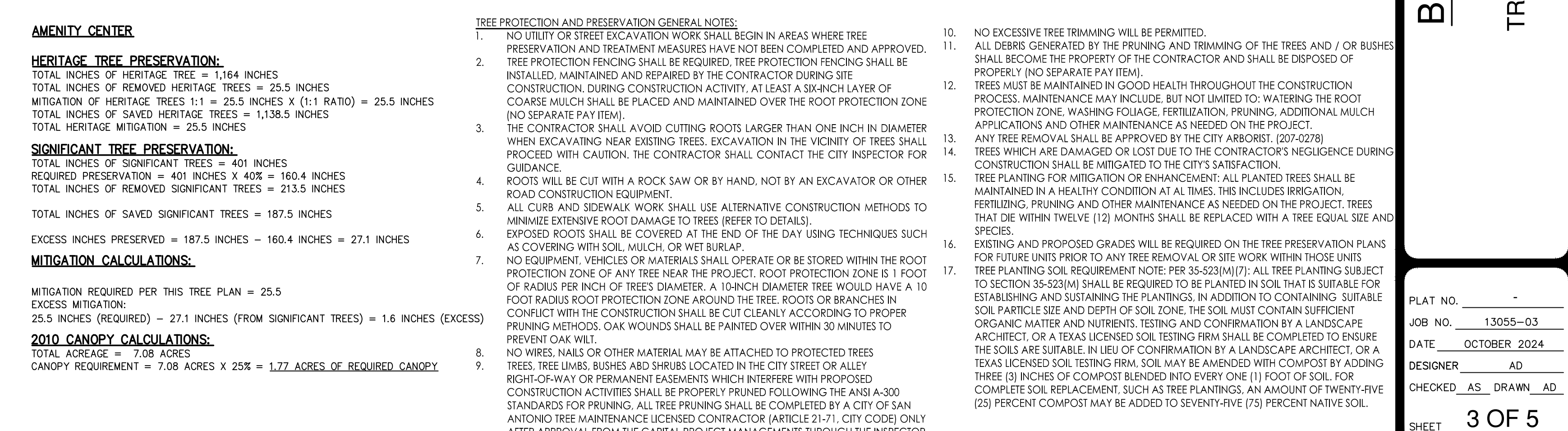



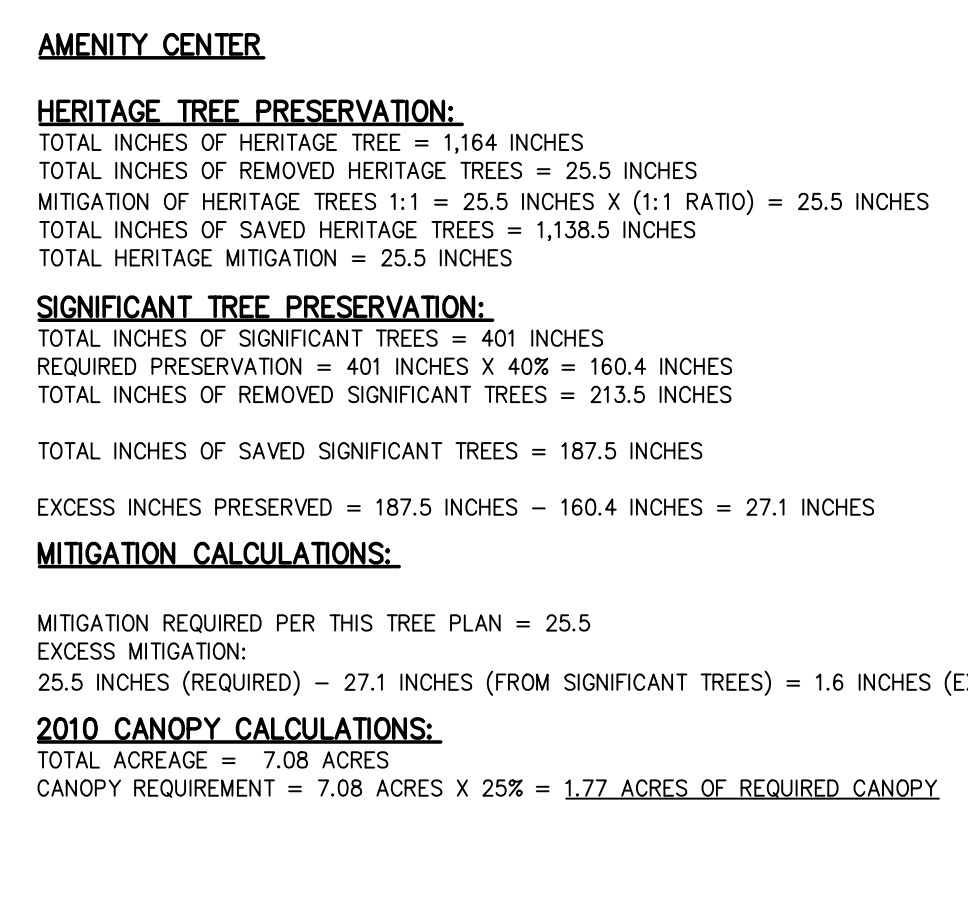



SIGNIFICANT TREES TO BE REMOVED (RESIDENTIAL)				
TAG#	SPECIES	SIZE (IN.)	TAG#	SPECIES
1078	MESQUITE	11	1488	HACKBERRY
1083	MESQUITE	10	1499	HACKBERRY
1084	MESQUITE	11.5	1500	HACKBERRY
1086	MESQUITE	11	3007	HACKBERRY
1106	HACKBERRY	11	3008	HACKBERRY
1107	HACKBERRY	10	3009	HACKBERRY
1108	HACKBERRY	10	3010	HACKBERRY
1109	HACKBERRY	10	3011	HACKBERRY
1110	MESQUITE	10.5	3012	HACKBERRY
1112	HACKBERRY	10.5	3013	HACKBERRY
1113	HACKBERRY	11	3014	HACKBERRY
1114	HACKBERRY	10.5	3019	HACKBERRY
1115	HACKBERRY	16	3020	HACKBERRY
1116	HACKBERRY	10	3021	HACKBERRY
1117	HACKBERRY	11	3024	HACKBERRY
1118	HACKBERRY	17	3025	HACKBERRY
1119	HACKBERRY	18	3026	HACKBERRY
1120	HACKBERRY	10	3027	HACKBERRY
1121	HACKBERRY	14	3028	HACKBERRY
1122	HACKBERRY	11.5	3029	HACKBERRY
1123	MESQUITE	18	3030	HACKBERRY
1124	HACKBERRY	14	3031	HACKBERRY
1125	HACKBERRY	12	3032	HACKBERRY
1127	HACKBERRY	13	3033	HACKBERRY
1128	HACKBERRY	18	3034	HACKBERRY
1129	HACKBERRY	10	3040	HACKBERRY
1130	HACKBERRY	10	3041	HACKBERRY
1131	HACKBERRY	10	3042	HACKBERRY
1132	HACKBERRY	12	3043	HACKBERRY
1226	HACKBERRY	10.5	3044	HACKBERRY
1318	HACKBERRY	14	3050	HACKBERRY
1319	HACKBERRY	15	3051	HACKBERRY
1320	HACKBERRY	11	3052	HACKBERRY
1321	HACKBERRY	11.5	3054	HACKBERRY
1322	HACKBERRY	19	3083	HACKBERRY
1323	HACKBERRY	14.5	3084	HACKBERRY
1324	HACKBERRY	11	3135	PECAN
1345	HACKBERRY	10.5	3236	PECAN
1346	HACKBERRY	12.5	3138	HACKBERRY
1347	HACKBERRY	14	3139	PECAN
1348	HACKBERRY	13.5	3141	PECAN
1349	HACKBERRY	13	3142	HACKBERRY
1350	HACKBERRY	10.5	3143	HACKBERRY
1351	HACKBERRY	13.5	3145	HACKBERRY
1352	HACKBERRY	17	3146	HACKBERRY
1354	HACKBERRY	18.5	3148	HACKBERRY
1355	HACKBERRY	15	3149	HACKBERRY
1356	HACKBERRY	17	3150	HACKBERRY
1392	HACKBERRY	12.5	3151	PECAN
1393	HACKBERRY	10	3152	PECAN
1394	HACKBERRY	11	3153	PECAN
1395	HACKBERRY	10	3154	HACKBERRY
1396	LIVE OAK	9	3155	HACKBERRY
1397	LIVE OAK	18	3157	PECAN
1398	LIVE OAK	19.5	3163	HACKBERRY
1399	LIVE OAK	17.5	3164	HACKBERRY
1400	LIVE OAK	17	3166	PECAN
1401	LIVE OAK	15	3167	PECAN
1402	LIVE OAK	18	3170	PECAN
1403	LIVE OAK	18	3174	HACKBERRY
1404	LIVE OAK	8.5	3175	HACKBERRY
1405	LIVE OAK	9	3177	HACKBERRY
1406	LIVE OAK	6	3181	LIVE OAK
1407	LIVE OAK	8	3183	PECAN
1408	LIVE OAK	12.5	3184	PECAN
1409	LIVE OAK	9.5	3185	PECAN
1410	LIVE OAK	22.5	3190	LIVE OAK
1430	LIVE OAK	13.5	3205	HACKBERRY
1432	LIVE OAK	9	3206	HACKBERRY
1433	LIVE OAK	18.5	3968	HACKBERRY
1434	LIVE OAK	21.5	3970	HACKBERRY
1435	LIVE OAK	22	3971	HACKBERRY
1436	LIVE OAK	17	3972	PECAN
1437	LIVE OAK	21	3973	HACKBERRY
1440	LIVE OAK	21	3974	HACKBERRY
1460	HACKBERRY	10	3975	HACKBERRY
1461	HACKBERRY	10.5	3976	HACKBERRY
1462	HACKBERRY	10	3977	HACKBERRY
1463	HACKBERRY	13.5	3978	HACKBERRY
1464	HACKBERRY	10.5	3979	HACKBERRY
1465	HACKBERRY	10	3980	HACKBERRY
1466	HACKBERRY	11	3981	HACKBERRY
1467	HACKBERRY	11.5	3982	MESQUITE
1468	HACKBERRY	13	3983	HACKBERRY
1472	HACKBERRY	10.5	3984	HACKBERRY
1473	HACKBERRY	10.5	3986	GUM GUMELIA
1474	HACKBERRY	10.5	3987	HACKBERRY
1475	HACKBERRY	11	3988	HACKBERRY
1476	MESQUITE	10.5	3994	HACKBERRY
1477	HACKBERRY	10	3995	HACKBERRY
1478	HACKBERRY	11	3996	HACKBERRY
1479	HACKBERRY	10.5	3997	HACKBERRY
1480	HACKBERRY	14	3998	MESQUITE
1481	HACKBERRY	11	3999	HACKBERRY
1487	HACKBERRY	12	4000	HACKBERRY

EXEMPT SIGNIFICANT TREES (RESIDENTIAL)				
TAG#	SPECIES	SIZE (IN.)	TAG#	SPECIES
1075	HACKBERRY	13	1459	HACKBERRY
*1076	HUISACHE	11	1460	HACKBERRY
*1077	HUISACHE	11	1470	HACKBERRY
1079	MESQUITE	11	*1471	HACKBERRY
1080	MESQUITE	12	1483	HACKBERRY
1081	MESQUITE	13	1484	HACKBERRY
1082	MESQUITE	11	1485	HACKBERRY
*1085	MESQUITE	13	1486	HACKBERRY
1087	MESQUITE	13	1489	HACKBERRY
1088	MESQUITE	11	1490	HACKBERRY
1089	MESQUITE	12	1491	HACKBERRY
*1090	HUISACHE	10	1492	HACKBERRY
*1091	HUISACHE	11	1493	HACKBERRY
*1092	HACKBERRY	20	1494	HACKBERRY
*1093	MESQUITE	18	1495	HACKBERRY
*1099	HACKBERRY	18.5	1496	HACKBERRY
*1104	MESQUITE	11	1497	MESQUITE
1108	HACKBERRY	10	*1498	HACKBERRY
*1111	MESQUITE	11	*3001	HACKBERRY
1130	HACKBERRY	10	3002	HACKBERRY
*1133	MESQUITE	18	3003	HACKBERRY
*1134	HACKBERRY	12.5	3004	HACKBERRY
1135	HACKBERRY	15.5	3005	HACKBERRY
*1136	HACKBERRY	13	3006	HACKBERRY
1137	HACKBERRY	13.5	3015	HACKBERRY
*1138	HACKBERRY	17	3017	HACKBERRY
*1141	HUISACHE	13	3018	HACKBERRY
*1142	HUISACHE	10	3035	HACKBERRY
*1143	MESQUITE	11	3036	HACKBERRY
*1144	HACKBERRY	14	3037	HACKBERRY
*1145	HUISACHE	10	*3038	MESQUITE
*1325	HACKBERRY	13.5	3039	HACKBERRY
1326	HACKBERRY	15.5	*3045	HACKBERRY
1327	HACKBERRY	13	3046	HACKBERRY
1328	HACKBERRY	10.5	3047	HACKBERRY
1329	HACKBERRY	10	3048	HACKBERRY
1330	HACKBERRY	14	3049	HACKBERRY
1331	HACKBERRY	13	*3053	MESQUITE
1332	HACKBERRY	19	*3055	HACKBERRY
1333	HACKBERRY	11	3056	GUM BUMELIA
1334	HACKBERRY	12.5	3057	HACKBERRY
1335	HACKBERRY	15.5	*3059	MESQUITE
1336	HACKBERRY	13	*3060	HACKBERRY
1337	HACKBERRY	13.5	*3099	HACKBERRY
1338	HACKBERRY	10.5	3098	HACKBERRY
1339	HACKBERRY	10	*3105	HACKBERRY
1340	HACKBERRY	16	*3107	HACKBERRY
1341	HACKBERRY	12	*3111	PECAN
1342	HACKBERRY	10.5	*3113	HACKBERRY
1343	HACKBERRY	10	*3114	HACKBERRY
1344	HACKBERRY	10	*3115	HACKBERRY
1345	LIVE OAK	18	*3116	HACKBERRY
*1367	LIVE OAK	22	*3117	HACKBERRY
1369	LIVE OAK	23	*3118	HACKBERRY
1371	HACKBERRY	10	*3126	HACKBERRY
1372	HACKBERRY	10	*3156	PECAN
1373	LIVE OAK	18.5	*3161	LIVE OAK
*1377	LIVE OAK	15.5	*3165	HACKBERRY
*1378	PECAN	17.5	*3168	HACKBERRY
LIVE OAK	13	15	*3171	HACKBERRY
1391	HACKBERRY	15	*3172	HACKBERRY
*1413	LIVE OAK	18	*3176	HACKBERRY
1416	LIVE OAK	14.5	3186	PECAN
1417	LIVE OAK	15	*3967	MESQUITE
1418	LIVE OAK	8	*3985	MESQUITE
1419	LIVE OAK	21	3989	HACKBERRY
1420	LIVE OAK	9.5	3990	HACKBERRY
*1429	LIVE OAK	6	3991	HACKBERRY
1443	LIVE OAK	21.5	3992	HACKBERRY
*1444	LIVE OAK	13.5	3993	HACKBERRY
*1446	HACKBERRY	18	*5002	MESQUITE
			*5024	MESQUITE

SIGNIFICANT TREES TO BE SAVED (RESIDENTIAL)				
TAG#	SPECIES	SIZE (IN.)	TAG#	SPECIES
1101	HACKBERRY	23	3119	HACKBERRY
1102	HACKBERRY	10	3120	HACKBERRY
1103	HACKBERRY	10.5	3122	HACKBERRY
1105	HACKBERRY	12	3123	HACKBERRY
1139	HACKBERRY	10.5	3124	HACKBERRY
1140	HACKBERRY	11	3125	HACKBERRY
1376	LIVE OAK	18.5	3127	HACKBERRY
3061	HACKBERRY	10	3128	GUM BUMELIA
3062	HACKBERRY	21	3129	HACKBERRY
3063	HACKBERRY	15	3133	PECAN
3064	HACKBERRY	15	3134	PECAN
3065	HACKBERRY	11	3144	HACKBERRY
3066	HACKBERRY	10.5	3202	LIVE OAK
3090	HACKBERRY	12.5	3213	HACKBERRY
3097	HACKBERRY	11.5	3214	HACKBERRY
3098	HACKBERRY	12.5	3216	HACKBERRY
3101	HACKBERRY	16.5	3249	HACKBERRY
3103	HACKBERRY	15	3250	HACKBERRY
3106	HACKBERRY	10	3965	HACKBERRY
3110	HACKBERRY	10.5	3966	MESQUITE
3112	HACKBERRY	17	1439	LIVE OAK

HERITAGE TREES TO BE REMOVED (RESIDENTIAL)		
TAG#	SPECIES	SIZE (IN.)
1353	HACKBERRY	28
1359	LIVE OAK	32
1360	LIVE OAK	35
1361	LIVE OAK	38
1362	LIVE OAK	46
1363	LIVE OAK	30
1438	LIVE OAK	24.5
3100	LIVE OAK	63
3137	PECAN	25.5
3147	LIVE OAK	69.5
3159	LIVE OAK	50.5
3160	LIVE OAK	50
3169	MESQUITE	26
3178	LIVE OAK	38.5
3180	LIVE OAK	37
3182	LIVE OAK	50
3188	LIVE OAK	39
3189	LIVE OAK	42
3191	LIVE OAK	38
3192	LIVE OAK	43
3193	LIVE OAK	55
3194	LIVE OAK	51.5
3195	LIVE OAK	39.5
3197	LIVE OAK	25
3198	LIVE OAK	34.5
3199	LIVE OAK	25.5
3203	LIVE OAK	30
3969	HACKBERRY	35

HERITAGE TREES TO BE SAVED (NON-RESIDENTIAL)		
TAG#	SPECIES	SIZE (IN.)
3235	LIVE OAK	67.5
3236	LIVE OAK	60.5
3239	LIVE OAK	53.5
3240	LIVE OAK	47.5
3241	LIVE OAK	51
3243	LIVE OAK	33
3244	LIVE OAK	39.5
3246	LIVE OAK	51
3248	LIVE OAK	44
3255	LIVE OAK	61.5
3256	LIVE OAK	49.5
3257	LIVE OAK	36.5
3259	LIVE OAK	39
3261	LIVE OAK	44
3264	LIVE OAK	39.5
3265	LIVE OAK	39
3266	LIVE OAK	29.5
3267	LIVE OAK	29
3269	LIVE OAK	32.5
3270	LIVE OAK	25.5
3271	LIVE OAK	29.5
3272	LIVE OAK	32.5
3274	LIVE OAK	34
3275	LIVE OAK	39
3276	LIVE OAK	28
3277	LIVE OAK	39.5
3278	LIVE OAK	25.5
3279	LIVE OAK	38.5

HERITAGE TREES TO BE REMOVED (BUFFER ZONE)		
TAG#	SPECIES	SIZE (IN.)
5027	LIVE OAK	32
5028	LIVE OAK	38.5

HERITAGE TREES NOT ON PROPERTY		
TAG#	SPECIES	SIZE (IN.)
*5025	LIVE OAK	44
5030	LIVE OAK	45.5

HERITAGE TREES TO BE SAVED (RESIDENTIAL)		
TAG#	SPECIES	SIZE (IN.)
3083	HACKBERRY	25.5
3096	LIVE OAK	45
3104	LIVE OAK	53
3108	LIVE OAK	50
3109	LIVE OAK	41.5
3121	LIVE OAK	55.5
3158	LIVE OAK	37
3200	LIVE OAK	48.5
3201	LIVE OAK	31.5
3204	LIVE OAK	40.5
3207	LIVE OAK	67
3208	LIVE OAK	78.5
3211	LIVE OAK	68
3212	LIVE OAK	59.5
3217	LIVE OAK	56.5
3218	LIVE OAK	57.5
3219	LIVE OAK	41.5
3220	LIVE OAK	42
3221	LIVE OAK	66
3222	LIVE OAK	46.5
3223	LIVE OAK	62
3225	LIVE OAK	43
3226	LIVE OAK	37.5
3227	LIVE OAK	51.5
3228	LIVE OAK	49
3229	LIVE OAK	27.5
3230	LIVE OAK	28.5
3231	LIVE OAK	43.5
3232	LIVE OAK	52
3233	LIVE OAK	39
3234	LIVE OAK	51.5
3262	LIVE OAK	39
3280	LIVE OAK	50.5
3281	LIVE OAK	48.5
3282	LIVE OAK	39
3283	LIVE OAK	63.5
3284	LIVE OAK	32
3285	LIVE OAK	52.5
3287	LIVE OAK	40
3284	LIVE OAK	74.5
5031	LIVE OAK	35.5