



TREE CANOPY ORDINANCE COMPLIANCE

PROJECT SITE AREA:	418,437 SF
x 25% = TOTAL TREE CANOPY REQUIRED	104,609 SF
100% CREDIT TREES PRESERVED (SF)	5,250 SF
(6) LIVE OAKS	
TREE CANOPY REMAINING	99,359 SF

REMAINING TREE CANOPY REQUIRED:

DIVIDED BY 788 SF PER TREE = TOTAL TREES REQUIRED:	126
x 1.5 CAL. INCH PER TREE = TOTAL MITIGATION DUE:	189 CAL. INCH
@ \$200 PER CAL. INCH = PAYMENT DUE TO CITY TREE FUND:	\$37,827

TREE MITIGATION SUMMARY

MITIGATION REQUIRED PER TREE INVENTORY:	209 Cal.Inches
-----------------------------------------	----------------

NET MITIGATION REQUIRED:

x \$200 per Cal. Inch:	\$41,800 Due to City Tree Mitigation Fund
------------------------	-------------------------------------------

EXISTING TREE PRESERVATION AND REMOVAL NOTES:

- UNLESS OTHERWISE SPECIFICALLY INDICATED, THIS DOCUMENT SHOWS ONLY EXISTING PROTECTED-SIZE TREES AS DEFINED BY THE CITY OF SAN ANTONIO UNIFIED DEVELOPMENT CODE (THE "UDC") IN EFFECT ON THE DATE HEREOF.
- CONTRACTOR IS SOLELY RESPONSIBLE FOR INSPECTING THE PROJECT SITE AND DETERMINING FOR HIMSELF IF OTHER EXISTING TREES, SHRUBS, OR VEGETATION ARE PRESENT WHICH MUST BE REMOVED IN ORDER TO CONSTRUCT THE IMPROVEMENTS PROPOSED HEREBY.
- BY ACT OF SUBMITTING A BID TO REMOVE THE EXISTING TREES SHOWN ON THIS PLAN, CONTRACTOR WARRANTS THAT HE (A) HAS PERSONALLY VISITED THE PROJECT SITE, (B) HAS INVESTIGATED THE EXISTING CONDITIONS SUFFICIENTLY TO DETERMINE WHAT, IF ANY, ADDITIONAL EXISTING TREES, SHRUBS, AND VEGETATION MUST BE REMOVED IN ORDER TO CONSTRUCT THE IMPROVEMENTS PROPOSED HEREBY, AND (C) HAS A CLEAR UNDERSTANDING OF THE TERMS "PROTECTED TREE, SIGNIFICANT TREE, HERITAGE TREE, AND FLOOD PLAIN, AND OF ANY OTHER CITY GUIDELINES, STANDARDS, AND REQUIREMENTS WHICH MAY IMPACT REMOVAL OF THE EXISTING TREES DEPICTED ON THIS PLAN.
- IN THE EVENT CONTRACTOR ENCOUNTERS ADDITIONAL EXISTING TREES, SHRUBS, AND VEGETATION NOT SHOWN ON THIS PLAN, BUT WHICH MUST REASONABLY BE REMOVED IN ORDER TO CONSTRUCT THE IMPROVEMENTS PROPOSED HEREBY, CONTRACTOR SHALL REMOVE THE ADDITIONAL EXISTING TREES, SHRUBS, AND VEGETATION AT NO ADDITIONAL COST TO THE OWNER, SUBJECT TO ANY APPLICABLE REQUIREMENTS, GUIDELINES, STIPULATIONS, OR APPROVALS ENFORCED BY THE CITY OF SAN ANTONIO.
- ALL NEW TREES SHALL BE PLANTED IN SOIL THAT IS SUITABLE FOR ESTABLISHING AND SUSTAINING THE PLANTINGS. IN ADDITION TO CONTAINING SUITABLE PARTICLE SIZE AND DEPTH OF SOIL ZONE, THE SOIL MUST CONTAIN SUFFICIENT ORGANIC MATTER AND NUTRIENTS. TESTING AND CONFIRMATION BY A LANDSCAPE ARCHITECT OR A TEXAS LICENSED SOIL TESTING LAB SHALL BE COMPLETED TO ENSURE THE SUITS ARE SUITABLE. IN LIEU OF CONFIRMATION BY A LANDSCAPE ARCHITECT OR A TEXAS LICENSED SOIL TESTING LAB, AMEND SOIL WITH COMPOST BY ADDING 3" OF COMPOST BLENDED INTO EVERY ONE (1) FOOT OF SOIL DEPTH. FOR COMPLETE SOIL REPLACEMENT, ADD COMPOST TO SOIL AT A RATIO OF 25% COMPOST TO 75% NATIVE SOIL.

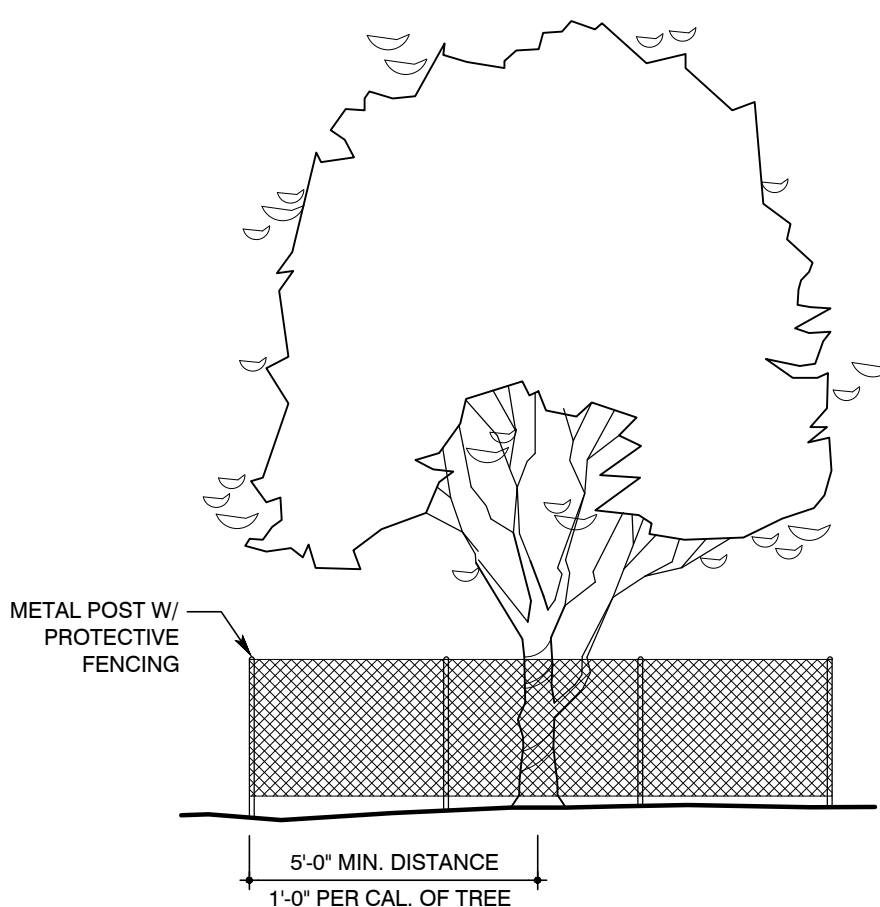

TREE PROTECTION DETAIL

NOT TO SCALE

PRUNING NOTES:

- ALL PRUNING IS TO BE DONE BY A LICENSED ARBORIST UNDER THE FIELD DIRECTION OF THE OWNER AND/OR LANDSCAPE ARCHITECT.
- WHERE FEASIBLE, PRUNE TREES BEFORE COMMENCEMENT OF CONSTRUCTION.
- PAIN

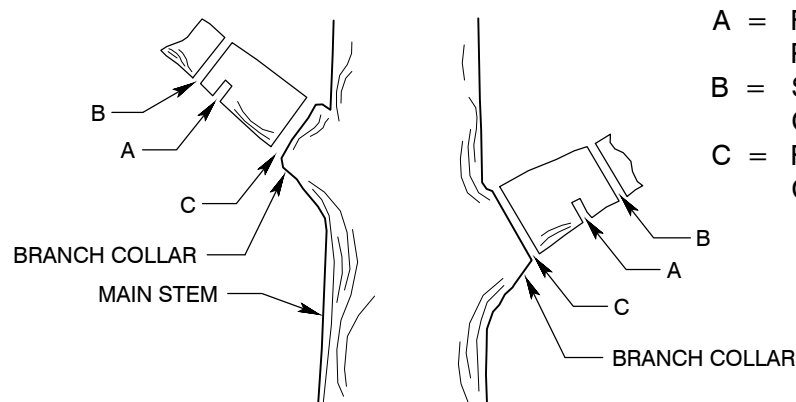

TREE PRUNING DETAIL

NOT TO SCALE

NOTES:

- LANDSCAPE SUBCONTRACTOR TO PROVIDE PRUNING AND FERTILIZATION FOR ALL EXISTING TREES TO BE PRESERVED BY A CITY OF SAN ANTONIO TREE MAINTENANCE LICENSED AND I.S.A CERTIFIED ARBORIST.
- APPLY APPROVED SLOW-RELEASE FERTILIZER INJECTED INTO SOIL BEFORE CONSTRUCTION COMMENCES AND AGAIN AFTER CONSTRUCTION IS COMPLETE.
- ALL PRUNING OF EXISTING TREES MUST COMPLY WITH THE CITY OF SAN ANTONIO'S APPROVED PRUNING DETAIL AND IS TO BE DONE UNDER THE FIELD DIRECTION OF THE OWNER AND/OR LANDSCAPE ARCHITECT.
- PROTECTIVE FENCING MUST BE IN PLACE BEFORE ANY CONSTRUCTION ACTIVITIES MAY COMMENCE.
- PROTECTIVE FENCING TO BE A MIN. 4'-0" HT. EXTENDING FROM TRUNK 12" PER CALIPER INCH OF TREE (MINIMUM 5'-0" ON ONE SIDE ONLY). THE OPTIMUM DISTANCE IS TO INSTALL FENCE DIRECTLY BENEATH DRIPLINE OF TREE AS SHOWN.
- PROTECTIVE FENCING TO BE STAKED IN FIELD BY CONTRACTOR AND APPROVED BY OWNER AND/OR LANDSCAPE ARCHITECT.
- DURING CONSTRUCTION, NO EXCESS SOIL, FILL MATERIAL, EQUIPMENT, LIQUIDS, OR CONSTRUCTION DEBRIS SHALL BE PLACED WITHIN THE PROTECTIVE FENCING, NOR SHALL ANY SOIL BE REMOVED FROM WITHIN THE FENCING.
- APPLY COARSE GROUND OR SHREDDED ORGANIC BARK MULCH TO 6" DEPTH @ ALL EXISTING TREES TO BE PRESERVED.
- THE PROPOSED FINISH GRADE WITHIN THE ROOT PROTECTION ZONE ("RPZ") OF ANY TREE TO BE PRESERVED SHALL NOT BE RAISED OR LOWERED MORE THAN THREE (3) INCHES.

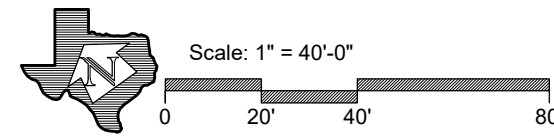
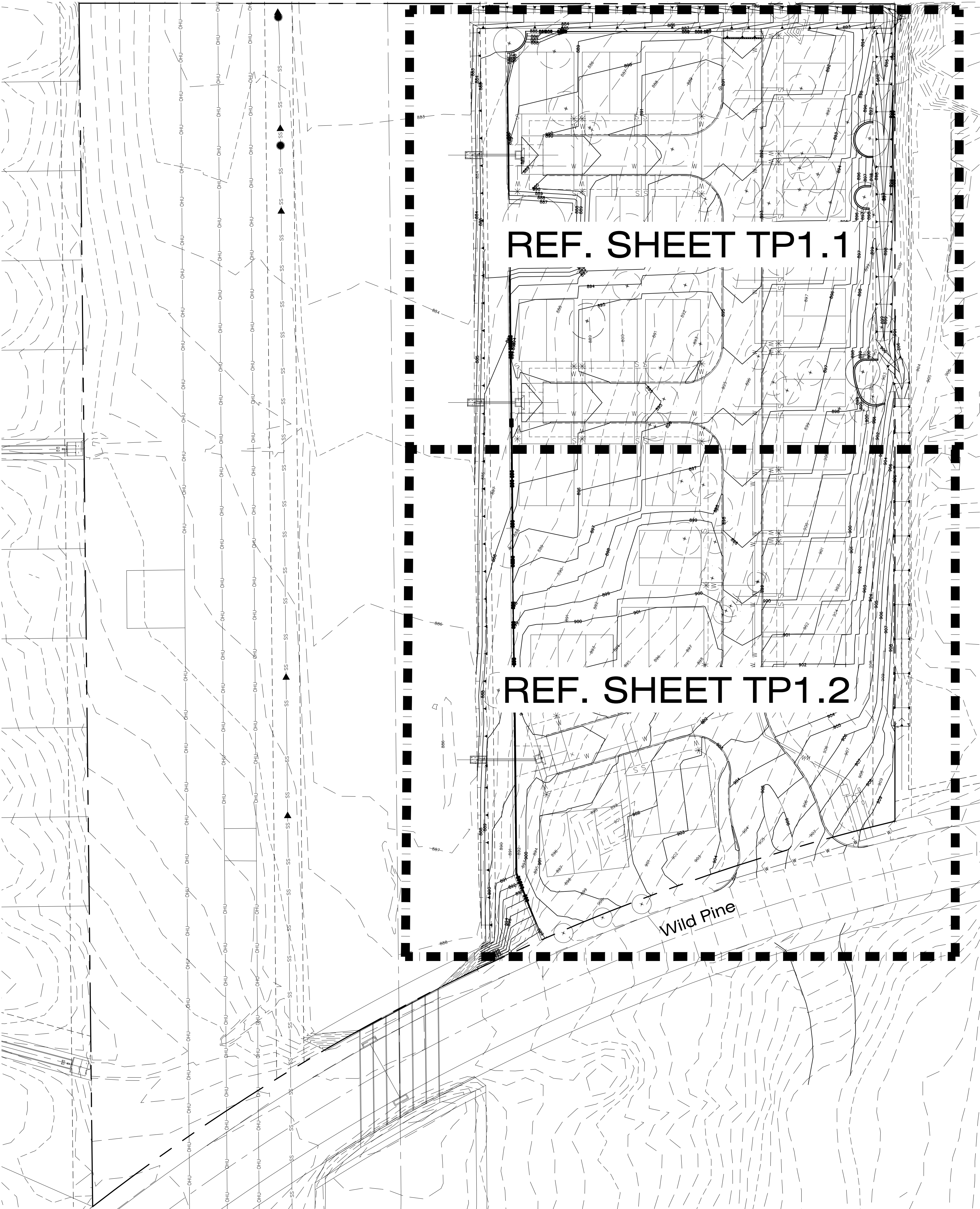

H O R I Z O N

DESIGN AND DEVELOPMENT

PLANNING LANDSCAPE ARCHITECTURE

DEVELOPMENT CONSULTING

16414 San Pedro Ave., Suite 630
San Antonio, Texas 78232
210.233.9650 jrobinson@horizondesign-sa.com

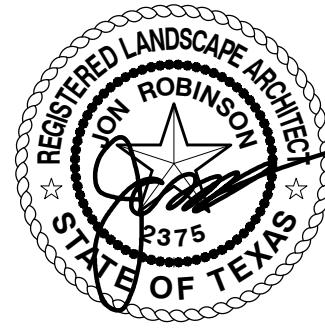

82125

The user of this file agrees to assume all responsibility for any modifications to or use of this drawing file that is inconsistent with the requirements of the Rules and Regulations of the Texas Board of Architectural Examiners. No person may make any modifications to this electronic drawing file without the Landscape Architect's express written permission.

OWNER

Clay Schlinke
Invest 5S LLC

7623 Lost Creek Gap
Boerne TX 78015

PROJECT

Wild Pine

Wild Pine
San Antonio TX 78253

REVISIONS

PROJECT NUMBER

2025-035

Drawn By: nj

Checked By: jr

Sheet Title:

**OVERALL TREE
PRESERVATION
PLAN**

Sheet Number:

TP1.0

Issue Date:

August 21, 2025

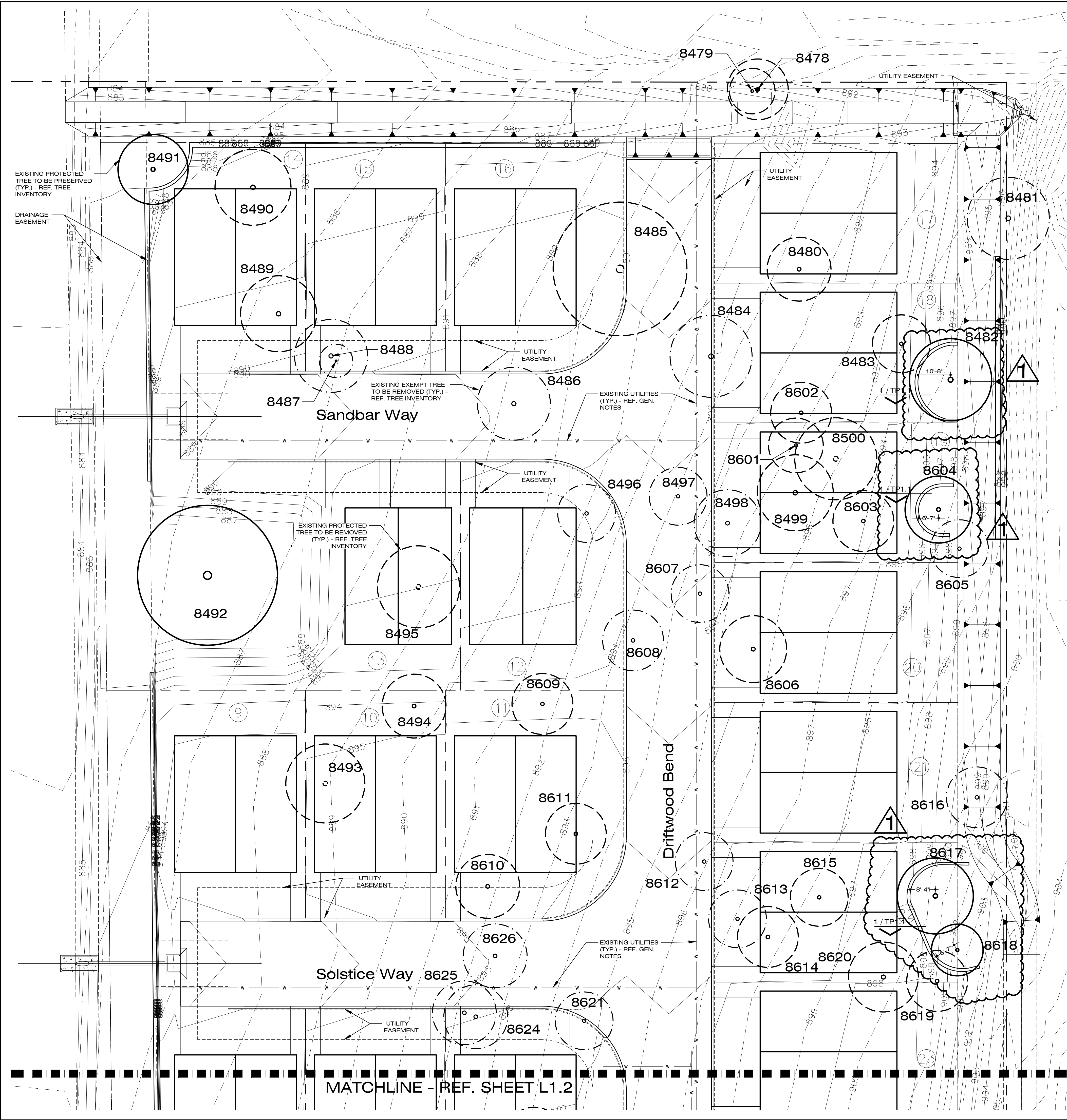

EXISTING TREE LEGEND

- 007 = EXISTING PROTECTED TREE TO BE PRESERVED
- 007 = EXISTING PROTECTED TREE TO BE REMOVED
- 007 = EXISTING EXEMPT TREE TO BE PRESERVED
- 007 = EXISTING EXEMPT TREE TO BE REMOVED
- 007 = EXISTING OFF-SITE TREE

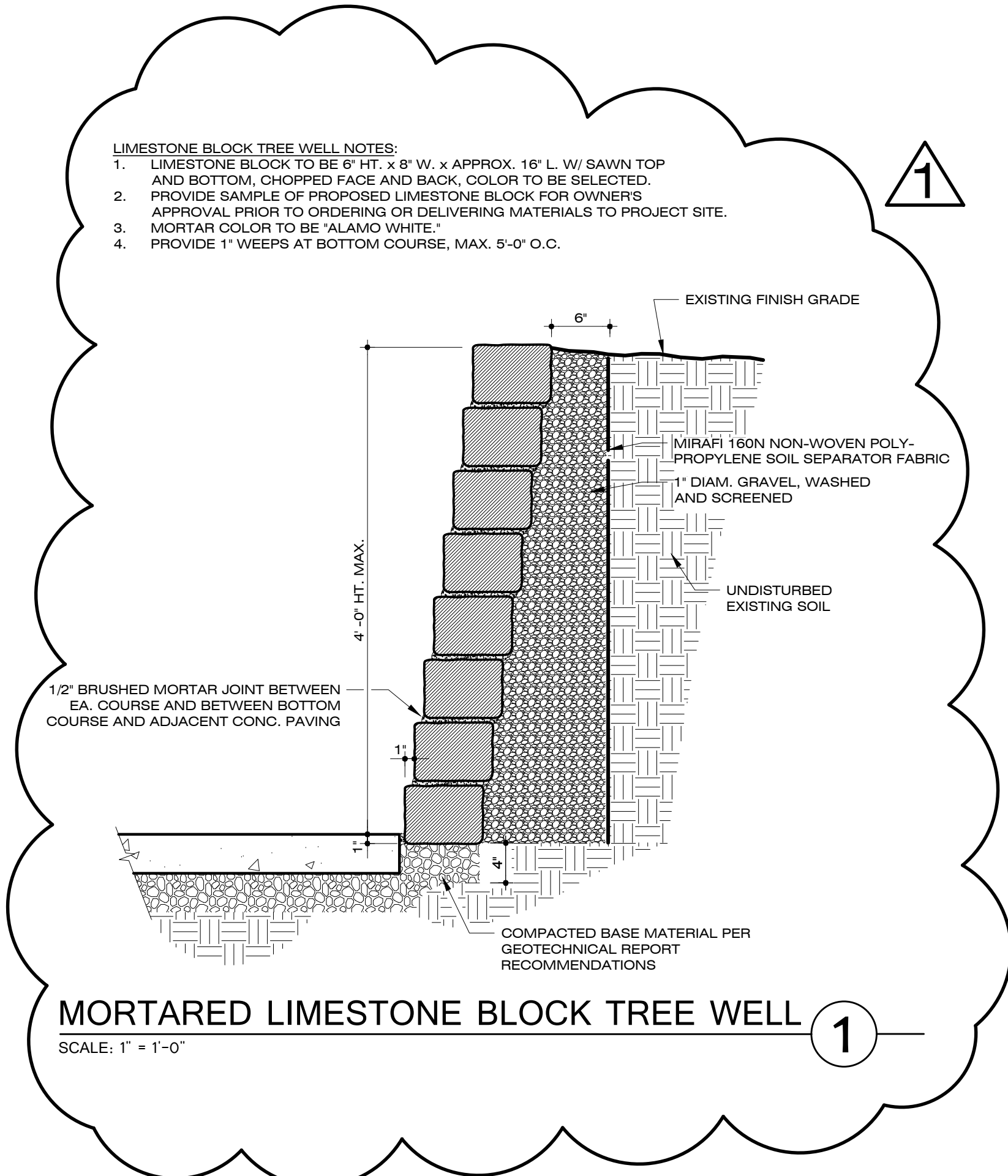

TREE WELL MUST BE CONSTRUCTED PRIOR TO ANY GRADING OR SITE WORK AROUND TREE #8482, #8604, #8617 AND #8618

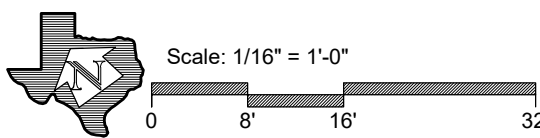

H O R I Z O N
DESIGN AND DEVELOPMENT
PLANNING, LANDSCAPE ARCHITECTURE
DEVELOPMENT CONSULTING
16414 San Pedro Ave., Suite 630
San Antonio, Texas 78232
210.233.9650 jrobinson@horizondesign-sa.com

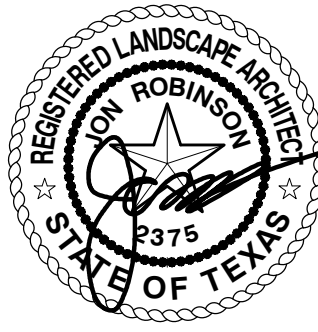

The user of this file agrees to assume all responsibility for any modifications to or use of this drawing file that is inconsistent with the requirements of the Rules and Regulations of the Texas Board of Architectural Examiners. No person may make any modifications to this electronic drawing file without the Landscape Architect's express written permission.

OWNER
Clay Schlinke
Invest 5S LLC

7623 Lost Creek Gap
Boerne TX 78015

PROJECT
Wild Pine

Wild Pine
San Antonio TX 78253

REVISIONS
1. City Comments 10/31/25

PROJECT NUMBER
2025-035

Drawn By: nj
Checked By: jr

Sheet Title:
**ENLARGED TREE
PRESERVATION
PLAN**

Sheet Number:

TP1.1

Issue Date:

August 21, 2025

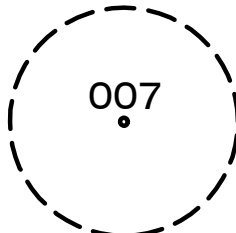
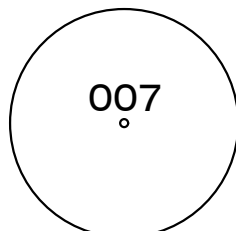
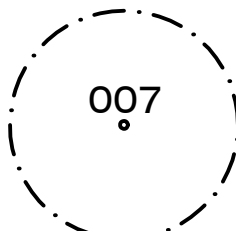
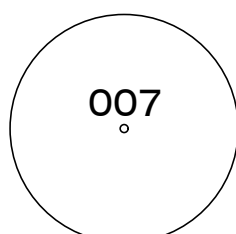

EXISTING TREE LEGEND

-  = EXISTING PROTECTED TREE TO BE PRESERVED
-  = EXISTING PROTECTED TREE TO BE REMOVED
-  = EXISTING EXEMPT TREE TO BE PRESERVED
-  = EXISTING EXEMPT TREE TO BE REMOVED
-  = EXISTING OFF-SITE TREE

H O R I Z O N
DESIGN AND DEVELOPMENT

PLANNING LANDSCAPE ARCHITECTURE
DEVELOPMENT CONSULTING
16414 San Pedro Ave., Suite 630
San Antonio, Texas 78232
210.233.9650 jrobinson@horizondesign-sa.com



The user of this file agrees to assume all responsibility for any modifications to or use of this drawing file that is inconsistent with the requirements of the Rules and Regulations of the Texas Board of Architectural Examiners. No person may make any modifications to this electronic drawing file without the Landscape Architect's express written permission.

OWNER
**Clay Schlinke
Invest 5S LLC**

7623 Lost Creek Gap
Boerne TX 78015

PROJECT
Wild Pine

Wild Pine
San Antonio TX 78253

REVISIONS

PROJECT NUMBER
2025-035

Drawn By: nj
Checked By: jr

Sheet Title:
**ENLARGED TREE
PRESERVATION
PLAN**

Sheet Number:

TP1.2

Issue Date:

August 21, 2025

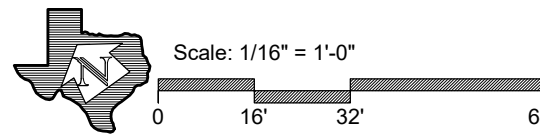

EXISTING PROTECTED TREE INVENTORY

August 21, 2025

			L A R G E S P E C I E S			S M A L L S P E C I E S			P R O T E C T E D				
TAG #	SPECIES	SIZE	SIGNIFICANT	SIGNIFICANT	HERITAGE	HERITAGE	HERITAGE	SIGNIFICANT	SIGNIFICANT	HERITAGE	HERITAGE	CAL. INCHES	COMMENTS
			PRESERVED	REMOVED	PRESERVED	REMOVED (3:1)	REMOVED (1:1)	PRESERVED	REMOVED	PRESERVED	REMOVED	EXEMPT	
8478	CEDAR ELM	12										12	Easement; Removed
8479	LIVE OAK	8										8	Easement; Removed
8480	LIVE OAK	14		14									
8481	LIVE OAK	20										20	Easement; Removed
8482	LIVE OAK	19	19										
8483	LIVE OAK	12		12									
8484	LIVE OAK	19										19	Easement; Removed
8485	LIVE OAK	37				37							
8486	LIVE OAK	16										16	Easement; Removed
8487	PERSIMMON	5										5	Easement; Removed
8488	LIVE OAK	16										16	Easement; Removed
8489	LIVE OAK	15		15									
8490	LIVE OAK	18		18									
8491	LIVE OAK	15	15										
8492	LIVE OAK	39			39								
8493	LIVE OAK	18		18									
8494	LIVE OAK	14		14									
8495	LIVE OAK	19		19									
8496	LIVE OAK	12										12	Easement; Removed
8497	LIVE OAK	11		11									
8498	LIVE OAK	15		15									
8499	ASHE JUNIPER	17		17									
8500	LIVE OAK	19		19									
8601	LIVE OAK	11		11									
8602	LIVE OAK	13		13									
8603	LIVE OAK	13		13									
8604	LIVE OAK	14	14										
8605	LIVE OAK	12										12	Easement; Removed
8606	LIVE OAK	14		14									
8607	LIVE OAK	12										12	Easement; Removed
8608	LIVE OAK	13										13	Easement; Removed
8609	LIVE OAK	13		13									
8610	LIVE OAK	14		14									
8611	LIVE OAK	11		11									
8612	LIVE OAK	11										11	Easement; Removed
8613	LIVE OAK	11										11	Easement; Removed
8614	LIVE OAK	13		13									
8615	LIVE OAK	11		11									
8616	LIVE OAK	13										13	Easement; Removed
8617	LIVE OAK	16	16										
8618	LIVE OAK	9	9										
8619	LIVE OAK	13		13									
8620	LIVE OAK	15		15									
8621	LIVE OAK	11										11	Easement; Removed
8622	LIVE OAK	13		13									
8623	LIVE OAK	12		12									
8624	LIVE OAK	13										13	Easement; Removed
8625	LIVE OAK	14										14	Easement; Removed
8626	LIVE OAK	13										13	Easement; Removed
8627	CEDAR ELM	21										21	Easement; Removed
8628	LIVE OAK	18										18	Easement; Removed
8629	CEDAR ELM	16		16									
8630	LIVE OAK	9										9	Easement; Removed
8631	LIVE OAK	9										9	Easement; Removed
8632	CEDAR ELM	10										10	Easement; Removed
8633	LIVE OAK	6										6	Easement; Removed
8634	CEDAR ELM	9										9	Easement; Removed
8635	LIVE OAK	8										8	Easement; Removed
8636	LIVE OAK	9										9	Easement; Removed
8637	CEDAR ELM	7										7	Easement; Removed
8638	DECIDUOUS	5										5	Easement; Removed
8639	CEDAR ELM	7										7	Offsite; Preserved
8640	CEDAR ELM	6										6	Offsite; Preserved
8641	CEDAR ELM	7										7	Offsite; Preserved
TOTALS		865	73	354	39	37	0	0	0	0	0	362	

TREE PRESERVATION SUMMARY	
TOTAL CAL. INCHES ON-SITE:	865
SIGNIFICANT CAL. INCHES ON-SITE:	427
Required Significant Preservation Ratio:	40%
Total Large Species Significant Cal. Inches:	427.0
Large Species Significant Cal. Inches Preserved:	73.0
Large Species Significant Class Preservation Ratio:	17.10%
TOTAL LARGE SPECIES EXCESS / (MITIGATION)	(97.8)
Total Large Species Heritage Cal. Inches:	76
Large Species Heritage Cal. Inches Preserved:	39
Large Species Heritage Class Preservation Ratio:	51.32%
Heritage Class Excess / (Mitigation), 3:1	(111.0)
Heritage Class Excess / (Mitigation), 1:1	0.0
TOTAL LARGE HERITAGE SPECIES EXCESS / (MITIGATION)	(111.0)
Total Small Species Significant Cal. Inches:	0
Small Species Significant Cal. Inches Preserved:	0
Small Species Significant Class Preservation Ratio:	#DIV/0!
TOTAL SMALL SPECIES EXCESS / (MITIGATION)	0.0
Total Small Species Heritage Cal. Inches:	0
Small Species Heritage Cal. Inches Preserved:	0
Small Species Heritage Class Preservation Ratio:	#DIV/0!
TOTAL SMALL HERITAGE SPECIES EXCESS / (MITIGATION), 1:1	0.0
TOTAL EXCESS / (MITIGATION)	(209)

H O R I Z O N
DESIGN AND DEVELOPMENT
PLANNING LANDSCAPE ARCHITECTURE
DEVELOPMENT CONSULTING
16414 San Pedro Ave., Suite 630
San Antonio, Texas 78232
210.233.9650 jrobinson@horizondesign-sa.com



82125

The user of this file agrees to assume all responsibility for any modifications to or use of this drawing file that is inconsistent with the requirements of the Rules and Regulations of the Texas Board of Architectural Examiners. No person may make any modifications to this electronic drawing file without the Landscape Architect's express written permission.

OWNER

Clay Schlinke
Invest 5S LLC

7623 Lost Creek Gap
Boerne TX 78015

PROJECT

Wild Pine

Wild Pine
San Antonio TX 78253

REVISIONS

PROJECT NUMBER
2025-035

Drawn By: nj
Checked By: jr

Sheet Title:

TREE
INVENTORY

Sheet Number:

TP1.3

Issue Date:

August 21, 2025