

Date: Dec 05, 2023, 10:04am User ID: tomochio
File: P:\26\32\14\Design\Civil\DWG\263214.dwg

THIS DOCUMENT HAS BEEN PRODUCED FROM MATERIAL THAT WAS STORED AND/OR TRANSMITTED ELECTRONICALLY AND MAY HAVE BEEN INADVERTENTLY ALTERED. RELY ONLY ON FINAL HARDCOPY MATERIALS BEARING THE CONSULTANTS ORIGINAL SIGNATURE AND SEAL. AERIAL IMAGERY PROVIDED BY GOOGLE/UNLESS OTHERWISE NOTED. Imagery © 2016, CAPOCO, Digital Globe, Texas Orthometry Program, USA Farm Service Agency.

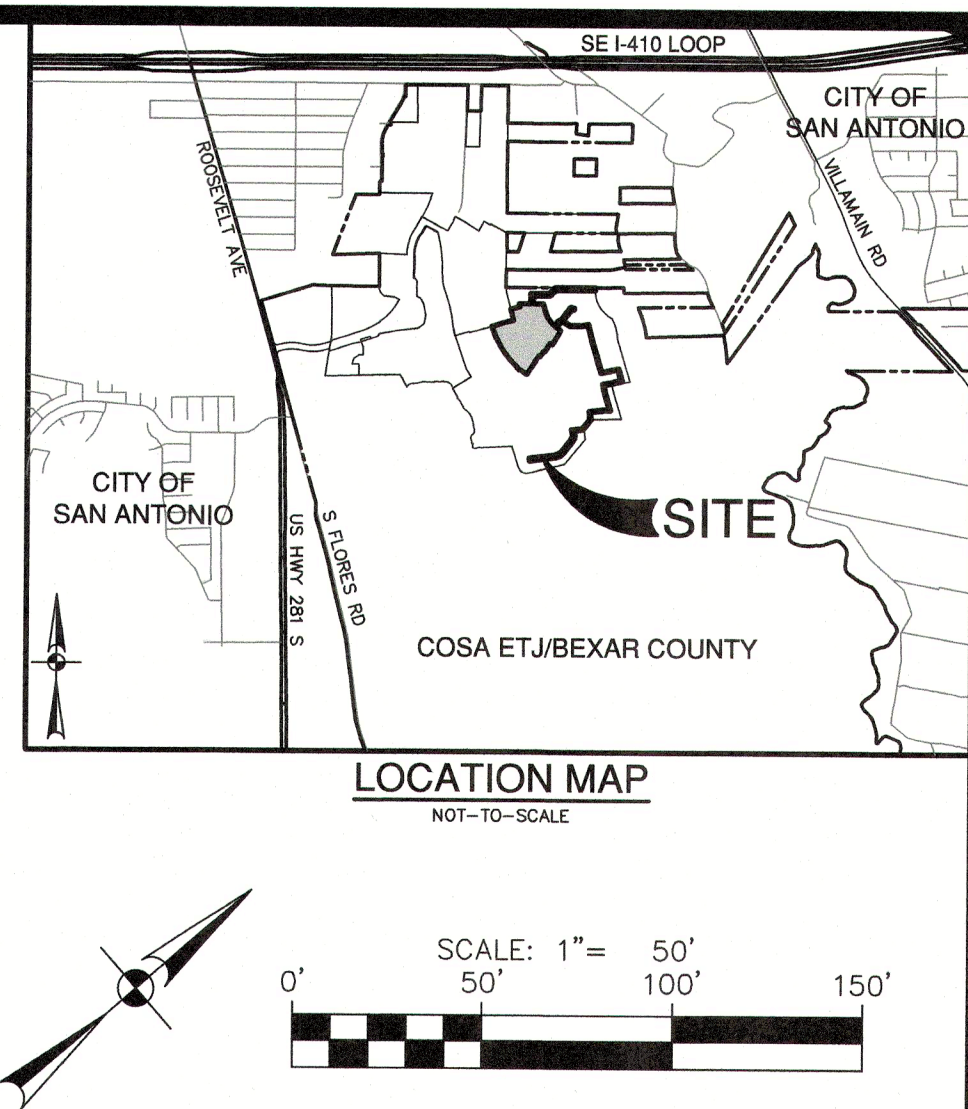

WATER LEGEND

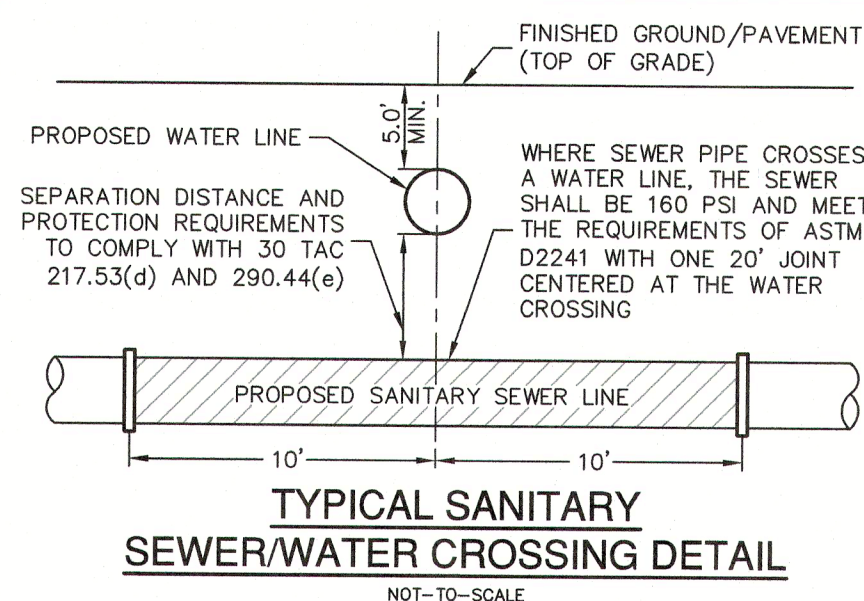
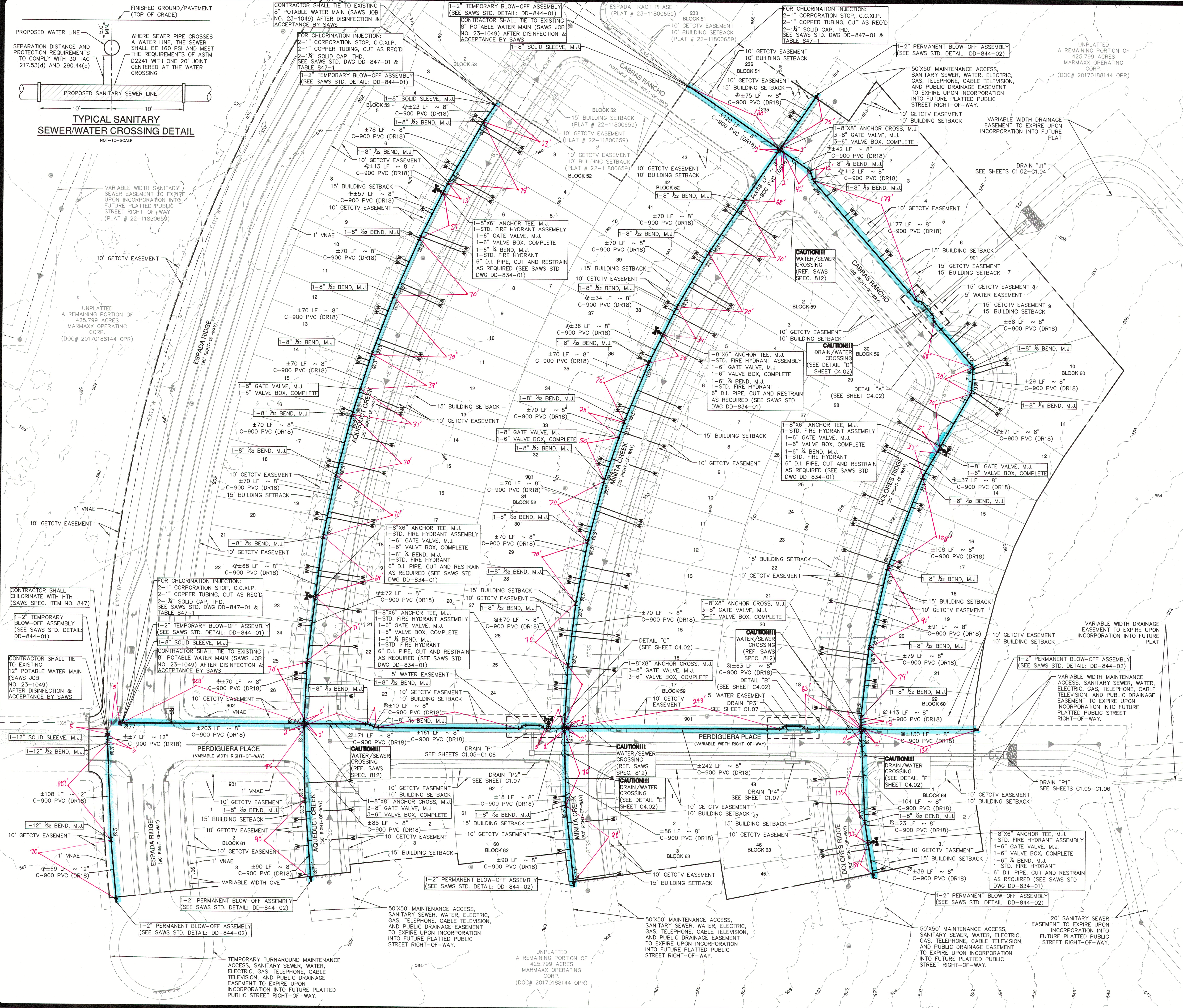
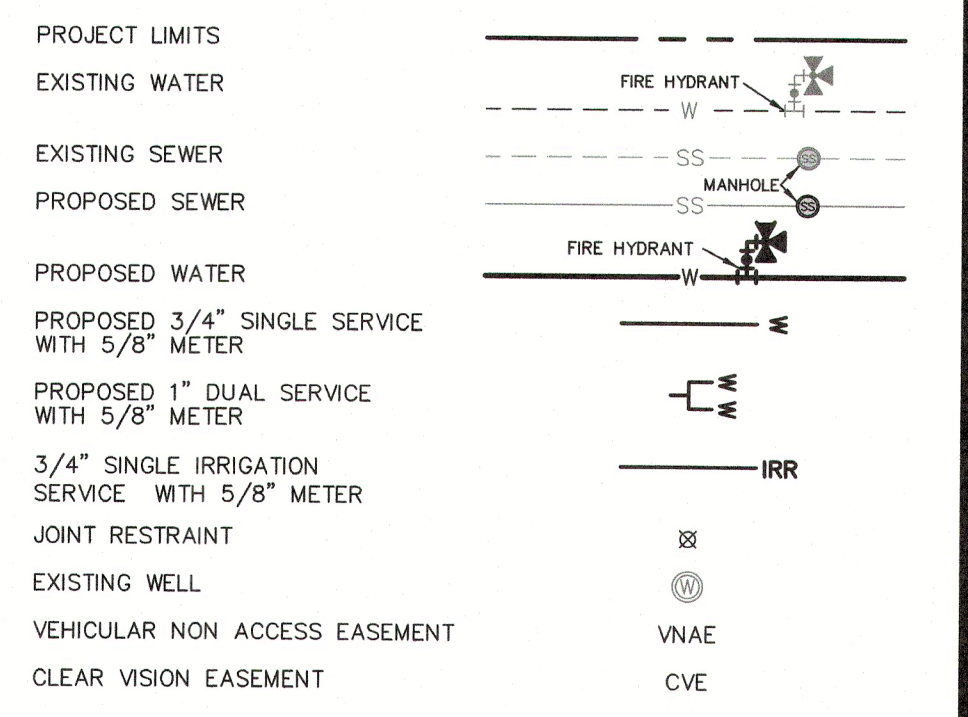

FIRE FLOW NOTE:

IN AN EFFORT TO MEET THE CITY OF SAN ANTONIO'S FIRE FLOW REQUIREMENTS FOR THE PROPOSED RESIDENTIAL DEVELOPMENT, THE PUBLIC WATER MAIN SYSTEM HAS BEEN DESIGNED FOR A MINIMUM FIRE FLOW DEMAND OF 1500 GPM AT 25 PSI RESIDUAL PRESSURE. THE FIRE FLOW REQUIREMENTS FOR INDIVIDUAL STRUCTURES WILL BE REVIEWED DURING THE BUILDING PERMIT PROCESS IN ACCORDANCE WITH THE PROCEDURES SET FORTH BY THE CITY OF SAN ANTONIO DIRECTOR OF DEVELOPMENT SERVICES DEPARTMENT AND THE SAN ANTONIO FIRE DEPARTMENT FIRE MARSHAL.

ROW PERMIT NOTE:

A BEXAR COUNTY PERMIT MUST BE OBTAINED BEFORE WORKING IN BEXAR COUNTY RIGHTS-OF-WAY.

PRESSURE REDUCING VALVE NOTE:

PRESSURE REDUCING VALVE TO BE INSTALLED ON CUSTOMER'S SIDE OF METER BY HOMEOWNER.

PRESSURE NOTE:

CONTRACTOR TO VERIFY THAT NO PORTION OF THE TRACT IS BELOW GROUND ELEVATION OF 565 FEET WHERE THE STATIC PRESSURE WILL NORMALLY EXCEED 80 PSI. AT ALL SUCH LOCATIONS WHERE THE GROUND LEVEL IS BELOW 565 FEET, THE DEVELOPER OR BUILDER SHALL INSTALL AT EACH LOT, ON THE CUSTOMER'S SIDE OF THE METER, AN APPROVED TYPE PRESSURE REGULATOR IN CONFORMANCE WITH THE PLUMBING CODE OF THE CITY OF SAN ANTONIO. NO DUAL SERVICES ALLOWED FOR ANY LOT(S). IF PRIOR IS/ARE REQUIRED FOR SUCH LOT(S), ONLY SINGLE SERVICE CONNECTIONS SHALL BE ALLOWED. *NOTE: A PRESSURE REGULATOR IS ALSO KNOWN AS A PRESSURE REDUCING VALVE (PRV).

JOINT RESTRAINT NOTE:

CONTRACTOR SHALL INSTALL RETAINER GLANDS AT ALL FITTINGS AND PROVIDE JOINT RESTRAINING HARNESSES OR FIELD LOCK GASKETS AT ALL JOINTS WITHIN THE LENGTH SHOWN. CONTRACTOR SHALL INSURE THAT ALL TEES, BENDS, VALVES, ETC. HAVE A MINIMUM OF 5 FT OF PIPE WITH NO JOINTS ON EACH SIDE OF THE FITTING. JOINT RESTRAINTS AND RETAINER GLANDS SHALL BE CALCULATED BY SAWS APPROVED PROGRAMS. THERE WILL BE NO SEPARATE PAY ITEM FOR RETAINER GLANDS AND OTHER JOINT RESTRAINING HARNESSES AND GASKETS, BUT SHALL BE SUBSIDIARY TO THE UNIT COST PER LINEAL FOOT OF PIPE INSTALLED.

TRENCH EXCAVATION SAFETY PROTECTION:

CONTRACTOR AND/OR CONTRACTOR'S INDEPENDENTLY RETAINED EMPLOYEE OR STRUCTURAL DESIGN/GEOTECHNICAL/ SAFETY/EQUIPMENT CONSULTANT, IF ANY, SHALL REVIEW THESE PLANS AND ANY AVAILABLE GEOTECHNICAL INFORMATION AND THE ANTICIPATED INSTALLATION SITES WITHIN THE PROJECT WORK AREA IN ORDER TO IMPLEMENT CONTRACTOR'S TRENCH EXCAVATION SAFETY PROTECTION SYSTEMS, PROGRAMS AND OR PROCEDURES FOR THE PROJECT DESCRIBED IN THE CONTRACT DOCUMENTS. THE CONTRACTOR'S IMPLEMENTATION OF THESE SYSTEMS, PROGRAMS AND/OR PROCEDURES SHALL PROVIDE FOR ADEQUATE TRENCH EXCAVATION SAFETY PROTECTION THAT COMPLY WITH AS A MINIMUM, OSHA STANDARDS FOR TRENCH EXCAVATIONS. SPECIFICALLY, CONTRACTOR AND/OR CONTRACTOR'S INDEPENDENTLY RETAINED EMPLOYEE OR SAFETY CONSULTANT SHALL IMPLEMENT A TRENCH SAFETY PROGRAM IN ACCORDANCE WITH OSHA STANDARDS GOVERNING THE PRESENCE AND ACTIVITIES OF INDIVIDUALS WORKING IN AND AROUND TRENCH EXCAVATION. WATER (SAWS PRESSURE ZONE 750)

DEVELOPER'S NAME: LENNAR HOMES OF TEXAS			
ADDRESS: 100 NE LOOP 410, STE. 1155			
CITY: SAN ANTONIO	STATE: TEXAS	ZIP: 78216	
PHONE# (210) 403-6200	FAX# N/A		
SAWS BLOCK MAP# 170538 TOTAL EDU'S 139 TOTAL ACREAGE 19.33			
TOTAL LINEAR FOOTAGE OF PIPE: 36567 LF - 8\"/>			
NUMBER OF LOTS 138 SAWS JOB NO. 23-1127			

DATE
NO. REVISION

12/2/23

ESPADA TRACT UNIT 15
SAN ANTONIO, TEXAS

OVERALL WATER DISTRIBUTION PLAN

PAPE-DAWSON
ENGINEERS

SAN ANTONIO | AUSTIN | HOUSTON | FORT WORTH | DALLAS
2000 NW LOOP 410 | SAN ANTONIO, TX 78213 | 210.375.9000
TEXAS ENGINEERING FIRM #470 | TEXAS SURVEYING FIRM #1028800

Date: Oct 27, 2023, 2:11pm User ID: kornecbo
File: P:\126132\14\Design\Civil\06071263214.dwg

THIS DOCUMENT HAS BEEN PRODUCED FROM MATERIAL THAT WAS STORED AND/OR TRANSMITTED ELECTRONICALLY AND MAY HAVE BEEN INADVERTENTLY ALTERED. RELY ONLY ON FINAL HARD COPY MATERIALS BEARING THE CONSULTANT'S ORIGINAL SIGNATURE AND SEAL. AERIAL IMAGERY PROVIDED BY GOOGLE/LEWIS UNLESS OTHERWISE NOTED. Imagery © 2016, CAPOCO, Digital Globe, Texas Orthology Program, USDA Farm Service Agency.

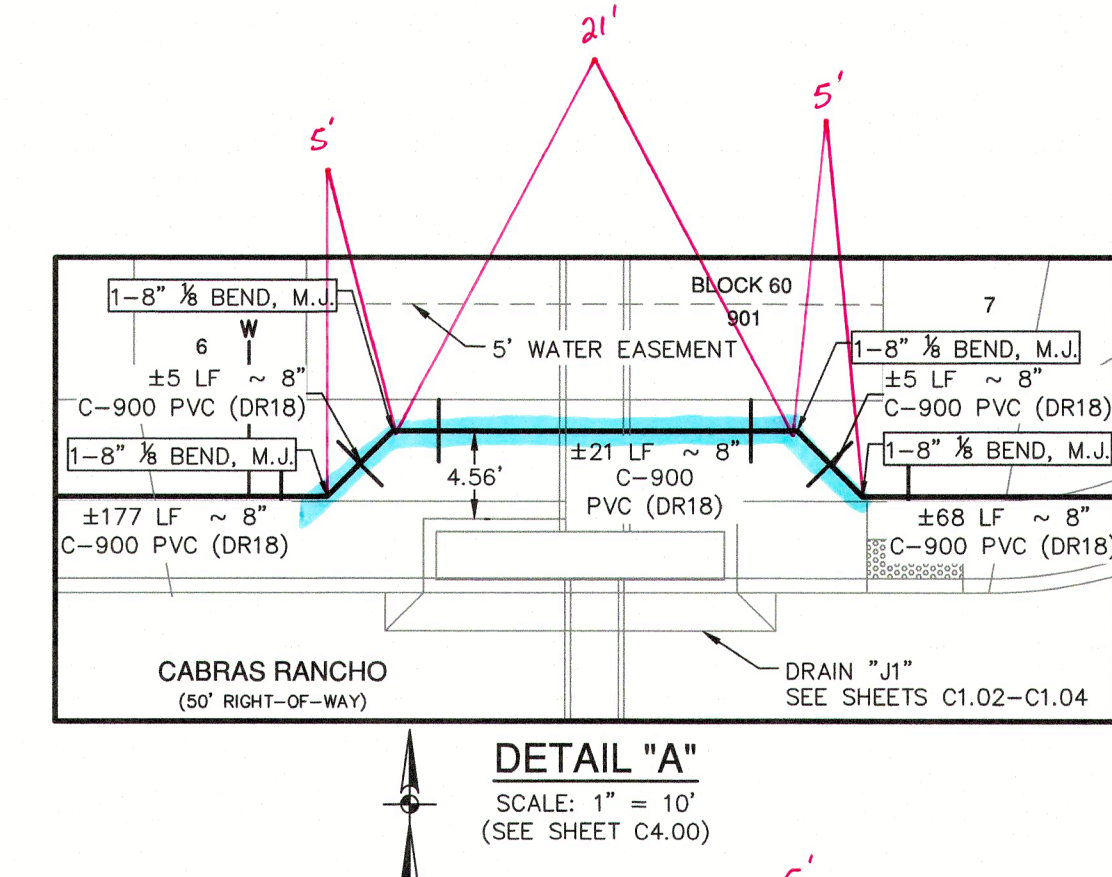
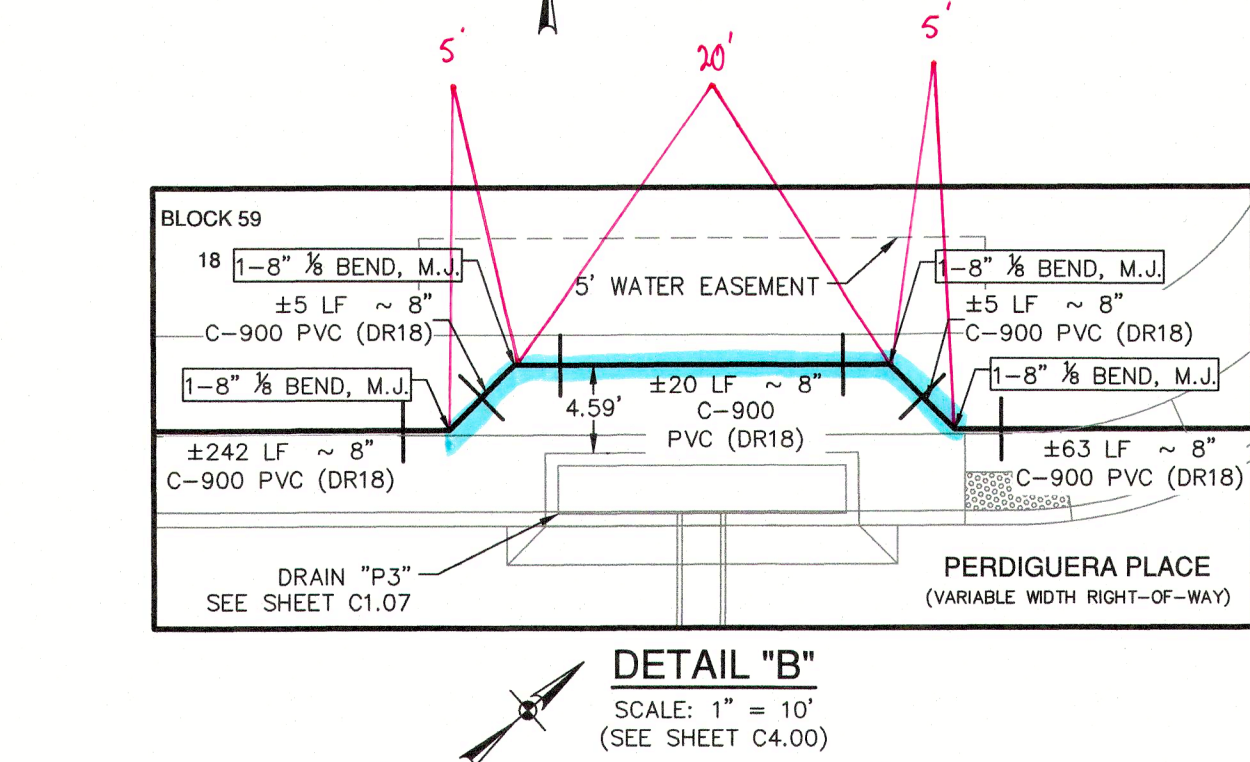
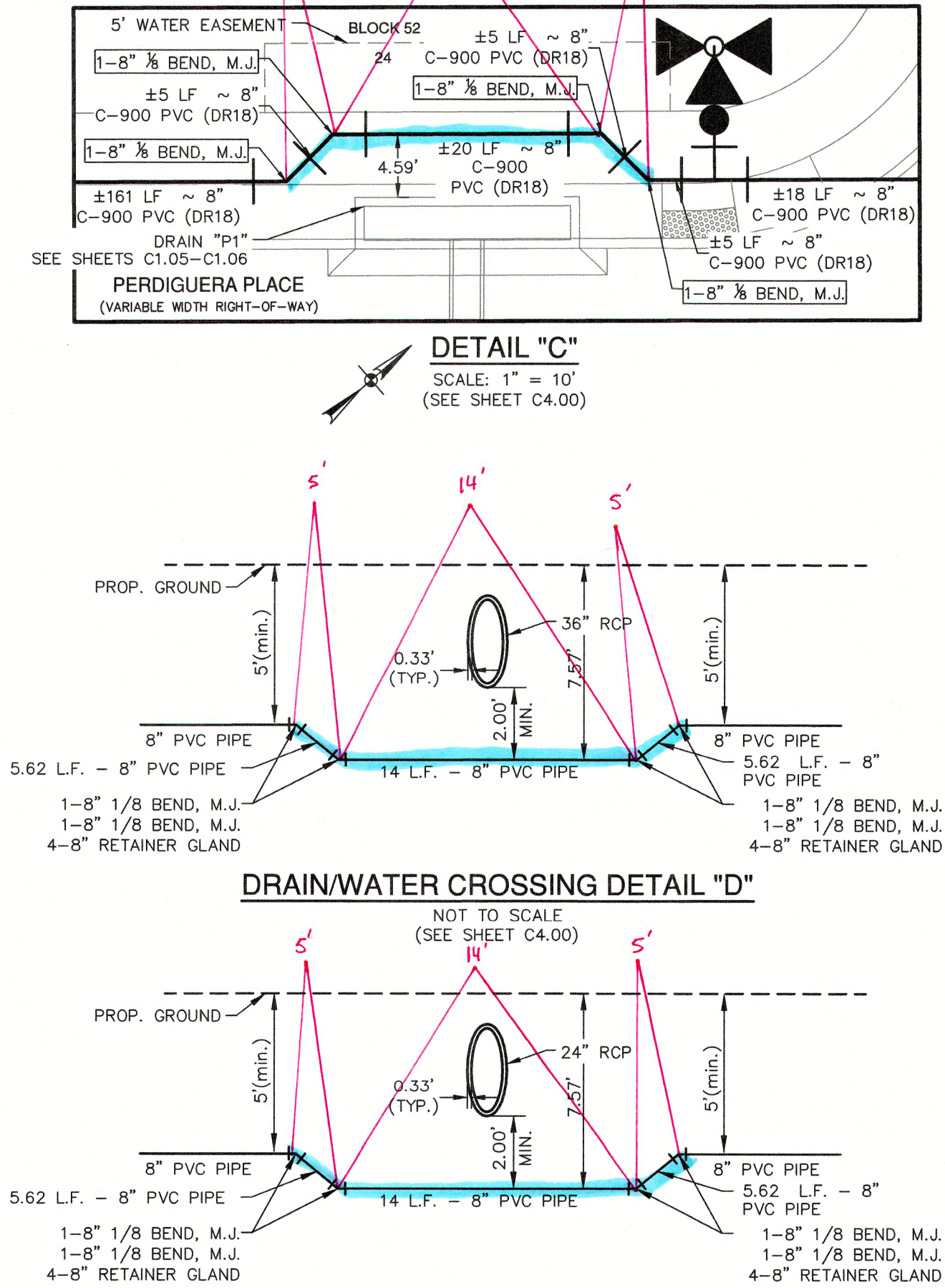
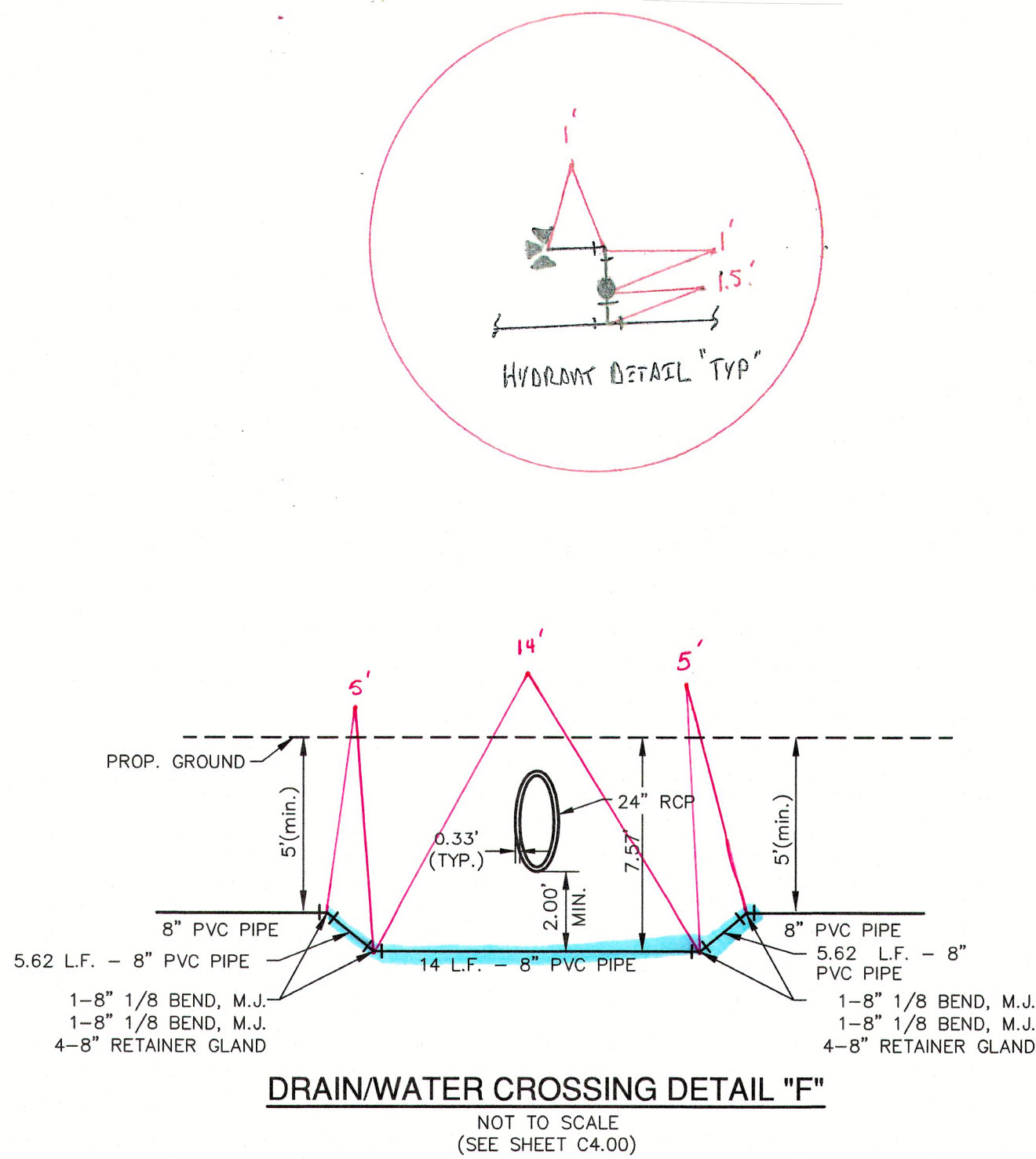

- C. CURRENT "SAN ANTONIO WATER SYSTEM STANDARD SPECIFICATIONS FOR WATER AND SANITARY SEWER CONSTRUCTION".
D. CURRENT CITY OF SAN ANTONIO "STANDARD SPECIFICATIONS FOR PUBLIC WORKS CONSTRUCTION".
E. CURRENT CITY OF SAN ANTONIO "UTILITY EXCAVATION CRITERIA MANUAL" (UECM).
- THE CONTRACTOR SHALL NOT PROCEED WITH ANY PIPE INSTALLATION WORK UNTIL THEY OBTAIN A COPY OF THE APPROVED COUNTER PERMIT OR GENERAL CONSTRUCTION PERMIT (GCP) FROM THE CONSULTANT AND HAS BEEN NOTIFIED BY SAWS CONSTRUCTION INSPECTION DIVISION TO PROCEED WITH THE WORK AND HAS ARRANGED A MEETING WITH THE INSPECTOR AND CONSULTANT FOR THE WORK REQUIREMENTS. WORK COMPLETED BY THE CONTRACTOR WITHOUT AN APPROVED COUNTER PERMIT AND/OR A GCP WILL BE SUBJECT TO REMOVAL AND REPLACEMENT AT THE EXPENSE OF THE CONTRACTORS AND/OR THE DEVELOPER.
 - THE CONTRACTOR SHALL OBTAIN THE SAWS STANDARD DETAILS FROM THE SAWS WEBSITE, [HTTP://WWW.SAWS.ORG/BUSINESS_CENTER/SPECS](http://www.saws.org/business_center/specs). UNLESS OTHERWISE NOTED WITHIN THE DESIGN PLANS.
 - THE CONTRACTOR IS TO MAKE ARRANGEMENTS WITH THE SAWS CONSTRUCTION INSPECTION DIVISION AT (210) 233-2973, ON NOTIFICATION PROCEDURES THAT WILL BE USED TO NOTIFY AFFECTED HOME RESIDENTS AND/OR PROPERTY OWNERS 48 HOURS PRIOR TO BEGINNING ANY WORK.
 - LOCATION AND DEPTH OF EXISTING UTILITIES AND SERVICE LATERALS SHOWN ON THE PLANS ARE UNDERSTOOD TO BE APPROXIMATE. ACTUAL LOCATIONS AND DEPTHS MUST BE FIELD VERIFIED BY THE CONTRACTOR AT LEAST 1 WEEK PRIOR TO CONSTRUCTION. IT SHALL BE THE CONTRACTOR'S RESPONSIBILITY TO LOCATE UTILITY SERVICE LINES AS REQUIRED FOR CONSTRUCTION AND TO PROTECT THEM DURING CONSTRUCTION AT NO COST TO SAWS.
 - THE CONTRACTOR SHALL VERIFY THE EXACT LOCATION OF UNDERGROUND UTILITIES AND DRAINAGE STRUCTURES AT LEAST 1-2 WEEKS PRIOR TO CONSTRUCTION WHETHER SHOWN ON PLANS OR NOT. PLEASE ALLOW UP TO 7 BUSINESS DAYS FOR LOCATES REQUESTING PIPE LOCATION MARKERS ON SAWS FACILITIES. THE FOLLOWING CONTACT INFORMATION ARE SUPPLIED FOR VERIFICATION PURPOSES:
 - SAWS UTILITY LOCATES: [HTTP://WWW.SAWS.ORG/SERVICE/LOCATES](http://www.saws.org/service/locates)
 - COSA DRAINAGE (210) 207-0724 OR (210) 207-6026
 - COSA TRAFFIC SIGNAL OPERATIONS (210) 206-8480
 - COSA TRAFFIC SIGNAL DAMAGES (210) 207-3951
 - TEXAS STATE WIDE ONE CALL LOCATOR 1-800-545-6005 OR 811
 - THE CONTRACTOR SHALL BE RESPONSIBLE FOR RESTORING EXISTING FENCES, CURBS, STREETS, DRIVEWAYS, SIDEWALKS, LANDSCAPING AND STRUCTURES TO ITS ORIGINAL OR BETTER CONDITION IF DAMAGES ARE MADE AS A RESULT OF THE PROJECT'S CONSTRUCTION.
 - ALL WORK IN TEXAS DEPARTMENT OF TRANSPORTATION (TxDOT) AND/OR BEXAR COUNTY RIGHT-OF-WAY SHALL BE DONE IN ACCORDANCE WITH RESPECTIVE CONSTRUCTION SPECIFICATIONS AND PERMIT REQUIREMENTS.
 - THE CONTRACTOR SHALL COMPLY WITH CITY OF SAN ANTONIO OR OTHER GOVERNING MUNICIPALITY'S TREE ORDINANCES WHEN EXCAVATING NEAR TREES.
 - THE CONTRACTOR SHALL NOT PLACE ANY WASTE MATERIALS IN THE 100-YEAR FLOOD PLAIN WITHOUT FIRST OBTAINING AN APPROVED FLOOD PLAIN PERMIT.
 - HOLIDAY WORK: CONTRACTORS WILL NOT BE ALLOWED TO PERFORM SAWS WORK ON SAWS RECOGNIZED HOLIDAYS. REQUEST SHOULD BE SENT TO CONSTWORKREQ@SAWS.ORG.
- WEEKEND WORK: CONTRACTORS ARE REQUIRED TO NOTIFY THE SAWS INSPECTION CONSTRUCTION DEPARTMENT 48 HOURS IN ADVANCE TO REQUEST WEEKEND WORK. REQUEST SHOULD BE SENT TO CONSTWORKREQ@SAWS.ORG.
- ANY AND ALL SAWS UTILITY WORK INSTALLED WITHOUT HOLIDAY/WEEKEND APPROVAL WILL BE SUBJECT TO BE UNCOVERED FOR PROPER INSPECTION.
- COMPACTION NOTE (ITEM 804): THE CONTRACTOR SHALL BE RESPONSIBLE FOR MEETING THE COMPACTION REQUIREMENTS ON ALL TRENCH BACKFILL AND FOR PAYING FOR THE TESTS PERFORMED BY A THIRD PARTY. COMPACTION TESTS WILL BE DONE AT ONE LOCATION POINT RANDOMLY SELECTED, OR AS INDICATED BY THE SAWS INSPECTOR AND/OR THE TEST ADMINISTRATOR, PER EACH 12-INCH LOOSE LIFT PER 400 LINEAR FEET AT A MINIMUM. THIS PROJECT WILL NOT BE ACCEPTED AND FINALIZED BY SAWS WITHOUT THIS REQUIREMENT BEING MET AND VERIFIED BY PROVIDING ALL NECESSARY DOCUMENTED TEST RESULTS.
 - A COPY OF ALL TESTING REPORTS SHALL BE FORWARDED TO SAWS CONSTRUCTION INSPECTION DIVISION.

- ASBESTOS CEMENT (AC) PIPE, ALSO KNOWN AS TRANSITE PIPE WHICH IS KNOWN TO CONTAIN ASBESTOS- CONTAINING MATERIAL (ACM), MAY BE LOCATED WITHIN THE PROJECT LIMITS. SPECIAL WASTE MANAGEMENT PROCEDURES AND HEALTH AND SAFETY REQUIREMENTS WILL BE APPLICABLE WHEN REMOVAL AND/OR DISTURBANCE OF THIS PIPE OCCURS. SUCH WORK IS TO BE MADE UNDER SPECIAL SPECIFICATION ITEM NO. 3000, "SPECIAL SPECIFICATION FOR HANDLING ASBESTOS CEMENT PIPE".
- VALVE REMOVAL: WHERE THE CONTRACTOR IS TO ABANDON A WATER MAIN, THE CONTROL VALVE LOCATED ON THE ABANDONING BRANCH WILL BE REMOVED AND REPLACED WITH A CAP/PLUG. (NSPI)
- SUITABLE ANCHORAGE/THRUST BLOCKING OR JOINT RESTRAINT SHALL BE PROVIDED AT ALL OF THE FOLLOWING MAIN LOCATIONS: DEAD ENDS, FLUGS, CAPS, TEES, CROSSES, VALVES, AND BENDS, IN ACCORDANCE WITH THE STANDARD DRAWINGS DD-839 SERIES AND ITEM NO. 839, IN THE SAWS STANDARD SPECIFICATIONS FOR CONSTRUCTION.
- ALL VALVES SHALL READ "OPEN RIGHT".
- PRVS REQUIRED: CONTRACTOR TO VERIFY THAT NO PORTION OF THE TRACT IS BELOW GROUND ELEVATION OF 565 FEET WHERE THE STATIC PRESSURE WILL NORMALLY EXCEED 80 PSI. AT ALL SUCH LOCATIONS WHERE THE GROUND LEVEL IS BELOW 565 FEET, THE DEVELOPER OR BUILDER SHALL INSTALL AT EACH LOT, ON THE CUSTOMER'S SIDE OF THE METER, AN APPROVED TYPE PRESSURE REGULATOR IN CONFORMANCE WITH THE PLUMBING CODE OF THE CITY OF SAN ANTONIO. NO DUAL SERVICES ALLOWED FOR ANY LOT(S) IF *PRV IS/ARE REQUIRED FOR SUCH LOT(S), ONLY SINGLE SERVICE CONNECTIONS SHALL BE ALLOWED. *NOTE: A PRESSURE REGULATOR IS ALSO KNOWN AS A PRESSURE REDUCING VALVE (PRV).
- PIPE DISINFECTION WITH DRY HTH FOR PROJECTS LESS THAN 800 LINEAR FEET. (ITEM NO. 847.3); MAINS SHALL BE DISINFECTED WITH DRY HTH WHERE SHOWN IN THE CONTRACT DOCUMENTS OR AS DIRECTED BY THE INSPECTOR, AND SHALL NOT EXCEED A TOTAL LENGTH OF 800 FEET. THIS METHOD OF DISINFECTION WILL ALSO BE FOLLOWED FOR MAIN REPAIRS. THE CONTRACTOR SHALL UTILIZE ALL APPROPRIATE SAFETY MEASURE TO PROTECT HIS PERSONNEL DURING DISINFECTION OPERATIONS.
- BACKFLOW PREVENTION DEVICES:
 - ALL IRRIGATION SERVICES WITHIN RESIDENTIAL AREAS ARE REQUIRED TO HAVE BACKFLOW PREVENTION DEVICES.
 - ALL COMMERCIAL BACKFLOW PREVENTION DEVICES MUST BE APPROVED BY SAWS PRIOR TO INSTALLATION.
- FINAL CONNECTION TO THE EXISTING WATER MAIN SHALL NOT BE MADE UNTIL THE WATER MAIN HAS BEEN PRESSURE TESTED, CHLORINATED, AND SAWS HAS RELEASED THE MAIN FOR TIE-IN AND USE.
- DIVISION VALVES: DIVISION VALVES SHOWN ON PLANS OR NOT SHOWN ON PLANS BUT FOUND IN THE FIELD SHALL ONLY BE OPERATED BY SAWS DISTRIBUTION AND COLLECTION STAFF AND ONLY WITH PRIOR WRITTEN APPROVAL OF THE SAWS DIRECTOR OF PRODUCTION AND OPERATIONS AND PROPER COORDINATION WITH ALL SAWS DEPARTMENTS. CONTRACTOR SHALL PROVIDE WRITTEN NOTIFICATION TO THE INSPECTOR A MINIMUM OF TWO WEEKS IN ADVANCE TO START THE COORDINATION PROCESS AND WILL BE INFORMED BY THE INSPECTOR WHEN THE DIVISION VALVE WILL BE OPERATED BY THE SAWS DISTRIBUTION AND COLLECTION STAFF. THE DIVISION VALVE CAN ONLY BE OPERATED BY SAWS DISTRIBUTION AND COLLECTION STAFF MEMBER NOT THE INSPECTOR OR THE CONTRACTOR. OPERATION OF A DIVISION VALVE WITHOUT THE EXPRESS PRIOR WRITTEN APPROVAL OF THE SAWS DISTRIBUTION AND COLLECTION STAFF WILL CONSTITUTE A MATERIAL BREACH OF ANY WRITTEN SAWS CONTRACT OR PERMIT IN ADDITION TO SUBJECTING THE CONTRACTOR TO LIABILITY FOR ANY AND ALL FINES, FEES, OR OTHER DAMAGES, DIRECT OR CONSEQUENTIAL, THAT MAY ARISE FROM OR BE CAUSED BY THE OPERATION OF THE VALVE WITHOUT PRIOR WRITTEN PERMISSION. PLEASE BE INFORMED THAT THE APPROVAL OF THE OPERATION OR OPENING OR CLOSING OF A DIVISION VALVE CAN TAKE SEVERAL WEEKS FOR APPROVAL. DIVISION VALVES WILL ALSO HAVE A VALVE LID LABELED DIVISION VALVE AND A LOCKING MECHANISM INSTALLED WITH A KEY. THE LOCK AND KEY MECHANISM WILL BE PAID FOR BY THE CONTRACTOR BUT WILL BE INSTALLED BY SAWS DISTRIBUTION AND COLLECTION STAFF.

- SHALL BE THE CONTRACTOR'S RESPONSIBILITY TO INSPECT THE SITE AND VERIFY THAT ALL STAKES REQUIRED FOR HIS WORK ARE IN PLACE AT THE TIME THE CONSTRUCTION BEGINS. IF ANY STAKES ARE MISSING THE ENGINEER SHOULD BE NOTIFIED IMMEDIATELY. AFTER CONSTRUCTION BEGINS, ALL CONSTRUCTION STAKES, MARKS, ETC., SHALL BE CAREFULLY PRESERVED BY THE CONTRACTOR, AND IN CASE OF DESTRUCTION OR REMOVAL BY THE CONTRACTOR, HIS EMPLOYEE OR ANY OTHER MEANS, SUCH STAKES, MARKS, ETC., SHALL BE REPLACED AT THE CONTRACTOR'S EXPENSE.
- THE CONTRACTOR SHALL FURNISH THE ENGINEER WITH ALL THE FINAL MEASUREMENTS, TAPS AND LENGTH OF SERVICE CONNECTIONS.
 - THE LOT CORNERS WILL BE SET BY THE ENGINEER FOR INSTALLATION OF ALL WATER SERVICES. THESE LOT CORNERS SHALL BE CAREFULLY PRESERVED BY THE CONTRACTOR SO THE METER BOXES CAN BE SET IN PHASE II. ANY LOT CORNER DESTROYED OR REMOVED BY THE CONTRACTOR, HIS EMPLOYEES, OR BY ANY OTHER MEANS SHALL BE REPLACED AT THE CONTRACTOR'S EXPENSE.
 - STREETS WILL HAVE BEEN EXCAVATED DOWN TO SUBGRADE AND THE PARKWAY WILL BE CUT DOWN TO TOP OF CURB BY THE STREET CONTRACTOR, PRIOR TO CONSTRUCTION OF THE WATER MAINS. IT WILL BE THE UTILITY CONTRACTOR'S RESPONSIBILITY TO PROVIDE A PAD FOR HIS EQUIPMENT.
 - WATER METER BOXES IF APPLICABLE SHALL BE INSTALLED NINE FEET FROM FACE OF CURB TO CENTER OF THE METER BOX.
 - ALL GARBAGE OR SPOIL MATERIAL FROM THIS WORK SHALL BE REMOVED FROM THE SITE BY THE CONTRACTOR, AT HIS EXPENSE.
 - FINAL CONNECTION TO THE EXISTING WATER MAIN SHALL NOT BE MADE UNTIL WATER MAIN HAS BEEN PRESSURE TESTED, CHLORINATED AND THE S.A.W.S. RELEASES THE MAIN FOR TIE-IN AND USE.
 - UNIT PRICE BID FOR "STANDARD FIRE HYDRANT ASSEMBLY" SHALL INCLUDE FIRE HYDRANT, 6-INCH GATE VALVE AND 6-INCH VALVE BOX COMPLETE, ANCHOR BEND, AND ALL 6-INCH DI PIPE REQUIRED (DI PIPE REQUIRED SHALL INCLUDE ALL PIPE FROM THE TEE ON THE MAIN LINE TO THE FIRE HYDRANT).
 - WHEN SEWER LINES ARE INSTALLED IN THE VICINITY OF WATER MAINS, SUCH INSTALLATION SHALL BE IN STRICT ACCORDANCE WITH THE TEXAS NATURAL RESOURCE CONSERVATION COMMISSION "RULES AND REGULATIONS FOR PUBLIC WATER SYSTEMS" (1988 OR ANY REVISIONS THERETO).
 - A CLEAR SPACE SHALL BE PROVIDED AROUND ALL FIRE HYDRANTS. THIS AREA SHOULD HAVE A MINIMUM DIAMETER OF 3.0' AND BE CLEAN OF VERTICAL OBSTRUCTIONS, VALVES, AND METER BOXES.
 - SAWS REQUIRES LEAD FREE (< 0.25%) FIRE HYDRANTS.
 - UNLESS OTHERWISE NOTED ALL SERVICES SHALL BE 3/4" WITH 5/8" METER.

WATER (SAWS PRESSURE ZONE 750)

DEVELOPER'S NAME:	LENNAR HOMES OF TEXAS
ADDRESS:	100 NE LOOP 410, STE. 1155
CITY:	SAN ANTONIO
STATE:	TEXAS
ZIP:	78216
PHONE#	(210) 403-6200
FAX#	N/A
SAWS BLOCK MAP#	170538
TOTAL EDU'S	139
TOTAL ACREAGE	19.33
TOTAL LINEAR FOOTAGE OF PIPE:	184.34 LF ~ 12" PVC
NUMBER OF LOTS	138
SAWS JOB NO.	23-1127

PLAT NO.	23-11800231
JOB NO.	12632-14
DATE	JULY 2023
DESIGNER	JG
CHECKED	DW
DRAWN	TC

SHEET C4.02

ESPADA TRACT UNIT 15
SAN ANTONIO, TEXAS

OVERALL WATER DISTRIBUTION DETAILS & NOTES

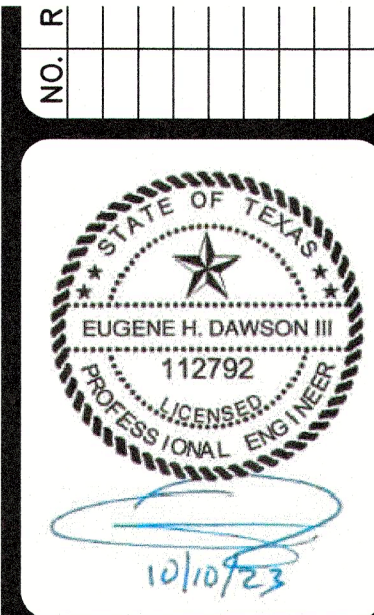

PAPE-DAWSON ENGINEERS
SAN ANTONIO | AUSTIN | HOUSTON | FORT WORTH | DALLAS
2000 NW LOOP 410 | SAN ANTONIO, TX 78213 | 210.375.9000
TEXAS ENGINEERING FIRM #470 | TEXAS SURVEYING FIRM #10028600